

Oklahoma Corporation Commission  
Oil & Gas Conservation Division  
Post Office Box 52000  
Oklahoma City, Oklahoma 73152-2000  
Rule 165: 10-3-25

Form 1002A

API No.: 35051248040001

**Completion Report**

Spud Date: September 22, 2020

OTC Prod. Unit No.: 051-227174-0-0000

Drilling Finished Date: October 15, 2020

1st Prod Date: April 24, 2021

Completion Date: April 24, 2021

**Drill Type:** HORIZONTAL HOLE

Well Name: HALE 4-1X36H

Purchaser/Measurer:

Location: GRADY 1 3N 6W  
NW SW NW SE  
1852 FSL 2405 FEL of 1/4 SEC  
Latitude: 34.75909683 Longitude: -97.78134842  
Derrick Elevation: 0 Ground Elevation: 1281

First Sales Date: 04/24/2021

Operator: GULFPORT MIDCON LLC 24020

3001 QUAIL SPRINGS PKWY  
OKLAHOMA CITY, OK 73134-2640

Completion Type	
X	Single Zone
	Multiple Zone
	Commingled

Location Exception	
Order No	
720405	

Increased Density	
Order No	
710922	
710923	

Casing and Cement							
Type	Size	Weight	Grade	Feet	PSI	SAX	Top of CMT
CONDUCTOR	30		SEAMPIPE	0			
SURFACE	13.375	54.4	J-55	1514		1000	SURFACE
INTERMEDIATE	9.625	40	P-110HC	11525		825	4633
PRODUCTION	5.5	23	P-110EC	22475		2745	8356

Liner								
Type	Size	Weight	Grade	Length	PSI	SAX	Top Depth	Bottom Depth
There are no Liner records to display.								

**Total Depth: 22447**

Packer	
Depth	Brand & Type
There are no Packer records to display.	

Plug	
Depth	Plug Type
There are no Plug records to display.	

Initial Test Data
-------------------

Test Date	Formation	Oil BBL/Day	Oil-Gravity (API)	Gas MCF/Day	Gas-Oil Ratio Cu FT/BBL	Water BBL/Day	Pumpin or Flowing	Initial Shut-In Pressure	Choke Size	Flow Tubing Pressure
May 14, 0202	WOODFORD	493	58	19729	40018	2230	FLOWING	4936	32	

Completion and Test Data by Producing Formation

Formation Name: WOODFORD

Code: 319WDFD

Class: GAS

Spacing Orders

Order No	Unit Size
184773	640
238020	640
257588	REINSTATE
720404	MULTIUNIT

Perforated Intervals

From	To
14350	22377

Acid Volumes

182 BARRELS ACID

Fracture Treatments

484,897 BARRELS FLUID  
23,136,811 POUNDS PROPPANT

Formation	Top
WOODFORD	14092

Were open hole logs run? No  
Date last log run:

Were unusual drilling circumstances encountered? No  
Explanation:

Other Remarks

There are no Other Remarks.

Lateral Holes

Sec: 36 TWP: 4N RGE: 6W County: GRADY

NE NE NE NW

96 FNL 2629 FWL of 1/4 SEC

Depth of Deviation: 13360 Radius of Turn: 343 Direction: 355 Total Length: 8744

Measured Total Depth: 22447 True Vertical Depth: 15036 End Pt. Location From Release, Unit or Property Line: 96

FOR COMMISSION USE ONLY

Status: Accepted

1147511

API NO. 35-051-24804  
OTC PROD. UNIT NO. 051-227174

Oil and Gas Conservation Division  
P.O. Box 52000  
Oklahoma City, OK 73152-2000  
405-521-2331  
OCCCentralProcessing@OCC.OK.GOV



Form 1002A  
Rev. 2021

RECEIVED

JAN 28 2022

OKLAHOMA CORPORATION  
COMMISSION

ORIGINAL  
AMENDED (Reason)

TYPE OF DRILLING OPERATION  
☐ STRAIGHT HOLE ☐ DIRECTIONAL HOLE ☒ HORIZONTAL HOLE  
SERVICE WELL

IF directional or horizontal, see reverse for bottom hole location.

COUNTY Grady SEC 01 TWP03N RGE 06W

LEASE NAME HALE WELL NO. 4-1X36H

NW 1/4 SW 1/4 NW 1/4 SE 1/4 FSL 1852 (FEET) 2405

ELEVATION Derrick FL Ground 1281 Latitude 34.75909683 Longitude -97.78134842

OPERATOR NAME GULFPORT MIDCON OTC / OCC OPERATOR NO. 24020

ADDRESS 3001 QUAIL SPRINGS PARKWAY

CITY OKLAHOMA CITY STATE OK ZIP 73134

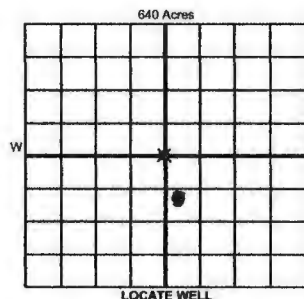

COMPLETION TYPE  
☒ SINGLE ZONE  
☐ MULTIPLE ZONE  
☐ COMMINGLED

LOCATION EXCEPTION ORDER NO. 720405 FO

MULTIUNIT ORDER NO. 720404 FO

INCREASED DENSITY ORDER NO. 710923/710922

CASING & CEMENT (Attach Form 1002C)

TYPE	SIZE	WEIGHT	GRADE	FEET	PSI	SAX	TOP OF CMT
CONDUCTOR	30		SEAMPIPE				
SURFACE	13.375	54.4LBS	J55	1,514		1000	SURFACE
INTERMEDIATE	9.625	40LBS	P110HC	11,525		825	4633
PRODUCTION	5.5	23LBS	P110EC	22,475		2,745	8,356
LINER							

PACKER @ BRAND & TYPE PLUG @ TYPE PLUG @ TYPE PLUG @ TYPE

PACKER @ BRAND & TYPE PLUG @ TYPE PLUG @ TYPE

TOTAL DEPTH 22,447

COMPLETION & TEST DATA BY PRODUCING FORMATION

FORMATION Woodford

SPACING & SPACING ORDER NUMBER 184773(640) 238020(640) 257500 Reinstated

CLASS: Oil, Gas, Dry, Inj, Disp, Comm Disp, Svc Gas

PERFORATED INTERVALS 14,350-22,377

ACID/VOLUME 182bbl Acid

FRACTURE TREATMENT (Fluids/Prop Amounts) 484,897 bbl Fluid 23,136,811lbs Proppant

Min Gas Allowable (185-10-17-7) OR Oil Allowable (165-10-13-3)

Purchaser/Measurer First Sales Date 4/24/2021

INITIAL TEST DATA

INITIAL TEST DATE	5/14/2021				
OIL-BBL/DAY	493				
OIL-GRAVITY (API)	58				
GAS-MCF/DAY	19,729				
GAS-OIL RATIO CU FT/BBL	ran 40018				
WATER-BBL/DAY	2,230				
PUMPING OR FLOWING	Flowing				
INITIAL SHUT-IN PRESSURE	4936				
CHOKE SIZE	32				
FLOW TUBING PRESSURE	N/A				

A record of the formations drilled through, and pertinent remarks are presented on the reverse. I declare that I have knowledge of the contents of this report and am authorized by my organization to make this report, which was prepared by me or under my supervision and direction, with the data and facts stated herein to be true, correct, and complete to the best of my knowledge and belief.

Monica Pickens  
3001 Quail Springs Parkway Oklahoma City OK 73134  
ADDRESS CITY STATE ZIP

1/27/2022 252-4600  
DATE PHONE NUMBER  
mpickens@gulfportenergy.com  
EMAIL ADDRESS

PLEASE TYPE OR USE BLACK INK ONLY

## FORMATION RECORD

Give formation names and tops, if available, or descriptions and thickness of formations drilled through. Show intervals cored or drillstem tested.

NAMES OF FORMATIONS	TOP
Woodford	14,092

LEASE NAME

Hale

WELL NO. 4-1X36H

FOR COMMISSION USE ONLY	
ITD on file <input type="checkbox"/> YES <input type="checkbox"/> NO	
APPROVED _____	DISAPPROVED _____
2) Reject Codes	
_____	
_____	
_____	
_____	

Were open hole logs run?	<input type="radio"/> yes <input checked="" type="radio"/> no
Date Last log was run	_____
Was CO <sub>2</sub> encountered?	<input type="radio"/> yes <input checked="" type="radio"/> no at what depths? _____
Was H <sub>2</sub> S encountered?	<input type="radio"/> yes <input checked="" type="radio"/> no at what depths? _____
Were unusual drilling circumstances encountered?	<input type="radio"/> yes <input checked="" type="radio"/> no
If yes, briefly explain below	

Other remarks: 051-227174-0-0000 OTC#

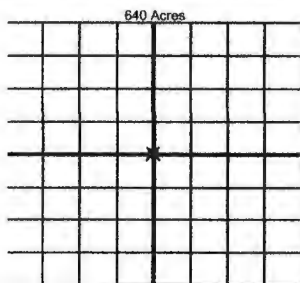

If more than three drainholes are proposed, attach a separate sheet indicating the necessary information.

Direction must be stated in degrees azimuth. Please note, the horizontal drainhole and its end point must be located within the boundaries of the lease or spacing unit.

Directional surveys are required for all drainholes and directional wells.

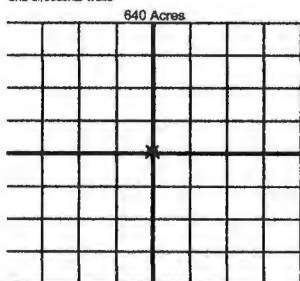

## BOTTOM HOLE LOCATION FOR DIRECTIONAL HOLE

SEC	TWP	RGE	COUNTY
1/4	1/4	1/4	1/4
Measured Total Depth		True Vertical Depth	BHL From Lease, Unit, or Property Line:

## BOTTOM HOLE LOCATION FOR HORIZONTAL HOLE: (LATERALS)

34.78284158 -97.78246220

LATERAL #1	SEC	TWP	RGE	COUNTY
	36	04N	06W	GRADY
NE 1/4	NE 1/4	NE 1/4	NW 1/4	Feet From 1/4 Sec Lines
Depth of Deviation	Radius of Turn	Direction	Total Length	
Measured Total Depth	True Vertical Depth	BHL From Lease, Unit, or Property Line:		
	22,447	15,036	96	2629

## LATERAL #2

SEC	TWP	RGE	COUNTY
1/4	1/4	1/4	1/4
Depth of Deviation		Radius of Turn	Direction
Measured Total Depth		True Vertical Depth	BHL From Lease, Unit, or Property Line:

## LATERAL #3

SEC	TWP	RGE	COUNTY
1/4	1/4	1/4	1/4
Depth of Deviation		Radius of Turn	Direction
Measured Total Depth		True Vertical Depth	BHL From Lease, Unit, or Property Line: