

Oklahoma Corporation Commission  
Oil & Gas Conservation Division  
Post Office Box 52000  
Oklahoma City, Oklahoma 73152-2000  
Rule 165: 10-3-25

Form 1002A

API No.: 35051247200000

**Completion Report**

Spud Date: November 04, 2019

OTC Prod. Unit No.: 051-226667-0-0000

Drilling Finished Date: November 11, 2019

1st Prod Date: February 06, 2020

Completion Date: February 06, 2020

**Drill Type:** HORIZONTAL HOLE

Min Gas Allowable: Yes

Well Name: SUE 3-11X14H

Purchaser/Measurer:

Location: GRADY 11 4N 6W  
NW NE NW NW  
186 FNL 881 FWL of 1/4 SEC  
Latitude: 34.84069 Longitude: -97.80560455  
Derrick Elevation: 0 Ground Elevation: 1086

First Sales Date: 02/10/2020

Operator: GULFPORT MIDCON LLC 24020

3001 QUAIL SPRINGS PKWY  
OKLAHOMA CITY, OK 73134-2640

Completion Type		Location Exception		Increased Density	
X	Single Zone	Order No		Order No	
	Multiple Zone	712493		700299	
	Commingled			700300	

Casing and Cement							
Type	Size	Weight	Grade	Feet	PSI	SAX	Top of CMT
CONDUCTOR	30		SEAMPIPE	120			SURFACE
SURFACE	13 3/8	54.4	J-55	1493		1000	SURFACE
INTERMEDIATE	9 5/8	40.0	P-110HC	12836		820	8265
PRODUCTION	5 1/2	23.0	P-110C4	22884		2540	9847

Liner								
Type	Size	Weight	Grade	Length	PSI	SAX	Top Depth	Bottom Depth
There are no Liner records to display.								

**Total Depth: 22912**

Packer	
Depth	Brand & Type
There are no Packer records to display.	

Plug	
Depth	Plug Type
There are no Plug records to display.	

Initial Test Data
-------------------

Test Date	Formation	Oil BBL/Day	Oil-Gravity (API)	Gas MCF/Day	Gas-Oil Ratio Cu FT/BBL	Water BBL/Day	Pumpin or Flowing	Initial Shut-In Pressure	Choke Size	Flow Tubing Pressure
Feb 18, 2020	WOODFORD	253	59.7	3254	12862	2882	FLOWING	4100	44	3426

Completion and Test Data by Producing Formation									
Formation Name: WOODFORD				Code: 319WDFD			Class: OIL		
Spacing Orders				Perforated Intervals					
Order No		Unit Size		From			To		
199706		640		15450			22803		
212972		640							
712495		MULTIUNIT							
Acid Volumes				Fracture Treatments					
1,536 BARRELS ACID				17,473,184 POUNDS SAND 303,796 BARRELS WATER					

Formation	Top
WOODFORD	15131

Were open hole logs run? No

Date last log run:

Were unusual drilling circumstances encountered? No

Explanation:

Other Remarks
There are no Other Remarks.

Lateral Holes
Sec: 14 TWP: 4N RGE: 6W County: GRADY  SW SW SE NW  2599 FNL 1616 FWL of 1/4 SEC  Depth of Deviation: 14702 Radius of Turn: 506 Direction: 181 Total Length: 7353  Measured Total Depth: 22912 True Vertical Depth: 15299 End Pt. Location From Release, Unit or Property Line: 1616

FOR COMMISSION USE ONLY
<div>Status: Accepted</div> <div>1147507</div>

NO. 051-24720  
OTC PROD.  
UNIT NO. 051-226667-0-0000

OKLAHOMA CORPORATION COMMISSION  
Oil & Gas Conservation Division  
Post Office Box 52000  
Oklahoma City, Oklahoma 73152-2000  
Rule 165:10-3-25

RECEIVED

MAR 28 2020

☒ ORIGINAL  
☐ AMENDED (Reason) \_\_\_\_\_

COMPLETION REPORT

OKLAHOMA CORPORATION  
COMMISSION

TYPE OF DRILLING OPERATION

☐ STRAIGHT HOLE ☐ DIRECTIONAL HOLE ☒ HORIZONTAL HOLE  
☐ SERVICE WELL

If directional or horizontal, see reverse for bottom hole location.

COUNTY Grady SEC 11 TWP 4N RGE 6W  
LEASE NAME Sue WELL NO. 3-11x14+  
DATE OF WELL COMPLETION 2/6/2020 1st PROD DATE 2/6/2020  
NW 1/4 NE 1/4 NW 1/4 NW 1/4  
ELEVATION 1086 FOL OF 126 FWL OF 881 RECOMP DATE  
Derrick FL Ground Latitude (if known) 34.8406900 Longitude (if known) 97.80560455  
OPERATOR Gulfport Midcon OTC/OCC OPERATOR NO. 24020  
ADDRESS 3001 Quail Springs Parkway  
CITY Oklahoma City STATE OK ZIP 73134

SPUD DATE 9/27/2019  
DRG FINISHED DATE 11/11/2019  
DATE OF WELL COMPLETION 2/6/2020  
1st PROD DATE 2/6/2020

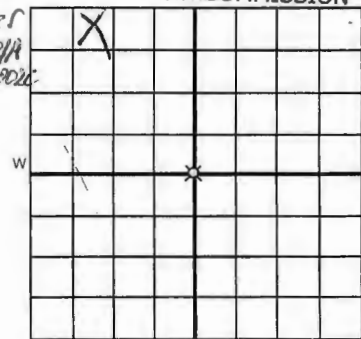

COMPLETION TYPE

☒ SINGLE ZONE  
☐ MULTIPLE ZONE  
Application Date  
COMINGLED  
Application Date  
LOCATION EXCEPTION  
ORDER NO. 712493FD  
INCREASED DENSITY  
ORDER NO. 700299/700300

CASING & CEMENT (Attach Form 1002C)

TYPE	SIZE	WEIGHT	GRADE	FEET	PSI	SAX	TOP OF CMT
CONDUCTOR	30		SEMM	120			Surface
SURFACE	13 3/8	54.4	555	1493		1000	Surface
INTERMEDIATE	9 5/8	40.0	P110HC	12836		820	8,265
PRODUCTION	5 1/2	23.0	P110CL	22,884		2540	9247
LINER							

PACKER @ \_\_\_\_\_ BRAND & TYPE \_\_\_\_\_  
PACKER @ \_\_\_\_\_ BRAND & TYPE \_\_\_\_\_

PLUG @ \_\_\_\_\_ TYPE \_\_\_\_\_ PLUG @ \_\_\_\_\_ TYPE \_\_\_\_\_  
PLUG @ \_\_\_\_\_ TYPE \_\_\_\_\_ PLUG @ \_\_\_\_\_ TYPE \_\_\_\_\_

TOTAL DEPTH 22,912

COMPLETION & TEST DATA BY PRODUCING FORMATION

FORMATION	Woodford	Woodford	Woodford			
SPACING & SPACING	<u>199706</u>	<u>212972</u>	<u>701922</u>	<u>712495FD</u>		
ORDER NUMBER						
CLASS: Oil, Gas, Dry, Inj, Disp, Comm Disp, Svc	<u>Oil</u>					
PERFORATED INTERVALS	<u>15,450-22,803</u>					
ACID/VOLUME	<u>1536 bbls Acid</u>					
FRACTURE TREATMENT (Fluids/Prop Amounts)	<u>7,473,184 lbs Sand</u> <u>303,796 bbls water</u>					

Min Gas Allowable (165:10-17-7)

Gas Purchaser/Measurer



OR

First Sales Date

Oil Allowable (165:10-13-3)

2/10/2020

INITIAL TEST DATA

INITIAL TEST DATE	<u>2/18/2020</u>					
OIL-BBL/DAY	<u>253</u>					
OIL-GRAVITY (API)	<u>59.7</u>					
GAS-MCF/DAY	<u>3,254</u>					
GAS-OIL RATIO CU FT/BBL	<u>12,862</u>					
WATER-BBL/DAY	<u>2.882</u>					
PUMPING OR FLOWING	<u>Flowing</u>					
INITIAL SHUT-IN PRESSURE	<u>4,100</u>					
CHOKE SIZE	<u>44</u>					
FLOW TUBING PRESSURE	<u>3,426</u>					

A record of the formations drilled through, and pertinent remarks are presented on the reverse. I declare that I have knowledge of the contents of this report and am authorized by my organization to make this report, which was prepared by me or under my supervision and direction, with the data and facts stated herein to be true, correct, and complete to the best of my knowledge and belief.

Man Pickens Monica Pickens 3/27/2020 252-4102  
SIGNATURE NAME (PRINT OR TYPE) DATE PHONE NUMBER  
3001 Quail Springs Parkway OK 73134 mpickens@gulfportenergy.com  
ADDRESS CITY STATE ZIP EMAIL ADDRESS

PLEASE TYPE OR USE BLACK INK ONLY  
FORMATION RECORD

Give formation names and tops, if available, or descriptions and thickness of formations drilled through. Show intervals cored or drillstem tested.

LEASE NAME

Sue

WELL NO.

3-11X14H

NAMES OF FORMATIONS	TOP
<u>Woodford</u>	<u>15131</u>

FOR COMMISSION USE ONLY	
ITD on file <input type="checkbox"/> YES <input type="checkbox"/> NO	
APPROVED <input checked="" type="checkbox"/> DISAPPROVED <input type="checkbox"/>	
2) Reject Codes	

Were open hole logs run?	<input type="checkbox"/> yes <input checked="" type="checkbox"/> no
Date Last log was run	
Was CO <sub>2</sub> encountered?	<input type="checkbox"/> yes <input checked="" type="checkbox"/> no at what depths?
Was H <sub>2</sub> S encountered?	<input type="checkbox"/> yes <input checked="" type="checkbox"/> no at what depths?
Were unusual drilling circumstances encountered?	<input type="checkbox"/> yes <input checked="" type="checkbox"/> no
If yes, briefly explain below	

Other remarks:

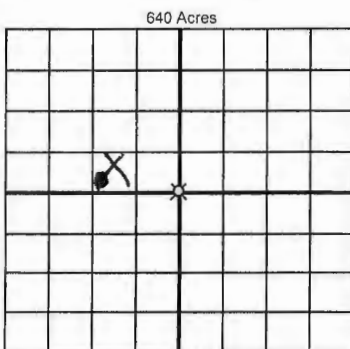

If more than three drainholes are proposed, attach a separate sheet indicating the necessary information.

Direction must be stated in degrees azimuth. Please note, the horizontal drainhole and its end point must be located within the boundaries of the lease or spacing unit.

Directional surveys are required for all drainholes and directional wells.

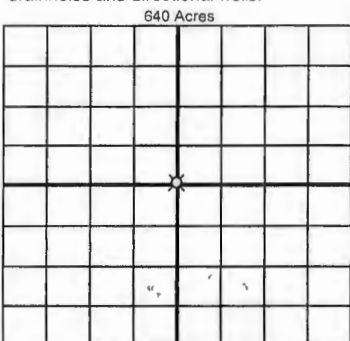

BOTTOM HOLE LOCATION FOR DIRECTIONAL HOLE

SEC	TWP	RGE	COUNTY
Spot Location		Feet From 1/4 Sec Lines	FSL
1/4	1/4	1/4	FWL
Measured Total Depth		True Vertical Depth	
BHL From Lease, Unit, or Property Line:			

BOTTOM HOLE LOCATION FOR HORIZONTAL HOLE: (LATERALS)

LATERAL #1			
SEC	TWP	RGE	COUNTY
<u>14</u>	<u>4N</u>	<u>6W</u>	<u>Grady</u>
Spot Location		Feet From 1/4 Sec Lines	FSL
<u>SW</u> 1/4	<u>SW</u> 1/4	<u>SE</u> 1/4	<u>NW</u> 1/4
Depth of Deviation		Radius of Turn	Direction
<u>14,702</u>		<u>506</u>	<u>475-101</u>
Measured Total Depth		True Vertical Depth	
<u>22,912</u>		<u>15299</u>	
BHL From Lease, Unit, or Property Line:			
<u>1616</u>			

LATERAL #2			
SEC	TWP	RGE	COUNTY
Spot Location		Feet From 1/4 Sec Lines	FSL
1/4	1/4	1/4	FWL
Depth of Deviation		Radius of Turn	Direction
Measured Total Depth		True Vertical Depth	
BHL From Lease, Unit, or Property Line:			

LATERAL #3			
SEC	TWP	RGE	COUNTY
Spot Location		Feet From 1/4 Sec Lines	FSL
1/4	1/4	1/4	FWL
Depth of Deviation		Radius of Turn	Direction
Measured Total Depth		True Vertical Depth	
BHL From Lease, Unit, or Property Line:			