

Oklahoma Corporation Commission
Oil & Gas Conservation Division
Post Office Box 52000
Oklahoma City, Oklahoma 73152-2000
Rule 165: 10-3-25

Form 1002A

API No.: 35081243040001

Completion Report

Spud Date: July 01, 2018

OTC Prod. Unit No.: 081-224306-0-0000

Drilling Finished Date: July 20, 2018

1st Prod Date: December 12, 2018

Completion Date: October 05, 2018

Drill Type: DIRECTIONAL HOLE

HORIZONTAL HOLE

Min Gas Allowable: Yes

Well Name: CHERRY HILLS 2-5H

Purchaser/Measurer: KINDER MORGAN

Location: LINCOLN 8 13N 5E
SE NW NE SW
2185 FSL 1876 FWL of 1/4 SEC
Derrick Elevation: 882 Ground Elevation: 865

First Sales Date: 12/12/2018

Operator: MONTCLAIR ENERGY LLC 22644

3509 FRENCH PARK DR STE B
EDMOND, OK 73034-7291

Completion Type		Location Exception		Increased Density	
X	Single Zone	Order No		Order No	
	Multiple Zone	688492		692073	
	Commingled				

Casing and Cement							
Type	Size	Weight	Grade	Feet	PSI	SAX	Top of CMT
SURFACE	9 5/8	32	J-55	183	500	130	SURFACE
PRODUCTION	7	26	N-80	6562	1500	300	4580

Liner								
Type	Size	Weight	Grade	Length	PSI	SAX	Top Depth	Bottom Depth
There are no Liner records to display.								

Total Depth: 10252

Packer	
Depth	Brand & Type
There are no Packer records to display.	

Plug	
Depth	Plug Type
There are no Plug records to display.	

Initial Test Data

Test Date	Formation	Oil BBL/Day	Oil-Gravity (API)	Gas MCF/Day	Gas-Oil Ratio Cu FT/BBL	Water BBL/Day	Pumpin or Flowing	Initial Shut-In Pressure	Choke Size	Flow Tubing Pressure
Dec 29, 2018	HUNTON	49	45	270	5510	1070	PUMPING			

Completion and Test Data by Producing Formation

Formation Name: HUNTON

Code: 269HNTN

Class: OIL

Spacing Orders

Order No	Unit Size
623880	640

Perforated Intervals

From	To
There are no Perf. Intervals records to display.	

Acid Volumes

8,000 GALLONS 15% HCL

Fracture Treatments

There are no Fracture Treatments records to display.
--

Formation	Top
BARTLESVILLE	5269
MISSISSIPPIAN CANEY	5549
MAYES	5743
WOODFORD SHALE	6186
HUNTON LIME	6352
SYLVAN SHALE	6505

Were open hole logs run? No

Date last log run:

Were unusual drilling circumstances encountered? No

Explanation:

Other Remarks

OCC - THIS WELL IS AN OPEN HOLE COMPLETION OPERATOR CUT HOLE IN 7" CASING AT 6376 AND DRILLED TO TERMINUS THROUGH THAT HOLE AT 10252.

Bottom Holes

Sec: 5 TWP: 13N RGE: 5E County: LINCOLN

NE SW SE SW

578 FSL 1828 FWL of 1/4 SEC

Depth of Deviation: 0 Radius of Turn: 0 Direction: 0 Total Length: 0

Measured Total Depth: 6657 True Vertical Depth: 4792 End Pt. Location From Release, Unit or Property Line: 350

Lateral Holes

Sec: 5 TWP: 13N RGE: 5E County: LINCOLN

NE NW SW NW

1515 FNL 372 FWL of 1/4 SEC

Depth of Deviation: 6376 Radius of Turn: 90 Direction: 354 Total Length: 3876

Measured Total Depth: 10252 True Vertical Depth: 4624 End Pt. Location From Release, Unit or Property Line: 372

Status: Accepted

API NO. 081-24304
OTC PROD. UNIT NO. 081224306

(PLEASE TYPE OR USE BLACK INK ONLY)

OKLAHOMA CORPORATION COMMISSION

Oil & Gas Conservation Division

Post Office Box 52000

Oklahoma City, Oklahoma 73152-2000

Rule 165:10-3-25

RECEIVED

FEB 01 2019

Oklahoma Corporation
Commission

Form 1002A

Rev. 2009

☒ ORIGINAL
☐ AMENDED (Reason)

COMPLETION REPORT

TYPE OF DRILLING OPERATION

☐ STRAIGHT HOLE ☒ DIRECTIONAL HOLE ☒ HORIZONTAL HOLE
☐ SERVICE WELL

If directional or horizontal, see reverse for bottom hole location.

COUNTY LINCOLN SEC 8 TWP 13N RGE 05E
LEASE NAME CHERRY HILLS WELL NO. 2-5H
SE 1/4 NW 1/4 NE 1/4 SW 1/4 FSL OF 1/4 SEC 2185 FWL OF 1/4 SEC 1876
ELEVATION 882' Ground 865' Latitude (if known) 35 36' 51.2" N Longitude (if known) 96 47' 52.3" W
OPERATOR NAME MONTCLAIR ENERGY, LLC OTC/OCC OPERATOR NO. 22644
ADDRESS 3509 FRENCH PARK DR. SUITE B
CITY EDMOND STATE OK ZIP 73034

SPUD DATE 7/1/2018
DRLG FINISHED DATE 7/20/2018
DATE OF WELL COMPLETION 10/5/2018
1st PROD DATE 12/12/2018
RECOMP DATE

640 Acres
W E
LOCATE WELL

COMPLETION TYPE

☒ SINGLE ZONE
☐ MULTIPLE ZONE
Application Date
COMMINGLED
Application Date
LOCATION EXCEPTION 688492 F.O.
ORDER NO.
INCREASED DENSITY
ORDER NO. 692073 CD-201802614

CASING & CEMENT (Form 1002C must be attached)

TYPE	SIZE	WEIGHT	GRADE	FEET	PSI	SAX	TOP OF CMT
CONDUCTOR							
SURFACE	9 5/8	32	J-55	183	500	130	Surface
INTERMEDIATE							
PRODUCTION	7	26	N-80	6562	1500	300	4580
LINER							

PACKER @ BRAND & TYPE PLUG @ TYPE PLUG @ TYPE
PACKER @ BRAND & TYPE PLUG @ TYPE PLUG @ TYPE

TOTAL DEPTH 10,252

COMPLETION & TEST DATA BY PRODUCING FORMATION

FORMATION HUNTON
SPACING & SPACING ORDER NUMBER 640 / 623880
CLASS: Oil, Gas, Dry, Inj, Disp, Comm Disp, Svc OIL
PERFORATED INTERVALS OPEN HOLE
6376-10252
ACID/VOLUME 15% HCl / 8000 gals
FRACTURE TREATMENT (Fluids/Prop Amounts)

Min Gas Allowable (165:10-17-7)

Gas Purchaser/Measurer

KINDER MORGAN

First Sales Date

12/12/2018

INITIAL TEST DATA

INITIAL TEST DATE 12/29/2018
OIL-BBL/DAY 49
OIL-GRAVITY (API) 45
GAS-MCF/DAY 270
GAS-OIL RATIO CU FT/BBL 5510
WATER-BBL/DAY 1070
PUMPING OR FLOWING PUMPING
INITIAL SHUT-IN PRESSURE
CHOKE SIZE
FLOW TUBING PRESSURE

AS SUBMITTED

A record of the formations drilled through, and pertinent remarks are presented on the reverse. I declare that I have knowledge of the contents of this report and am authorized by my organization to make this report, which was prepared by me or under my supervision and direction, with the data and facts stated herein to be true, correct, and complete to the best of my knowledge and belief.

SIGNATURE

ALAN STRACKE

1/28/2019

405-205-8976

3509 FRENCH PARK DR. STE B

EDMOND

NAME (PRINT OR TYPE)

OK

73034

DATE

PHONE NUMBER

ADDRESS

CITY

STATE

ZIP

ALAN.STRACKE@ATT.NET

EMAIL ADDRESS

PLEASE TYPE OR USE BLACK INK ONLY
FORMATION RECORD

Give formation names and tops, if available, or descriptions and thickness of formations drilled through. Show intervals cored or drillstem tested.

LEASE NAME CHERRY HILLS WELL NO. 2-5H

NAMES OF FORMATIONS	TOP
BARTLESVILLE	5269' (MD) 4139' (TVD)
MISSISSIPPIAN CANEY	5549' (MD) 4334' (TVD)
MAYES	5743' (MD) 4459' (TVD)
WOODFORD SHALE	6186' (MD) 4649' (TVD)
HUNTON LIME	6352' (MD) 4701' (TVD)
SYLVAN SHALE	6505' (MD) 4745' (TVD)

FOR COMMISSION USE ONLY

ITD on file ☐ YES ☐ NO

APPROVED _____ DISAPPROVED _____

2) Reject Codes _____

Were open hole logs run? _____ yes ☒ no

Date Last log was run _____

Was CO₂ encountered? _____ yes ☒ no at what depths? _____

Was H₂S encountered? _____ yes ☒ no at what depths? _____

Were unusual drilling circumstances encountered? _____ yes ☒ no
If yes, briefly explain below _____

Other remarks: *OCC - This well is an open hole completion from hole cut in 7" casing at 6376' to terminus at 10,252'.*

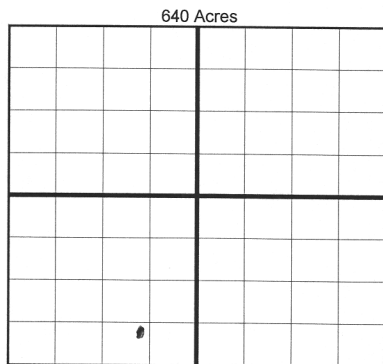

If more than three drainholes are proposed, attach a separate sheet indicating the necessary information.

Direction must be stated in degrees azimuth.
Please note, the horizontal drainhole and its end point must be located within the boundaries of the lease or spacing unit.

Directional surveys are required for all drainholes and directional wells.

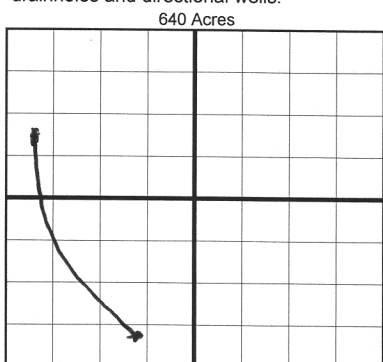

BOTTOM HOLE LOCATION FOR DIRECTIONAL HOLE

SEC 5	TWP 13N	RGE 05E	COUNTY LINCOLN
Spot Location NE 1/4 SW 1/4 SE 1/4 SW 1/4	Feet From 1/4 Sec Lines	FSL 578	FWL 1828
Measured Total Depth 6657	True Vertical Depth 4792	BHL From Lease, Unit, or Property Line: 350	

BOTTOM HOLE LOCATION FOR HORIZONTAL HOLE: (LATERALS)

Per LE order FNL 1515

SEC 5	TWP 13N	RGE 05E	COUNTY LINCOLN
Spot Location NE 1/4 NW 1/4 SW 1/4 NW 1/4	Feet From 1/4 Sec Lines	FSL 578 1142	FWL 372
Depth of Deviation 6,376	Radius of Turn 90	Direction 354 330	Total Length 3,876
Measured Total Depth 10,252	True Vertical Depth 4,624	BHL From Lease, Unit, or Property Line: 372	

LATERAL #2

SEC	TWP	RGE	COUNTY
Spot Location 1/4 1/4 1/4 1/4	Feet From 1/4 Sec Lines	FSL	FWL
Depth of Deviation	Radius of Turn	Direction	Total Length
Measured Total Depth	True Vertical Depth	BHL From Lease, Unit, or Property Line:	

LATERAL #3

SEC	TWP	RGE	COUNTY
Spot Location 1/4 1/4 1/4 1/4	Feet From 1/4 Sec Lines	FSL	FWL
Depth of Deviation	Radius of Turn	Direction	Total Length
Measured Total Depth	True Vertical Depth	BHL From Lease, Unit, or Property Line:	