

Oklahoma Corporation Commission
Oil & Gas Conservation Division
Post Office Box 52000
Oklahoma City, Oklahoma 73152-2000
Rule 165: 10-3-25

Form 1002A

API No.: 35103247460000

Completion Report

Spud Date: September 15, 2018

OTC Prod. Unit No.: 103-224701

Drilling Finished Date: September 22, 2018

1st Prod Date: March 15, 2019

Completion Date: February 08, 2019

Drill Type: STRAIGHT HOLE

Well Name: GRACE 18

Purchaser/Measurer:

Location: NOBLE 36 24N 2W
SE NW SE NE
825 FSL 1815 FWL of 1/4 SEC
Derrick Elevation: 987 Ground Elevation: 974

First Sales Date:

Operator: DONRAY PETROLEUM LLC 21690

2525 NW EXPRESSWAY STE 640
OKLAHOMA CITY, OK 73112-7230

Completion Type		Location Exception		Increased Density	
X	Single Zone	Order No		Order No	
	Multiple Zone	There are no Location Exception records to display.		There are no Increased Density records to display.	
	Commingled				

Casing and Cement							
Type	Size	Weight	Grade	Feet	PSI	SAX	Top of CMT
SURFACE	8 5/8	23		272		185	SURFACE
PRODUCTION	5.5	17		2446		185	1300

Liner								
Type	Size	Weight	Grade	Length	PSI	SAX	Top Depth	Bottom Depth
There are no Liner records to display.								

Total Depth: 2446

Packer		Plug	
Depth	Brand & Type	Depth	Plug Type
There are no Packer records to display.		2446	CIBP

Initial Test Data										
Test Date	Formation	Oil BBL/Day	Oil-Gravity (API)	Gas MCF/Day	Gas-Oil Ratio Cu FT/BBL	Water BBL/Day	Pumpin or Flowing	Initial Shut-In Pressure	Choke Size	Flow Tubing Pressure
Mar 15, 2019	HOOVER	30	40	35	1167	450	PUMPING	280		

Completion and Test Data by Producing Formation			
Formation Name: HOOVER		Code: 406HOVR	Class: OIL
Spacing Orders		Perforated Intervals	
Order No	Unit Size	From	To
NONE		2038	2084
Acid Volumes		Fracture Treatments	
750 GALLONS 12.5% HCL		650 BSW, 24,000 POUNDS 20/40 SAND	

Formation	Top
HOOVER	2020

Were open hole logs run? Yes
Date last log run: September 22, 2018

Were unusual drilling circumstances encountered? Yes
Explanation: HAD SHALLOW GAS ZONE THAT HAD TO BE SQUEEZED OFF.

Other Remarks
HAD TO WAIT ON WEATHER AND ELECTRIC IS THE REASON FOR COMPLETION DELAY.

FOR COMMISSION USE ONLY	
Status: Accepted	1142575

API NO.	10324746
OTC PROD. UNIT NO.	103224701

(PLEASE TYPE OR USE BLACK INK ONLY)

OKLAHOMA CORPORATION COMMISSION
Oil & Gas Conservation Division
Post Office Box 52000
Oklahoma City, Oklahoma 73152-2000
Rule 165:10-3-25

RECEIVED

Form 1002A
Rev. 2009

APR 12 2019

OKLAHOMA CORPORATION COMMISSION
640 Acres

☒ ORIGINAL
☐ AMENDED (Reason) _____

COMPLETION REPORT

TYPE OF DRILLING OPERATION

☒ STRAIGHT HOLE ☐ DIRECTIONAL HOLE ☐ HORIZONTAL HOLE
☐ SERVICE WELL

If directional or horizontal, see reverse for bottom hole location.

COUNTY	noble	SEC	36	TWP	24n	RGE	2w	SPUD DATE	9/15/18
LEASE NAME	grace			WELL NO.	18	DATE OF WELL COMPLETION	02/08/19	DRLG FINISHED DATE	9/22/18
se 1/4 nw 1/4 se 1/4 ne 1/4	FSL OF 1/4 SEC 825			FWL OF 1/4 SEC 1815	1st PROD DATE		3/15/19	RECOMP DATE	
ELEVATION Derrick FL	987	Ground	974	Latitude (if known)		Longitude (if known)			
OPERATOR NAME	donray petroleum llc.				OTC / OCC OPERATOR NO.	21690			
ADDRESS 2525 nw expressway #640									
CITY	okc	STATE	okla.	ZIP	73112				

LOCATE WELL

COMPLETION TYPE

<input checked="" type="checkbox"/>	SINGLE ZONE	
<input type="checkbox"/>	MULTIPLE ZONE	
<input type="checkbox"/>	Application Date	
<input type="checkbox"/>	COMINGLED	
<input type="checkbox"/>	Application Date	
<input type="checkbox"/>	LOCATION EXCEPTION	
<input type="checkbox"/>	ORDER NO.	
<input type="checkbox"/>	INCREASED DENSITY	
<input type="checkbox"/>	ORDER NO.	

CASING & CEMENT (Attach Form 1002C)

TYPE	SIZE	WEIGHT	GRADE	FEET	PSI	SAX	TOP OF CMT
CONDUCTOR							
SURFACE	8 5/8	23#		272		185	surf.
INTERMEDIATE							
PRODUCTION	5.5	17#		2446		185	1300
LINER							

PACKER @ _____ BRAND & TYPE _____ PLUG @ 2446 TYPE cibp PLUG @ _____ TYPE _____
PACKER @ _____ BRAND & TYPE _____ PLUG @ _____ TYPE _____ PLUG @ _____ TYPE _____

TOTAL DEPTH 2,446

COMPLETION & TEST DATA BY PRODUCING FORMATION

FORMATION	Hoover								
SPACING & SPACING ORDER NUMBER	none								
CLASS: Oil, Gas, Dry, Inj, Disp, Comm Disp, Svc	oil								
PERFORATED INTERVALS	2038-48								
	2080-84								
ACID/VOLUME	750 gal 12.5% hcl								
FRACTURE TREATMENT (Fluids/Prop Amounts)	650 bsw								
	24,000# 20/40 snd								

Monitor
Report to FractFocus

Min Gas Allowable (165:10-17-7)

Gas Purchaser/Measurer

☐

OR

First Sales Date

Oil Allowable (165:10-13-3)

INITIAL TEST DATA

INITIAL TEST DATE	3/15/2019						
OIL-BBL/DAY	30 bpd						
OIL-GRAVITY (API)	40						
GAS-MCF/DAY	35 mcfpd						
GAS-OIL RATIO CU FT/BBL	1167						
WATER-BBL/DAY	450 bpd						
PUMPING OR FLOWING	pump						
INITIAL SHUT-IN PRESSURE	280#						
CHOKE SIZE							
FLOW TUBING PRESSURE							

AS SUBMITTED

A record of the formations drilled through, and pertinent remarks are presented on the reverse. I declare that I have knowledge of the contents of this report and am authorized by my organization to make this report, which was prepared by me or under my supervision and direction, with the data and facts stated herein to be true, correct, and complete to the best of my knowledge and belief.

SIGNATURE	ray corbitt jr	DATE	4/9/2019	PHONE NUMBER	405 418 4348
ADDRESS	2525 nw expressway #640	CITY	okc	STATE	ok
		ZIP	73112	EMAIL ADDRESS	ray@donraypetroleum.com

PLEASE TYPE OR USE BLACK INK ONLY
FORMATION RECORD

Give formation names and tops, if available, or descriptions and thickness of formations drilled through. Show intervals cored or drillstem tested.

NAMES OF FORMATIONS	TOP
hoover	2,020

LEASE NAME grace WELL NO. 18

FOR COMMISSION USE ONLY	
ITD on file <input type="checkbox"/> YES <input type="checkbox"/> NO	
APPROVED _____	DISAPPROVED _____
2) Reject Codes	

Were open hole logs run?	<input checked="" type="checkbox"/> yes <input type="checkbox"/> no
Date Last log was run	<u>9/22/2018</u>
Was CO ₂ encountered?	<input type="checkbox"/> yes <input checked="" type="checkbox"/> no at what depths? _____
Was H ₂ S encountered?	<input type="checkbox"/> yes <input checked="" type="checkbox"/> no at what depths? _____
Were unusual drilling circumstances encountered?	<input checked="" type="checkbox"/> yes <input type="checkbox"/> no
If yes, briefly explain below	

Other remarks: had shallow gas zone that had to be squeezed off had to wait on weather and electric is the reason for completion delay

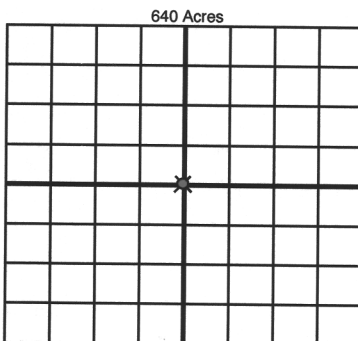

If more than three drainholes are proposed, attach a separate sheet indicating the necessary information.

Direction must be stated in degrees azimuth. Please note, the horizontal drainhole and its end point must be located within the boundaries of the lease or spacing unit.

Directional surveys are required for all drainholes and directional wells.

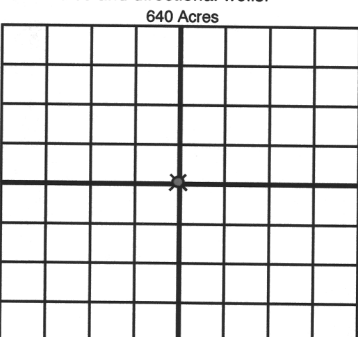

BOTTOM HOLE LOCATION FOR DIRECTIONAL HOLE

SEC	TWP	RGE	COUNTY
Spot Location			
1/4	1/4	1/4	1/4
Measured Total Depth		True Vertical Depth	Feet From 1/4 Sec Lines FSL _____ FWL _____
BHL From Lease, Unit, or Property Line: _____			

BOTTOM HOLE LOCATION FOR HORIZONTAL HOLE: (LATERALS)

SEC	TWP	RGE	COUNTY
Spot Location			
1/4	1/4	1/4	1/4
Depth of Deviation		Radius of Turn	Direction
Measured Total Depth		True Vertical Depth	Total Length
BHL From Lease, Unit, or Property Line: _____			

LATERAL #2

SEC	TWP	RGE	COUNTY
Spot Location			
1/4	1/4	1/4	1/4
Depth of Deviation		Radius of Turn	Direction
Measured Total Depth		True Vertical Depth	Total Length
BHL From Lease, Unit, or Property Line: _____			

LATERAL #3

SEC	TWP	RGE	COUNTY
Spot Location			
1/4	1/4	1/4	1/4
Depth of Deviation		Radius of Turn	Direction
Measured Total Depth		True Vertical Depth	Total Length
BHL From Lease, Unit, or Property Line: _____			