

Oklahoma Corporation Commission  
Oil & Gas Conservation Division  
Post Office Box 52000  
Oklahoma City, Oklahoma 73152-2000  
Rule 165: 10-3-25

Form 1002A

API No.: 35043234720002

**Completion Report**

Spud Date: September 05, 2016

OTC Prod. Unit No.: 043-218167

Drilling Finished Date: October 30, 2016

**Amended**

1st Prod Date: November 30, 2016

Amend Reason: REMOVED PACKER AND RECLASSIFY AS GAS WELL

Completion Date: November 20, 2016

Recomplete Date: August 12, 2018

**Drill Type: HORIZONTAL HOLE**

Well Name: STEPHEN 26-18-17 1H

Purchaser/Measurer:

Location: DEWEY 26 18N 17W  
NW SE SE SW  
388 FSL 2021 FWL of 1/4 SEC  
Derrick Elevation: 1875 Ground Elevation: 1850

First Sales Date:

Operator: CHESAPEAKE OPERATING LLC 17441  
PO BOX 18496  
6100 N WESTERN AVE  
OKLAHOMA CITY, OK 73154-0496

Completion Type		Location Exception		Increased Density	
X	Single Zone	Order No		Order No	
	Multiple Zone	660153		654751	
	Commingled				

Casing and Cement							
Type	Size	Weight	Grade	Feet	PSI	SAX	Top of CMT
SURFACE	9 5/8	36	J-55	1536		757	SURFACE
PRODUCTION	7	29	P-110EC	12157		777	6500

Liner								
Type	Size	Weight	Grade	Length	PSI	SAX	Top Depth	Bottom Depth
LINER	4 1/2	13.5	P-110EC	5602	0	503	12032	17634

**Total Depth: 17635**

Packer	
Depth	Brand & Type
There are no Packer records to display.	

Plug	
Depth	Plug Type
There are no Plug records to display.	

Initial Test Data										
Test Date	Formation	Oil BBL/Day	Oil-Gravity (API)	Gas MCF/Day	Gas-Oil Ratio Cu FT/BBL	Water BBL/Day	Pumpin or Flowing	Initial Shut-In Pressure	Choke Size	Flow Tubing Pressure
Mar 16, 2019	MERAMEC-OSAGE	5		1404	280800	75	ARTIFICIA			129

Completion and Test Data by Producing Formation			
Formation Name: MERAMEC-OSAGE		Code: 353MRMOG	Class: GAS
<b>Spacing Orders</b>		<b>Perforated Intervals</b>	
<b>Order No</b>	<b>Unit Size</b>	<b>From</b>	<b>To</b>
443925	640	12590	17515
<b>Acid Volumes</b>		<b>Fracture Treatments</b>	
21,700 GALLONS ACID		293,185 BARRELS FLUIDS, 13,588,160 POUNDS PROPPANT	

Formation	Top
MERAMEC - OSAGE	12579

Were open hole logs run? No

Date last log run:

Were unusual drilling circumstances encountered? No

Explanation:

Other Remarks
There are no Other Remarks.

Lateral Holes
Sec: 26 TWP: 18N RGE: 17W County: DEWEY
NE NW NW NW
134 FNL 649 FWL of 1/4 SEC
Depth of Deviation: 12325 Radius of Turn: 119 Direction: 3 Total Length: 5056
Measured Total Depth: 17635 True Vertical Depth: 12444 End Pt. Location From Release, Unit or Property Line: 134

FOR COMMISSION USE ONLY	
Status: Accepted	1142606

API NO. 043-23472  
OTC PROD.  
UNIT NO. 043-218167

PLEASE TYPE OR USE BLACK INK ONLY

NOTE:

Attach copy of original 1002A if recompletion or reentry.

OKLAHOMA CORPORATION COMMISSION

Oil & Gas Conservation Division

Post Office Box 52000

Oklahoma City, Oklahoma 73152-2000

Rule 165:10-3-25

Form 1002A

Rev. 2009

RECEIVED

APR 12 2019

Oklahoma Corporation  
Commission  
640 Acres

ORIGINAL  
AMENDED

Reason Amended

Removed packer & reclassify as gas well

TYPE OF DRILLING OPERATION

STRAIGHT HOLE ☐ DIRECTIONAL HOLE ☐ HORIZONTAL HOLE ☒

If directional or horizontal, see reverse for bottom hole location.

COUNTY Dewey SEC 26 TWP 18N RGE 17W

LEASE NAME Stephen 26-18-17

SHL NW 1/4 SE 1/4 SE 1/4 SW 1/4 FSL 388 FWL OF 1/4 SEC 2,021

ELEVATION Derrick Fl 1,875 Ground 1,850 Latitude (if Known)

OPERATOR NAME CHESAPEAKE OPERATING, L.L.C.

OTC/OCC OPERATOR NO. 17441

ADDRESS P.O. BOX 18496

CITY OKLAHOMA CITY

STATE OK

ZIP 73154

COMPLETION REPORT

SPUD DATE 9/5/2016

DRLG FINISHED DATE 10/30/2016

DATE OF WELL COMPLETION 11/20/2016

1ST PROD DATE 11/30/2016

RECOMP DATE 8/12/2018

Longitude (if Known)

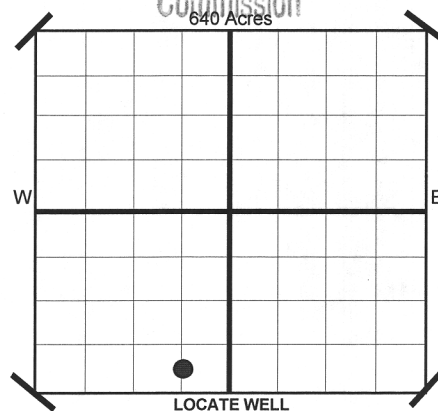

COMPLETION TYPE

<input checked="" type="checkbox"/>	SINGLE ZONE
<input type="checkbox"/>	MULTIPLE ZONE
<input type="checkbox"/>	Application Date
<input type="checkbox"/>	COMMINGLED
<input type="checkbox"/>	Application Date
LOCATION EXCEPTION ORDER NO. 660153	
INCREASED DENSITY ORDER NO. 654751	

CASING & CEMENT (Form 1002C must be attached)

TYPE	SIZE	WEIGHT	GRADE	FEET	PSI	SAX	TOP
CONDUCTOR							
SURFACE	9-5/8"	36#	J-55	1,536		757	Surface
INTERMEDIATE							
PRODUCTION	7"	29#	P-110EC	12,157		777	6,500
LINER	4-1/2"	13.5#	P-110EC	12,032-17,634		503	12,032
TOTAL DEPTH							17,635

PACKER @ BRAND & TYPE  
PACKER @ BRAND & TYPE

PLUG @ TYPE  
PLUG @ TYPE  
PLUG @ TYPE  
PLUG @ TYPE

COMPLETION & TEST DATA BY PRODUCING FORMATION

FORMATION	Meramec-Osage
SPACING & SPACING ORDER NUMBER	640 443925
CLASS: Oil, Gas, Dry, Inj. Disp, Comm Disp, Svc	Gas
PERFORATED INTERVALS	12,590 17,515
ACID/VOLUME	21,700 gals acid
FRACTURE TREATMENT (Fluids/Prop Amounts)	293,185 bbls fluids 13,588,160# proppant

Minimum Gas Allowable

(165:10-17-7)

Gas Purchaser/Measurer

OR

1st Sales Date

INITIAL TEST DATA

Oil Allowable

(165:10-13-3)

INITIAL TEST DATE	3/16/2019
OIL-BBL/DAY	5
OIL-GRAVITY ( API)	
GAS-MCF/DAY	1,404
GAS-OIL RATIO CU FT/BBL	280,800
WATER-BBL/DAY	75
PUMPING OR FLOWING	Artificial Lift
INITIAL SHUT-IN PRESSURE	
CHOKE SIZE	
FLOW TUBING PRESSURE	129

AS SUBMITTED

A record of the formations drilled through, and pertinent remarks are presented on the reverse. I declare that I have knowledge of the contents of this report and am authorized by my organization to make this report, which was prepared by me or under my supervision and direction, with the data and facts stated herein to be true, correct, and complete to the best of my knowledge and belief.

Juanita Cooper	JUANITA COOPER - REGULATORY SPECIALIST	4/11/2019	405-848-8000
SIGNATURE	NAME (PRINT OR TYPE)	DATE	PHONE NUMBER
P.O. BOX 18496	OKLAHOMA CITY	OK	73154
ADDRESS	CITY	STATE	ZIP
		juanita.cooper@chk.com	
		EMAIL ADDRESS	

PLEASE TYPE OR USE BLACK INK ONLY  
FORMATION RECORD

Give formation names and tops, if available, or descriptions and thickness of formations drilled through. Show intervals cored or drillstem tested.

LEASE NAME Stephen 26-18-17

WELL NO. 1H

NAMES OF FORMATIONS	TOP
Meramec-Osage	12,579

FOR COMMISSION USE ONLY	
ITD on file <input type="checkbox"/> YES <input type="checkbox"/> NO	
APPROVED _____	DISAPPROVED _____
2) Reject Codes	
_____	
_____	
_____	
_____	

Were open hole logs run?	yes	<input checked="" type="checkbox"/> no
Date Last log was run	N/A	
Was CO <sub>2</sub> encountered?	yes	<input checked="" type="checkbox"/> no at what depths?
Was H <sub>2</sub> S encountered?	yes	<input checked="" type="checkbox"/> no at what depths?
Were unusual drilling circumstances encountered?	yes	<input checked="" type="checkbox"/> no
If yes, briefly explain.		

Other remarks:

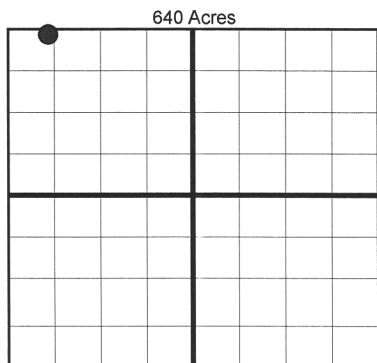

If more than three drainholes are proposed, attach a separate sheet indicating the necessary information.

Direction must be stated in degrees azimuth.  
Please note, the horizontal drainhole and its end point must be located within the boundaries of the lease or spacing unit.

**Directional surveys are required for all drainholes and directional wells.**  
640 Acres

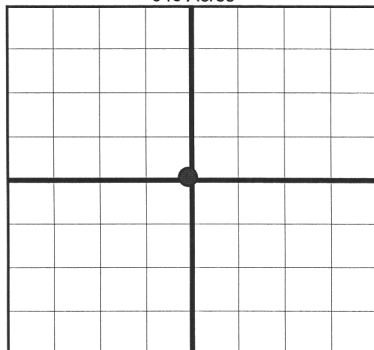

**BOTTOM HOLE LOCATION FOR DIRECTIONAL HOLE**

SEC	TWP	RGE	COUNTY
Spot Location	1/4	1/4	1/4
Measured Total Depth	True Vertical Depth	BHL From Lease, Unit, or Property Line:	

**BOTTOM HOLE LOCATION FOR HORIZONTAL HOLE: (LATERALS)**

SEC	TWP	RGE	COUNTY
26	18N	17W	Dewey
Spot Location	NE 1/4	NW 1/4	NW 1/4
Depth of Deviation	12,325	Radius of Turn	119
Measured Total Depth	17,635	True Vertical Depth	12,444
Feet From 1/4 Sec Lines		FSL	134
Direction		Total Length	5,056
BHL From Lease, Unit, or Property Line:		134	

**LATERAL #2**

SEC	TWP	RGE	COUNTY
Spot Location	1/4	1/4	1/4
Depth of Deviation	Radius of Turn	Direction	Total Length
Measured Total Depth	True Vertical Depth	BHL From Lease, Unit, or Property Line:	

**LATERAL #3**

SEC	TWP	RGE	COUNTY
Spot Location	1/4	1/4	1/4
Depth of Deviation	Radius of Turn	Direction	Total Length
Measured Total Depth	True Vertical Depth	BHL From Lease, Unit, or Property Line:	

4/12/19  
Oklahoma Corporation Commission  
Oil & Gas Conservation Division  
Post Office Box 52000  
Oklahoma City, Oklahoma 73152-2000  
Rule 165: 10-3-25

Form 1002A

**1002A**  
**Addendum**

API No.: 0043234720002

**Completion Report**

Spud Date: September 05, 2016

OTC Prod. Unit No.: 043-218167 -0-0000

Drilling Finished Date: October 30, 2016

**Amended**

1st Prod Date: November 30, 2016

Amend Reason: REMOVED PACKER AND RECLASSIFY AS GAS WELL

Completion Date: November 20, 2016

Recomplete Date: August 12, 2018

**Drill Type:** HORIZONTAL HOLE

**Well Name:** STEPHEN 26-18-17 1H

A: 218167

I

**Purchaser/Measurer:**

**Location:** DEWEY 26 18N 17W  
NW SE SE SW  
388 FSL 2021 FWL of 1/4 SEC  
Derrick Elevation: 1875 Ground Elevation: 1850

**First Sales Date:**

**Operator:** CHESAPEAKE OPERATING LLC 17441  
PO BOX 18496  
6100 N WESTERN AVE  
OKLAHOMA CITY, OK 73154-0496

Completion Type		Location Exception		Increased Density	
X	Single Zone	Order No		Order No	
	Multiple Zone	660153		654751	
	Commingled				

Casing and Cement							
Type	Size	Weight	Grade	Feet	PSI	SAX	Top of CMT
SURFACE	9 5/8	36	J-55	1536		757	SURFACE
PRODUCTION	7	29	P-110EC	12157		777	6500

Liner								
Type	Size	Weight	Grade	Length	PSI	SAX	Top Depth	Bottom Depth
LINER	4 1/2	13.5	P-110EC	5602	0	503	12032	17634

**Total Depth: 17635**

Packer	
Depth	Brand & Type
There are no Packer records to display.	

Plug	
Depth	Plug Type
There are no Plug records to display.	

Initial Test Data										
Test Date	Formation	Oil BBL/Day	Oil-Gravity (API)	Gas MCF/Day	Gas-Oil Ratio Cu FT/BBL	Water BBL/Day	Pumpin or Flowing	Initial Shut-In Pressure	Choke Size	Flow Tubing Pressure
Mar 16, 2019	MERAMEC-OSAGE	5		1404	280800	75	ARTIFICIA			129

May 23, 2019

1 of 2  
AR

EC

3/16/19

353 MR MOG

1 XMT- AA LIA

# Completion and Test Data by Producing Formation

Formation Name: MERAMEC-OSAGE

Code: 353MRMOG

Class: GAS

## Spacing Orders

Order No	Unit Size
443925 780	640 (V)

## Perforated Intervals

From	To
12590	17515

## Acid Volumes

21,700 GALLONS ACID
---------------------

## Fracture Treatments

293,185 BARRELS FLUIDS, 13,588,160 POUNDS PROPPANT
--

Formation	Top
MERAMEC - OSAGE	12579

Were open hole logs run? No

Date last log run:

Were unusual drilling circumstances encountered? No

Explanation:

## Other Remarks

There are no Other Remarks.

## Lateral Holes

Sec: 26 TWP: 18N RGE: 17W County: DEWEY

NE NW NW NW

134 FNL 649 FWL of 1/4 SEC

Depth of Deviation: 12325 Radius of Turn: 119 Direction: 3 Total Length: 5056

Measured Total Depth: 17635 True Vertical Depth: 12444 End Pt. Location From Release, Unit or Property Line: 134

## FOR COMMISSION USE ONLY

1142606

Status: Accepted