

Oklahoma Corporation Commission  
Oil & Gas Conservation Division  
Post Office Box 52000  
Oklahoma City, Oklahoma 73152-2000  
Rule 165: 10-3-25

Form 1002A

API No.: 35137276120000

**Completion Report**

Spud Date: September 27, 2020

OTC Prod. Unit No.:

Drilling Finished Date: October 05, 2020

1st Prod Date: November 28, 2020

Completion Date: November 27, 2020

**Drill Type: STRAIGHT HOLE**

Well Name: JONES QUINN 23

Purchaser/Measurer: ENERWEST TRADING

Location: STEPHENS 23 1S 5W  
SE NW SW SE  
750 FSL 640 FWL of 1/4 SEC  
Derrick Elevation: 0 Ground Elevation: 1121

First Sales Date:

Operator: SOUTHERLAND JOE DON dba TAYLOR OIL CO 19583  
PO BOX 188  
RR 2 BOX 232 C (DUNCAN)  
VELMA, OK 73491-0188

| Completion Type |               | Location Exception                                  |  | Increased Density                                  |  |
|-----------------|---------------|---|--|--|--|
| X               | Single Zone   | Order No  |  | Order No   |  |
|                 | Multiple Zone | There are no Location Exception records to display. |  | There are no Increased Density records to display. |  |
|                 | Commingled    |   |  |  |  |

| Casing and Cement |      |        |       |      |     |     |            |
|-------------------|------|--------|-------|------|-----|-----|------------|
| Type              | Size | Weight | Grade | Feet | PSI | SAX | Top of CMT |
| PRODUCTION        | 5.5  | 15.5   |       | 962  |     | 140 | SURFACE    |

| Liner                                  |      |        |       |        |     |     |           |              |
|--|------|--------|-------|--------|-----|-----|-----------|--------------|
| Type                                   | Size | Weight | Grade | Length | PSI | SAX | Top Depth | Bottom Depth |
| There are no Liner records to display. |      |        |       |        |     |     |           |              |

**Total Depth: 970**

| Packer                                  |              | Plug                                  |           |
|---|--------------|---------------------------------------|-----------|
| Depth                                   | Brand & Type | Depth                                 | Plug Type |
| There are no Packer records to display. |              | There are no Plug records to display. |           |

| Initial Test Data |           |             |                   |             |                         |               |                   |                          |            |                      |
|-------------------|-----------|-------------|-------------------|-------------|-------------------------|---------------|-------------------|--------------------------|------------|----------------------|
| Test Date         | Formation | Oil BBL/Day | Oil-Gravity (API) | Gas MCF/Day | Gas-Oil Ratio Cu FT/BBL | Water BBL/Day | Pumpin or Flowing | Initial Shut-In Pressure | Choke Size | Flow Tubing Pressure |
| Nov 29, 2020      | PERMIAN   | 8           | 27                |             |                         | 30            | PUMPING           |                          |            |                      |

| Completion and Test Data by Producing Formation |  |  |  |  |  |  |  |  |  |  |
|---|--|--|--|--|--|--|--|--|--|--|
|---|--|--|--|--|--|--|--|--|--|--|

Formation Name: PERMIAN

Code: 459PRMN

Class: OIL

**Spacing Orders**

| Order No   | Unit Size |
|------------|-----------|
| NO SPACING |           |

**Perforated Intervals**

| From | To  |
|------|-----|
| 500  | 512 |
| 534  | 552 |
| 566  | 580 |
| 624  | 638 |
| 640  | 644 |
| 651  | 662 |
| 672  | 680 |
| 698  | 716 |

**Acid Volumes**

|      |
|------|
| NONE |
|------|

**Fracture Treatments**

|  |
|--|
| SLICKWATER FRAC, CLAYPLEX 650, PLEXSLICK 957 |
|--|

| Formation              | Top |
|------------------------|-----|
| PERMIAN ( TO SURFACE ) | 0   |

Were open hole logs run? Yes

Date last log run: October 05, 2020

Were unusual drilling circumstances encountered? No

Explanation:

**Other Remarks**

There are no Other Remarks.

**FOR COMMISSION USE ONLY**

Status: Accepted

1145970

137-27612

API NO. 35-  
OTC PROD. UNIT NO.

Oil and Gas Conservation Division  
P.O. Box 52000  
Oklahoma City, OK 73152-2000  
405-522-0577  
OCCCentralProcessing@OCC.OK.GOV

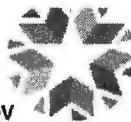

OKLAHOMA  
Corporation  
Commission

Submitted  
12-18-2020  
DKN

Form 1002A  
Rev. 2020

☒ ORIGINAL  
☐ AMENDED (Reason)

Rule 165:10-3-25

## COMPLETION REPORT

## TYPE OF DRILLING OPERATION

☒ STRAIGHT HOLE ☐ DIRECTIONAL HOLE ☐ HORIZONTAL HOLE  
☐ SERVICE WELL

If directional or horizontal, see reverse for bottom hole location.

COUNTY Stephens SEC 23 TWP 1S RGE 5W  
LEASE NAME Jones Quinn WELL NO. 23 1st PROD DATE 11-28-2020  
SE 1/4 NW 1/4 SW 1/4 SE 1/4 FSL 750 FWL 640 RECOMP DATE  
ELEVATION Danick FL Ground 1121' Latitude 34° 27' 3.5" Longitude 97° 41' 28.4"  
OPERATOR NAME Taylor Oil Company OTC / OCC OPERATOR NO. 19583  
ADDRESS PO Box 244  
CITY Velma STATE OK ZIP 73491

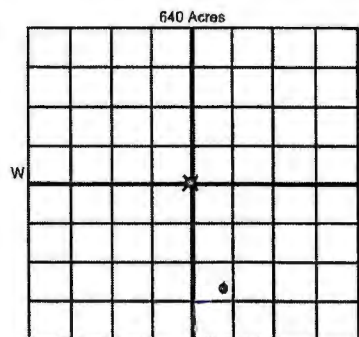
SPUD DATE 9-27-2020DRLG FINISHED DATE 10-5-2020DATE OF WELL COMPLETION 11-27-2020

## COMPLETION TYPE

☒ SINGLE ZONE  
☐ MULTIPLE ZONE  
Application Date  
☐ COMMINGLED  
Application Date  
LOCATION EXCEPTION ORDER NO.  
MULTIUNIT ORDER NO.  
INCREASED DENSITY ORDER NO.

## CASING &amp; CEMENT (Attach Form 1002C)

| TYPE         | SIZE | WEIGHT | GRADE | FEET | PSI | SAX | TOP OF CMT |
|--------------|------|--------|-------|------|-----|-----|------------|
| CONDUCTOR    |      |        |       |      |     |     |            |
| SURFACE      |      |        |       |      |     |     |            |
| INTERMEDIATE |      |        |       |      |     |     |            |
| PRODUCTION   | 5.5  | 15.5   |       | 962  |     | 140 | Surface    |
| LINER        |      |        |       |      |     |     |            |

PACKER @ \_\_\_\_\_ BRAND & TYPE \_\_\_\_\_ PLUG @ \_\_\_\_\_ TYPE \_\_\_\_\_ PLUG @ \_\_\_\_\_ TYPE \_\_\_\_\_ TOTAL DEPTH 970 Per open hole 109  
PACKER @ \_\_\_\_\_ BRAND & TYPE \_\_\_\_\_ PLUG @ \_\_\_\_\_ TYPE \_\_\_\_\_ PLUG @ \_\_\_\_\_ TYPE \_\_\_\_\_  
COMPLETION & TEST DATA BY PRODUCING FORMATION 459 PRMN

|   |   |                |                |  |  |  |
|---|---|----------------|----------------|--|--|--|
| FORMATION                                       | <u>Permian</u>  |                |                |  |  |  |
| SPACING & SPACING ORDER NUMBER                  | <u>no spacing</u>   |                |                |  |  |  |
| CLASS: Oil, Gas, Dry, Inj, Disp, Comm Disp, Svc | <u>Oil</u>  |                |                |  |  |  |
| PERFORATED INTERVALS                            | <u>500-512</u>  | <u>624-638</u> | <u>672-680</u> |  |  |  |
|   | <u>534-552</u>  | <u>640-644</u> | <u>698-716</u> |  |  |  |
|   | <u>566-580</u>  | <u>651-662</u> |                |  |  |  |
| ACID/VOLUME                                     | <u>no acid</u>  |                |                |  |  |  |
| FRACTURE TREATMENT (Fluids/Prop Amounts)        | <u>Slickwater frac</u><br><u>clayplex 650</u><br><u>PlexSlick 951</u> |                |                |  |  |  |

Min Gas Allowable (165:10-17-7)



OR

Oil Allowable (165:10-13-3)

Purchaser/Measurer

First Sales Date

Enerwest Trading

## INITIAL TEST DATA

|                          |                   |  |  |  |  |  |
|--------------------------|-------------------|--|--|--|--|--|
| INITIAL TEST DATE        | <u>11-29-2020</u> |  |  |  |  |  |
| OIL-BBL/DAY              | <u>8</u>          |  |  |  |  |  |
| OIL-GRAVITY (API)        | <u>27</u>         |  |  |  |  |  |
| GAS-MCF/DAY              |                   |  |  |  |  |  |
| GAS-OIL RATIO CU FT/BBL  |                   |  |  |  |  |  |
| WATER-BBL/DAY            | <u>30</u>         |  |  |  |  |  |
| PUMPING OR FLOWING       | <u>pumping</u>    |  |  |  |  |  |
| INITIAL SHUT-IN PRESSURE |                   |  |  |  |  |  |
| CHOKE SIZE               |                   |  |  |  |  |  |
| FLOW TUBING PRESSURE     |                   |  |  |  |  |  |

A record of the formations drilled through, and pertinent remarks are presented on the reverse. I declare that I have knowledge of the contents of this report and am authorized by my organization to make this report, which was prepared by me or under my supervision and direction, with the data and facts stated herein to be true, correct, and complete to the best of my knowledge and belief.

SIGNATURE Joe Southerland DATE 12-10-2020 PHONE NUMBER 580.251.1338  
ADDRESS PO Box 244 CITY Velma STATE OK ZIP 73491 EMAIL ADDRESS southerlandinvestments@gmail.com

PLEASE TYPE OR USE BLACK INK ONLY  
FORMATION RECORD

Give formation names and tops, if available, or descriptions and thickness of formations drilled through. Show intervals cored or drillstem tested.

LEASE NAME

Jones Quinn

WELL NO. 23

| NAMES OF FORMATIONS | TOP |
|---------------------|-----|
| Permian             |     |

FOR COMMISSION USE ONLY

ITD on file ☐ YES ☐ NO

APPROVED \_\_\_\_\_ DISAPPROVED \_\_\_\_\_

2) Reject Codes \_\_\_\_\_

Were open hole logs run? ☒ yes ☐ no

Date Last log was run 10-5-2020

Was CO<sub>2</sub> encountered? ☐ yes ☒ no at what depths? \_\_\_\_\_

Was H<sub>2</sub>S encountered? ☐ yes ☒ no at what depths? \_\_\_\_\_

Were unusual drilling circumstances encountered? ☐ yes ☒ no

If yes, briefly explain below \_\_\_\_\_

Other remarks:

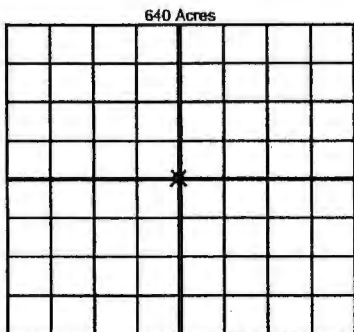

If more than three drainholes are proposed, attach a separate sheet indicating this necessary information.

Direction must be stated in degrees azimuth. Please note, the horizontal drainhole and its end point must be located within the boundaries of the lease or spacing unit.

Directional surveys are required for all drainholes and directional wells

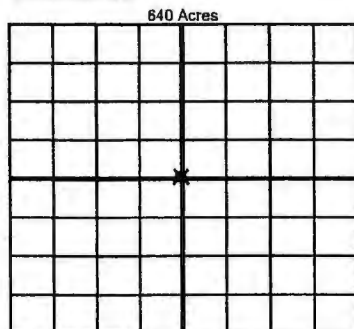

BOTTOM HOLE LOCATION FOR DIRECTIONAL HOLE

|                      |     |                     |   |
|----------------------|-----|---------------------|---|
| SEC                  | TWP | RGE                 | COUNTY                                  |
| 1/4                  | 1/4 | 1/4                 | 1/4                                     |
| Measured Total Depth |     | True Vertical Depth | BHL From Lease, Unit, or Property Line: |

BOTTOM HOLE LOCATION FOR HORIZONTAL HOLE: (LATERALS)

LATERAL #1

|                      |     |                     |   |
|----------------------|-----|---------------------|---|
| SEC                  | TWP | RGE                 | COUNTY                                  |
| 1/4                  | 1/4 | 1/4                 | 1/4                                     |
| Depth of Deviation   |     | Radius of Turn      | Direction                               |
| Measured Total Depth |     | True Vertical Depth | BHL From Lease, Unit, or Property Line: |

LATERAL #2

|                      |     |                     |   |
|----------------------|-----|---------------------|---|
| SEC                  | TWP | RGE                 | COUNTY                                  |
| 1/4                  | 1/4 | 1/4                 | 1/4                                     |
| Depth of Deviation   |     | Radius of Turn      | Direction                               |
| Measured Total Depth |     | True Vertical Depth | BHL From Lease, Unit, or Property Line: |

LATERAL #3

|                      |     |                     |   |
|----------------------|-----|---------------------|---|
| SEC                  | TWP | RGE                 | COUNTY                                  |
| 1/4                  | 1/4 | 1/4                 | 1/4                                     |
| Depth of Deviation   |     | Radius of Turn      | Direction                               |
| Measured Total Depth |     | True Vertical Depth | BHL From Lease, Unit, or Property Line: |