

Oklahoma Corporation Commission
Oil & Gas Conservation Division
Post Office Box 52000
Oklahoma City, Oklahoma 73152-2000
Rule 165: 10-3-25

Form 1002A

API No.: 35015233090000

Completion Report

Spud Date: March 17, 2019

OTC Prod. Unit No.: 015-227089-0-0000

Drilling Finished Date: May 05, 2019

1st Prod Date: September 30, 2020

Completion Date: January 15, 2021

Drill Type: HORIZONTAL HOLE

Min Gas Allowable: Yes

Well Name: BAKER 5-8 1WH

Purchaser/Measurer: SUNOCO PARTNERS
MARKETING

First Sales Date: 11/10/2020

Location: CADD0 5 6N 12W
C S2 S2 NW
2310 FNL 1320 FWL of 1/4 SEC
Latitude: 35.022846923 Longitude: -98.493063253
Derrick Elevation: 1371 Ground Elevation: 1349

Operator: KING ENERGY LLC 19617

7025 N ROBINSON AVE
OKLAHOMA CITY, OK 73116-9044

Completion Type		Location Exception		Increased Density	
X	Single Zone	Order No		Order No	
	Multiple Zone	705834		There are no Increased Density records to display.	
	Commingled				

Casing and Cement								
Type		Size	Weight	Grade	Feet	PSI	SAX	Top of CMT
SURFACE		13 3/8	54.5	J55	1515	900	890	SURFACE
PRODUCTION		7	29	P110	9600	1500	607	6400

Liner								
Type	Size	Weight	Grade	Length	PSI	SAX	Top Depth	Bottom Depth
LINER	4 1/2	13.5	P110	5744	1625	330	8791	14535

Total Depth: 14537

Packer		Plug	
Depth	Brand & Type	Depth	Plug Type
There are no Packer records to display.		There are no Plug records to display.	

Initial Test Data

Test Date	Formation	Oil BBL/Day	Oil-Gravity (API)	Gas MCF/Day	Gas-Oil Ratio Cu FT/BBL	Water BBL/Day	Pumpin or Flowing	Initial Shut-In Pressure	Choke Size	Flow Tubing Pressure
Oct 31, 2020	WOODFORD	78	32	498	6385	1245	PUMPING	840	64/64	

Completion and Test Data by Producing Formation

Formation Name: WOODFORD

Code: 319WDFD

Class: OIL

Spacing Orders

Order No	Unit Size
690616	640
697013	640 MODIFY
697077	640 MODIFY
705833	MULTIUNIT

Perforated Intervals

From	To
9651	14439

Acid Volumes

40,000 GALS 15%

Fracture Treatments

213,721 BBLS WATER & 8,735,480 LBS PROPPANT

Formation	Top
SYCAMORE	7799
WOODFORD	8955
HUNTON	9599

Were open hole logs run? Yes

Date last log run: April 01, 2020

Were unusual drilling circumstances encountered? No

Explanation:

Other Remarks

SHUT IN. WAITING ON PIPELINE EVALUATION.

Lateral Holes

Sec: 8 TWP: 6N RGE: 12W County: CADDO

SW SW SE NW

2537 FNL 1536 FWL of 1/4 SEC

Depth of Deviation: 8504 Radius of Turn: 710 Direction: 196 Total Length: 4917

Measured Total Depth: 14537 True Vertical Depth: 8577 End Pt. Location From Release, Unit or Property Line: 1536

FOR COMMISSION USE ONLY

Status: Accepted

1146198

API NO. 35-01523309
OTC PROD. UNIT NO. 015227089

Oil and Gas Conservation Division
P.O. Box 52000
Oklahoma City, OK 73152-2000
405-522-0577
OCCentralProcessing@OCC.OK.GOV



OKLAHOMA
Corporation
Commission

Form 1002A
Rev. 2020



ORIGINAL
AMENDED (Reason)

Rule 165:10-3-25

COMPLETION REPORT

TYPE OF DRILLING OPERATION

☐ STRAIGHT HOLE ☐ DIRECTIONAL HOLE ☒ HORIZONTAL HOLE
☐ SERVICE WELL

If directional or horizontal, see reverse for bottom hole location.

COUNTY	Caddo	SEC	5	TWP	6N	RGE	12W
LEASE NAME	Baker			WELL NO.	5-8 1WH		
C	1/4	S/2	1/4	NW	1/4	2310'	1320'
ELEVATION	1371'	Ground	1349'	Latitude	35.022846923N		
Derrick FL				Longitude	98.493063253W		
OPERATOR NAME	King Energy LLC			OTC / OCC OPERATOR NO.	19617		
ADDRESS	7025 N. Robinson Ave.						
CITY	Oklahoma City	STATE	OK	ZIP	73116		

SPUD DATE 3/17/19
DRLG FINISHED DATE 5/5/19
DATE OF WELL COMPLETION 1/15/21
1st PROD DATE 9/30/20
RECOMP DATE

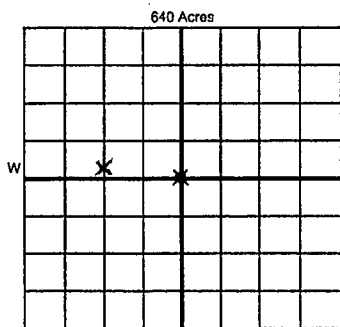

LOCATE WELL

COMPLETION TYPE

<input checked="" type="radio"/> SINGLE ZONE	
<input type="radio"/> MULTIPLE ZONE	
<input type="radio"/> COMMINGLED	
LOCATION EXCEPTION ORDER NO.	705834 FD
MULTIUNIT ORDER NO.	-705833 FD
INCREASED DENSITY ORDER NO.	

CASING & CEMENT (Attach Form 1002C)

TYPE	SIZE	WEIGHT	GRADE	FEET	PSI	SAX	TOP OF CMT
CONDUCTOR							
SURFACE	13 3/8	54.5#	J55	1515	900	890	surface
INTERMEDIATE	7"	29#	P110	9600	1500	3270'	6400'
PRODUCTION	4 1/2	13.5#	P110	1453	1625	530'	6450'
LINER				8791-14535		530'	

PACKER @ BRAND & TYPE PLUG @ TYPE PLUG @ TYPE
PACKER @ BRAND & TYPE PLUG @ TYPE PLUG @ TYPE

TOTAL DEPTH 14532

COMPLETION & TEST DATA BY PRODUCING FORMATION

FORMATION	Woodford					Monitor
SPACING & SPACING	640 ac; 690616; 697077; 697013	Clarity/Med. Fy				Report to FracFocus
ORDER NUMBER						
CLASS: Oil, Gas, Dry, Inj, Disp, Comm Disp, Svc	Oil					
PERFORATED INTERVALS	9651'-14428' 39'					
ACID/VOLUME	40000 gal 15%					
FRACTURE TREATMENT (Fluids/Prop Amounts)	213721 bbls wtr, 8,735,480 lbs proppant					

Min Gas Allowable (165:10-17-7)
OR
Oil Allowable (165:10-13-3)

Purchaser/Measurer
First Sales Date

Sunoco Partners Marketing
11/10/20

INITIAL TEST DATA

INITIAL TEST DATE	10/31/20					
OIL-BBL/DAY	78					
OIL-GRAVITY (API)	32.5					
GAS-MCF/DAY	498					
GAS-OIL RATIO CU FT/BBL	6385					
WATER-BBL/DAY	1245					
PUMPING OR FLOWING	pumping					
INITIAL SHUT-IN PRESSURE	840 psi					
CHOKE SIZE	64/64					
FLOW TUBING PRESSURE						

A record of the formations drilled through, and pertinent remarks are presented on the reverse. I declare that I have knowledge of the contents of this report and am authorized by my organization to make this report, which was prepared by me or under my supervision and direction, with the data and facts stated herein to be true, correct, and complete to the best of my knowledge and belief.

Rex Moore
SIGNATURE

Rex Moore
NAME (PRINT OR TYPE)

3/15/21 405-463-0909
DATE PHONE NUMBER

7025 N. Robinson Ave.

Oklahoma City OK 73116

moorellc@cox.net

ADDRESS

CITY STATE ZIP

EMAIL ADDRESS

PLEASE TYPE OR USE BLACK INK ONLY
FORMATION RECORD

Give formation names and tops, if available, or descriptions and thickness of formations drilled through. Show intervals cored or drillstem tested.

NAMES OF FORMATIONS	TOP
Sycamore	7799'
Woodford	8955'
Hunton	9599'

LEASE NAME Baker WELL NO. 5-8 1WH

FOR COMMISSION USE ONLY	
ITD on file <input type="checkbox"/> YES <input type="checkbox"/> NO	
APPROVED <input type="checkbox"/> DISAPPROVED <input type="checkbox"/>	2) Reject Codes
<div></div> <div></div> <div></div> <div></div>	

Were open hole logs run?	<input checked="" type="radio"/> yes <input type="radio"/> no
Date Last log was run	<u>4/1/20</u>
Was CO ₂ encountered?	<input type="radio"/> yes <input checked="" type="radio"/> no at what depths? <u> </u>
Was H ₂ S encountered?	<input type="radio"/> yes <input checked="" type="radio"/> no at what depths? <u> </u>
Were unusual drilling circumstances encountered?	<input type="radio"/> yes <input checked="" type="radio"/> no
If yes, briefly explain below	

Other remarks: Shut in. Waiting on gas pipeline evaluation.

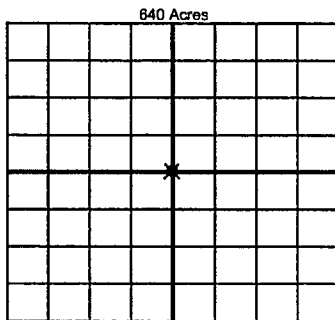

If more than three drainholes are proposed, attach a separate sheet indicating the necessary information.

Direction must be stated in degrees azimuth. Please note, the horizontal drainhole and its end point must be located within the boundaries of the lease or spacing unit.

Directional surveys are required for all drainholes and directional wells

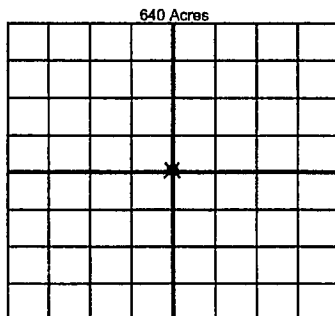

BOTTOM HOLE LOCATION FOR DIRECTIONAL HOLE

SEC	TWP	RGE	COUNTY
1/4	1/4	1/4	1/4
Measured Total Depth	True Vertical Depth	Feet From 1/4 Sec Lines	
		BHL From Lease, Unit, or Property Line:	

BOTTOM HOLE LOCATION FOR HORIZONTAL HOLE: (LATERALS)

Per Rex Moore & WEbMk Exhibits

LATERAL #1	SEC	TWP	RGE	COUNTY
	8	6N	12W	Caddo
	S1/2SW	S1/2SW	S1/2E	NW
Depth of Deviation	8504'	Radius of Turn	713'	Direction <u>196 195</u>
Measured Total Depth	14537'	True Vertical Depth	<u>8577-9191'</u>	Total Length <u>5563'</u>
		BHL From Lease, Unit, or Property Line:		<u>1536 1528'</u>

LATERAL #2

SEC	TWP	RGE	COUNTY
1/4	1/4	1/4	1/4
Depth of Deviation	Radius of Turn	Direction	Total Length
Measured Total Depth	True Vertical Depth	BHL From Lease, Unit, or Property Line:	

LATERAL #3

SEC	TWP	RGE	COUNTY
1/4	1/4	1/4	1/4
Depth of Deviation	Radius of Turn	Direction	Total Length
Measured Total Depth	True Vertical Depth	BHL From Lease, Unit, or Property Line:	