

Oklahoma Corporation Commission
Oil & Gas Conservation Division
Post Office Box 52000
Oklahoma City, Oklahoma 73152-2000
Rule 165: 10-3-25

Form 1002A

API No.: 35019263450000

Completion Report

Spud Date: January 03, 2020

OTC Prod. Unit No.: 019-109942-0-5383

Drilling Finished Date: January 12, 2020

1st Prod Date: March 06, 2020

Completion Date: March 05, 2020

Drill Type: STRAIGHT HOLE

Well Name: SW WILDCAT JIM DEESE UNIT 7-1

Purchaser/Measurer:

Location: CARTER 6 2S 2W
NW SW SE SW
430 FSL 1640 FWL of 1/4 SEC
Latitude: 34.406475 Longitude: -97.452001
Derrick Elevation: 0 Ground Elevation: 1066

First Sales Date:

Operator: MACK ENERGY CO 11739

4700 GAILLARDIA PKWY STE 102
OKLAHOMA CITY, OK 73142-1839

Completion Type		Location Exception		Increased Density	
X	Single Zone	Order No		Order No	
	Multiple Zone	There are no Location Exception records to display.		There are no Increased Density records to display.	
	Commingled				

Casing and Cement							
Type	Size	Weight	Grade	Feet	PSI	SAX	Top of CMT
CONDUCTOR	16			42			SURFACE
SURFACE	9 5/8	36	J-55	1326		435	SURFACE
PRODUCTION	7	26	J-55	4348		575	674

Liner								
Type	Size	Weight	Grade	Length	PSI	SAX	Top Depth	Bottom Depth
There are no Liner records to display.								

Total Depth: 4372

Packer	
Depth	Brand & Type
There are no Packer records to display.	

Plug	
Depth	Plug Type
There are no Plug records to display.	

Initial Test Data

Test Date	Formation	Oil BBL/Day	Oil-Gravity (API)	Gas MCF/Day	Gas-Oil Ratio Cu FT/BBL	Water BBL/Day	Pumpin or Flowing	Initial Shut-In Pressure	Choke Size	Flow Tubing Pressure
Mar 25, 2020	DEESE	1	22			230	PUMPING	40	N/A	
Completion and Test Data by Producing Formation										
Formation Name: DEESE			Code: 404DEESS			Class: OIL				
Spacing Orders				Perforated Intervals						
Order No		Unit Size		From			To			
701901		UNIT		4134			4172			
Acid Volumes				Fracture Treatments						
2,000 GALLONS 15% MCA				NONE						
Formation Name: DEESE			Code: 404DEESS			Class: OIL				
Spacing Orders				Perforated Intervals						
Order No		Unit Size		From			To			
701901		UNIT		3992			4020			
				4044			4058			
Acid Volumes				Fracture Treatments						
550 GALLONS 7.5 NEFE HCL				942 BARRELS, 32,500 POUNDS SAND						
Formation Name: DEESE			Code: 404DEESS			Class: OIL				
Spacing Orders				Perforated Intervals						
Order No		Unit Size		From			To			
701901		UNIT		3606			3620			
Acid Volumes				Fracture Treatments						
150 GALLONS NEFE HCL				513 BARRELS, 10,000 POUNDS SAND						
Formation Name: DEESE			Code: 404DEESS			Class: OIL				
Spacing Orders				Perforated Intervals						
Order No		Unit Size		From			To			
701901		UNIT		3248			3262			
				3320			3334			
Acid Volumes				Fracture Treatments						
9.5 BARRELS 7.5% NEFE HCL				778 BARRELS, 26,000 POUNDS SAND						

Formation Name: DEESE		Code: 404DEESS	Class: OIL
Spacing Orders		Perforated Intervals	
Order No	Unit Size	From	To
701901	UNIT	3196	3212
Acid Volumes		Fracture Treatments	
4.8 BARRELS 7.5% NEFE HCL		480 BARRELS, 11,000 POUNDS SAND	

Formation	Top
------------------	------------

Were open hole logs run? Yes
Date last log run: January 11, 2020

Were unusual drilling circumstances encountered? No
Explanation:

Other Remarks
OCC - CORRECTION SHOW OPEN HOLE LOGS RUN DATA ENTRY ERROR.

FOR COMMISSION USE ONLY	
Status: Accepted	1145095

(PLEASE TYPE OR USE BLACK INK ONLY)

OKLAHOMA CORPORATION COMMISSION
Oil & Gas Conservation Division
Post Office Box 52000
Oklahoma City, Oklahoma 73152-2000
Rule 165-10-3-25

Form 1002A
Rev. 2009

<input checked="" type="checkbox"/>	ORIGINAL
<input type="checkbox"/>	AMENDED (Reason)

COMPLETION REPORT

TYPE OF DRILLING OPERATION

☒ STRAIGHT HOLE ☐ DIRECTIONAL HOLE ☐ HORIZONTAL HOLE
☐ SERVICE WELL

SPUD DATE 1-2-2020

DRLG FINISHED	1-12-20
DATE	

COUNTY	Carter	SEC	6	TWP	2S	RGE	2W	DATE OF WELL COMPLETION	3/5/20
--------	--------	-----	---	-----	----	-----	----	-------------------------	--------

LEASE NAME	SW Wildcat	SW WIDU Jim Deese	WELL NO.	7-1	1st PROD DATE	3/6/20
------------	------------	-------------------	----------	-----	---------------	--------

NW 1/4 SW 1/4 SE 1/4 SW 1/4	FSL OF	430'	FWL OF	1640'	RECOMP DATE
-----------------------------	--------	------	--------	-------	-------------

ELEVATION (Derrick 5)	Ground	1066'	Latitude (if known)	34.406475	Longitude	97.45200
--------------------------	--------	-------	---------------------	-----------	-----------	----------

OPERATOR NAME	Mack Energy Co.	OTC / OCC	11739
------------------	-----------------	-----------	-------

NAME	57-111	OPERATOR NO.	11733
ADDRESS	P. O. Box 400		

CITY	Duncan	STATE	OK	ZIP	73534
------	--------	-------	----	-----	-------

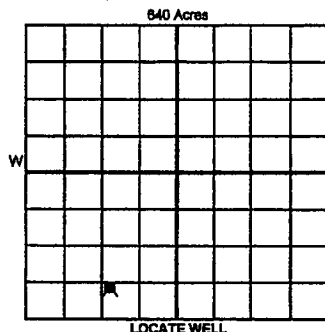

COMPLETION TYPE

X	SINGLE ZONE	
	MULTIPLE ZONE Application Date	
	COMMINGLED Application Date	
LOCATION EXCEPTION ORDER NO.		
INCREASED DENSITY ORDER NO.		

CASING & CEMENT (Attach Form 1002C)

TYPE	SIZE	WEIGHT	GRADE	FEET	PSI	SAX	TOP OF CMT
CONDUCTOR	16"			42'			Surface
SURFACE	9 5/8"	36#	J-55	1326'		435	Surface
INTERMEDIATE							
PRODUCTION	7"	26#	J-55	4348'		575	674'
LINER							
PLUG #	TYPE	PLUG #	TYPE		TOTAL		4372'

PACKER @ _____ BRAND & TYPE _____ PLUG @ _____ TYPE _____ PLUG @ _____ TYPE _____
 PACKER @ _____ BRAND & TYPE _____ PLUG @ _____ TYPE _____ PLUG @ _____ TYPE _____

COMPLETION & TEST DATA BY PRODUCING FORMATION

FORMATION	(Lower Morris)	(Upper Morris)	(Carpenter)	(Tussy)	(Eason)	Fracture
SPACING & SPACING ORDER NUMBER	← 10 acre	10 acre	10 acre	10 acre	10 acre	← 20190
CLASS: Oil, Gas, Dry, Int, Disp, Comm Disp, Svc	Oil	Oil	Oil	Oil	Oil	
PERFORATED INTERVALS	4134-4172'	3992-4020'	3606-3620'	3248-3262'	3196-3212'	
		4044-4058'		3320-3334'		
ACID/VOLUME	2000 gals 15% MCA	550 gals 7.5% NeFe HCl	150 gals NeFe HCl	9.5 bbls 7.5% NeFe HCl	4.8 bbls 7.5% NeFe HCl	
FRACTURE TREATMENT (Fluids/Prop Amounts)	None	942 bbls/ 32500 sd	513 bbls/ 10000# sd	778 bbls/ 26000# sd	480 bbls/ 11000# sd	

Reported to
Trac Focus
- 201901 (unit)

INITIAL TEST DATA	<input type="checkbox"/>	Min Gas Allowable (185:10-17-7)	Gas Purchaser/Measurer
		OR	First Sales Date
		Oil Allowable (185:10-13-3)	

INITIAL TEST DATE	3/25/2020				
OIL-BBL/DAY	1				
OIL-GRAVITY (API)	22				
GAS-MCF/DAY	0				
GAS-OIL RATIO CU FT/BBL	0				
WATER-BBL/DAY	230				
PUMPING OR FLOWING	Pumping				
INITIAL SHUT-IN PRESSURE	40 psi				
CHOKE SIZE	N/A				
FLOW TUBING PRESSURE	N/A				

A record of the formations drilled through, and pertinent remarks are presented on the reverse. I declare that I have knowledge of the contents of this report and am authorized by my organization to make this report, which was prepared by me or under my supervision and direction, with the data and facts stated herein to be true, correct, and complete to the best of my knowledge and belief.

Daniel M. Hayes
SIGNATURE

Dinah Mayes

3/11/2020

580-856-3705

3730 Samedan Rd.

Ratliff City

NAME (PRINT OR TYPE)

OK 73481

DATE _____

PHONE NUMBER

ADDRESS

CITY

STATE

719

dmayes@mackenergy.com

EMAIL ADDRESS

PLEASE TYPE OR USE BLACK INK ONLY

FORMATION RECORD

Give formation names and tops, if available, or descriptions and thickness of formations drilled through. Show intervals cored or drilled and tested.

NAMES OF FORMATIONS	TOP
Deese	3054'

LEASE NAME SW WJDU WELL NO. 7-1

FOR COMMISSION USE ONLY	
ITD on file <input type="checkbox"/> YES <input type="checkbox"/> NO	
APPROVED _____	DISAPPROVED _____
2) Reject Codes	

Were open hole logs run?	<input checked="" type="checkbox"/> yes <input type="checkbox"/> no
Date Last log was run	<u>1/11/2020</u>
Was CO ₂ encountered?	<input type="checkbox"/> yes <input checked="" type="checkbox"/> no at what depths? _____
Was H ₂ S encountered?	<input type="checkbox"/> yes <input checked="" type="checkbox"/> no at what depths? _____
Were unusual drilling circumstances encountered?	<input type="checkbox"/> yes <input checked="" type="checkbox"/> no
If yes, briefly explain below	
1	

Other remarks: _____

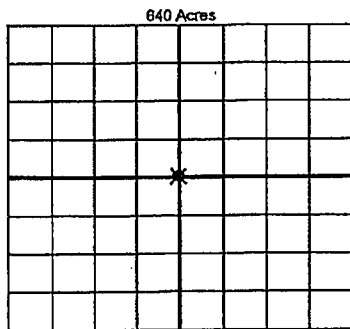

If more than three drainholes are proposed, attach a separate sheet indicating the necessary information.

Direction must be stated in degrees azimuth. Please note, the horizontal drainhole and its end point must be located within the boundaries of the lease or spacing unit.

Directional surveys are required for all drainholes and directional wells.

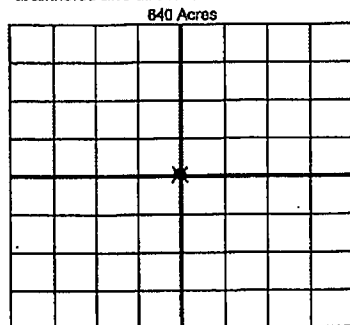

BOTTOM HOLE LOCATION FOR DIRECTIONAL HOLE

SEC	TWP	RGE	COUNTY
Spot Location			
1/4	1/4	1/4	1/4
Measured Total Depth		True Vertical Depth	BHL From Lease, Unit, or Property Line:

BOTTOM HOLE LOCATION FOR HORIZONTAL HOLE: (LATERALS)

LATERAL #1			
SEC	TWP	RGE	COUNTY
Spot Location			
1/4	1/4	1/4	1/4
Depth of Deviation		Radius of Turn	Direction
Measured Total Depth		True Vertical Depth	BHL From Lease, Unit, or Property Line:

LATERAL #2			
SEC	TWP	RGE	COUNTY
Spot Location			
1/4	1/4	1/4	1/4
Depth of Deviation		Radius of Turn	Direction
Measured Total Depth		True Vertical Depth	BHL From Lease, Unit, or Property Line:

LATERAL #3			
SEC	TWP	RGE	COUNTY
Spot Location			
1/4	1/4	1/4	1/4
Depth of Deviation		Radius of Turn	Direction
Measured Total Depth		True Vertical Depth	BHL From Lease, Unit, or Property Line: