

Oklahoma Corporation Commission
Oil & Gas Conservation Division
Post Office Box 52000
Oklahoma City, Oklahoma 73152-2000
Rule 165: 10-3-25

Form 1002A

API No.: 35119233010002

Completion Report

Spud Date: November 06, 1992

OTC Prod. Unit No.: 119-096407-0-0000

Drilling Finished Date: November 16, 1992

Amended

1st Prod Date: January 08, 1993

Amend Reason: RECOMPLETION

Completion Date: January 08, 1993

Recomplete Date: February 01, 2021

Drill Type: DIRECTIONAL HOLE

Min Gas Allowable: Yes

Well Name: FRIEDEMANN 1-33

Purchaser/Measurer: SUPERIOR (GAS) /
PHILLIPS 66 (OIL)

Location: PAYNE 33 19N 3E
NE NE NE NE
2477 FSL 2507 FWL of 1/4 SEC
Latitude: 36.0869279 Longitude: -96.9805811
Derrick Elevation: 886 Ground Elevation: 879

First Sales Date: 07/09/2021

Operator: PRESLEY OPERATING LLC 23803

101 PARK AVE STE 670
OKLAHOMA CITY, OK 73102-7220

Completion Type	
X	Single Zone
	Multiple Zone
	Commingled

Location Exception
Order No
There are no Location Exception records to display.

Increased Density
Order No
There are no Increased Density records to display.

Casing and Cement							
Type	Size	Weight	Grade	Feet	PSI	SAX	Top of CMT
SURFACE	8 5/8	24	J-55	458	2000	325	SURFACE
PRODUCTION	5 1/2	15.5	J-55	4308	2000	260	3150

Liner								
Type	Size	Weight	Grade	Length	PSI	SAX	Top Depth	Bottom Depth
There are no Liner records to display.								

Total Depth: 4319

Packer	
Depth	Brand & Type
There are no Packer records to display.	

Plug	
Depth	Plug Type
4200	CIBP

Initial Test Data

Test Date	Formation	Oil BBL/Day	Oil-Gravity (API)	Gas MCF/Day	Gas-Oil Ratio Cu FT/BBL	Water BBL/Day	Pumpin or Flowing	Initial Shut-In Pressure	Choke Size	Flow Tubing Pressure
Jul 17, 2021	RED FORK	18.7	40	41	2214	119	PUMPING	1200	N/A	

Completion and Test Data by Producing Formation

Formation Name: RED FORK

Code: 404RDFK

Class: OIL

Spacing Orders

Order No	Unit Size
711736	40

Perforated Intervals

From	To
3834	3858

Acid Volumes

500 GALLONS 7 1/2% HCL

Fracture Treatments

423 BARRELS X-LINK, 10,000 POUNDS 16/30, 5,000 POUNDS RESIN

Formation	Top
CLEVELAND	3369
RED FORK	3834

Were open hole logs run? No

Date last log run: November 15, 1992

Were unusual drilling circumstances encountered? No

Explanation:

Other Remarks

OCC - ORDER NUMBER 711736 IS AN IRREGULAR 40 ACRE UNIT COVERING SW SW SW SECTION 27, SE SE SW SECTION 28, NE NE NE SECTION 33, AND NW NW NW SECTION 34 ALL IN 19N-3E.

Bottom Holes

Sec: 28 TWP: 19N RGE: 3E County: PAYNE

SE SE SE SE

11 FSL 2612 FWL of 1/4 SEC

Depth of Deviation: 0 Radius of Turn: 0 Direction: 0 Total Length: 0

Measured Total Depth: 4319 True Vertical Depth: 4298 End Pt. Location From Release, Unit or Property Line: 632

FOR COMMISSION USE ONLY

Status: Accepted

1146716

API NO. 35-119-23301
OTC PROD. UNIT NO. 119-096407

Oil and Gas Conservation Division
P.O. Box 52000
Oklahoma City, OK 73152-2000
405-521-2331
OCCCentralProcessing@OCC.OK.GOV



OKLAHOMA
Corporation
Commission

Form 1002A
Rev. 2020

ORIGINAL
AMENDED (Reason) RECOMPLETION

Rule 165:10-3-25

COMPLETION REPORT

TYPE OF DRILLING OPERATION
☐ STRAIGHT HOLE ☒ DIRECTIONAL HOLE ☐ HORIZONTAL HOLE
☐ SERVICE WELL

SPUD DATE 11-6-92
DRLG FINISHED DATE 11-16-92

COUNTY PAYNE SEC 33 TWP 19N RGE 3E

DATE OF WELL COMPLETION 1-8-93

LEASE NAME FRIEDEMANN WELL NO. 1-33

1st PROD DATE 1-8-93

NE 1/4 NE 1/4 NE 1/4 NE 1/4 FSL 2477 FWL 2507

RECOMP DATE 2-1-21

ELEVATION 886 Ground 879 Latitude 36.0869279

Longitude -96.980511

OPERATOR NAME PRESLEY OPERATING LLC

OTC / OCC OPERATOR NO. 23803

ADDRESS 101 PARK AVE, SUITE 670

CITY OKLAHOMA CITY STATE OK ZIP 73102

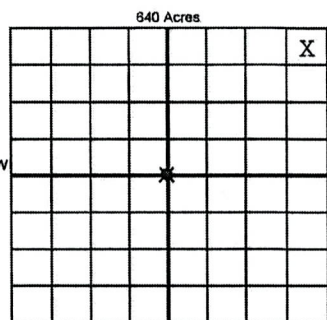

COMPLETION TYPE
☒ SINGLE ZONE
☐ MULTIPLE ZONE
☐ COMMINGLED
LOCATION EXCEPTION ORDER NO.
MULTIUNIT ORDER NO.
INCREASED DENSITY ORDER NO.

TYPE	SIZE	WEIGHT	GRADE	FEET	PSI	SAX	TOP OF CMT
CONDUCTOR							
SURFACE	8 5/8	24	J-55	458	2000	325	SURFACE
INTERMEDIATE							
PRODUCTION	5 1/2	15.5	J-55	4308	2000	260	3150
LINER							

PACKER @ BRAND & TYPE PLUG @ 4200 TYPE CIBP PLUG @ TYPE TOTAL DEPTH 4319

COMPLETION & TEST DATA BY PRODUCING FORMATION

FORMATION	RED FORK					
SPACING & SPACING ORDER NUMBER	711736 (40)					
CLASS: Oil, Gas, Dry, Inj, Disp, Comm Disp, Svc	Oil					
PERFORATED INTERVALS	3834' - 3842'					
	3854' - 3858'					
ACID/VOLUME	7 1/2% HCL, 500 GAL					
FRACTURE TREATMENT (Fluids/Prop Amounts)	423 BBL X-LINK 10,000 # 16/30 5,000# Resin					

Reported to Frac Focus

RECEIVED
JUL 22 2021
OKLAHOMA CORPORATION COMMISSION

Min Gas Allowable (165:10-17-7) OR Oil Allowable (165:10-13-3) Purchaser/Measurer First Sales Date SUPERIOR (GAS) /PHILLIPS66 (OIL) 7-9-21 (GAS)/7-19-21 (OIL)

INITIAL TEST DATE	7-17-21				
OIL-BBL/DAY	18.7				
OIL-GRAVITY (API)	40				
GAS-MCF/DAY	41.4				
GAS-OIL RATIO CU FT/BBL	2214				
WATER-BBL/DAY	119				
PUMPING OR FLOWING	PUMPING				
INITIAL SHUT-IN PRESSURE	1200 PSI				
CHOKE SIZE	N/A				
FLOW TUBING PRESSURE	N/A				

A record of the formations drilled through, and pertinent remarks are presented on the reverse. I declare that I have knowledge of the contents of this report and am authorized by my organization to make this report, which was prepared by me or under my supervision and direction, with the data and facts stated herein to be true, correct, and complete to the best of my knowledge and belief.

Signature: Travers Boughtadly
101 PARK AVE, STE 670 OKLAHOMA CITY OK 73102
BO@PRESLEYPETROLEUM.COM

DATE: 7-19-21
PHONE NUMBER: 405-526-3000
EMAIL ADDRESS: BO@PRESLEYPETROLEUM.COM

PLEASE TYPE OR USE BLACK INK ONLY
FORMATION RECORD

Give formation names and tops, if available, or descriptions and thickness of formations drilled through. Show intervals cored or drillstem tested.

NAMES OF FORMATIONS	TOP
CLEVELAND (405CLVD)	3369
RED FORK (404RDFK)	3834

LEASE NAME Friedemann

WELL NO. 1-33

FOR COMMISSION USE ONLY	
ITD on file <input type="checkbox"/> YES <input type="checkbox"/> NO	
APPROVED _____ DISAPPROVED _____	2) Reject Codes

Were open hole logs run?	<input type="radio"/> yes <input checked="" type="radio"/> no
Date Last log was run	11-15-92
Was CO ₂ encountered?	<input type="radio"/> yes <input checked="" type="radio"/> no at what depths? _____
Was H ₂ S encountered?	<input type="radio"/> yes <input checked="" type="radio"/> no at what depths? _____
Were unusual drilling circumstances encountered?	<input type="radio"/> yes <input checked="" type="radio"/> no
If yes, briefly explain below	

Other remarks:

QCC - order 711736 is an irregular 40 covering SW SW SW Section 27, SE SE SW Section 28, NE NE NE Section 33, and NWN NW Sec 34 All in 19N-3E.

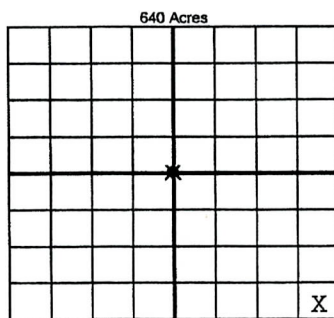

If more than three drainholes are proposed, attach a separate sheet indicating the necessary information.

Direction must be stated in degrees azimuth.
Please note, the horizontal drainhole and its end point must be located within the boundaries of the lease or spacing unit.

Directional surveys are required for all drainholes and directional wells

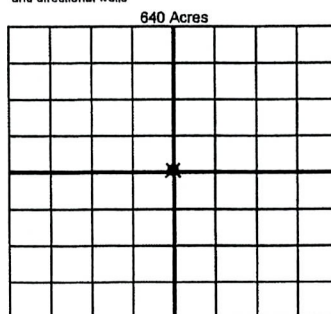

BOTTOM HOLE LOCATION FOR DIRECTIONAL HOLE

SEC 28	TWP 19N	RGE 3E	COUNTY PAYNE
SE 1/4	SE 1/4	SE 1/4	SE 1/4
Measured Total Depth	4319	True Vertical Depth	4298
Feet From 1/4 Sec Lines		FSL 11	FWL 2612
BHL From Lease, Unit, or Property Line: 632 (IRREGULAR 40 AC UNIT)			

BOTTOM HOLE LOCATION FOR HORIZONTAL HOLE: (LATERALS)

LATERAL #1			
SEC	TWP	RGE	COUNTY
1/4	1/4	1/4	1/4
Depth of Deviation	Radius of Turn	Direction	Total Length
Measured Total Depth	True Vertical Depth	BHL From Lease, Unit, or Property Line:	

LATERAL #2			
SEC	TWP	RGE	COUNTY
1/4	1/4	1/4	1/4
Depth of Deviation	Radius of Turn	Direction	Total Length
Measured Total Depth	True Vertical Depth	BHL From Lease, Unit, or Property Line:	

LATERAL #3			
SEC	TWP	RGE	COUNTY
1/4	1/4	1/4	1/4
Depth of Deviation	Radius of Turn	Direction	Total Length
Measured Total Depth	True Vertical Depth	BHL From Lease, Unit, or Property Line:	