

Oklahoma Corporation Commission  
Oil & Gas Conservation Division  
Post Office Box 52000  
Oklahoma City, Oklahoma 73152-2000  
Rule 165: 10-3-25

Form 1002A

API No.: 35039225760001

**Completion Report**

Spud Date: June 01, 2019

OTC Prod. Unit No.: 039-225941-0-0000

Drilling Finished Date: July 22, 2019

**Amended**

1st Prod Date: August 12, 2019

Amend Reason: CHANGE CLASSIFICATION TO GAS

Completion Date: August 09, 2019

**Drill Type:** HORIZONTAL HOLE

Min Gas Allowable: Yes

Well Name: WINGARD 1510 1HX

Purchaser/Measurer: ENABLE

Location: CUSTER 15 14N 14W  
SE SW SW NW  
2440 FNL 460 FWL of 1/4 SEC  
Latitude: 35.68992 Longitude: -98.68402  
Derrick Elevation: 1743 Ground Elevation: 1718

First Sales Date: 08/12/2019

Operator: UNIT PETROLEUM COMPANY 16711  
PO BOX 702500  
8200 S UNIT DRIVE  
TULSA, OK 74170-2500

Completion Type		Location Exception		Increased Density	
X	Single Zone	Order No		Order No	
	Multiple Zone	706032		695458	
	Commingled				

Casing and Cement							
Type	Size	Weight	Grade	Feet	PSI	SAX	Top of CMT
SURFACE	13 3/8	54.5	J-55	561	1500	480	SURFACE
INTERMEDIATE	9 5/8	40	P-110	10161	1500	335	7239
INTERMEDIATE	7	29	P-110	11131	1500	260	8693
PRODUCTION	4 1/2	13.5	P-110	16180	9500	525	9804

Liner								
Type	Size	Weight	Grade	Length	PSI	SAX	Top Depth	Bottom Depth
There are no Liner records to display.								

**Total Depth: 16188**

Packer		Plug	
Depth	Brand & Type	Depth	Plug Type
There are no Packer records to display.		9914	PUMP OUT

Initial Test Data
-------------------

Test Date	Formation	Oil BBL/Day	Oil-Gravity (API)	Gas MCF/Day	Gas-Oil Ratio Cu FT/BBL	Water BBL/Day	Pumpin or Flowing	Initial Shut-In Pressure	Choke Size	Flow Tubing Pressure
Mar 14, 2022	RED FORK	45	49	1048	23289	42	FLOWING	4048	128/64	124

Completion and Test Data by Producing Formation

Formation Name: RED FORK

Code: 404RDFK

Class: GAS

Spacing Orders

Order No	Unit Size
681788	640
697080	640
706031	MULTIUNIT

Perforated Intervals

From	To
11252	16188

Acid Volumes

1,210 BARRELS 15% HCl ACID
----------------------------

Fracture Treatments

140,500 BARRELS SLICKWATER, 5,205,920 POUNDS PROPPANT
---

Formation	Top
TONKAWA	8306
COTTAGE GROVE	8824
CHECKERBOARD	9457
CLEVELAND	9528
OSWEGO	9860
PINK LIME	10654
RED FORK	11053

Were open hole logs run? No

Date last log run:

Were unusual drilling circumstances encountered? No

Explanation:

Other Remarks

CHANGE CLASSIFICATION TO GAS; EXCEPTION TO RULES ORDER 706070

Lateral Holes

Sec: 10 TWP: 14N RGE: 11W County: CUSTER

NW NE NW NW

2520 FNL 762 FWL of 1/4 SEC

Depth of Deviation: 10333 Radius of Turn: 585 Direction: 359 Total Length: 4936

Measured Total Depth: 16188 True Vertical Depth: 10695 End Pt. Location From Release, Unit or Property Line: 762

FOR COMMISSION USE ONLY

Status: Accepted

1147741

039-22576-01

API NO. 35-03922576  
 OTC PROD. UNIT NO. 039225941

Oil and Gas Conservation Division  
 P.O. Box 52000  
 Oklahoma City, OK 73152-2000  
 405-521-2331  
 OCCCentralProcessing@OCC.OK.GOV

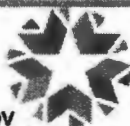

**OKLAHOMA**  
 Corporation  
 Commission

Form 1002A  
 Rev. 2021



ORIGINAL  
 AMENDED (Reason)

CHANGE CLASSIFICATION TO GAS

Rule 165:10-3-25

COMPLETION REPORT

TYPE OF DRILLING OPERATION

☐ STRAIGHT HOLE ☐ DIRECTIONAL HOLE ☒ HORIZONTAL HOLE  
☐ SERVICE WELL

If directional or horizontal, see reverse for bottom hole location.

COUNTY	CUSTER	SEC	15	TWP	14N	RGE	14W
LEASE NAME	WINGARD 1510			WELL NO.	1HX		
SE 1/4 SW 1/4 SW 1/4 NW 1/4	2440			FWL	460		
ELEVATION	1743	Ground	1718	Latitude	35.68992		Longitude
OPERATOR NAME	UNIT PETROLEUM COMPANY			OTC / OCC OPERATOR NO.	16711		
ADDRESS	PO BOX 702500						
CITY	TULSA			STATE	OK		ZIP
							74170-2500

SPUD DATE 6/1/19

DRLG FINISHED DATE 7/22/19

DATE OF WELL COMPLETION 8/9/19

1st PROD DATE 8/12/19

RECOMP DATE

Longitude -98.68402

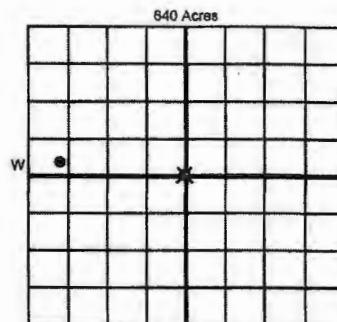

LOCATE WELL

COMPLETION TYPE

<input checked="" type="radio"/> SINGLE ZONE	
<input type="radio"/> MULTIPLE ZONE	
<input type="radio"/> COMMINGLED	
LOCATION EXCEPTION ORDER NO.	706032, 706070
MULTIUNIT ORDER NO.	706031
INCREASED DENSITY ORDER NO.	695458

CASING & CEMENT (Attach Form 1002C)

TYPE	SIZE	WEIGHT	GRADE	FEET	PSI	SAX	TOP OF CMT
CONDUCTOR							
SURFACE	13 3/8	54.5	J-55	561	1500	480	SURFACE
INTERMEDIATE	9 5/8	40	P-110	10161	1500	335	7239
INTERMEDIATE	7	29	P-110	11131	1500	260	8693
INTERMEDIATE	4 1/2	13.5	P-110	16180	9500	525	9804

PACKER @ BRAND & TYPE PUMP-OUT PLUG @ 9914 TYPE Pump Out PLUG @ TYPE TOTAL DEPTH 16188

COMPLETION & TEST DATA BY PRODUCING FORMATION

FORMATION	RED FORK
SPACING & SPACING ORDER NUMBER	640/697080, 640/681788
CLASS: Oil, Gas, Dry, Int, Disp, Comm Disp, Svc	GAS
PERFORATED INTERVALS	11252-16188
ACID/VOLUME	1210 BBLs 15% HCL ACID
FRACTURE TREATMENT (Fluids/Prop Amounts)	140,588 BBLs SLICKWATER; 5,205,920 LBS PROPPANT



Min Gas Allowable (165:10-17-7)

OR

Oil Allowable (165:10-13-3)

Purchaser/Measurer

First Sales Date

ENABLE

8/12/19

INITIAL TEST DATA

INITIAL TEST DATE	3/14/22
OIL-BBL/DAY	45
OIL-GRAVITY (API)	49
GAS-MCF/DAY	1048
GAS-OIL RATIO CU FT/BBL	23,289 OK
WATER-BBL/DAY	42
PUMPING OR FLOWING	FLOWING
INITIAL SHUT-IN PRESSURE	4048
CHOKE SIZE	128/64
FLOW TUBING PRESSURE	124

RECEIVED

MAR 17 2022

OKLAHOMA CORPORATION  
 COMMISSION

A record of the formations drilled through, and pertinent remarks are presented on the reverse. I declare that I have knowledge of the contents of this report and am authorized by my organization to make this report, which was prepared by me or under my supervision and direction, with the data and facts stated herein to be true, correct, and complete to the best of my knowledge and belief.

Brent Keys SIGNATURE  
 BRENT KEYS NAME (PRINT OR TYPE)  
 PO BOX 702500 TULSA OK 74170-2500 3/15/22 918/493-7700  
 ADDRESS CITY STATE ZIP DATE PHONE NUMBER  
 brent.keys@unitcorp.com EMAIL ADDRESS

PLEASE TYPE OR USE BLACK INK ONLY

FORMATION RECORD

Give formation names and tops, if available, or descriptions and thickness of formations drilled through. Show intervals cored or drillstem tested.

NAMES OF FORMATIONS	TOP
TONKAWA	8306
COTTAGE GROVE	8824
CHECKERBOARD	9457
CLEVELAND	9528
OSWEGO	9860
PINK LIME	10654
RED FORD <del>SAND</del>	11053

LEASE NAME WINGARD 1510

WELL NO. 1HX

FOR COMMISSION USE ONLY		
ITD on file	<input type="checkbox"/> YES	<input type="checkbox"/> NO
APPROVED	DISAPPROVED	2) Reject Codes
<div></div> <div></div> <div></div> <div></div> <div></div>		

Were open hole logs run?	<input type="radio"/> yes	<input checked="" type="radio"/> no	
Date Last log was run			
Was CO <sub>2</sub> encountered?	<input type="radio"/> yes	<input checked="" type="radio"/> no	at what depths?
Was H <sub>2</sub> S encountered?	<input type="radio"/> yes	<input checked="" type="radio"/> no	at what depths?
Were unusual drilling circumstances encountered?	<input type="radio"/> yes	<input checked="" type="radio"/> no	
If yes, briefly explain below			

Other remarks:

Change classification to Gas; Exception to rules order 708070

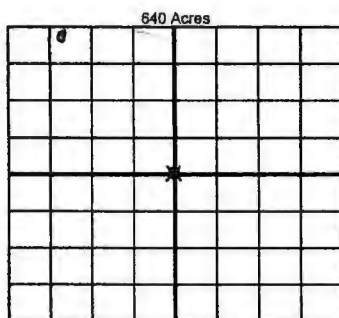

If more than three drainholes are proposed, attach a separate sheet indicating the necessary information.

Direction must be stated in degrees azimuth. Please note, the horizontal drainhole and its end point must be located within the boundaries of the lease or spacing unit.

Directional surveys are required for all drainholes and directional wells

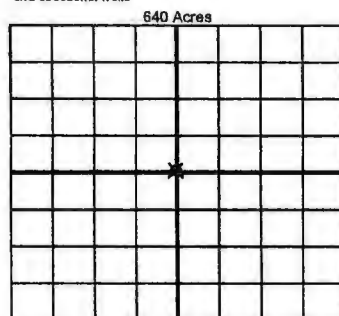

BOTTOM HOLE LOCATION FOR DIRECTIONAL HOLE

SEC	TWP	RGE	COUNTY
1/4	1/4	1/4	1/4
Measured Total Depth	True Vertical Depth	Feet From 1/4 Sec Lines	
		BHL From Lease, Unit, or Property Line:	

BOTTOM HOLE LOCATION FOR HORIZONTAL HOLE: (LATERALS)

LATERAL #1			
SEC	TWP	RGE	COUNTY
10	14N	14W	CUSTER
NW 1/4	NE 1/4	NW 1/4	NW 1/4
Depth of Deviation	Radius of Turn	Direction	Total Length
10333	585	359	4936
Measured Total Depth	True Vertical Depth	BHL From Lease, Unit, or Property Line:	
16188	10695	762	

LATERAL #2

SEC	TWP	RGE	COUNTY
1/4	1/4	1/4	1/4
Depth of Deviation	Radius of Turn	Direction	Total Length
Measured Total Depth	True Vertical Depth	BHL From Lease, Unit, or Property Line:	

LATERAL #3

SEC	TWP	RGE	COUNTY
1/4	1/4	1/4	1/4
Depth of Deviation	Radius of Turn	Direction	Total Length
Measured Total Depth	True Vertical Depth	BHL From Lease, Unit, or Property Line:	

4/12/22  
Oklahoma Corporation Commission  
Oil & Gas Conservation Division  
Post Office Box 52000  
Oklahoma City, Oklahoma 73152-2000  
Rule 165: 10-3-25

Form 1002A

**1002A**  
**Addendum**

API No.: 35039225760001

**Completion Report**

Spud Date: June 01, 2019

OTC Prod. Unit No.: 039-225941-0-0000

Drilling Finished Date: July 22, 2019

**Amended**

1st Prod Date: August 12, 2019

Amend Reason: CHANGE CLASSIFICATION TO GAS

Completion Date: August 09, 2019

**Drill Type: HORIZONTAL HOLE**

Min Gas Allowable: Yes

Well Name: WINGARD 1510 1HX

Purchaser/Measurer: ENABLE

Location: CUSTER 15 14N 14W  
SE SW SW NW  
2440 FNL 460 FWL of 1/4 SEC  
Latitude: 35.68992 Longitude: -98.68402  
Derrick Elevation: 1743 Ground Elevation: 1718

First Sales Date: 08/12/2019

Operator: UNIT PETROLEUM COMPANY 16711  
PO BOX 702500  
8200 S UNIT DRIVE  
TULSA, OK 74170-2500

Multistage

Sec. 15: 44.53% 225941 I

Sec. 10: 55.47% 225941A I

Completion Type	
X	Single Zone
	Multiple Zone
	Commingled

Location Exception
Order No
706032

Increased Density
Order No
695458

Casing and Cement							
Type	Size	Weight	Grade	Feet	PSI	SAX	Top of CMT
SURFACE	13 3/8	54.5	J-55	561	1500	480	SURFACE
INTERMEDIATE	9 5/8	40	P-110	10161	1500	335	7239
INTERMEDIATE	7	29	P-110	11131	1500	260	8693
PRODUCTION	4 1/2	13.5	P-110	16180	9500	525	9804

Liner								
Type	Size	Weight	Grade	Length	PSI	SAX	Top Depth	Bottom Depth
There are no Liner records to display.								

**Total Depth: 16188**

Packer	
Depth	Brand & Type
There are no Packer records to display.	

Plug	
Depth	Plug Type
9914	PUMP OUT

Initial Test Data
-------------------

March 22, 2022

3/14/22

404RDFK

4048

1 of 2