

Oklahoma Corporation Commission
Oil & Gas Conservation Division
Post Office Box 52000
Oklahoma City, Oklahoma 73152-2000
Rule 165: 10-3-25

Form 1002A

API No.: 35111275450000

Completion Report

Spud Date: November 29, 2021

OTC Prod. Unit No.: 111-227361-0-0000

Drilling Finished Date: December 03, 2021

1st Prod Date: March 16, 2022

Completion Date: February 15, 2022

Drill Type: STRAIGHT HOLE

Min Gas Allowable: Yes

Well Name: SUZIEQ 44-17

Purchaser/Measurer:

Location: OKMULGEE 17 15N 11E
NW NW SE SE
1155 FSL 1155 FEL of 1/4 SEC
Latitude: 35.7730378 Longitude: -96.1614539
Derrick Elevation: 887 Ground Elevation: 0

First Sales Date:

Operator: ENTERPRISE ENERGY EXPLORATION INC 21418

6528 E 101ST ST STE 392
TULSA, OK 74133-6724

Completion Type		Location Exception		Increased Density	
X	Single Zone	Order No		Order No	
	Multiple Zone	There are no Location Exception records to display.		There are no Increased Density records to display.	
	Commingled				

Casing and Cement							
Type	Size	Weight	Grade	Feet	PSI	SAX	Top of CMT
SURFACE	8 5/8	20	L.S.	178	800	100	SURFACE
PRODUCTION	5 1/2	17	J-55	3330	1000	210	1726

Liner								
Type	Size	Weight	Grade	Length	PSI	SAX	Top Depth	Bottom Depth
There are no Liner records to display.								

Total Depth: 3360

Packer	
Depth	Brand & Type
There are no Packer records to display.	

Plug	
Depth	Plug Type
There are no Plug records to display.	

Initial Test Data

Test Date	Formation	Oil BBL/Day	Oil-Gravity (API)	Gas MCF/Day	Gas-Oil Ratio Cu FT/BBL	Water BBL/Day	Pumpin or Flowing	Initial Shut-In Pressure	Choke Size	Flow Tubing Pressure
Feb 15, 2022	DUTCHER	10	39			20	PUMPING	150		

Completion and Test Data by Producing Formation

Formation Name: DUTCHER

Code: 403DTCR

Class: OIL

Spacing Orders

Order No	Unit Size
NONE	

Perforated Intervals

From	To
2621	2625

Acid Volumes

500 GALLONS 10%

Fracture Treatments

There are no Fracture Treatments records to display.

Formation	Top
BARTLESVILLE	2000
BOOCH	2300
DUTCHER	2500
WILCOX	3020

Were open hole logs run? No

Date last log run: August 14, 2021

Were unusual drilling circumstances encountered? No

Explanation:

Other Remarks

There are no Other Remarks.

FOR COMMISSION USE ONLY

Status: Accepted

1147744

111-27545

API NO. 411-27542
OTC PROD. UNIT NO. 111-227361

Oil and Gas Conservation Division
P.O. Box 52000
Oklahoma City, OK 73152-2000
405-521-2331
OCCCentralProcessing@OCC.OK.GOV



OKLAHOMA Corporation Commission

Form 1002A
Rev. 2021

ORIGINAL
AMENDED (Reason)

Rule 165:10-3-25

COMPLETION REPORT

TYPE OF DRILLING OPERATION

☒ STRAIGHT HOLE ☐ DIRECTIONAL HOLE ☐ HORIZONTAL HOLE
☐ SERVICE WELL

If directional or horizontal, see reverse for bottom hole location.

COUNTY Okmulgee SEC 17 TWP 5N RGE 11E

LEASE NAME SuzieQ WELL NO. 44-17

NW 1/4 NW 1/4 SE 1/4 SE 1/4 FSL 1155' (FEL) 1155'

ELEVATION 887' Ground Latitude Longitude

OPERATOR NAME Enterprise Energy Exp, Inc OTC / OCC OPERATOR NO. 21418

ADDRESS 6528 E. 101st ST STE 392

CITY Tulsa STATE OK ZIP 74133

SPUD DATE 11/30/2021

DRLG FINISHED DATE 12/03/2021

DATE OF WELL COMPLETION 2/15/2021

1st PROD DATE 3/16/2022

RECOMP DATE

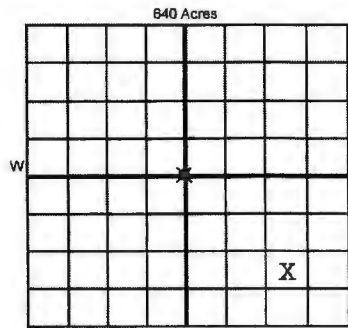

LOCATE WELL

COMPLETION TYPE

☒ SINGLE ZONE
☐ MULTIPLE ZONE
☐ COMMINGLED
LOCATION EXCEPTION ORDER NO.
MULTIUNIT ORDER NO.
INCREASED DENSITY ORDER NO.

CASING & CEMENT (Attach Form 1002C)

TYPE	SIZE	WEIGHT	GRADE	FEET	PSI	SAX	TOP OF CMT
CONDUCTOR							
SURFACE	8 5/8	20#	L.S.	178'	800	100	Surface
INTERMEDIATE							
PRODUCTION	5 1/2"	17 #	J-55	3330'	1000	210	1726'
LINER							

PACKER @ _____ BRAND & TYPE _____ PLUG @ _____ TYPE _____ PLUG @ _____ TYPE _____
PACKER @ _____ BRAND & TYPE _____ PLUG @ _____ TYPE _____ PLUG @ _____ TYPE _____

TOTAL DEPTH 3360

COMPLETION & TEST DATA BY PRODUCING FORMATION

403 DTCR

FORMATION	<u>Dutcher</u>					<u>No Frac</u>
SPACING & SPACING ORDER NUMBER	<u>none</u>					
CLASS: Oil, Gas, Dry, Inj, Disp, Comm Disp, Svc	<u>Oil</u>					
PERFORATED INTERVALS	<u>2621' - 2625'</u> <u>3/spf</u>					
ACID VOLUME	<u>500 gals 10%</u>					
FRACTURE TREATMENT (Fluids/Prop Amounts)						

☒

Min Gas Allowable (165:10-17-7)

OR

Oil Allowable (165:10-13-3)

Purchaser/Measurer

First Sales Date

INITIAL TEST DATA

INITIAL TEST DATE	<u>2/15/2022</u>					
OIL-BBL/DAY	<u>10</u>					
OIL-GRAVITY (API)	<u>39</u>					
GAS-MCF/DAY	<u>0</u>					
GAS-OIL RATIO CU FT/BBL	<u>0</u>					
WATER-BBL/DAY	<u>20</u>					
PUMPING OR FLOWING	<u>Pumping</u>					
INITIAL SHUT-IN PRESSURE	<u>150 psi</u>					
CHOKE SIZE						
FLOW TUBING PRESSURE						

RECEIVED

MAR 17 2022

OKLAHOMA CORPORATION COMMISSION

A record of the formations drilled through, and pertinent remarks are presented on the reverse. I declare that I have knowledge of the contents of this report and am authorized by my organization to make this report, which was prepared by me or under my supervision and direction, with the data and facts stated herein to be true, correct, and complete to the best of my knowledge and belief.

Tim Elias
SIGNATURE
6528 E. 101st ST STE 392

Tulsa OK 74133
ADDRESS CITY STATE ZIP

Tim Elias SR
NAME (PRINT OR TYPE)

3/15/2022 918-857-4248
DATE PHONE NUMBER
telias8121@aol.com
EMAIL ADDRESS

PLEASE TYPE OR USE BLACK INK ONLY
FORMATION RECORD

Give formation names and tops, if available, or descriptions and thickness of formations drilled through. Show intervals cored or drillstem tested.

NAMES OF FORMATIONS	TOP
BRVL	2000
BOCHS	2300
DTCR	2500
WLCX	3020

LEASE NAME Caroline WELL NO. 34-17

FOR COMMISSION USE ONLY	
ITD on file <input type="checkbox"/> YES <input type="checkbox"/> NO	
APPROVED _____ DISAPPROVED _____	2) Reject Codes _____

Were open hole logs run?	<input checked="" type="radio"/> yes <input type="radio"/> no
Date Last log was run	8.14.2021
Was CO ₂ encountered?	<input type="radio"/> yes <input checked="" type="radio"/> no at what depths? _____
Was H ₂ S encountered?	<input type="radio"/> yes <input checked="" type="radio"/> no at what depths? _____
Were unusual drilling circumstances encountered? If yes, briefly explain below	<input type="radio"/> yes <input checked="" type="radio"/> no

Other remarks:

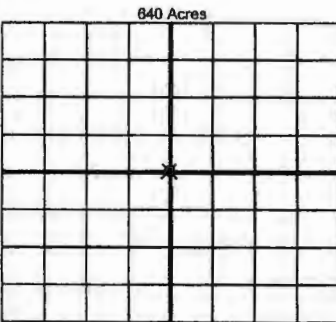

If more than three drainholes are proposed, attach a separate sheet indicating the necessary information.

Direction must be stated in degrees azimuth.
Please note, the horizontal drainhole and its end point must be located within the boundaries of the lease or spacing unit.

Directional surveys are required for all drainholes and directional wells

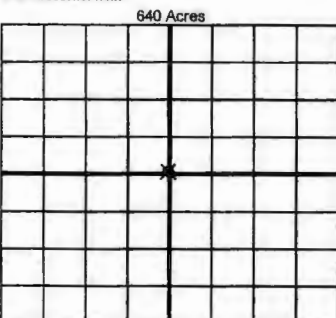

BOTTOM HOLE LOCATION FOR DIRECTIONAL HOLE

SEC	TWP	RGE	COUNTY
1/4	1/4	1/4	1/4
Measured Total Depth		True Vertical Depth	Feet From 1/4 Sec Lines BHL From Lease, Unit, or Property Line:

BOTTOM HOLE LOCATION FOR HORIZONTAL HOLE: (LATERALS)

LATERAL #1			
SEC	TWP	RGE	COUNTY
1/4	1/4	1/4	1/4
Depth of Deviation		Radius of Turn	Direction Total Length
Measured Total Depth		True Vertical Depth	BHL From Lease, Unit, or Property Line:

LATERAL #2			
SEC	TWP	RGE	COUNTY
1/4	1/4	1/4	1/4
Depth of Deviation		Radius of Turn	Direction Total Length
Measured Total Depth		True Vertical Depth	BHL From Lease, Unit, or Property Line:

LATERAL #3			
SEC	TWP	RGE	COUNTY
1/4	1/4	1/4	1/4
Depth of Deviation		Radius of Turn	Direction Total Length
Measured Total Depth		True Vertical Depth	BHL From Lease, Unit, or Property Line: