

Oklahoma Corporation Commission
Oil & Gas Conservation Division
Post Office Box 52000
Oklahoma City, Oklahoma 73152-2000
Rule 165: 10-3-25

Form 1002A

API No.: 35119244450000

Completion Report

Spud Date: February 20, 2020

OTC Prod. Unit No.:

Drilling Finished Date: February 27, 2020

1st Prod Date: August 20, 2020

Completion Date: August 12, 2020

Drill Type: STRAIGHT HOLE

Well Name: JET 9-1

Purchaser/Measurer:

Location: PAYNE 9 19N 6E
E2 SW SW SW
330 FSL 363 FWL of 1/4 SEC
Derrick Elevation: 914 Ground Elevation: 905

First Sales Date:

Operator: LITTLE RIVER ENERGY COMPANY 10148
PO BOX 1113
1260 E BROADWAY
DRUMRIGHT, OK 74030-1113

Completion Type		Location Exception		Increased Density	
X	Single Zone	Order No		Order No	
	Multiple Zone	There are no Location Exception records to display.		There are no Increased Density records to display.	
	Commingled				

Casing and Cement							
Type	Size	Weight	Grade	Feet	PSI	SAX	Top of CMT
SURFACE	8.625	24	J	420	4000	250	SURFACE
PRODUCTION	5.50	15.5	J	2936	4000	75	2515

Liner								
Type	Size	Weight	Grade	Length	PSI	SAX	Top Depth	Bottom Depth
There are no Liner records to display.								

Total Depth: 3218

Packer		Plug	
Depth	Brand & Type	Depth	Plug Type
There are no Packer records to display.		There are no Plug records to display.	

Initial Test Data										
Test Date	Formation	Oil BBL/Day	Oil-Gravity (API)	Gas MCF/Day	Gas-Oil Ratio Cu FT/BBL	Water BBL/Day	Pumpin or Flowing	Initial Shut-In Pressure	Choke Size	Flow Tubing Pressure
Aug 14, 2020	OSWEGO	4	42			210	SWABBIN			

Completion and Test Data by Producing Formation			
Formation Name: OSWEGO		Code: 404OSWG	Class: OIL
Spacing Orders		Perforated Intervals	
Order No	Unit Size	From	To
NONE		2810	2820
Acid Volumes		Fracture Treatments	
1,500 GALLONS		NONE	

Formation	Top
BIG LIME	2740
OSWEGO	2790
VERDIGRIS	2940
PINK LIME	3080

Were open hole logs run? Yes
Date last log run: September 14, 2020

Were unusual drilling circumstances encountered? No
Explanation:

Other Remarks
There are no Other Remarks.

FOR COMMISSION USE ONLY	
Status: Accepted	1147740

API NO. 35-119-24445
OTC PROD. UNIT NO.

Oil and Gas Conservation Division
P.O. Box 52000
Oklahoma City, OK 73152-2000
405-521-2331
OCCCentralProcessing@OCC.OK.GOV



OKLAHOMA
Corporation
Commission

Form 1002A
Rev. 2021

☒ ORIGINAL
☐ AMENDED (Reason) _____

Rule 165:10-3-25

COMPLETION REPORT

TYPE OF DRILLING OPERATION

☒ STRAIGHT HOLE ☐ DIRECTIONAL HOLE ☐ HORIZONTAL HOLE
☐ SERVICE WELL

If directional or horizontal, see reverse for bottom hole location.

COUNTY	Payne	SEC	9	TWP	19N	RGE	6E	SPUD DATE	2/20/20
LEASE NAME	Jet			WELL NO.	9-1	DATE OF WELL COMPLETION	8/12/20	DRLG FINISHED DATE	2/27/20
ELEVATION	914	Ground	905	FSL	330	FWL	363	1st PROD DATE	8/20/20
OPERATOR NAME	LITTLE RIVER ENERGY CO.			RECOMP DATE		NA			
ADDRESS	PO BOX 1113								
CITY	DRUMRIGHT			STATE	OK	ZIP	74030		

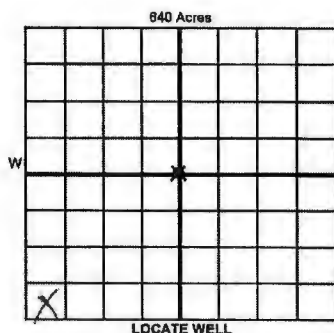

COMPLETION TYPE

<input checked="" type="radio"/> SINGLE ZONE	
<input type="radio"/> MULTIPLE ZONE	
<input type="radio"/> COMMINGLED	
LOCATION EXCEPTION ORDER NO.	
MULTIUNIT ORDER NO.	
INCREASED DENSITY ORDER NO.	

CASING & CEMENT (Attach Form 1002C)

TYPE	SIZE	WEIGHT	GRADE	FEET	PSI	SAX	TOP OF CMT
CONDUCTOR	-						
SURFACE	8.625	24	J	420	4000	250	SURFACE
INTERMEDIATE	-						
PRODUCTION	5.50	15.5	J	2936	4000	75	2515
LINER	-						

PACKER @ NA BRAND & TYPE PLUG @ TYPE PLUG @ TYPE TOTAL DEPTH 3218

COMPLETION & TEST DATA BY PRODUCING FORMATION

FORMATION	Oswego					No Frac
SPACING & SPACING ORDER NUMBER	none					
CLASS: Oil, Gas, Dry, Inj, Disp, Comm Disp, Svc	Oil					
PERFORATED INTERVALS	2810-2820					
	1 HPF					
ACID/VOLUME	1500 gals					
FRACTURE TREATMENT (Fluids/Prop Amounts)	none					

☐ Min Gas Allowable (165:10-17-7)
OR
☐ Oil Allowable (165:10-13-3)

Purchaser/Measurer
First Sales Date

INITIAL TEST DATA

INITIAL TEST DATE	8/14/20					
OIL-BBL/DAY	4					
OIL-GRAVITY (API)	42					
GAS-MCF/DAY	nominal					
GAS-OIL RATIO CU FT/BBL	NA					
WATER-BBL/DAY	210					
PUMPING OR FLOWING	swabbing					
INITIAL SHUT-IN PRESSURE	-0-					
CHOKE SIZE	NA					
FLOW TUBING PRESSURE	NA					

RECEIVED

MAR 17 2022

OKLAHOMA CORPORATION
COMMISSION

A record of the formations drilled through, and pertinent remarks are presented on the reverse. I declare that I have knowledge of the contents of this report and am authorized by my organization to make this report which was prepared by me or under my supervision and direction, with the data and facts stated herein to be true, correct, and complete to the best of my knowledge and belief.

SIGNATURE	R. Steve Crowder, Pres.	03/13/22	918-362-4444
PO Box 1113	Drumright OK 74030	DATE	PHONE NUMBER
ADDRESS	CITY STATE ZIP	EMAIL ADDRESS	

PLEASE TYPE OR USE BLACK INK ONLY
FORMATION RECORD

Give formation names and tops, if available, or descriptions and thickness of formations drilled through. Show intervals cored or drillstem tested.

NAMES OF FORMATIONS	TOP
Big Lime	2740
Oswego	2790
Verdigris	2940
Pink Lime	3080
TD	3218

LEASE NAME Jet WELL NO. 9-1

FOR COMMISSION USE ONLY	
ITD on file <input type="checkbox"/> YES <input type="checkbox"/> NO	
APPROVED <input type="checkbox"/> DISAPPROVED <input type="checkbox"/>	2) Reject Codes

Were open hole logs run?	<input checked="" type="radio"/> yes <input type="radio"/> no
Date Last log was run	9/14/20 (Bond Log)
Was CO ₂ encountered?	<input type="radio"/> yes <input checked="" type="radio"/> no at what depths?
Was H ₂ S encountered?	<input type="radio"/> yes <input checked="" type="radio"/> no at what depths?
Were unusual drilling circumstances encountered?	<input type="radio"/> yes <input checked="" type="radio"/> no
If yes, briefly explain below.	

Other remarks:

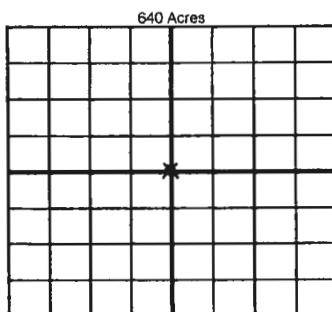

If more than three drainholes are proposed, attach a separate sheet indicating the necessary information.

Direction must be stated in degrees azimuth. Please note, the horizontal drainhole and its end point must be located within the boundaries of the lease or spacing unit.

Directional surveys are required for all drainholes and directional wells

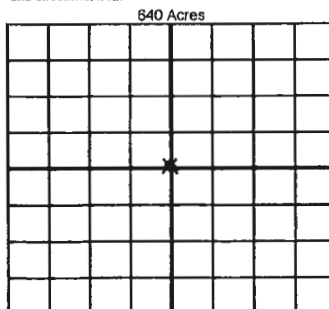

BOTTOM HOLE LOCATION FOR DIRECTIONAL HOLE

SEC	TWP	RGE	COUNTY
1/4	1/4	1/4	1/4
Measured Total Depth		True Vertical Depth	
		BHL From Lease, Unit, or Property Line:	

BOTTOM HOLE LOCATION FOR HORIZONTAL HOLE: (LATERALS)

LATERAL #1			
SEC	TWP	RGE	COUNTY
1/4	1/4	1/4	1/4
Depth of Deviation		Radius of Turn	Direction
Measured Total Depth		True Vertical Depth	Total Length
		BHL From Lease, Unit, or Property Line:	

LATERAL #2			
SEC	TWP	RGE	COUNTY
1/4	1/4	1/4	1/4
Depth of Deviation		Radius of Turn	Direction
Measured Total Depth		True Vertical Depth	Total Length
		BHL From Lease, Unit, or Property Line:	

LATERAL #3			
SEC	TWP	RGE	COUNTY
1/4	1/4	1/4	1/4
Depth of Deviation		Radius of Turn	Direction
Measured Total Depth		True Vertical Depth	Total Length
		BHL From Lease, Unit, or Property Line:	