

Oklahoma Corporation Commission
Oil & Gas Conservation Division
Post Office Box 52000
Oklahoma City, Oklahoma 73152-2000
Rule 165: 10-3-25

Form 1002A

API No.: 35137092020003

Completion Report

Spud Date: August 23, 1951

OTC Prod. Unit No.:

Drilling Finished Date: September 28, 1951

Amended

1st Prod Date: October 03, 1951

Amend Reason: COMPLETE AS WATER INJECTION WELL

Completion Date: October 03, 1951

Recomplete Date: February 06, 2018

Drill Type: STRAIGHT HOLE

SERVICE WELL

Well Name: NORTH DOYLE PENN SAND UNIT (HATTIE HARRELL 1) 8-1

Purchaser/Measurer:

Location: STEPHENS 3 1N 5W
S2 NE NE SE
2280 FSL 2310 FWL of 1/4 SEC
Latitude: 34.58593 Longitude: -97.70447
Derrick Elevation: 1149 Ground Elevation: 1134

First Sales Date:

Operator: PHOENIX PETROCORP INC 19499

3900 S STONEBRIDGE DR STE 1201
MCKINNEY, TX 75070-8084

Completion Type		Location Exception		Increased Density	
X	Single Zone	Order No		Order No	
	Multiple Zone	There are no Location Exception records to display.		There are no Increased Density records to display.	
	Commingled				

Casing and Cement								
Type		Size	Weight	Grade	Feet	PSI	SAX	Top of CMT
SURFACE		10 3/4	32.5		452		375	SURFACE
PRODUCTION		5 1/2	15.5	J-55	5848		500	4720

Liner								
Type	Size	Weight	Grade	Length	PSI	SAX	Top Depth	Bottom Depth
LINER	3 1/2	9.5	J-55	976	0	110	5182	6158

Total Depth: 6160

Packer		Plug	
Depth	Brand & Type	Depth	Plug Type
5632	ARROWSET 1	There are no Plug records to display.	

Initial Test Data

Test Date	Formation	Oil BBL/Day	Oil-Gravity (API)	Gas MCF/Day	Gas-Oil Ratio Cu FT/BBL	Water BBL/Day	Pumpin or Flowing	Initial Shut- In Pressure	Choke Size	Flow Tubing Pressure
-----------	-----------	----------------	----------------------	----------------	----------------------------	------------------	----------------------	---------------------------------	---------------	-------------------------

There are no Initial Data records to display.

Completion and Test Data by Producing Formation

Formation Name: PENN SD Code: 409PVSD Class: INJ

Spacing Orders		Perforated Intervals	
Order No	Unit Size	From	To
150290	UNIT	5700	5787
		5990	6029
Acid Volumes		Fracture Treatments	
There are no Acid Volume records to display.		There are no Fracture Treatments records to display.	

Formation	Top
-----------	-----

Were open hole logs run? No
Date last log run:

Were unusual drilling circumstances encountered? No
Explanation:

Other Remarks
UIC PERMIT NUMBER 1708080005. EXCEPTION NUMBER 664136

FOR COMMISSION USE ONLY

1143955

Status: Accepted

API NO. 137-09202
OTC PROD. UNIT NO. 404911933

(PLEASE TYPE OR USE BLACK INK ONLY)

OKLAHOMA CORPORATION COMMISSION
Oil & Gas Conservation Division
Post Office Box 52000
Oklahoma City, Oklahoma 73152-2000
Rule 165:10-3-25

RECEIVED

Form 1002A
Rev. 2009

OCT 17 2019

OKLAHOMA CORPORATION COMMISSION

ORIGINAL
☒ AMENDED (Reason) COMPLETE AS WATER INJECTION WELL

COMPLETION REPORT

TYPE OF DRILLING OPERATION

☒ STRAIGHT HOLE ☐ DIRECTIONAL HOLE ☐ HORIZONTAL HOLE
☒ SERVICE WELL

If directional or horizontal, see reverse for bottom hole location.

COUNTY	STEPHENS	SEC	3	TWP	1N	RGE	5W	SPUD DATE	8-23-1951
LEASE NAME	NORTH DOYLE PENN UNIT							DRLG FINISHED DATE	9-28-1951
S/2 1/4 NE 1/4 NE 1/4 SE 1/4	FSL OF 1/4 SEC 2280		FWL OF 1/4 SEC 2310		WELL NO.		8-1	DATE OF WELL COMPLETION	10-3-1951
ELEVATION Derrick FL	1149	Ground	1134	Latitude (if known)	34.58593		Longitude (if known)	-97.70447	
OPERATOR NAME	PHOENIX PETROCORP INC.							OTC / OCC OPERATOR NO.	19499
ADDRESS	3900 STONEBRIDGE DR. SUITE 1201								
CITY	McKINNEY			STATE	TX	ZIP	75070		

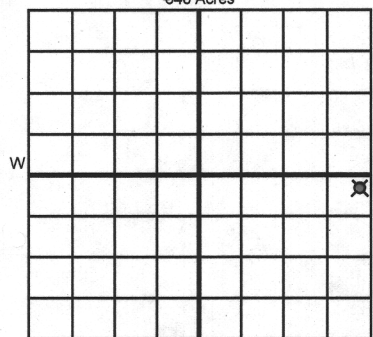

LOCATE WELL

COMPLETION TYPE

<input checked="" type="checkbox"/> SINGLE ZONE	
<input type="checkbox"/> MULTIPLE ZONE	
Application Date	
COMMINGLED	
Application Date	
LOCATION EXCEPTION ORDER NO.	
INCREASED DENSITY ORDER NO.	

CASING & CEMENT (Attach Form 1002C)

TYPE	SIZE	WEIGHT	GRADE	FEET	PSI	SAX	TOP OF CMT
CONDUCTOR							
SURFACE	10-3/4"	32.5#		452'		375	CIRC to Surface
INTERMEDIATE							
PRODUCTION	5-1/2"	15.5#	J55	5848'		500	4720'
LINER	3-1/2"	9.5#	J55	5182'-6158'		110	

PACKER @ 5632' BRAND & TYPE ARROWSET 1 PLUG @ TYPE PLUG @ TYPE
PACKER @ BRAND & TYPE PLUG @ TYPE PLUG @ TYPE

TOTAL DEPTH 6160'

COMPLETION & TEST DATA BY PRODUCING FORMATION

FORMATION	409 PVSD - Penn sand				
SPACING & SPACING ORDER NUMBER	150290 unit				
CLASS: Oil, Gas, Dry, Inj, Disp, Comm Disp, Svc	INJ	(SEE REMARKS)			
PERFORATED INTERVALS	5700'-5787'				
	5990'-6029'				
ACID/VOLUME					
FRACTURE TREATMENT (Fluids/Prop Amounts)					

Min Gas Allowable (165:10-17-7)

Gas Purchaser/Measurer



OR

First Sales Date

Oil Allowable (165:10-13-3)

INITIAL TEST DATA

INITIAL TEST DATE					
OIL-BBL/DAY					
OIL-GRAVITY (API)					
GAS-MCF/DAY					
GAS-OIL RATIO CU FT/BBL					
WATER-BBL/DAY					
PUMPING OR FLOWING					
INITIAL SHUT-IN PRESSURE					
CHOKE SIZE					
FLOW TUBING PRESSURE					

AS SUBMITTED

A record of the formations drilled through, and pertinent remarks are presented on the reverse. I declare that I have knowledge of the contents of this report and am authorized by my organization to make this report, which was prepared by me or under my supervision and direction, with the data and facts stated herein to be true, correct, and complete to the best of my knowledge and belief.

SIGNATURE	CLINT FULLER	10/14/2019	469-452-6036
3900 STONEBRIDGE DR. SUITE 1201	McKINNEY TX 75070	DATE	PHONE NUMBER
ADDRESS	CITY STATE ZIP	EMAIL ADDRESS c.fuller@phoenixpetrocorp.com	

Give formation names and tops, if available, or descriptions and thickness of formations drilled through. Show intervals cored or drillstem tested.

NAMES OF FORMATIONS	TOP

NAMES OF FORMATIONS	TOP

ITD on file ☐ YES ☐ NO

APPROVED DISAPPROVED

2) Reject Codes

Were open hole logs run?	yes	no
--------------------------	-----	----

Date Last log was run _____

Was CO ₂ encountered?	yes	no	at what depths?
----------------------------------	-----	----	-----------------

Was H₂S encountered? yes no at what depths?

Were unusual drilling circumstances encountered? _____ yes _____ no
If yes, briefly explain below

Other remarks: UIC PERMIT #1708080005 EXCEPTION #664136

640 Acres

If more than three drainholes are proposed, attach a separate sheet indicating the necessary information.

Direction must be stated in degrees azimuth.
Please note, the horizontal drainhole and its end
point must be located within the boundaries of the
lease or spacing unit.

Directional surveys are required for all drainholes and directional wells.

640 Acres

SEC	TWP	RGE	COUNTY
Spot Location			
1/4	1/4	1/4	1/4
Measured Total Depth		True Vertical Depth	Feet From 1/4 Sec Lines
			FSL
		BHL From Lease, Unit, or Property Line:	
			FWL

LATERAL #1						
SEC	TWP	RGE	COUNTY			
Spot Location						
1/4	1/4	1/4	1/4	Feet From 1/4 Sec Lines	FSL	FWL
Depth of Deviation		Radius of Turn		Direction		Total Length
Measured Total Depth		True Vertical Depth		BHL From Lease, Unit, or Property Line:		

SEC	TWP	RGE	COUNTY				
Spot Location							
1/4	1/4	1/4	1/4	Feet From 1/4 Sec Lines	FSL		FWL
Depth of Deviation		Radius of Turn		Direction	Total Length		
Measured Total Depth		True Vertical Depth		BHL From Lease, Unit, or Property Line:			

SEC	TWP	RGE	COUNTY			
Spot Location						
1/4	1/4	1/4	1/4	Feet From 1/4 Sec Lines	FSL	FWL
Depth of Deviation		Radius of Turn	Direction	Total Length		
Measured Total Depth		True Vertical Depth	BHL From Lease, Unit, or Property Line:			