

Oklahoma Corporation Commission
Oil & Gas Conservation Division
Post Office Box 52000
Oklahoma City, Oklahoma 73152-2000
Rule 165: 10-3-25

Form 1002A

API No.: 35037094850001

Completion Report

Spud Date: July 16, 1964

OTC Prod. Unit No.:

Drilling Finished Date: July 30, 1964

Amended

1st Prod Date:

Amend Reason: CONVERT TO INJECTION / RAN LINER

Completion Date: September 22, 1964

Recomplete Date: August 16, 2019

Drill Type: STRAIGHT HOLE

SERVICE WELL

Well Name: JENNETTA RICHARD 21

Purchaser/Measurer:

Location: CREEK 4 17N 7E
SW NE SW NE
760 FSL 685 FWL of 1/4 SEC
Latitude: 35.98328 Longitude: -96.57253
Derrick Elevation: 901 Ground Elevation: 894

First Sales Date:

Operator: PETCO PETROLEUM CORP 19386

108 E OGDEN AVE
HINSDALE, IL 60521-3572

Completion Type		Location Exception		Increased Density	
X	Single Zone	Order No		Order No	
	Multiple Zone	There are no Location Exception records to display.		There are no Increased Density records to display.	
	Commingled				

Casing and Cement							
Type	Size	Weight	Grade	Feet	PSI	SAX	Top of CMT
SURFACE	8 5/8	24		52		35	SURFACE
PRODUCTION	5 1/2	14		2522		900	N/A

Liner								
Type	Size	Weight	Grade	Length	PSI	SAX	Top Depth	Bottom Depth
LINER	4 1/2	11.6	J-55	0	0	110	SURFACE	2477

Total Depth: 2620

Packer		Plug	
Depth	Brand & Type	Depth	Plug Type
2450	CBP-1	There are no Plug records to display.	

Initial Test Data

Test Date	Formation	Oil BBL/Day	Oil-Gravity (API)	Gas MCF/Day	Gas-Oil Ratio Cu FT/BBL	Water BBL/Day	Pumpin or Flowing	Initial Shut- In Pressure	Choke Size	Flow Tubing Pressure
There are no Initial Data records to display.										

Completion and Test Data by Producing Formation										
Formation Name: BARTLESVILLE				Code: 404BRVL			Class: INJ			

Formation	Top
SEE ORIGINAL 1002A	0

Were open hole logs run? No
Date last log run:

Were unusual drilling circumstances encountered? No
Explanation:

Other Remarks
OCC - THIS WELL IS AN OPEN HOLE COMPLETION FROM BOTTOM OF THE 5 1/2" CASING AT 2,522' TO TOTAL DEPTH AT 2,620'. UIC ORDER NUMBER 81887

FOR COMMISSION USE ONLY	
Status: Accepted	1143963

API NO. 3503709485
OTC PROD.
UNIT NO.

(PLEASE TYPE OR USE BLACK INK ONLY)

OKLAHOMA CORPORATION COMMISSION

Oil & Gas Conservation Division
Post Office Box 52000

Oklahoma City, Oklahoma 73152-2000
Rule 165:10-3-25

RECEIVED

Form 1002A
Rev. 2009

OCT 18 2019

OKLAHOMA CORPORATION COMMISSION

☐ ORIGINAL
☒ AMENDED (Reason)

Convert to Injection
ran liner

COMPLETION REPORT

TYPE OF DRILLING OPERATION

☒ STRAIGHT HOLE ☐ DIRECTIONAL HOLE ☐ HORIZONTAL HOLE
☒ SERVICE WELL

If directional or horizontal, see reverse for bottom hole location.

COUNTY	Creek	SEC	4	TWP	17N	RGE	7E
LEASE NAME	Jennetta Richard			WELL NO.	21		
ELEVATION	901			FSL OF 1/4 SEC	760		
Derrick FL	Ground			FWL OF 1/4 SEC	685		
Latitude (if known)	35.98328			Longitude (if known)	-96.57253		
OPERATOR NAME	Petco Petroleum Corp.			OTC / OCC OPERATOR NO.	19386		
ADDRESS	108 E. Ogden Ave.						
CITY	Hinsdale			STATE	IL	ZIP	60521

SPUD DATE	7-16-1964
DRILLING FINISHED DATE	7-30-1964
DATE OF WELL COMPLETION	9-22-64
1st PROD DATE	
RECOMP DATE	8-16-2019

640 Acres							
LOCATE WELL							

COMPLETION TYPE

<input checked="" type="checkbox"/> SINGLE ZONE	
<input type="checkbox"/> MULTIPLE ZONE	
Application Date	
COMINGLED	
Application Date	
LOCATION EXCEPTION ORDER NO.	
INCREASED DENSITY ORDER NO.	

CASING & CEMENT (Attach Form 1002C)

TYPE	SIZE	WEIGHT	GRADE	FEET	PSI	SAX	TOP OF CMT
CONDUCTOR							
SURFACE	8 5/8	24#		52		35	SURFACE
INTERMEDIATE							
PRODUCTION	5 1/2	14#		2522		900	NA
LINER	4 1/2	11.6#	J-55	2477		110	SURFACE
						TOTAL DEPTH	2620'

PACKER @ 2450' BRAND & TYPE CBP-1
PACKER @ BRAND & TYPE

PLUG @ TYPE PLUG @ TYPE
PLUG @ TYPE PLUG @ TYPE

COMPLETION & TEST DATA BY PRODUCING FORMATION

FORMATION	Bartlesville
SPACING & SPACING	
ORDER NUMBER	
CLASS: Oil, Gas, Dry, Inj, Disp, Comm Disp, Svc	Inj.
PERFORATED INTERVALS	2522'-2620' open hole
ACID/VOLUME	
FRACTURE TREATMENT (Fluids/Prop Amounts)	

☐ Min Gas Allowable (165:10-17-7)
OR
☐ Oil Allowable (165:10-13-3)
Gas Purchaser/Measurer
First Sales Date

INITIAL TEST DATA

INITIAL TEST DATE	
OIL-BBL/DAY	
OIL-GRAVITY (API)	
GAS-MCF/DAY	
GAS-OIL RATIO CU FT/BBL	
WATER-BBL/DAY	
PUMPING OR FLOWING	
INITIAL SHUT-IN PRESSURE	
CHOKE SIZE	
FLOW TUBING PRESSURE	

AS SUBMITTED

A record of the formations drilled through, and pertinent remarks are presented on the reverse. I declare that I have knowledge of the contents of this report and am authorized by my organization to make this report, which was prepared by me or under my supervision and direction, with the data and facts stated herein to be true, correct, and complete to the best of my knowledge and belief.

SIGNATURE	Darren Kimple	10/14/2019	850-541-8630
8317 Front Beach Rd., Ste. 37K	Panama City Bch. FL 32407	DATE	PHONE NUMBER
ADDRESS	CITY STATE ZIP	EMAIL ADDRESS	

PLEASE TYPE OR USE BLACK INK ONLY
FORMATION RECORD

Give formation names and tops, if available, or descriptions and thickness of formations drilled through. Show intervals cored or drillstem tested.

NAMES OF FORMATIONS	TOP
see original 1002A	

LEASE NAME Jennetta Richard WELL NO. 21

FOR COMMISSION USE ONLY	
ITD on file <input type="checkbox"/> YES <input type="checkbox"/> NO	
APPROVED _____ DISAPPROVED _____	2) Reject Codes

Were open hole logs run?	_____ yes _____ no
Date Last log was run	_____
Was CO ₂ encountered?	_____ yes _____ no at what depths? _____
Was H ₂ S encountered?	_____ yes _____ no at what depths? _____
Were unusual drilling circumstances encountered?	_____ yes _____ no
If yes, briefly explain below	

Other remarks:

OCC - This well is an open hole completion from bottom of the 5 1/2" casing at 2522' to total depth at 2620' W/ORDER 81887

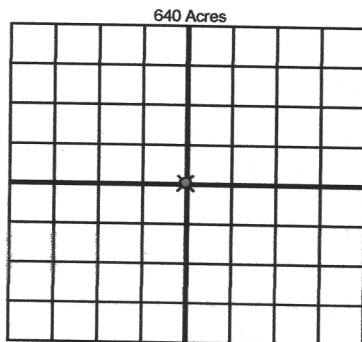

If more than three drainholes are proposed, attach a separate sheet indicating the necessary information.

Direction must be stated in degrees azimuth. Please note, the horizontal drainhole and its end point must be located within the boundaries of the lease or spacing unit.

Directional surveys are required for all drainholes and directional wells.

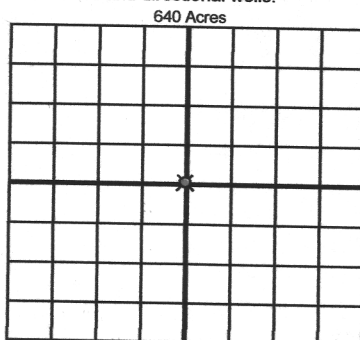

BOTTOM HOLE LOCATION FOR DIRECTIONAL HOLE

SEC	TWP	RGE	COUNTY
Spot Location			
1/4	1/4	1/4	1/4
Measured Total Depth		True Vertical Depth	BHL From Lease, Unit, or Property Line:

BOTTOM HOLE LOCATION FOR HORIZONTAL HOLE: (LATERALS)

LATERAL #1			
SEC	TWP	RGE	COUNTY
Spot Location			
1/4	1/4	1/4	1/4
Depth of Deviation		Radius of Turn	Direction
Measured Total Depth		True Vertical Depth	Total Length
			BHL From Lease, Unit, or Property Line:

LATERAL #2			
SEC	TWP	RGE	COUNTY
Spot Location			
1/4	1/4	1/4	1/4
Depth of Deviation		Radius of Turn	Direction
Measured Total Depth		True Vertical Depth	Total Length
			BHL From Lease, Unit, or Property Line:

LATERAL #3			
SEC	TWP	RGE	COUNTY
Spot Location			
1/4	1/4	1/4	1/4
Depth of Deviation		Radius of Turn	Direction
Measured Total Depth		True Vertical Depth	Total Length
			BHL From Lease, Unit, or Property Line: