

Oklahoma Corporation Commission  
Oil & Gas Conservation Division  
Post Office Box 52000  
Oklahoma City, Oklahoma 73152-2000  
Rule 165: 10-3-25

Form 1002A

API No.: 35133222040002

**Completion Report**

Spud Date: December 14, 1982

OTC Prod. Unit No.:

Drilling Finished Date: December 17, 1982

**Amended**

1st Prod Date:

Amend Reason: CONVERT SALTWATER DISPOSAL TO PRODUCER

Completion Date: January 08, 1983

Recomplete Date: January 20, 2020

**Drill Type: STRAIGHT HOLE**

Well Name: BERRYMAN 1

Purchaser/Measurer:

Location: SEMINOLE 10 10N 8E  
C SW NE NW  
1650 FSL 1650 FWL of 1/4 SEC  
Derrick Elevation: 929 Ground Elevation: 925

First Sales Date:

Operator: NATURAL RESOURCES OP LLC 20923

1831 E IMHOFF RD STE 100  
NORMAN, OK 73071-1295

Completion Type		Location Exception		Increased Density	
X	Single Zone	Order No		Order No	
	Multiple Zone	There are no Location Exception records to display.		There are no Increased Density records to display.	
	Commingled				

Casing and Cement							
Type	Size	Weight	Grade	Feet	PSI	SAX	Top of CMT
CONDUCTOR	8 5/8	23	H-40	84	2000	70	SURFACE
PRODUCTION	4 1/2	9.5	J-55	1660	4000	400	SURFACE

Liner								
Type	Size	Weight	Grade	Length	PSI	SAX	Top Depth	Bottom Depth
There are no Liner records to display.								

**Total Depth: 1660**

Packer		Plug	
Depth	Brand & Type	Depth	Plug Type
There are no Packer records to display.		There are no Plug records to display.	

Initial Test Data										
Test Date	Formation	Oil BBL/Day	Oil-Gravity (API)	Gas MCF/Day	Gas-Oil Ratio Cu FT/BBL	Water BBL/Day	Pumpin or Flowing	Initial Shut-In Pressure	Choke Size	Flow Tubing Pressure
Jan 20, 2020	WEWOKA	0.5	39			10	PUMPING			

API NO. 13322204  
OTC PROD.  
UNIT NO.

(PLEASE TYPE OR USE BLACK INK ONLY)

OKLAHOMA CORPORATION COMMISSION

Oil & Gas Conservation Division

Post Office Box 52000

Oklahoma City, Oklahoma 73152-2000

Rule 165:10-3-25

Form 1002A

Rev. 2009

ORIGINAL  
AMENDED (Reason)

Convert SWD to Producer

COMPLETION REPORT

TYPE OF DRILLING OPERATION

☒ STRAIGHT HOLE ☐ DIRECTIONAL HOLE ☐ HORIZONTAL HOLE  
☐ SERVICE WELL

If directional or horizontal, see reverse for bottom hole location.

COUNTY	Seminole	SEC	10	TWP	10N	RGE	8E	SPUD DATE	12/14/82
LEASE NAME	Berryman	WELL NO.	1	DATE OF WELL COMPLETION	1/8/83	1st PROD DATE	DA	DRLG FINISHED DATE	12/17/82
C SW 1/4 NE 1/4 NW 1/4	1/4	FSL OF 1/4 SEC	1/50	FWL OF 1/4 SEC	1/50	RECOMP DATE	1/20/2020		
ELEVATION Derrick FL	929	Ground	925	Latitude (if known)		Longitude (if known)			
OPERATOR NAME	Natural Resources Operating Co.	OTC / OCC	20923						
ADDRESS	1831 E Imhoff Rd Suite 100								
CITY	NORMAN	STATE	OK	ZIP	73071				

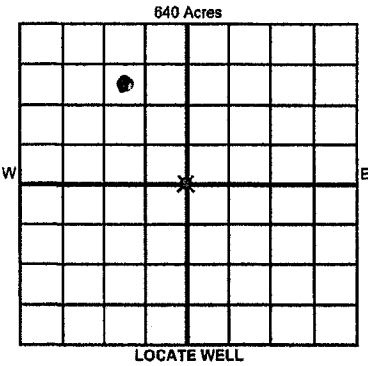

COMPLETION TYPE

<input checked="" type="checkbox"/> SINGLE ZONE	
<input type="checkbox"/> MULTIPLE ZONE	
<input type="checkbox"/> COMMINGLED	
<input type="checkbox"/> LOCATION EXCEPTION	
<input type="checkbox"/> ORDER NO.	
<input type="checkbox"/> INCREASED DENSITY	
<input type="checkbox"/> ORDER NO.	

CASING & CEMENT (Attach Form 1002C)

TYPE	SIZE	WEIGHT	GRADE	FEET	PSI	SAX	TOP OF CMT
CONDUCTOR							
SURFACE	8 5/8	23	H40	84'	2000	70	Surf
INTERMEDIATE							
PRODUCTION	4 1/2	9.5	55	1660'	4000	460	Surf
LINER							

PACKER @ \_\_\_\_\_ BRAND & TYPE \_\_\_\_\_

PLUG @ \_\_\_\_\_ TYPE \_\_\_\_\_

PLUG @ \_\_\_\_\_ TYPE \_\_\_\_\_

TOTAL DEPTH 1660'

COMPLETION & TEST DATA BY PRODUCING FORMATION

FORMATION	DeWoka					No Frac
SPACING & SPACING ORDER NUMBER	Unspaced					
CLASS: Oil, Gas, Dry, Inj, Disp, Comm Disp, Svc	Oil					
PERFORATED INTERVALS	1552-56'					
	1614-20'					
ACID/VOLUME	Done 500 gal 7 1/2% (Done 2-16-88)					
FRACTURE TREATMENT (Fluids/Prop Amounts)	Done					

Min Gas Allowable (165:10-17-7)

Gas Purchaser/Measurer



OR

First Sales Date

INITIAL TEST DATA

Oil Allowable (165:10-13-3)

INITIAL TEST DATE	1/20/20					
OIL-BBL/DAY	0.5					
OIL-GRAVITY (API)	39					
GAS-MCF/DAY	0					
GAS-OIL RATIO CU FT/BBL	0					
WATER-BBL/DAY	10					
PUMPING OR FLOWING	Pumping					
INITIAL SHUT-IN PRESSURE	8					
CHOKE SIZE	5					
FLOW TUBING PRESSURE	0					

A record of the formations drilled through, and pertinent remarks are presented on the reverse. I declare that I have knowledge of the contents of this report and am authorized by my organization to make this report, which was prepared by me or under my supervision and direction, with the data and facts stated herein to be true, correct, and complete to the best of my knowledge and belief.

SIGNATURE	NAME (PRINT OR TYPE)	DATE	PHONE NUMBER
1831 E Imhoff Rd	NORMAN OK 73071	4/1/20	405 366-8885
ADDRESS	CITY STATE ZIP	EMAIL ADDRESS	patrick@octagonresources.com

**PLEASE TYPE OR USE BLACK INK ONLY**  
**FORMATION RECORD**

Give formation names and tops, if available, or descriptions and thickness of formations drilled through. Show intervals cored or drillstem tested.

NAMES OF FORMATIONS	TOP
Leflon Weverka	1125' 1552'

LEASE NAME \_\_\_\_\_ WELL NO. \_\_\_\_\_

FOR COMMISSION USE ONLY	
ITD on file <input type="checkbox"/> YES <input type="checkbox"/> NO	
APPROVED _____	DISAPPROVED _____
2) Reject Codes	

Were open hole logs run?	<input checked="" type="checkbox"/> yes <input type="checkbox"/> no
Date Last log was run	12/17/80
Was CO <sub>2</sub> encountered?	yes _____ no _____ at what depths? _____
Was H <sub>2</sub> S encountered?	yes _____ no _____ at what depths? _____
Were unusual drilling circumstances encountered? If yes, briefly explain below.	yes _____ <input checked="" type="checkbox"/> no

Other remarks:

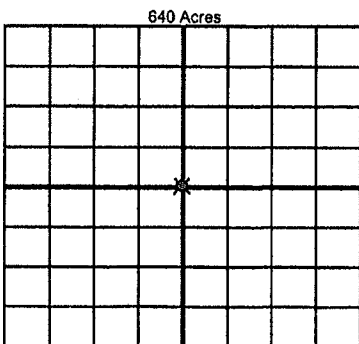
If more than three drainholes are proposed, attach a separate sheet indicating the necessary information.

Direction must be stated in degrees azimuth.  
Please note, the horizontal drainhole and its end point must be located within the boundaries of the lease or spacing unit.

Directional surveys are required for all drainholes and directional wells.

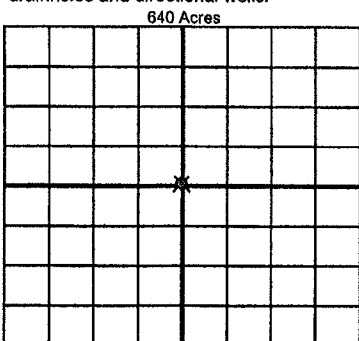

**BOTTOM HOLE LOCATION FOR DIRECTIONAL HOLE**

SEC	TWP	RGE	COUNTY
Spot Location			
1/4	1/4	1/4	1/4
Measured Total Depth		True Vertical Depth	BHL From Lease, Unit, or Property Line:

**BOTTOM HOLE LOCATION FOR HORIZONTAL HOLE: (LATERALS)**

**LATERAL #1**

SEC	TWP	RGE	COUNTY
Spot Location			
1/4	1/4	1/4	1/4
Depth of Deviation		Radius of Turn	Direction
Measured Total Depth		True Vertical Depth	BHL From Lease, Unit, or Property Line:

**LATERAL #2**

SEC	TWP	RGE	COUNTY
Spot Location			
1/4	1/4	1/4	1/4
Depth of Deviation		Radius of Turn	Direction
Measured Total Depth		True Vertical Depth	BHL From Lease, Unit, or Property Line:

**LATERAL #3**

SEC	TWP	RGE	COUNTY
Spot Location			
1/4	1/4	1/4	1/4
Depth of Deviation		Radius of Turn	Direction
Measured Total Depth		True Vertical Depth	BHL From Lease, Unit, or Property Line:

BOB ANTHONY  
Commissioner

TODD HIETT  
Commissioner

DANA MURPHY  
Commissioner

OKLAHOMA  
CORPORATION COMMISSION  
P.O. BOX 52000  
OKLAHOMA CITY, OKLAHOMA 73152-2000

258 Jim Thorpe Building

OIL & GAS CONSERVATION DIVISION

Technical Services Dept.



Q1002A.AMD

March 20, 2020

20923-0

NATURAL RESOURCES OPERATING LLC  
ATTN: STEPHEN L HARRIS  
1831 E IMHOFF ROAD, SUITE 100  
NORMAN, OK 73071-1295

RE: BERRYMAN 1, API 133-22204-01, C SW NE NW 10-10N-06E, SEMINOLE COUNTY

Dear Mr. Harris:

According to our records, we have not received an amended Form 1002A Completion Report showing recompletion status for the above well, as required by Rule 165:10-3-25. This rule states in part that an amended completion report shall be submitted within 60 days after completion of operations to re-enter, re-complete and/or convert a well, regardless of whether a well is a producer, dry hole, injection, disposal or service well, or a well that was plugged at a later date.

We are requesting that you submit your amended Form 1002A Completion Report within 15 days from the date of receipt of this letter. Please submit this form along with a copy of this letter, marked to the attention of the staff member named in the closing sentence.

If you require further assistance or have questions, please contact Dennis Niskern at (405) 522-2977.

Sincerely,

A handwritten signature in black ink, appearing to read "Duncan Woodliff", written over a horizontal line.

Duncan Woodliff  
Compliance Section

xc: Judicial and Legislative Services

Completion and Test Data by Producing Formation			
Formation Name: WEWOKA		Code: 404WWOK	Class: OIL
<b>Spacing Orders</b>		<b>Perforated Intervals</b>	
<b>Order No</b>	<b>Unit Size</b>	<b>From</b>	<b>To</b>
UNSPACED		1552	1556
		1614	1620
<b>Acid Volumes</b>		<b>Fracture Treatments</b>	
500 GALLONS 7 1/2% (DONE FEBRUARY 16, 1984)		NONE	

Formation	Top
LAYTON	1125
WEWOKA	1552

Were open hole logs run? Yes  
Date last log run: December 17, 1982  
Were unusual drilling circumstances encountered? No  
Explanation:

Other Remarks
There are no Other Remarks.

FOR COMMISSION USE ONLY	
Status: Accepted	1145011