

Oklahoma Corporation Commission
Oil & Gas Conservation Division
Post Office Box 52000
Oklahoma City, Oklahoma 73152-2000
Rule 165: 10-3-25

Form 1002A

API No.: 35139004980001

Completion Report

Spud Date: May 03, 1947

OTC Prod. Unit No.: 139-014928

Drilling Finished Date: May 17, 1947

Amended

1st Prod Date:

Amend Reason: NEW FRAC

Completion Date: May 17, 1947

Recomplete Date: January 15, 2019

Drill Type: STRAIGHT HOLE

Well Name: ART 1

Purchaser/Measurer:

Location: TEXAS 36 2N 16E CM
NE NE NE SW
150 FNL 150 FEL of 1/4 SEC
Latitude: 36.59447 Longitude: -101.28703
Derrick Elevation: 2870 Ground Elevation: 2867

First Sales Date:

Operator: SCOUT ENERGY MANAGEMENT LLC 23138

4901 LBJ FWY STE 300
DALLAS, TX 75244-6107

Completion Type		Location Exception		Increased Density	
X	Single Zone	Order No		Order No	
	Multiple Zone	There are no Location Exception records to display.		There are no Increased Density records to display.	
	Commingled				

Casing and Cement							
Type	Size	Weight	Grade	Feet	PSI	SAX	Top of CMT
SURFACE	8.625	17.8	SJ SW	519	1000	300	SURFACE
PRODUCTION	5.5	14	H-40	2674	1000	900	SURFACE

Liner								
Type	Size	Weight	Grade	Length	PSI	SAX	Top Depth	Bottom Depth
There are no Liner records to display.								

Total Depth: 2685

Packer		Plug	
Depth	Brand & Type	Depth	Plug Type
2471	PACKER	There are no Plug records to display.	

Initial Test Data

Test Date	Formation	Oil BBL/Day	Oil-Gravity (API)	Gas MCF/Day	Gas-Oil Ratio Cu FT/BBL	Water BBL/Day	Pumpin or Flowing	Initial Shut- In Pressure	Choke Size	Flow Tubing Pressure
Jan 15, 2019	GUYMON-HUGOTON			32			FLOWING	171		

Completion and Test Data by Producing Formation

Formation Name: GUYMON-HUGOTON

Code: 451GYHG

Class: GAS

Spacing Orders

Order No	Unit Size
17867	640

Perforated Intervals

From	To
2521	2646

Acid Volumes

1,000 GALLONS 15% HCL

Fracture Treatments

51,000 POUNDS 16/30 SAND WITH 444 BARRELS WATER, 75 QUALITY FOAM
--

Formation	Top
HERINGTON	2518
KRIDER	2571
WINFIELD	2670

Were open hole logs run? No
Date last log run:

Were unusual drilling circumstances encountered? No
Explanation:

Other Remarks

OCC - THIS WELL IS BOTH PERFORATED FROM 2,521' - 2,646' AND AN OPEN HOLE COMPLETION FROM BOTTOM OF THE 5 1/2" CASING TO TOTAL DEPTH.

FOR COMMISSION USE ONLY

Status: Accepted

1142272

API NO. 139-00498
OTC PROD.
UNIT NO. 139-014928

(PLEASE TYPE OR USE BLACK INK ONLY)

OKLAHOMA CORPORATION COMMISSION
Oil & Gas Conservation Division
Post Office Box 52000
Oklahoma City, Oklahoma 73152-2000
Rule 165:10-3-25

RECEIVED

MAR 05 2019

Oklahoma Corporation
Commission

Form 1002A

Rev. 2009

☒ ORIGINAL
☒ AMENDED (Reason)

New
Recompletion Frac

COMPLETION REPORT

TYPE OF DRILLING OPERATION

☒ STRAIGHT HOLE ☐ DIRECTIONAL HOLE ☐ HORIZONTAL HOLE
☐ SERVICE WELL

If directional or horizontal, see reverse for bottom hole location.

COUNTY **Texas** SEC **36** TWP **2N** RGE **16ECM**
LEASE NAME **Art** WELL NO. **1**
NE 1/4 NE 1/4 SW 1/4 1/4 FNL OF 1/4 SEC **150** FEL OF 1/4 SEC **150** DATE OF WELL COMPLETION **05/17/1947**
ELEVATION **2870'** Ground **2867'** Latitude (if known) **36.59447** Longitude (if known) **-101.28703**
OPERATOR NAME **Scout Energy Management LLC** OTC/OCC OPERATOR NO. **23138**
ADDRESS **4901 LBJ Freeway, Ste 300**
CITY **Dallas** STATE **TX** ZIP **75244**

640 Acres

LOCATE WELL

COMPLETION TYPE

☒ SINGLE ZONE
☐ MULTIPLE ZONE
Application Date
☐ COMMINGLED
Application Date
LOCATION EXCEPTION
ORDER NO.
INCREASED DENSITY
ORDER NO.

CASING & CEMENT (Form 1002C must be attached)

TYPE	SIZE	WEIGHT	GRADE	FEET	PSI	SAX	TOP OF CMT
CONDUCTOR							
SURFACE	8.625	17.8	SJ SW	519'	1000	300	Surface
INTERMEDIATE							
PRODUCTION	5.5	14	H-40	2674'	1000	900	Surface
LINER							
TOTAL DEPTH							2685'

PACKER @ **2471'** BRAND & TYPE _____ PLUG @ _____ TYPE _____ PLUG @ _____ TYPE _____
PACKER @ _____ BRAND & TYPE _____ PLUG @ _____ TYPE _____ PLUG @ _____ TYPE _____

COMPLETION & TEST DATA BY PRODUCING FORMATION

FORMATION	(Chase) <i>Chaymon-Hugoton</i>								
SPACING & SPACING ORDER NUMBER	17867-640								
CLASS: Oil, Gas, Dry, Inj, Disp, Comm Disp, Svc	Gas								
PERFORATED INTERVALS	2521' - 2646'								
	2660' - 2685' open hole								
ACID/VOLUME	1000 gal. 15% HCl								
FRACTURE TREATMENT (Fluids/Prop Amounts)	51,000# 16/30 sand w/ 444 bbls wtr, 75 quality foam								

Min Gas Allowable (165:10-17-7)

Gas Purchaser/Measurer

First Sales Date

INITIAL TEST DATA

INITIAL TEST DATE	01/15/2019								
OIL-BBL/DAY	0								
OIL-GRAVITY (API)	NA								
GAS-MCF/DAY	32.4								
GAS-OIL RATIO CU FT/BBL	0								
WATER-BBL/DAY	NA								
PUMPING OR FLOWING	Flowing								
INITIAL SHUT-IN PRESSURE	171								
CHOKE SIZE	NA								
FLOW TUBING PRESSURE	NA								

AS SUBMITTED

A record of the formations drilled through, and pertinent remarks are presented on the reverse. I declare that I have knowledge of the contents of this report and am authorized by my organization to make this report, which was prepared by me or under my supervision and direction, with the data and facts stated herein to be true, correct, and complete to the best of my knowledge and belief.

Emily J. Van Der Gryp
SIGNATURE
4901 LBJ Freeway, Ste 300
ADDRESS

Emily J. Van Der Gryp
NAME (PRINT OR TYPE)
Dallas TX 75244
CITY STATE ZIP

03/04/2019 (972) 325-1146
DATE PHONE NUMBER
evandergryp@scoutep.com
EMAIL ADDRESS

PLEASE TYPE OR USE BLACK INK ONLY

FORMATION RECORD

Give formation names and tops, if available, or descriptions and thickness of formations drilled through. Show intervals cored or drillstem tested.

LEASE NAME Art

WELL NO. 1

NAMES OF FORMATIONS	TOP
Herrington	2518
Krider	2571
Winfield	2670
TD:	2685

FOR COMMISSION USE ONLY	
ITD on file <input type="checkbox"/> YES <input type="checkbox"/> NO	
APPROVED _____	DISAPPROVED _____
2) Reject Codes	

Were open hole logs run?	_____ yes <u>X</u> no
Date Last log was run	_____
Was CO ₂ encountered?	_____ yes <u>X</u> no at what depths? _____
Was H ₂ S encountered?	_____ yes <u>X</u> no at what depths? _____
Were unusual drilling circumstances encountered?	_____ yes <u>X</u> no
If yes, briefly explain below	

Other remarks:

DCC - This well is both perforated from 2521-2646 and an open hole completion from bottom of the 5 1/2" casing to total depth

640 Acres

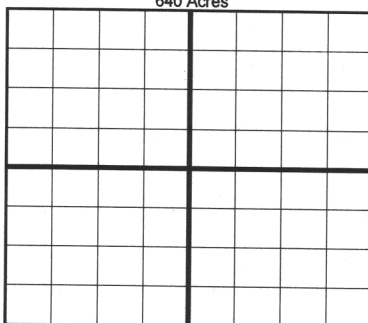

If more than three drainholes are proposed, attach a separate sheet indicating the necessary information.

Direction must be stated in degrees azimuth. Please note, the horizontal drainhole and its end point must be located within the boundaries of the lease or spacing unit.

Directional surveys are required for all drainholes and directional wells.

640 Acres

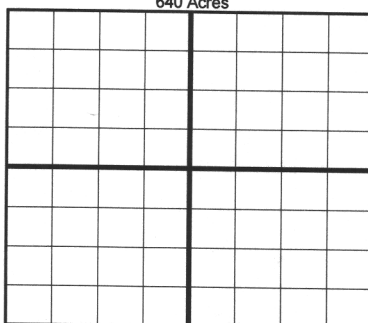

BOTTOM HOLE LOCATION FOR DIRECTIONAL HOLE

SEC	TWP	RGE	COUNTY
Spot Location			
1/4	1/4	1/4	1/4
Measured Total Depth		True Vertical Depth	Feet From 1/4 Sec Lines FSL FWL
BHL From Lease, Unit, or Property Line:			

BOTTOM HOLE LOCATION FOR HORIZONTAL HOLE: (LATERALS)

LATERAL #1			
SEC	TWP	RGE	COUNTY
Spot Location			
1/4	1/4	1/4	1/4
Depth of Deviation		Radius of Turn	Direction
Measured Total Depth		True Vertical Depth	Total Length
BHL From Lease, Unit, or Property Line:			

LATERAL #2			
SEC	TWP	RGE	COUNTY
Spot Location			
1/4	1/4	1/4	1/4
Depth of Deviation		Radius of Turn	Direction
Measured Total Depth		True Vertical Depth	Total Length
BHL From Lease, Unit, or Property Line:			

LATERAL #3			
SEC	TWP	RGE	COUNTY
Spot Location			
1/4	1/4	1/4	1/4
Depth of Deviation		Radius of Turn	Direction
Measured Total Depth		True Vertical Depth	Total Length
BHL From Lease, Unit, or Property Line:			

