

Oklahoma Corporation Commission
Oil & Gas Conservation Division
Post Office Box 52000
Oklahoma City, Oklahoma 73152-2000
Rule 165: 10-3-25

Form 1002A

API No.: 35139016600001

Completion Report

Spud Date: May 13, 1947

OTC Prod. Unit No.: 139-014945

Drilling Finished Date: May 31, 1947

Amended

1st Prod Date:

Amend Reason: NEW FRAC

Completion Date: June 08, 1947

Recomplete Date: January 15, 2019

Drill Type: STRAIGHT HOLE

Well Name: ROSCOE 1

Purchaser/Measurer:

Location: TEXAS 34 2N 16E CM
NE NE NE SW
150 FNL 150 FEL of 1/4 SEC
Latitude: 36.59444 Longitude: -101.32297
Derrick Elevation: 2860 Ground Elevation: 2857

First Sales Date:

Operator: SCOUT ENERGY MANAGEMENT LLC 23138

4901 LBJ FWY STE 300
DALLAS, TX 75244-6107

| Completion Type | | Location Exception | | Increased Density | |
|-----------------|---------------|---|--|--|--|
| X | Single Zone | Order No | | Order No | |
| | Multiple Zone | There are no Location Exception records to display. | | There are no Increased Density records to display. | |
| | Commingled | | | | |

| Casing and Cement | | | | | | | |
|-------------------|-------|--------|-------|------|------|-----|------------|
| Type | Size | Weight | Grade | Feet | PSI | SAX | Top of CMT |
| SURFACE | 8.625 | 17.8 | SJ SW | 517 | 1000 | 300 | SURFACE |
| PRODUCTION | 5.5 | 14 | H-40 | 2639 | 1000 | 900 | SURFACE |

| Liner | | | | | | | | |
|--|------|--------|-------|--------|-----|-----|-----------|--------------|
| Type | Size | Weight | Grade | Length | PSI | SAX | Top Depth | Bottom Depth |
| There are no Liner records to display. | | | | | | | | |

Total Depth: 2646

| Packer | | Plug | |
|--------|--------------|---------------------------------------|-----------|
| Depth | Brand & Type | Depth | Plug Type |
| 2425 | PACKER | There are no Plug records to display. | |

| Initial Test Data |
|-------------------|
|-------------------|

| Test Date | Formation | Oil BBL/Day | Oil-Gravity (API) | Gas MCF/Day | Gas-Oil Ratio Cu FT/BBL | Water BBL/Day | Pumpin or Flowing | Initial Shut-In Pressure | Choke Size | Flow Tubing Pressure |
|--------------|----------------|-------------|-------------------|-------------|-------------------------|---------------|-------------------|--------------------------|------------|----------------------|
| Jan 15, 2019 | GUYMON-HUGOTON | | | 32 | | | FLOWING | 185 | | |

| | | | | | |
|--|------------------|---------------|--|------------|--|
| Completion and Test Data by Producing Formation | | | | | |
| Formation Name: GUYMON-HUGOTON | | Code: 451GYHG | | Class: GAS | |
| Spacing Orders | | | Perforated Intervals | | |
| Order No | Unit Size | | From | To | |
| 17867 | 640 | | 2475 | 2596 | |
| Acid Volumes | | | Fracture Treatments | | |
| 1,000 GALLONS 15% HCL | | | 50,000 POUNDS 16/30 SAND WITH 444 BARRELS WATER, 75 QUALITY FOAM | | |

| Formation | Top |
|-----------|------|
| HERINGTON | 2471 |
| KRIDER | 2528 |
| WINFIELD | 2616 |

Were open hole logs run? No

Date last log run:

Were unusual drilling circumstances encountered? No

Explanation:

| |
|---|
| Other Remarks |
| OCC - THIS WELL IS COMPLETED BOTH FROM PERFORATIONS AND OPEN HOLE FROM BOTTOM OF THE 5 1/2" CASING AND TOTAL DEPTH. |

| | |
|--------------------------------|--------------------|
| FOR COMMISSION USE ONLY | |
| <div>Status: Accepted</div> | <div>1142274</div> |

API NO. 139-01660
OTC PROD. UNIT NO. 139-014945

(PLEASE TYPE OR USE BLACK INK ONLY)

OKLAHOMA CORPORATION COMMISSION

Oil & Gas Conservation Division

Post Office Box 52000

Oklahoma City, Oklahoma 73152-2000

Rule 165:10-3-25

RECEIVED

MAR 05 2019

Oklahoma Corporation Commission

Form 1002A

Rev. 2009

☒ ORIGINAL
☒ AMENDED (Reason)

Recompletion (Frac)

COMPLETION REPORT

TYPE OF DRILLING OPERATION

☒ STRAIGHT HOLE ☐ DIRECTIONAL HOLE ☐ HORIZONTAL HOLE

If directional or horizontal, see reverse for bottom hole location.

COUNTY Texas SEC 34 TWP 2N RGE 16ECM
LEASE NAME Roscoe WELL NO. 1
ELEVATION NE 1/4 NE 1/4 SW 1/4 1/4 FNL OF 1/4 SEC 150 FEL OF 1/4 SEC 150
Derrick FL 2860' Ground 2857' Latitude (if known) 36.59444 Longitude (if known) -101.32297
OPERATOR NAME Scout Energy Management LLC OTC/OCC OPERATOR NO. 23138
ADDRESS 4901 LBJ Freeway, Ste 300
CITY Dallas STATE TX ZIP 75244

SPUD DATE 05/13/1947
DRLG FINISHED DATE 05/31/1947
DATE OF WELL COMPLETION 06/08/1947
1st PROD DATE
RECOMP DATE 01/15/2019

640 Acres
LOCATE WELL

COMPLETION TYPE

☒ SINGLE ZONE
☐ MULTIPLE ZONE
Application Date
COMMINGLED
Application Date
LOCATION EXCEPTION
ORDER NO.
INCREASED DENSITY
ORDER NO.

CASING & CEMENT (Form 1002C must be attached)

| TYPE | SIZE | WEIGHT | GRADE | FEET | PSI | SAX | TOP OF CMT |
|--------------|-------|--------|-------|-------|-------------|-------|------------|
| CONDUCTOR | | | | | | | |
| SURFACE | 8.625 | 17.8 | SJ SW | 517' | 1000 | 300 | Surface |
| INTERMEDIATE | | | | | | | |
| PRODUCTION | 5.5 | 14 | H-40 | 2639' | 1000 | 900 | Surface |
| LINER | | | | | | | |
| | | | | | TOTAL DEPTH | 2646' | |

PACKER @ 2425' BRAND & TYPE PLUG @ TYPE PLUG @ TYPE
PACKER @ BRAND & TYPE PLUG @ TYPE PLUG @ TYPE

COMPLETION & TEST DATA BY PRODUCING FORMATION

FORMATION (Chase) Guymon-Hughton
SPACING & SPACING ORDER NUMBER 17867-640
CLASS: Oil, Gas, Dry, Inj, Disp, Comm Disp, Svc Gas
PERFORATED INTERVALS 2475' - 2596'
2626' - 2646' open hole
ACID/VOLUME 1000 gal. 15% HCl
FRACTURE TREATMENT (Fluids/Prop Amounts) 50,000# 16/30 sand w/ 444 bbls wtr, 75 quality foam

Min Gas Allowable (165:10-17-7) OR Oil Allowable (165:10-13-3) Gas Purchaser/Measurer First Sales Date

INITIAL TEST DATA

INITIAL TEST DATE 01/15/2019
OIL-BBL/DAY 0
OIL-GRAVITY (API) NA
GAS-MCF/DAY 32.8
GAS-OIL RATIO CU FT/BBL 0
WATER-BBL/DAY NA
PUMPING OR FLOWING Flowing
INITIAL SHUT-IN PRESSURE 185
CHOKE SIZE NA
FLOW TUBING PRESSURE NA

AS SUBMITTED

A record of the formations drilled through, and pertinent remarks are presented on the reverse. I declare that I have knowledge of the contents of this report and am authorized by my organization to make this report, which was prepared by me or under my supervision and direction, with the data and facts stated herein to be true, correct, and complete to the best of my knowledge and belief.

SIGNATURE Emily J. Van Der Gryp
4901 LBJ Freeway, Ste 300 Dallas TX 75244
ADDRESS CITY STATE ZIP
DATE 03/04/2019 (972) 325-1146
PHONE NUMBER
EMAIL ADDRESS evandergryp@scoutep.com

PLEASE TYPE OR USE BLACK INK ONLY

FORMATION RECORD

Give formation names and tops, if available, or descriptions and thickness of formations drilled through. Show intervals cored or drillstem tested.

LEASE NAME Roscoe

WELL NO. 1

| NAMES OF FORMATIONS | TOP |
|---------------------|------|
| Herrington | 2471 |
| Krider | 2528 |
| Winfield | 2616 |
| TD: | 2646 |

FOR COMMISSION USE ONLY

ITD on file ☐ YES ☐ NO

APPROVED _____ DISAPPROVED _____

2) Reject Codes

Were open hole logs run? ____ yes X no

Date Last log was run _____

Was CO₂ encountered? ____ yes X no at what depths? _____

Was H₂S encountered? ____ yes X no at what depths? _____

Were unusual drilling circumstances encountered? ____ yes X no

If yes, briefly explain below _____

Other remarks:

OCC - This well is completed both from perforations and open hole from bottom of the 5 1/2" casing to total depth

640 Acres

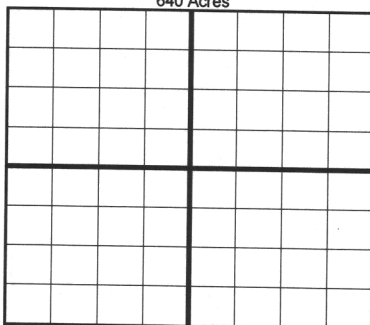

If more than three drainholes are proposed, attach a separate sheet indicating the necessary information.

Direction must be stated in degrees azimuth. Please note, the horizontal drainhole and its end point must be located within the boundaries of the lease or spacing unit.

Directional surveys are required for all drainholes and directional wells.

640 Acres

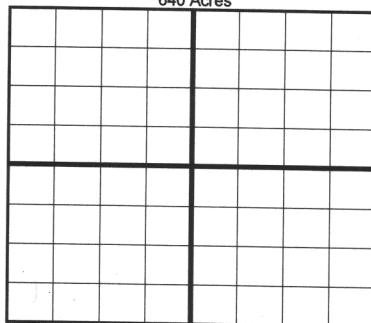

BOTTOM HOLE LOCATION FOR DIRECTIONAL HOLE

| | | | |
|---|-----|---------------------|---------------------------------|
| SEC | TWP | RGE | COUNTY |
| Spot Location | | | |
| 1/4 | 1/4 | 1/4 | 1/4 |
| Measured Total Depth | | True Vertical Depth | Feet From 1/4 Sec Lines FSL FWL |
| BHL From Lease, Unit, or Property Line: | | | |

BOTTOM HOLE LOCATION FOR HORIZONTAL HOLE: (LATERALS)

LATERAL #1

| | | | |
|---|-----|---------------------|--------------|
| SEC | TWP | RGE | COUNTY |
| Spot Location | | | |
| 1/4 | 1/4 | 1/4 | 1/4 |
| Depth of Deviation | | Radius of Turn | Direction |
| Measured Total Depth | | True Vertical Depth | Total Length |
| BHL From Lease, Unit, or Property Line: | | | |

LATERAL #2

| | | | |
|---|-----|---------------------|--------------|
| SEC | TWP | RGE | COUNTY |
| Spot Location | | | |
| 1/4 | 1/4 | 1/4 | 1/4 |
| Depth of Deviation | | Radius of Turn | Direction |
| Measured Total Depth | | True Vertical Depth | Total Length |
| BHL From Lease, Unit, or Property Line: | | | |

LATERAL #3

| | | | |
|---|-----|---------------------|--------------|
| SEC | TWP | RGE | COUNTY |
| Spot Location | | | |
| 1/4 | 1/4 | 1/4 | 1/4 |
| Depth of Deviation | | Radius of Turn | Direction |
| Measured Total Depth | | True Vertical Depth | Total Length |
| BHL From Lease, Unit, or Property Line: | | | |

4/1/19

01

API NO. 139-01660

OTC PROD. UNIT NO. 139-014945

(PLEASE TYPE OR USE BLACK INK ONLY)

A: 014945 I

OKLAHOMA CORPORATION COMMISSION

Oil & Gas Conservation Division

Post Office Box 52000

Oklahoma City, Oklahoma 73152-2000

Rule 165:10-3-25

RECEIVED

Form 1002A

Rev. 2009

MAR 05 2019

Oklahoma Corporation Commission

☒ ORIGINAL

☐ AMENDED (Reason)

New Recompletion (Frac)

COMPLETION REPORT

TYPE OF DRILLING OPERATION

☒ STRAIGHT HOLE ☐ DIRECTIONAL HOLE ☐ HORIZONTAL HOLE

☐ SERVICE WELL

If directional or horizontal, see reverse for bottom hole location.

COUNTY Texas SEC 34 TWP 2N RGE 16ECM

LEASE NAME Roscoe WELL NO. 1

NE 1/4 NE 1/4 SW 1/4 1/4 FNL OF 1/4 SEC 150 FEL OF 1/4 SEC 150

ELEVATION 2860' Ground 2857' Latitude (if known) 36.59444 Longitude (if known) -101.32297

OPERATOR NAME Scout Energy Management LLC OTC/OCC OPERATOR NO. 23138

ADDRESS 4901 LBJ Freeway, Ste 300

CITY Dallas STATE TX ZIP 75244

SPUD DATE 05/13/1947

DRLG FINISHED DATE 05/31/1947

DATE OF WELL COMPLETION 06/08/1947

1st PROD DATE

RECOMP DATE 01/15/2019

640 Acres

LOCATE WELL

1016E2

COMPLETION TYPE

☒ SINGLE ZONE

☐ MULTIPLE ZONE

Application Date

☐ COMMINGLED

Application Date

LOCATION EXCEPTION

ORDER NO.

INCREASED DENSITY

ORDER NO.

CASING & CEMENT (Form 1002C must be attached)

| TYPE | SIZE | WEIGHT | GRADE | FEET | PSI | SAX | TOP OF CMT |
|--------------|-------|--------|-------|-------|------|-----|------------|
| CONDUCTOR | | | | | | | |
| SURFACE | 8.625 | 17.8 | SJ SW | 517' | 1000 | 300 | Surface |
| INTERMEDIATE | | | | | | | |
| PRODUCTION | 5.5 | 14 | H-40 | 2639' | 1000 | 900 | Surface |
| LINER | | | | | | | |
| TOTAL DEPTH | | | | | | | 2646' |

PACKER @ 2425' BRAND & TYPE PLUG @ TYPE PLUG @ TYPE

PACKER @ BRAND & TYPE PLUG @ TYPE PLUG @ TYPE

COMPLETION & TEST DATA BY PRODUCING FORMATION

FORMATION (Chase) Guyman-Hughston

SPACING & SPACING ORDER NUMBER 17867-640

CLASS: Oil, Gas, Dry, Inj. Gas

PERFORATED INTERVALS 2475' - 2596'

2626' - 2646' open hole

ACID/VOLUME 1000 gal. 15% HCl

FRACTURE TREATMENT (Fluids/Prop Amounts) 50,000# 16/30 sand w/ 444 bbls wtr, 75 quality foam

Reported to Frac Focus

☐ Min Gas Allowable (165:10-17-7)

OR

☐ Oil Allowable (165:10-13-3)

Gas Purchaser/Measurer

First Sales Date

INITIAL TEST DATA

INITIAL TEST DATE 01/15/2019

OIL-BBL/DAY 0

OIL-GRAVITY (API) NA

GAS-MCF/DAY 32.8

GAS-OIL RATIO CU FT/BBL 0

WATER-BBL/DAY NA

PUMPING OR FLOWING Flowing

INITIAL SHUT-IN PRESSURE 185

CHOKE SIZE NA

FLOW TUBING PRESSURE NA

AS SUBMITTED

SCANNED

A record of the formations drilled through, and pertinent remarks are presented on the reverse. I declare that I have knowledge of the contents of this report and am authorized by my organization to make this report, which was prepared by me or under my supervision and direction, with the data and facts stated herein to be true, correct, and complete to the best of my knowledge and belief.

Signature: Emily J. Van Der Gryp NAME (PRINT OR TYPE) Emily J. Van Der Gryp

4901 LBJ Freeway, Ste 300 ADDRESS Dallas CITY TX 75244 STATE ZIP

03/04/2019 (972) 325-1146 DATE PHONE NUMBER

evandergryp@scoutep.com EMAIL ADDRESS

EZ

JK

PLEASE TYPE OR USE BLACK INK ONLY

FORMATION RECORD

Give formation names and tops, if available, or descriptions and thickness of formations drilled through. Show intervals cored or drillstem tested.

LEASE NAME Roscoe

WELL NO. 1

| NAMES OF FORMATIONS | TOP |
|---------------------|------|
| Herrington | 2471 |
| Krider | 2528 |
| Winfield | 2616 |
| TD: | 2646 |

FOR COMMISSION USE ONLY

ITD on file ☐ YES ☐ NO

APPROVED _____ DISAPPROVED _____

2) Reject Codes _____

Were open hole logs run? ____ yes X no

Date Last log was run _____

Was CO₂ encountered? ____ yes X no at what depths? _____

Was H₂S encountered? ____ yes X no at what depths? _____

Were unusual drilling circumstances encountered? ____ yes X no

If yes, briefly explain below _____

Other remarks:

OCC - This well is completed both from perforations and open hole from bottom of the 5 1/2" casing to total depth

640 Acres

| | | | | | | | | | |
|--|--|--|--|--|--|--|--|--|--|
| | | | | | | | | | |
| | | | | | | | | | |
| | | | | | | | | | |
| | | | | | | | | | |
| | | | | | | | | | |
| | | | | | | | | | |
| | | | | | | | | | |
| | | | | | | | | | |
| | | | | | | | | | |
| | | | | | | | | | |

If more than three drainholes are proposed, attach a separate sheet indicating the necessary information.

Direction must be stated in degrees azimuth. Please note, the horizontal drainhole and its end point must be located within the boundaries of the lease or spacing unit.

Directional surveys are required for all drainholes and directional wells.

640 Acres

| | | | | | | | | | |
|--|--|--|--|--|--|--|--|--|--|
| | | | | | | | | | |
| | | | | | | | | | |
| | | | | | | | | | |
| | | | | | | | | | |
| | | | | | | | | | |
| | | | | | | | | | |
| | | | | | | | | | |
| | | | | | | | | | |
| | | | | | | | | | |
| | | | | | | | | | |

BOTTOM HOLE LOCATION FOR DIRECTIONAL HOLE

| SEC | TWP | RGE | COUNTY |
|---|-----|---------------------|---------------------------------|
| Spot Location | | | |
| 1/4 | 1/4 | 1/4 | 1/4 |
| Measured Total Depth | | True Vertical Depth | Feet From 1/4 Sec Lines FSL FWL |
| BHL From Lease, Unit, or Property Line: | | | |

BOTTOM HOLE LOCATION FOR HORIZONTAL HOLE: (LATERALS)

LATERAL #1

| SEC | TWP | RGE | COUNTY |
|---|-----|---------------------|---------------------------------|
| Spot Location | | | |
| 1/4 | 1/4 | 1/4 | 1/4 |
| Depth of Deviation | | Radius of Turn | Feet From 1/4 Sec Lines FSL FWL |
| Measured Total Depth | | True Vertical Depth | Direction Total Length |
| BHL From Lease, Unit, or Property Line: | | | |

LATERAL #2

| SEC | TWP | RGE | COUNTY |
|---|-----|---------------------|---------------------------------|
| Spot Location | | | |
| 1/4 | 1/4 | 1/4 | 1/4 |
| Depth of Deviation | | Radius of Turn | Feet From 1/4 Sec Lines FSL FWL |
| Measured Total Depth | | True Vertical Depth | Direction Total Length |
| BHL From Lease, Unit, or Property Line: | | | |

LATERAL #3

| SEC | TWP | RGE | COUNTY |
|---|-----|---------------------|---------------------------------|
| Spot Location | | | |
| 1/4 | 1/4 | 1/4 | 1/4 |
| Depth of Deviation | | Radius of Turn | Feet From 1/4 Sec Lines FSL FWL |
| Measured Total Depth | | True Vertical Depth | Direction Total Length |
| BHL From Lease, Unit, or Property Line: | | | |