

Oklahoma Corporation Commission
Oil & Gas Conservation Division
Post Office Box 52000
Oklahoma City, Oklahoma 73152-2000
Rule 165: 10-3-25

Form 1002A

API No.: 35139008100001

Completion Report

Spud Date: April 22, 1947

OTC Prod. Unit No.:

Drilling Finished Date: May 03, 1947

Amended

1st Prod Date:

Amend Reason: NEW FRAC

Completion Date: May 03, 1947

Recomplete Date: January 15, 2019

Drill Type: STRAIGHT HOLE

Well Name: PRUDENTIAL 1

Purchaser/Measurer:

Location: TEXAS 35 2N 16E CM
SE SE SE NW
2533 FNL 2535 FWL of 1/4 SEC
Latitude: 36.595 Longitude: -101.30506
Derrick Elevation: 2851 Ground Elevation: 2848

First Sales Date:

Operator: SCOUT ENERGY MANAGEMENT LLC 23138

4901 LBJ FWY STE 300
DALLAS, TX 75244-6107

Completion Type		Location Exception		Increased Density	
X	Single Zone	Order No		Order No	
	Multiple Zone	There are no Location Exception records to display.		There are no Increased Density records to display.	
	Commingled				

Casing and Cement							
Type	Size	Weight	Grade	Feet	PSI	SAX	Top of CMT
SURFACE	8.625	17.8	SW SJ	521		300	SURFACE
PRODUCTION	5.5	14	H-40	2630		900	SURFACE

Liner								
Type	Size	Weight	Grade	Length	PSI	SAX	Top Depth	Bottom Depth
There are no Liner records to display.								

Total Depth: 2641

Packer		Plug	
Depth	Brand & Type	Depth	Plug Type
2415	PACKER	There are no Plug records to display.	

Initial Test Data

Test Date	Formation	Oil BBL/Day	Oil-Gravity (API)	Gas MCF/Day	Gas-Oil Ratio Cu FT/BBL	Water BBL/Day	Pumpin or Flowing	Initial Shut- In Pressure	Choke Size	Flow Tubing Pressure
Jan 15, 2019	GUYMON-HUGOTON			46			FLOWING	47		

Completion and Test Data by Producing Formation

Formation Name: GUYMON-HUGOTON

Code: 451GYHG

Class: GAS

Spacing Orders		Perforated Intervals	
Order No	Unit Size	From	To
17867	640	2465	2620

Acid Volumes	Fracture Treatments
1,000 GALLONS 15% HCL	51,000 POUNDS 16/30 SAND WITH 444 POUNDS WATER, SPEC. GRAVITY 2.65 - 75 QUALITY FOAM

Formation	Top
HERINGTON	2456
KRIDER	2518
ODELL SHALE	2596
WINFIELD	2606

Were open hole logs run? No

Date last log run:

Were unusual drilling circumstances encountered? No

Explanation:

Other Remarks

OCC - THIS WELL IS BOTH PERFORATED FROM 2,465' TO 2,620' AND AN OPEN HOLE COMPLETION FROM BOTTOM OF THE 5 1/2" CASING TO TOTAL DEPTH.

FOR COMMISSION USE ONLY

1142271

Status: Accepted

API NO. 35-139-00810
OTC PROD.
UNIT NO.

(PLEASE TYPE OR USE BLACK INK ONLY)

OKLAHOMA CORPORATION COMMISSION

Oil & Gas Conservation Division

Post Office Box 52000

Oklahoma City, Oklahoma 73152-2000

Rule 165:10-3-25

COMPLETION REPORT

☒ ORIGINAL
☐ AMENDED (Reason)

TYPE OF DRILLING OPERATION

☒ STRAIGHT HOLE ☐ DIRECTIONAL HOLE ☐ HORIZONTAL HOLE
☐ SERVICE WELL

If directional or horizontal, see reverse for bottom hole location.

COUNTY Texas SEC 35 TWP 2N RGE 16ECM

LEASE NAME Prudential

WELL NO. 1

DATE OF WELL COMPLETION 05/03/1947

1st PROD DATE

RECOMP DATE 01/15/2019

ELEVATION Derrick FL 2851' KB Ground 2848'

Latitude (if known) 36.5950

Longitude (if known) -101.30506

OPERATOR NAME Scout Energy Management LLC

OTC/OCC OPERATOR NO. 23138

ADDRESS 4901 LBJ Freeway, Ste 300

CITY Dallas

STATE TX

ZIP 75244

COMPLETION TYPE

☒ SINGLE ZONE
☐ MULTIPLE ZONE
Application Date
☐ COMMINGLED
Application Date
LOCATION EXCEPTION
ORDER NO.
INCREASED DENSITY
ORDER NO.

CASING & CEMENT (Form 1002C must be attached)

TYPE	SIZE	WEIGHT	GRADE	FEET	PSI	SAX	TOP OF CMT
CONDUCTOR							
SURFACE	8.625	17.8	SW S	521'		300	Surface
INTERMEDIATE							
PRODUCTION	5.5	14	H-40	2630'		900	Surface
LINER							
						TOTAL DEPTH	2641'

PACKER @ 2415' BRAND & TYPE

PLUG @ TYPE

PLUG @ TYPE

TOTAL DEPTH 2641'

PACKER @ BRAND & TYPE

PLUG @ TYPE

PLUG @ TYPE

COMPLETION & TEST DATA BY PRODUCING FORMATION

FORMATION	(Chase) Guyman-Hugoton						
SPACING & SPACING ORDER NUMBER	17867-640						
CLASS: Oil, Gas, Dry, Inj, Disp, Comm Disp, Svc	Gas						
PERFORATED INTERVALS	2465'-2620'						
	2630-2641' Open Hole						
ACID/VOLUME	1000 gal. 15% HCl						
FRACTURE TREATMENT (Fluids/Prop Amounts)	51,000 lbs of 16/30 sand w/ 444 lbs wtr, Spec. Gravity 2.65 - 75 quality foam						

Min Gas Allowable (165:10-17-7)

Gas Purchaser/Measurer



Oil Allowable (165:10-13-3)

First Sales Date

INITIAL TEST DATA

INITIAL TEST DATE	01/15/2019					
OIL-BBL/DAY	0					
OIL-GRAVITY (API)	-					
GAS-MCF/DAY	46					
GAS-OIL RATIO CU FT/BBL	-					
WATER-BBL/DAY	0					
PUMPING OR FLOWING	Flowing					
INITIAL SHUT-IN PRESSURE	47					
CHOKE SIZE	-					
FLOW TUBING PRESSURE	-					

AS SUBMITTED

RECEIVED

Form 1002A

Rev. 2009

MAR 04 2019

OKLAHOMA CORPORATION COMMISSION

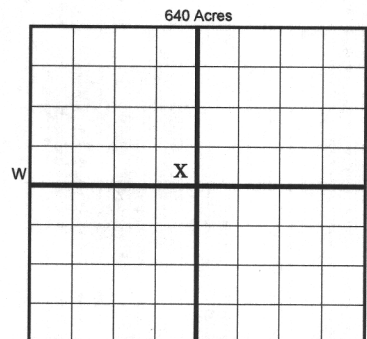

LOCATE WELL

A record of the formations drilled through, and pertinent remarks are presented on the reverse. I declare that I have knowledge of the contents of this report and am authorized by my organization to make this report, which was prepared by me or under my supervision and direction, with the data and facts stated herein to be true, correct, and complete to the best of my knowledge and belief.

Signature of Emily J. Van Der Gryp

Emily J. Van Der Gryp

03/01/2019 (972) 325-1146

4901 LBJ Freeway, Ste 300

Dallas

TX

75244

evandergryp@scoutep.com

ADDRESS

CITY

STATE

ZIP

EMAIL ADDRESS

PLEASE TYPE OR USE BLACK INK ONLY

FORMATION RECORD

Give formation names and tops, if available, or descriptions and thickness of formations drilled through. Show intervals cored or drillstem tested.

LEASE NAME Prudential

WELL NO. 1

NAMES OF FORMATIONS	TOP
Harington	2456
Krider	2518
Odell Shale	2596
Winfield	2606
TD:	2641

FOR COMMISSION USE ONLY

ITD on file ☐ YES ☐ NO

APPROVED _____ DISAPPROVED _____

2) Reject Codes

Were open hole logs run? yes ☒ no ☐

Date Last log was run Unknown

Was CO₂ encountered? yes ☒ no at what depths? _____

Was H₂S encountered? yes ☒ no at what depths? _____

Were unusual drilling circumstances encountered? yes ☒ no ☐

If yes, briefly explain below _____

Other remarks:

OCC - This well is both perforated from 2465' to 2620' and an open hole completion from bottom of the 5 1/2" casing to total depth.

640 Acres

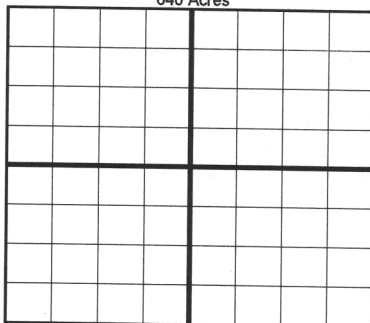

If more than three drainholes are proposed, attach a separate sheet indicating the necessary information.

Direction must be stated in degrees azimuth. Please note, the horizontal drainhole and its end point must be located within the boundaries of the lease or spacing unit.

Directional surveys are required for all drainholes and directional wells.

640 Acres

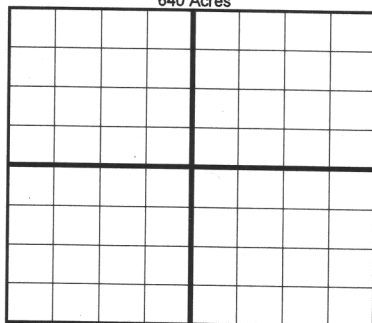

BOTTOM HOLE LOCATION FOR DIRECTIONAL HOLE

SEC	TWP	RGE	COUNTY
Spot Location			
1/4	1/4	1/4	1/4
Measured Total Depth		True Vertical Depth	BHL From Lease, Unit, or Property Line:

BOTTOM HOLE LOCATION FOR HORIZONTAL HOLE: (LATERALS)

LATERAL #1

SEC	TWP	RGE	COUNTY
Spot Location			
1/4	1/4	1/4	1/4
Depth of Deviation		Radius of Turn	Direction
Measured Total Depth		True Vertical Depth	BHL From Lease, Unit, or Property Line:

LATERAL #2

SEC	TWP	RGE	COUNTY
Spot Location			
1/4	1/4	1/4	1/4
Depth of Deviation		Radius of Turn	Direction
Measured Total Depth		True Vertical Depth	BHL From Lease, Unit, or Property Line:

LATERAL #3

SEC	TWP	RGE	COUNTY
Spot Location			
1/4	1/4	1/4	1/4
Depth of Deviation		Radius of Turn	Direction
Measured Total Depth		True Vertical Depth	BHL From Lease, Unit, or Property Line:

API NO. 35-139-00810
OTC PROD. UNIT NO. 139-014923

(PLEASE TYPE OR USE BLACK INK ONLY)

OKLAHOMA CORPORATION COMMISSION

Oil & Gas Conservation Division

Post Office Box 52000

Oklahoma City, Oklahoma 73152-2000

Rule 165:10-3-25

RECEIVED

Form 1002A

Rev. 2009

MAR 04 2019

OKLAHOMA CORPORATION COMMISSION

1016EZ

☐ ORIGINAL
☒ AMENDED (Reason)

New
Recompletion (Frac)

COMPLETION REPORT

TYPE OF DRILLING OPERATION

☒ STRAIGHT HOLE ☐ DIRECTIONAL HOLE ☐ HORIZONTAL HOLE

If directional or horizontal, see reverse for bottom hole location.

COUNTY Texas SEC 35 TWP 2N RGE 16ECM
LEASE NAME Prudential WELL NO. 1
SE 1/4 SE 1/4 NW 1/4 1/4 END OF 1/4 SEC 2533' FWL OF 1/4 SEC 2535'
ELEVATION Derrick FL 2851' KB Ground 2848' Latitude (if known) 36.5950 Longitude (if known) -101.30506
OPERATOR NAME Scout Energy Management LLC OTC/OCC OPERATOR NO. 23138
ADDRESS 4901 LBJ Freeway, Ste 300
CITY Dallas STATE TX ZIP 75244

SPUD DATE 04/22/1947
DRLG FINISHED DATE 05/03/1947
DATE OF WELL COMPLETION 05/03/1947
1st PROD DATE
RECOMP DATE 01/15/2019

640 Acres
LOCATE WELL

COMPLETION TYPE

☒ SINGLE ZONE
☐ MULTIPLE ZONE
Application Date
COMINGLED
Application Date
LOCATION EXCEPTION
ORDER NO.
INCREASED DENSITY
ORDER NO.

CASING & CEMENT (Form 1002C must be attached)

TYPE	SIZE	WEIGHT	GRADE	FEET	PSI	SAX	TOP OF CMT
CONDUCTOR							
SURFACE	8.625	17.8	SW S	521'		300	Surface
INTERMEDIATE							
PRODUCTION	5.5	14	H-40	2630'		900	Surface
LINER							
TOTAL DEPTH						2641'	

PACKER @ 2415' BRAND & TYPE PLUG @ TYPE PLUG @ TYPE
PACKER @ BRAND & TYPE PLUG @ TYPE PLUG @ TYPE

COMPLETION & TEST DATA BY PRODUCING FORMATION

FORMATION Chase Guxion-Hupston
SPACING & SPACING ORDER NUMBER 17867-640
CLASS: Oil, Gas, Dry, Inj, Disp, Comm Disp, Svc Gas
PERFORATED INTERVALS 2465'-2620'
2630-2641' Open Hole
ACID/VOLUME 1000 gal. 15% HCl
FRACTURE TREATMENT (Fluids/Prop Amounts) 51,000 lbs of 16/30 sand w/ 444 lbs wtr, Spec. Gravity 2.65 - 75 quality foam

Min Gas Allowable (165:10-17-7) OR Oil Allowable (165:10-13-3) Gas Purchaser/Measurer First Sales Date

INITIAL TEST DATA

INITIAL TEST DATE 01/15/2019
OIL-BBL/DAY 0
OIL-GRAVITY (API) -
GAS-MCF/DAY 46
GAS-OIL RATIO CU FT/BBL -
WATER-BBL/DAY 0
PUMPING OR FLOWING Flowing
INITIAL SHUT-IN PRESSURE 47
CHOKE SIZE -
FLOW TUBING PRESSURE -

AS SUBMITTED

A record of the formations drilled through, and pertinent remarks are presented on the reverse. I declare that I have knowledge of the contents of this report and am authorized by my organization to make this report, which was prepared by me or under my supervision and direction, with the data and facts stated herein to be true, correct, and complete to the best of my knowledge and belief.

Emily J. Van Der Gryp

Emily J. Van Der Gryp

03/01/2019 (972) 325-1146

4901 LBJ Freeway, Ste 300

Dallas

TX

75244

evandergryp@scoutep.com

ADDRESS

CITY

STATE

ZIP

EMAIL ADDRESS

SCANNED

EZ

JK

Give formation names and tops, if available, or descriptions and thickness of formations drilled through. Show intervals cored or drillstem tested.

WELL NO. 1

NAMES OF FORMATIONS	TOP
Harington	2456
Krider	2518
Odell Shale	2596
Winfield	2606
TD:	2641

FOR COMMISSION USE ONLY	
ITD on file	<input type="checkbox"/> YES <input type="checkbox"/> NO
APPROVED	DISAPPROVED
2) Reject Codes	

Were open hole logs run? yes X no

Date Last log was run Unknown

Was CO₂ encountered? yes X no at what depths?

Was H₂S encountered? yes X no at what depths?

Were unusual drilling circumstances encountered? yes X no

If yes, briefly explain below

Other remarks:

Other remarks: OCC - This well is both perforated from 2465' to 2620' and can open hole completion from bottom of the 5 1/2" casing to total depth.

640 Acres

The diagram shows a large square divided into a 10x10 grid of smaller squares. A thick vertical line and a thick horizontal line intersect at the center, dividing the grid into four 5x5 quadrants. The top-left quadrant is shaded gray. The text '640 Acres' is centered above the grid.

If more than three drainholes are proposed, attach a separate sheet indicating the necessary information.

Direction must be stated in degrees azimuth.
Please note, the horizontal drainhole and its end
point must be located within the boundaries of the
lease or spacing unit.

Directional surveys are required for all drainholes and directional wells.

640 Acres



SEC	TWP	RGE	COUNTY
Spot Location			
1/4	1/4	1/4	1/4
Measured Total Depth		True Vertical Depth	BHL From Lease, Unit, or Property Line:

LATERAL #1								
SEC	TWP	RGE	COUNTY					
Spot Location			1/4	1/4	1/4	Feet From 1/4 Sec Lines	FSL	FWL
Depth of Deviation		Radius of Turn		Direction		Total Length		
Measured Total Depth		True Vertical Depth		BHL From Lease, Unit, or Property Line:				

SEC	TWP	RGE	COUNTY
Spot Location		Feet From 1/4 Sec Lines	
1/4	1/4	1/4	1/4
Depth of Deviation	Radius of Turn	Direction	FSL
Measured Total Depth	True Vertical Depth	FWL	
		BHL From Lease, Unit, or Property Line:	

SEC	TWP	RGE	COUNTY
Spot Location			
1/4	1/4	1/4	1/4
Feet From 1/4 Sec Lines		FSL	FWL
Depth of Deviation	Radius of Turn	Direction	Total Length
Measured Total Depth		True Vertical Depth	
BHL From Lease, Unit, or Property Line:			