

Oklahoma Corporation Commission  
Oil & Gas Conservation Division  
Post Office Box 52000  
Oklahoma City, Oklahoma 73152-2000  
Rule 165: 10-3-25

Form 1002A

API No.: 35037294360000

**Completion Report**

Spud Date: October 15, 2019

OTC Prod. Unit No.: 037-226379-0-0000

Drilling Finished Date: October 18, 2019

1st Prod Date: January 08, 2020

Completion Date: January 05, 2020

**Drill Type: STRAIGHT HOLE**

Well Name: BARNHART 1-24

Purchaser/Measurer:

Location: CREEK 24 14N 10E  
S2 NW SW SW  
847 FSL 330 FWL of 1/4 SEC  
Derrick Elevation: 0 Ground Elevation: 775

First Sales Date:

Operator: WFD OIL CORPORATION 17501

16800 CONIFER LN  
EDMOND, OK 73012-0619

Completion Type		Location Exception		Increased Density	
X	Single Zone	Order No		Order No	
	Multiple Zone	There are no Location Exception records to display.		There are no Increased Density records to display.	
	Commingled				

Casing and Cement								
Type		Size	Weight	Grade	Feet	PSI	SAX	Top of CMT
SURFACE		7	23	NEW	288		72	SURFACE
PRODUCTION		4 1/2	11.5	NEW	3359		150	1660

Liner								
Type	Size	Weight	Grade	Length	PSI	SAX	Top Depth	Bottom Depth
There are no Liner records to display.								

**Total Depth: 3365**

Packer		Plug	
Depth	Brand & Type	Depth	Plug Type
There are no Packer records to display.		There are no Plug records to display.	

Initial Test Data										
Test Date	Formation	Oil BBL/Day	Oil-Gravity (API)	Gas MCF/Day	Gas-Oil Ratio Cu FT/BBL	Water BBL/Day	Pumpin or Flowing	Initial Shut-In Pressure	Choke Size	Flow Tubing Pressure
Jan 05, 2020	DUTCHER	50	36				PUMPING			

Completion and Test Data by Producing Formation			
Formation Name: DUTCHER		Code: 403DTCR	Class: OIL
<b>Spacing Orders</b>		<b>Perforated Intervals</b>	
<b>Order No</b>	<b>Unit Size</b>	<b>From</b>	<b>To</b>
699858	40	2654	2672
<b>Acid Volumes</b>		<b>Fracture Treatments</b>	
500 GALLONS		NONE	

Formation	Top
SKINNER SS	1500
RED FORK SS	1854
BARTLESVILLE SS	2124
DUTCHER SS	2654
WOODFORD SHALE	3140
VIOLA	3224
WILCOX SS	3253

Were open hole logs run? Yes  
Date last log run: October 13, 2019

Were unusual drilling circumstances encountered? No  
Explanation:

Other Remarks
There are no Other Remarks.

FOR COMMISSION USE ONLY	
Status: Accepted	1144792



PLEASE TYPE OR USE BLACK INK ONLY  
FORMATION RECORD

Give formation names and tops, if available, or descriptions and thickness of formations drilled through. Show intervals cored or drillstem tested.

LEASE NAME Barnhart

WELL NO. 1-24

NAMES OF FORMATIONS	TOP
Skinner ss	1500
Red Fork ss	1854
Bartlesville ss	2124
Dutcher ss	2654
Woodford sh	3140
Viola	3224
Wilcox ss	3253

FOR COMMISSION USE ONLY		
ITD on file	<input type="checkbox"/> YES	<input type="checkbox"/> NO
APPROVED	DISAPPROVED	2) Reject Codes

Were open hole logs run?	<input checked="" type="checkbox"/> yes	<input type="checkbox"/> no
Date Last log was run	<u>10-13-19</u>	
Was CO <sub>2</sub> encountered?	<input type="checkbox"/> yes	<input checked="" type="checkbox"/> no at what depths? _____
Was H <sub>2</sub> S encountered?	<input type="checkbox"/> yes	<input checked="" type="checkbox"/> no at what depths? _____
Were unusual drilling circumstances encountered?	<input type="checkbox"/> yes <input checked="" type="checkbox"/> no	
If yes, briefly explain below		

Other remarks:

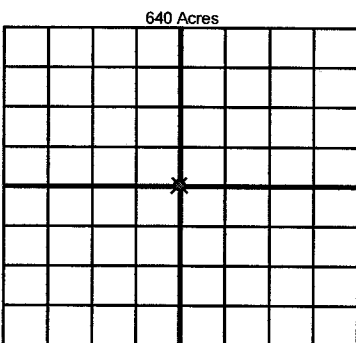

If more than three drainholes are proposed, attach a separate sheet indicating the necessary information.

Direction must be stated in degrees azimuth. Please note, the horizontal drainhole and its end point must be located within the boundaries of the lease or spacing unit.

Directional surveys are required for all drainholes and directional wells.

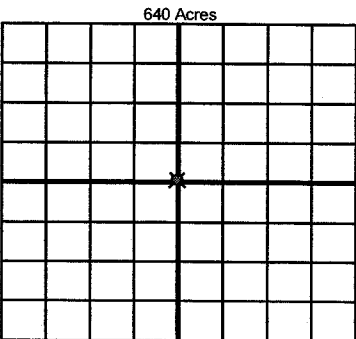

BOTTOM HOLE LOCATION FOR DIRECTIONAL HOLE

SEC	TWP	RGE	COUNTY
Spot Location			
1/4	1/4	1/4	1/4
Measured Total Depth		True Vertical Depth	BHL From Lease, Unit, or Property Line:

BOTTOM HOLE LOCATION FOR HORIZONTAL HOLE: (LATERALS)

LATERAL #1

SEC	TWP	RGE	COUNTY
Spot Location			
1/4	1/4	1/4	1/4
Depth of Deviation		Radius of Turn	Direction
Measured Total Depth		True Vertical Depth	BHL From Lease, Unit, or Property Line:

LATERAL #2

SEC	TWP	RGE	COUNTY
Spot Location			
1/4	1/4	1/4	1/4
Depth of Deviation		Radius of Turn	Direction
Measured Total Depth		True Vertical Depth	BHL From Lease, Unit, or Property Line:

LATERAL #3

SEC	TWP	RGE	COUNTY
Spot Location			
1/4	1/4	1/4	1/4
Depth of Deviation		Radius of Turn	Direction
Measured Total Depth		True Vertical Depth	BHL From Lease, Unit, or Property Line:

API NO. 3511723645  
OTC PROD. UNIT NO. 1172164080

(PLEASE TYPE OR USE BLACK INK ONLY)

OKLAHOMA CORPORATION COMMISSION

Oil & Gas Conservation Division

Post Office Box 52000

Oklahoma City, Oklahoma 73152-2000

Rule 165:10-3-25

RECEIVED

Form 1002A

Rev. 2009

FEB 27 2020

☒ ORIGINAL  
☐ AMENDED (Reason)

TYPE OF DRILLING OPERATION

☒ STRAIGHT HOLE ☐ DIRECTIONAL HOLE ☐ HORIZONTAL HOLE  
☐ SERVICE WELL

If directional or horizontal, see reverse for bottom hole location.

COUNTY Pawnee SEC 10 TWP 21N RGE 5E  
LEASE NAME Mark Waters WELL NO. 1-10  
C 1/4 NW 1/4 SW 1/4 NW 1/4 (FNL OF 1/4 SEC) 1650 FWL OF 1/4 SEC 330  
ELEVATION Derrick FL 951 Ground 964 Latitude (if known) 36.314164 Longitude (if known) -96.762955  
OPERATOR NAME Prairie Gas Company of Oklahoma, LLC OTC/OCC OPERATOR NO. 24073  
ADDRESS 114 E 5th Street, Suite 300  
CITY Tulsa STATE OK ZIP 74103

COMPLETION REPORT

SPUD DATE 07/05/2015  
DRLG FINISHED DATE 07/11/2015  
DATE OF WELL COMPLETION 09/13/2015  
1st PROD DATE 02/21/2017  
RECOMP DATE  
Longitude (if known) -96.762955

OKLAHOMA CORPORATION COMMISSION

640 Acres

W E

LOCATE WELL

COMPLETION TYPE

SINGLE ZONE  
MULTIPLE ZONE  
Application Date  
COMMINGLED  
Application Date  
LOCATION EXCEPTION  
ORDER NO. 644907  
INCREASED DENSITY  
ORDER NO.

CASING & CEMENT (Form 1002C must be attached)

TYPE	SIZE	WEIGHT	GRADE	FEET	PSI	SAX	TOP OF CMT
CONDUCTOR							
SURFACE	8 5/8	24	J-55	235		160	Surface
INTERMEDIATE							
PRODUCTION	5 1/2	15.5	J-55	3783		270	2550
LINER							
						TOTAL DEPTH	3,803

PACKER @ BRAND & TYPE PLUG @ TYPE PLUG @ TYPE  
PACKER @ BRAND & TYPE PLUG @ TYPE PLUG @ TYPE

COMPLETION & TEST DATA BY PRODUCING FORMATION

FORMATION	Skinner	Red Fork	Mississippian	Woodford	Simpson	Wilcox
SPACING & SPACING ORDER NUMBER	641895278171 - 40 AC (640)	278171 - 40 AC (640)	278171 - 40 AC (640)	641895 (640)	641895 (640)	278171 - 40 AC (640)
CLASS: Oil, Gas, Dry, Inj, Disp, Comm Disp, Svc	Gas	Gas	Gas	Gas	Gas	Gas
	3200-3245	3245-3280	3405-3458	3596-3629	3629-3630	3652-3692
PERFORATED INTERVALS			3468-3544		3634-3642	
ACID/VOLUME			6048gal15%HCl	2016gal15%HCl	36bbbls 15%HCl	
FRACTURE TREATMENT (Fluids/Prop Amounts)	2141 bbbls B Frac 2.5	2141bbbls B Frac	8657bbbls slick	11071bbbls slick	3676bbbls slick	1205bbbl B Frac
	336,300 lbs 12/20	336,300 lbs 12/20	water, 137226	water, 195743 lbs	38711 lbs	6968lbs 100
	sand	sand	lbs 30/50 sand	30/50 sand	30/50 sand	65416lbs 12/20

Min Gas Allowable (165:10-17-7)

Gas Purchaser/Measurer

☐

OR

First Sales Date

Oil Allowable (165:10-13-3)

INITIAL TEST DATA

INITIAL TEST DATE	6/3/2017					
OIL-BBL/DAY	1.67					
OIL-GRAVITY ( API)	34					
GAS-MCF/DAY	63					
GAS-OIL RATIO CU FT/BBL	37,725					
WATER-BBL/DAY	1444					
PUMPING OR FLOWING	Pumping					
INITIAL SHUT-IN PRESSURE						
CHOKE SIZE						
FLOW TUBING PRESSURE						

A record of the formations drilled through, and pertinent remarks are presented on the reverse. I declare that I have knowledge of the contents of this report and am authorized by my organization to make this report, which was prepared by me or under my supervision and direction, with the data and facts stated herein to be true, correct, and complete to the best of my knowledge and belief.

SIGNATURE Kim Booth DATE 2/12/2020 PHONE NUMBER 539-867-2095  
114 E 5th Street, Suite 300 Tulsa OK 74103 kbooth@pgcollc.com  
ADDRESS CITY STATE ZIP EMAIL ADDRESS

### FORMATION RECORD

LEASE NAME Mark Waters WELL NO. 1-10

NAMES OF FORMATIONS	TOP
Cleveland	2,657
Big Lime	2,887
Oswego	2937
Prue	3,051
Skinner	3,133
Red Fork	3,233
Mississippi Lime	3,347
Woodford Shale	3,527
Simpson Dolomite	3,562
Wilcox	3,586

FOR COMMISSION USE ONLY	
ITD on file	<input type="checkbox"/> YES <input type="checkbox"/> NO
APPROVED	DISAPPROVED
2) Reject Codes	

Were open hole logs run?            X yes      \_\_\_ no

Date Last log was run                 7/12/2015

Was CO<sub>2</sub> encountered?                \_\_\_ yes      X no      at what depths? \_\_\_\_\_

Was H<sub>2</sub>S encountered?                \_\_\_ yes      X no      at what depths? \_\_\_\_\_

Were unusual drilling circumstances encountered?                                  \_\_\_ yes      X no

If yes, briefly explain below

Other remarks:

640 Acres

A 10x10 grid representing 640 acres. The grid is divided into four 5x5 quadrants by a thick black cross. The top-left quadrant is shaded light blue, the top-right quadrant is shaded light green, the bottom-left quadrant is shaded light orange, and the bottom-right quadrant is white. The text '640 Acres' is centered at the top of the grid.

Direction must be stated in degrees azimuth.  
Please note, the horizontal drainhole and its end  
point must be located within the boundaries of the  
lease or spacing unit.

**Directional surveys are required for all drainholes and directional wells.**

640 Acres

**BOTTOM HOLE LOCATION FOR DIRECTIONAL HOLE**

SEC	TWP	RGE	COUNTY			
Spot Location				Feet From 1/4 Sec Lines	FSL	FWL
1/4	1/4	1/4	1/4			
Measured Total Depth		True Vertical Depth		BHL From Lease, Unit, or Property Line:		

**BOTTOM HOLE LOCATION FOR HORIZONTAL HOLE: (LATERALS)**

**LATERAL #1**

SEC	TWP	RGE	COUNTY			
Spot Location				Feet From 1/4 Sec Lines	FSL	FWL
1/4	1/4	1/4	1/4			
Depth of Deviation		Radius of Turn	Direction	Total Length		
Measured Total Depth		True Vertical Depth	BHL From Lease, Unit, or Property Line:			

**LATERAL #2**

SEC	TWP	RGE	COUNTY			
Spot Location				Feet From 1/4 Sec Lines	FSL	FWL
1/4	1/4	1/4	1/4			
Depth of Deviation		Radius of Turn	Direction	Total Length		
Measured Total Depth		True Vertical Depth	BHL From Lease, Unit, or Property Line:			

**LATERAL #3**

SEC	TWP	RGE	COUNTY			
Spot Location				Feet From 1/4 Sec Lines	FSL	FWL
1/4	1/4	1/4	1/4			
Depth of Deviation		Radius of Turn	Direction	Total Length		
Measured Total Depth		True Vertical Depth	BHL From Lease, Unit, or Property Line:			