

Oklahoma Corporation Commission  
Oil & Gas Conservation Division  
Post Office Box 52000  
Oklahoma City, Oklahoma 73152-2000  
Rule 165: 10-3-25

Form 1002A

API No.: 35125212700002

**Completion Report**

Spud Date: July 08, 1981

OTC Prod. Unit No.:

Drilling Finished Date: July 22, 1981

**Amended**

1st Prod Date: September 01, 1981

Amend Reason: CHANGE CLASS FROM INJECTOR TO OIL PRODUCER

Completion Date: August 07, 1981

Recomplete Date: July 08, 2021

**Drill Type: STRAIGHT HOLE**

Well Name: NW TECUMSEH UNIT 21-21

Purchaser/Measurer:

Location: POTTAWATOMIE 20 10N 3E  
NW SE NE NE  
1770 FSL 2265 FWL of 1/4 SEC  
Latitude: 35.3310481 Longitude: -97.002308  
Derrick Elevation: 1053 Ground Elevation: 1044

First Sales Date:

Operator: HOOD OIL AND GAS LLC 24568

10800 E 51ST ST  
TULSA, OK 74146-5805

Completion Type		Location Exception		Increased Density	
X	Single Zone	Order No		Order No	
	Multiple Zone	There are no Location Exception records to display.		There are no Increased Density records to display.	
	Commingled				

Casing and Cement							
Type	Size	Weight	Grade	Feet	PSI	SAX	Top of CMT
SURFACE	8 5/8	24	H-40	398		300	SURFACE
PRODUCTION	4 1/2	10.5	J-55	5157		450	3790

Liner								
Type	Size	Weight	Grade	Length	PSI	SAX	Top Depth	Bottom Depth
There are no Liner records to display.								

**Total Depth: 5200**

Packer		Plug	
Depth	Brand & Type	Depth	Plug Type
There are no Packer records to display.		There are no Plug records to display.	

Initial Test Data
-------------------

Test Date	Formation	Oil BBL/Day	Oil-Gravity (API)	Gas MCF/Day	Gas-Oil Ratio Cu FT/BBL	Water BBL/Day	Pumpin or Flowing	Initial Shut-In Pressure	Choke Size	Flow Tubing Pressure
Jul 08, 2021	RED FORK	2	37			350	SWABBIN			

<b>Completion and Test Data by Producing Formation</b>					
Formation Name: RED FORK		Code: 404RDFK		Class: OIL	
<b>Spacing Orders</b>			<b>Perforated Intervals</b>		
<b>Order No</b>	<b>Unit Size</b>		<b>From</b>	<b>To</b>	
342977	UNIT		4857	4938	
<b>Acid Volumes</b>			<b>Fracture Treatments</b>		
There are no Acid Volume records to display.			There are no Fracture Treatments records to display.		

Formation	Top
SEE ORIGINAL 1002A	0

Were open hole logs run? No

Date last log run:

Were unusual drilling circumstances encountered? No

Explanation:

<b>Other Remarks</b>
OCC - ORDER 354225 TERMINATED BY FORM 1072 8/12/2021.

<b>FOR COMMISSION USE ONLY</b>	
Status: Accepted	1146695

API NO. 35-125-21270  
OTC PROP UNIT NO.

Oil and Gas Conservation Division  
P.O. Box 52000  
Oklahoma City, OK 73152-2000  
405-521-2331  
OCCCentralProcessing@OCC.OK.GOV



OKLAHOMA  
Corporation  
Commission

Form 1002A  
Rev. 2020

ORIGINAL  
AMENDED (Reason) Change class from injector to oil producer

Rule 165:10-3-25

COMPLETION REPORT

TYPE OF DRILLING OPERATION

☒ STRAIGHT HOLE ☐ DIRECTIONAL HOLE ☐ HORIZONTAL HOLE  
☐ SERVICE WELL

If directional or horizontal, see reverse for bottom hole location.

COUNTY Pottawatomie SEC 20 TWP 10N RGE 3E  
LEASE NAME NorthWestTecomsehUnit WELL NO. 21-21  
SW 1/4 SE 1/4 NE 1/4 NE 1/4 FSL 1770 FWL 2265  
ELEVATION Derrick FL 1053 Ground 1044 Latitude Longitude  
OPERATOR NAME Hood Oil and Gas LLC OTC / OCC OPERATOR NO. 24568  
ADDRESS 10800 E 51st  
CITY Tulsa STATE OK ZIP 74146

SPUD DATE 7/8/81

DRLG FINISHED DATE 7/22/81

DATE OF WELL COMPLETION 8/7/81

1st PROD DATE 9/1/81

RECOMP DATE 7/8/21

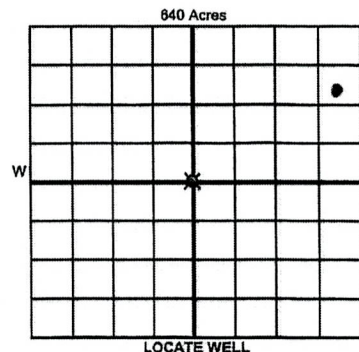

COMPLETION TYPE

☒ SINGLE ZONE  
☐ MULTIPLE ZONE  
Application Date  
☐ COMMINGLED  
Application Date  
LOCATION EXCEPTION ORDER NO.  
MULTIUNIT ORDER NO.  
INCREASED DENSITY ORDER NO.

CASING & CEMENT (Attach Form 1002C)

TYPE	SIZE	WEIGHT	GRADE	FEET	PSI	SAX	TOP OF CMT
CONDUCTOR							
SURFACE	8 5/8	24	H40	398		300	circ to Surface
INTERMEDIATE							
PRODUCTION	4 1/2	10.5	J55	5157		450	3790
LINER							

PACKER @ BRAND & TYPE PLUG @ TYPE PLUG @ TYPE  
PACKER @ BRAND & TYPE PLUG @ TYPE PLUG @ TYPE

TOTAL DEPTH 5200

COMPLETION & TEST DATA BY PRODUCING FORMATION

FORMATION Red Fork  
SPACING & SPACING ORDER NUMBER 342977 (unit)  
CLASS: Oil, Gas, Dry, Inj, Disp, Comm Disp, Svc Oil  
4857-4938  
PERFORATED INTERVALS  
ACID/VOLUME  
FRACTURE TREATMENT (Fluids/Prop Amounts)  
RECEIVED  
JUL 21 2021  
OKLAHOMA CORPORATION COMMISSION

Min Gas Allowable (165:10-17-7)

OR

Oil Allowable (165:10-13-3)

Purchaser/Measurer

First Sales Date

INITIAL TEST DATA

INITIAL TEST DATE	7/8/21
OIL-BBL/DAY	2
OIL-GRAVITY (API)	37
GAS-MCF/DAY	0
GAS-OIL RATIO CU FT/BBL	0
WATER-BBL/DAY	350
PUMPING OR FLOWING	swabbing
INITIAL SHUT-IN PRESSURE	
CHOKE SIZE	
FLOW TUBING PRESSURE	

A record of the formations drilled through, and pertinent remarks are presented on the reverse. I declare that I have knowledge of the contents of this report and am authorized by my organization to make this report, which was prepared by me or under my supervision and direction, with the data and facts stated herein to be true, correct, and complete to the best of my knowledge and belief.

SIGNATURE Gary A Green  
ADDRESS 10800 E 51st  
CITY Tulsa STATE OK ZIP 74146  
DATE 7/19/21 PHONE NUMBER 918-697-0370  
EMAIL ADDRESS gagreen@mail.com

PLEASE TYPE OR USE BLACK INK ONLY

FORMATION RECORD

Give formation names and tops, if available, or descriptions and thickness of formations drilled through. Show intervals cored or drillstem tested.

LEASE NAME NorthWestTecomsehUnit

WELL NO. 21-21

NAMES OF FORMATIONS	TOP
<i>See Original 1002A</i>	

FOR COMMISSION USE ONLY	
ITD on file <input type="checkbox"/> YES <input type="checkbox"/> NO	
APPROVED <input type="checkbox"/> DISAPPROVED <input type="checkbox"/>	2) Reject Codes

Were open hole logs run?	<input checked="" type="radio"/> yes <input type="radio"/> no
Date Last log was run	
Was CO <sub>2</sub> encountered?	<input type="radio"/> yes <input type="radio"/> no at what depths?
Was H <sub>2</sub> S encountered?	<input type="radio"/> yes <input type="radio"/> no at what depths?
Were unusual drilling circumstances encountered?	<input type="radio"/> yes <input type="radio"/> no
If yes, briefly explain below	

Other remarks:

*OCC - order 354225 terminated by 1072 8/12/2021*

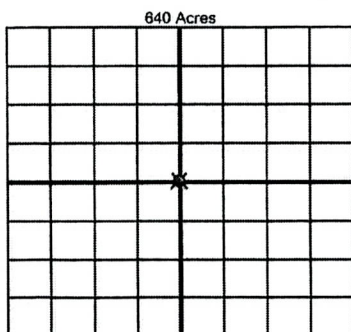

If more than three drainholes are proposed, attach a separate sheet indicating the necessary information.

Direction must be stated in degrees azimuth. Please note, the horizontal drainhole and its end point must be located within the boundaries of the lease or spacing unit.

Directional surveys are required for all drainholes and directional wells

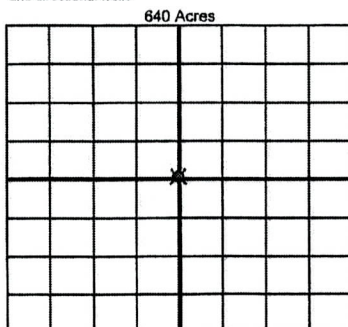

BOTTOM HOLE LOCATION FOR DIRECTIONAL HOLE

SEC	TWP	RGE	COUNTY
1/4	1/4	1/4	1/4
Measured Total Depth		True Vertical Depth	BHL From Lease, Unit, or Property Line:

BOTTOM HOLE LOCATION FOR HORIZONTAL HOLE: (LATERALS)

LATERAL #1

SEC	TWP	RGE	COUNTY
1/4	1/4	1/4	1/4
Depth of Deviation		Radius of Turn	Direction
Measured Total Depth		True Vertical Depth	BHL From Lease, Unit, or Property Line:

LATERAL #2

SEC	TWP	RGE	COUNTY
1/4	1/4	1/4	1/4
Depth of Deviation		Radius of Turn	Direction
Measured Total Depth		True Vertical Depth	BHL From Lease, Unit, or Property Line:

LATERAL #3

SEC	TWP	RGE	COUNTY
1/4	1/4	1/4	1/4
Depth of Deviation		Radius of Turn	Direction
Measured Total Depth		True Vertical Depth	BHL From Lease, Unit, or Property Line: