

Oklahoma Corporation Commission
Oil & Gas Conservation Division
Post Office Box 52000
Oklahoma City, Oklahoma 73152-2000
Rule 165: 10-3-25

Form 1002A

API No.: 35059225480003

Completion Report

Spud Date: May 23, 2010

OTC Prod. Unit No.: 059-226340-0-0000

Drilling Finished Date: June 04, 2010

Amended

1st Prod Date: June 29, 2010

Amend Reason: RECOMPLETION

Completion Date: June 29, 2010

Recomplete Date: July 22, 2021

Drill Type: STRAIGHT HOLE

Min Gas Allowable: Yes

Well Name: MYRTLE B 3-6

Purchaser/Measurer: ENERGY TRANSFER

Location: HARPER 6 26N 24W
W2 NE NE NE
330 FNL 500 FEL of 1/4 SEC
Latitude: 36.4603 Longitude: -99.4911
Derrick Elevation: 2128 Ground Elevation: 2117

First Sales Date: 07/22/2021

Operator: LATIGO OIL AND GAS INC 10027
PO BOX 1208
5815 OKLAHOMA AVE
WOODWARD, OK 73802-1208

Completion Type		Location Exception		Increased Density	
	Single Zone	Order No		Order No	
	Multiple Zone	717588		717626	
X	Commingled				

Casing and Cement							
Type	Size	Weight	Grade	Feet	PSI	SAX	Top of CMT
SURFACE	13 5/8	54.5 / 61	J-55 / HCK- 55	350		475	SURFACE
INTERMEDIATE	8 5/8	24 / 32	J-55 / STC- 55	965		580	SURFACE
PRODUCTION	4 1/2	11.6	N-80	6685		460	4424

Liner								
Type	Size	Weight	Grade	Length	PSI	SAX	Top Depth	Bottom Depth
There are no Liner records to display.								

Total Depth: 6685

Packer	
Depth	Brand & Type
There are no Packer records to display.	

Plug	
Depth	Plug Type
There are no Plug records to display.	

Initial Test Data

Test Date	Formation	Oil BBL/Day	Oil-Gravity (API)	Gas MCF/Day	Gas-Oil Ratio Cu FT/BBL	Water BBL/Day	Pumpin or Flowing	Initial Shut-In Pressure	Choke Size	Flow Tubing Pressure
Jul 30, 2021	TONKAWA-CHEROKEE	2	39.8	35	17500		PUMPING	38	W/O	25

Completion and Test Data by Producing Formation

Formation Name: TONKAWA

Code: 406TNKW

Class: GAS

Spacing Orders

Order No	Unit Size
37035	640

Perforated Intervals

From	To
5382	5392

Acid Volumes

500 GALLONS 7.5% HCL

Fracture Treatments

28,600 GALLONS X-LINK, 38,154 POUNDS 20/40 SAND

Formation Name: CHEROKEE

Code: 404CHRK

Class: GAS

Spacing Orders

Order No	Unit Size
UNSPACED	

Perforated Intervals

From	To
6466	6507

Acid Volumes

9,618 GALLONS 20% FOAMED ACID, 8,316 GALLONS 2% SLICK / CCL WATER

Fracture Treatments

There are no Fracture Treatments records to display.

Formation Name: TONKAWA-CHEROKEE

Code:

Class: GAS

Formation	Top
TONKAWA SAND	5382
CHEROKEE	6466

Were open hole logs run? Yes

Date last log run: June 02, 2010

Were unusual drilling circumstances encountered? No

Explanation:

Other Remarks

There are no Other Remarks.

FOR COMMISSION USE ONLY

1146800

Status: Accepted

03

API NO. 35-059-225480
 OTC PROD. UNIT NO. 059-226340

Oil and Gas Conservation Division
 P.O. Box 52000
 Oklahoma City, OK 73152-2000
 405-522-0577
 OCCCentralProcessing@OCC.OK.GOV



OKLAHOMA
 Corporation
 Commission

Form 1002A
 Rev. 2020

ORIGINAL AMENDED (Reason) **Recompletion** Rule 165:10-3-25
COMPLETION REPORT

TYPE OF DRILLING OPERATION

☒ STRAIGHT HOLE ☐ DIRECTIONAL HOLE ☐ HORIZONTAL HOLE
☐ SERVICE WELL

If directional or horizontal, see reverse for bottom hole location.

COUNTY **HARPER** SEC **6** TWP **26N** RGE **24W** SPUD DATE **05/23/2010**
 LEASE NAME **MYRTLE B** WELL NO. **3-6** DRLG FINISHED DATE **6/4/2010**
W2 1/4 NE 1/4 NE 1/4 NE 1/4 **FNL** **330** **FEL** **500** DATE OF WELL COMPLETION **6/29/2010**
 ELEVATION **2128** Ground **2117** Latitude **36.4603** Longitude **-99.4911**
 OPERATOR NAME **LATIGO OIL & GAS, INC.** OTC / OCC OPERATOR NO. **10027**
 ADDRESS **P.O. BOX 1208**
 CITY **WOODWARD** STATE **OK** ZIP **73802**

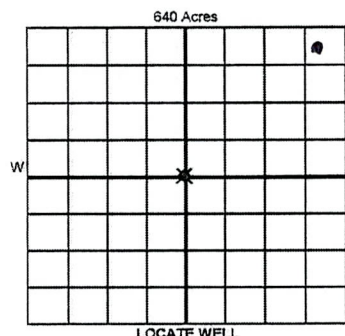

COMPLETION TYPE

☐ SINGLE ZONE
☐ MULTIPLE ZONE
☒ COMMINGLED
 Application Date **8/13/2021**
 LOCATION EXCEPTION ORDER NO. **717588**
 MULTIUNIT ORDER NO.
 INCREASED DENSITY ORDER NO. **717626**

CASING & CEMENT (Attach Form 1002C)

TYPE	SIZE	WEIGHT	GRADE	FEET	PSI	SAX	TOP OF CMT
CONDUCTOR							
SURFACE	13 5/8	54.5/61	2-SS HCR-54	350		475	SURFACE
INTERMEDIATE	8 5/8	24/32	2-SS STE-53	965		580	SURFACE
PRODUCTION	4 1/2	11.6	N-80	6685		460	4424
LINER							

PACKER @ _____ BRAND & TYPE _____ PLUG @ _____ TYPE _____ PLUG @ _____ TYPE _____ TOTAL DEPTH **6685**
 PACKER @ _____ BRAND & TYPE _____ PLUG @ _____ TYPE _____ PLUG @ _____ TYPE _____

COMPLETION & TEST DATA BY PRODUCING FORMATION **406 TNKW 404 CLKK**

FORMATION	Tonkawa Sand	Cherokee			
SPACING & SPACING ORDER NUMBER	37035 (640)	Unspaced			
CLASS: Oil, Gas, Dry, Inj, Disp, Comm Disp, Svc	Gas	Oil Gas			
PERFORATED INTERVALS	5382-5392'	6466-6507'			
ACID/VOLUME		9,618 GAL 20% FOAMED ACID			
FRACTURE TREATMENT (Fluids/Prop Amounts)	500 gal 7.5% HCL 28,600 gal X-link, 38,154# 20/40 sd	8,316 GALS 2% SLICK/CCL WATER			

RECEIVED

AUG 20 2021

**OKLAHOMA CORPORATION
 COMMISSION**

☒ Min Gas Allowable (165:10-17-7)
 OR
☐ Oil Allowable (165:10-13-3)

Purchaser/Measurer
 First Sales Date

Energy Transfer
7/22/2021

INITIAL TEST DATA

INITIAL TEST DATE	7/30/2021				
OIL-BBL/DAY	2				
OIL-GRAVITY (API)	39.8				
GAS-MCF/DAY	35				
GAS-OIL RATIO CU FT/BBL	17500				
WATER-BBL/DAY	0				
PUMPING OR FLOWING	Pumping				
INITIAL SHUT-IN PRESSURE	38#				
CHOKE SIZE	W/O				
FLOW TUBING PRESSURE	25#				

A record of the formations drilled through, and pertinent remarks are presented on the reverse. I declare that I have knowledge of the contents of this report and am authorized by my organization to make this report, which was prepared by me or under my supervision and direction, with the data and facts stated herein to be true, correct, and complete to the best of my knowledge and belief.

RYAN BARBY **8/16/2021** **580-256-1416**
 SIGNATURE NAME (PRINT OR TYPE) DATE PHONE NUMBER
P.O. BOX 1208 **WOODWARD** **OK** **73802** **ryanb@latigooil.com**
 ADDRESS CITY STATE ZIP EMAIL ADDRESS

PLEASE TYPE OR USE BLACK INK ONLY
FORMATION RECORD

Give formation names and tops, if available, or descriptions and thickness of formations drilled through. Show intervals cored or drillstem tested.

NAMES OF FORMATIONS	TOP
Tonkawa Sand	5382'
Cherokee	6466'

LEASE NAME Myrtle B WELL NO. 3-6

FOR COMMISSION USE ONLY	
ITD on file <input type="checkbox"/> YES <input type="checkbox"/> NO	
APPROVED _____ DISAPPROVED _____	2) Reject Codes
<div></div> <div></div> <div></div> <div></div>	

Were open hole logs run?	<input checked="" type="radio"/> yes <input type="radio"/> no
Date Last log was run	<u>6/2/2010</u>
Was CO ₂ encountered?	<input type="radio"/> yes <input checked="" type="radio"/> no at what depths? _____
Was H ₂ S encountered?	<input type="radio"/> yes <input checked="" type="radio"/> no at what depths? _____
Were unusual drilling circumstances encountered?	<input type="radio"/> yes <input checked="" type="radio"/> no
If yes, briefly explain below	

Other remarks:

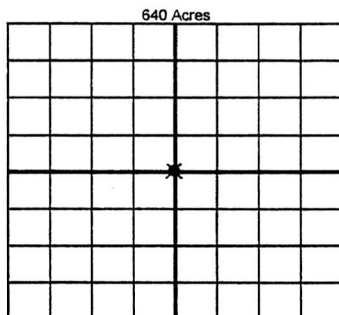

If more than three drainholes are proposed, attach a separate sheet indicating the necessary information.

Direction must be stated in degrees azimuth. Please note, the horizontal drainhole and its end point must be located within the boundaries of the lease or spacing unit.

Directional surveys are required for all drainholes and directional wells

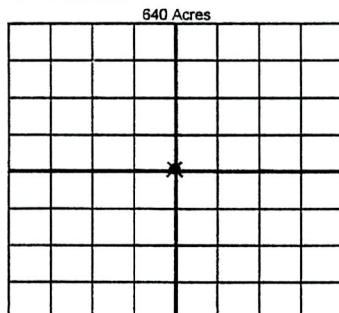

BOTTOM HOLE LOCATION FOR DIRECTIONAL HOLE

SEC	TWP	RGE	COUNTY
1/4	1/4	1/4	1/4
Measured Total Depth		True Vertical Depth	BHL From Lease, Unit, or Property Line:

BOTTOM HOLE LOCATION FOR HORIZONTAL HOLE: (LATERALS)

LATERAL #1

SEC	TWP	RGE	COUNTY
1/4	1/4	1/4	1/4
Depth of Deviation		Radius of Turn	Direction
Measured Total Depth		True Vertical Depth	BHL From Lease, Unit, or Property Line:

LATERAL #2

SEC	TWP	RGE	COUNTY
1/4	1/4	1/4	1/4
Depth of Deviation		Radius of Turn	Direction
Measured Total Depth		True Vertical Depth	BHL From Lease, Unit, or Property Line:

LATERAL #3

SEC	TWP	RGE	COUNTY
1/4	1/4	1/4	1/4
Depth of Deviation		Radius of Turn	Direction
Measured Total Depth		True Vertical Depth	BHL From Lease, Unit, or Property Line: