

Oklahoma Corporation Commission
Oil & Gas Conservation Division
Post Office Box 52000
Oklahoma City, Oklahoma 73152-2000
Rule 165: 10-3-25

Form 1002A

API No.: 35007254670005

Completion Report

Spud Date: October 01, 2011

OTC Prod. Unit No.: 007-207186-0-0000

Drilling Finished Date: October 20, 2011

Amended

1st Prod Date: January 18, 2012

Amend Reason: RECOMPLETION

Completion Date: February 29, 2012

Recomplete Date: March 01, 2022

Drill Type: STRAIGHT HOLE

Well Name: MAGGIE 1-13

Purchaser/Measurer: DCP MIDSTREAM

Location: BEAVER 13 4N 26E CM
NE SE NW NW
1860 FSL 1100 FWL of 1/4 SEC
Latitude: 36.817565 Longitude: -100.213951
Derrick Elevation: 2361 Ground Elevation: 2351

First Sales Date: 01/18/2012

Operator: LATIGO OIL AND GAS INC 10027
PO BOX 1208
5815 OKLAHOMA AVE
WOODWARD, OK 73802-1208

Completion Type		Location Exception		Increased Density	
X	Single Zone	Order No		Order No	
	Multiple Zone	There are no Location Exception records to display.		There are no Increased Density records to display.	
	Commingled				

Casing and Cement							
Type	Size	Weight	Grade	Feet	PSI	SAX	Top of CMT
SURFACE	8 5/8	24	ST & C	700		400	SURFACE
PRODUCTION	5 1/2	17	N/JLTC	9330		780	2750

Liner								
Type	Size	Weight	Grade	Length	PSI	SAX	Top Depth	Bottom Depth
There are no Liner records to display.								

Total Depth: 9345

Packer	
Depth	Brand & Type
There are no Packer records to display.	

Plug	
Depth	Plug Type
5601	BP
7505	BP
9125	CIBP

Initial Test Data

Test Date	Formation	Oil BBL/Day	Oil-Gravity (API)	Gas MCF/Day	Gas-Oil Ratio Cu FT/BBL	Water BBL/Day	Pumpin or Flowing	Initial Shut-In Pressure	Choke Size	Flow Tubing Pressure
Sep 28, 2021	KANSAS CITY	0.5				20	PUMPING	130		
Mar 01, 2022	PERMIAN (COUN GROVE)			319	319	32	PUMPING	340		110

Completion and Test Data by Producing Formation									
Formation Name: KANSAS CITY				Code: 405KSSC			Class: DRY		
Spacing Orders				Perforated Intervals					
Order No		Unit Size		From			To		
684936		320		5710			5712		
Acid Volumes				Fracture Treatments					
250 GALLONS 15%				There are no Fracture Treatments records to display.					
Formation Name: PERMIAN (COUN GROVE)				Code: 451PMCGV			Class: GAS		
Spacing Orders				Perforated Intervals					
Order No		Unit Size		From			To		
684936		320		3240			3248		
Acid Volumes				Fracture Treatments					
250 GALLONS 15%				There are no Fracture Treatments records to display.					

Formation	Top
PERMIAN (COUNCIL GROVE)	3100
KANSAS CITY	5710

Were open hole logs run? Yes
Date last log run: October 20, 2011

Were unusual drilling circumstances encountered? No
Explanation:

Other Remarks
SET PLUG AT 5,601', PRODUCE AS SINGLE ZONE, PERMIAN (COUNCIL GROVE) WELL

FOR COMMISSION USE ONLY
<div> <div>Status: Accepted</div> <div>1147711</div> </div>

API NO. 35-007-25467
OTC PROD. UNIT NO. 007-207186

Oil and Gas Conservation Division
P.O. Box 52000
Oklahoma City, OK 73152-2000
405-521-2331
OCCCentralProcessing@OCC.OK.GOV



OKLAHOMA
Corporation
Commission

Form 1002A
Rev. 2021

ORIGINAL
AMENDED (Reason)

Re-Completion

Rule 105:10-3-25

COMPLETION REPORT

TYPE OF DRILLING OPERATION

☒ STRAIGHT HOLE ☐ DIRECTIONAL HOLE ☐ HORIZONTAL HOLE
☐ SERVICE WELL

If directional or horizontal, see reverse for bottom hole location.

COUNTY BEAVER SEC 13 TWP 4N RGE 26ECM

LEASE NAME MAGGIE

WELL NO. 1-13

SPUD DATE 10/1/2011

DRLG FINISHED DATE 10/20/2011

DATE OF WELL COMPLETION 2/29/2012

1st PROD DATE 1/18/2012

RECOMP DATE 3/1/2022

ELEVATION 2361 Ground 2351

Latitude

Longitude

OPERATOR NAME LATIGO OIL & GAS, INC

OTC / OCC OPERATOR NO. 10027

ADDRESS P.O. BOX 1208

CITY WOODWARD

STATE OK

ZIP 73802

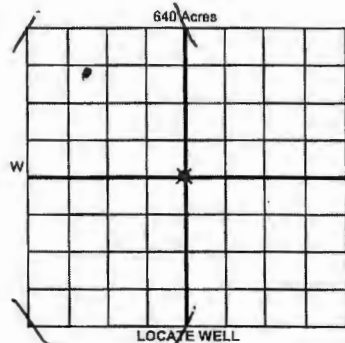

LOCATE WELL

COMPLETION TYPE

☒ SINGLE ZONE
☐ MULTIPLE ZONE
☐ COMMINGLED
LOCATION EXCEPTION ORDER NO.
MULTIUNIT ORDER NO.
INCREASED DENSITY ORDER NO.

CASING & CEMENT (Attach Form 1002C)

TYPE	SIZE	WEIGHT	GRADE	FEET	PSI	SAX	TOP OF CMT
CONDUCTOR							
SURFACE	8 5/8"	24#	ST&C	700'		400	SURFACE
INTERMEDIATE							
PRODUCTION	5 1/2"	17#	NJLTC	9330'		780	2750'
LINER							

PACKER @ BRAND & TYPE

PLUG @ 7505' TYPE BP

PLUG @ 9125' TYPE CIBP

TOTAL DEPTH 9345'

PACKER @ BRAND & TYPE

PLUG @ 5601' TYPE BP

PLUG @ TYPE

COMPLETION & TEST DATA BY PRODUCING FORMATION

405K55C 451PMLGV

FORMATION	KANSAS CITY	PERMAN (COUNCIL GROVE)				NoFrac
SPACING & SPACING ORDER NUMBER	684936(320)	684936(320)				
CLASS: Oil, Gas, Dry, Inj, Disp, Comm Disp, Svc	Dry	Gas				
PERFORATED INTERVALS	5710-12	3240-48'				
ACID VOLUME	250 GAL 15%	250 GAL 15%				
FRACTURE TREATMENT (Fluids/Prop Amounts)						

Min Gas Allowable (105:10-17-7)
OR
Oil Allowable (105:10-13-3)

Purchaser/Measurer
First Sales Date

DCP MIDSTREAM
1/18/2012

INITIAL TEST DATA

INITIAL TEST DATE	9/28/21	3/1/2022			
OIL-BBL/DAY	.5	0			
OIL-GRAVITY (API)					
GAS-MCF/DAY	0	319			
GAS-OIL RATIO CU FT/BBL	0	319			
WATER-BBL/DAY	20	32			
PUMPING OR FLOWING	PUMPING	PUMPING			
INITIAL SHUT-IN PRESSURE	130#	340#			
CHOKE SIZE					
FLOW TUBING PRESSURE		110#			

A record of the formations drilled through, and pertinent remarks are presented on the reverse. I declare that I have knowledge of the contents of this report and am authorized by my organization to make this report, which was prepared by me or under my supervision and direction, with the data and facts stated herein to be true, correct, and complete to the best of my knowledge and belief.

SIGNATURE RYAN BARBY
P.O. BOX 1208 WOODWARD OK 73802
ADDRESS CITY STATE ZIP
DATE 3/9/2022 PHONE NUMBER 580-256-1416
EMAIL ADDRESS RYANB@LATIGOIL.COM

PLEASE TYPE OR USE BLACK INK ONLY
FORMATION RECORD

Give formation names and tops, if available, or descriptions and thickness of formations drilled through. Show intervals cored or drillstem tested.

NAMES OF FORMATIONS	TOP
PERMIAN (COUNCIL GROVE)	3100'
KANSAS CITY	5710'

LEASE NAME MAGGIE WELL NO. 1-13

FOR COMMISSION USE ONLY	
ITD on file <input type="checkbox"/> YES <input type="checkbox"/> NO	
APPROVED _____ DISAPPROVED _____	2) Reject Codes

Were open hole logs run?	<input checked="" type="radio"/> yes <input type="radio"/> no
Date Last log was run	10/20/2011
Was CO ₂ encountered?	<input type="radio"/> yes <input checked="" type="radio"/> no at what depths? _____
Was H ₂ S encountered?	<input type="radio"/> yes <input checked="" type="radio"/> no at what depths? _____
Were unusual drilling circumstances encountered?	<input type="radio"/> yes <input checked="" type="radio"/> no
If yes, briefly explain below	

Other remarks: SET PLUG AT 5601', PRODUCE AS SINGLE ZONE, PERMAIN (COUNCIL GROVE) WELL

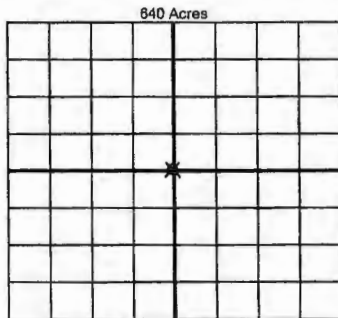

If more than three drainholes are proposed, attach a separate sheet indicating the necessary information.

Direction must be stated in degrees azimuth. Please note, the horizontal drainhole and its end point must be located within the boundaries of the lease or spacing unit.

Directional surveys are required for all drainholes and directional wells

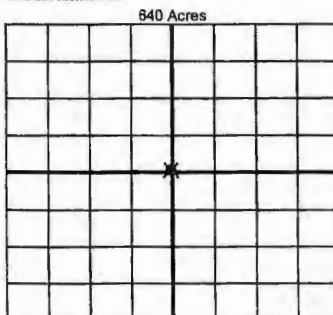

BOTTOM HOLE LOCATION FOR DIRECTIONAL HOLE

SEC	TWP	RGE	COUNTY
1/4	1/4	1/4	1/4
Measured Total Depth		True Vertical Depth	BHL From Lease, Unit, or Property Line:

BOTTOM HOLE LOCATION FOR HORIZONTAL HOLE: (LATERALS)

LATERAL #1			
SEC	TWP	RGE	COUNTY
1/4	1/4	1/4	1/4
Depth of Deviation		Radius of Turn	Direction
Measured Total Depth		True Vertical Depth	BHL From Lease, Unit, or Property Line:

LATERAL #2			
SEC	TWP	RGE	COUNTY
1/4	1/4	1/4	1/4
Depth of Deviation		Radius of Turn	Direction
Measured Total Depth		True Vertical Depth	BHL From Lease, Unit, or Property Line:

LATERAL #3			
SEC	TWP	RGE	COUNTY
1/4	1/4	1/4	1/4
Depth of Deviation		Radius of Turn	Direction
Measured Total Depth		True Vertical Depth	BHL From Lease, Unit, or Property Line: