

Oklahoma Corporation Commission  
Oil & Gas Conservation Division  
Post Office Box 52000  
Oklahoma City, Oklahoma 73152-2000  
Rule 165: 10-3-25

Form 1002A

API No.: 35059224640002

**Completion Report**

Spud Date: February 27, 2008

OTC Prod. Unit No.: 059-123298-0-0000

Drilling Finished Date: March 08, 2008

**Amended**

1st Prod Date: March 19, 2008

Amend Reason: RECOMPLETE AND COMMINGLE

Completion Date: March 21, 2008

Recomplete Date: January 31, 2022

**Drill Type: STRAIGHT HOLE**

Min Gas Allowable: Yes

Well Name: BENTLEY 2-5

Purchaser/Measurer: DCP MIDSTREAM

Location: HARPER 5 26N 24W  
E2 SW SW NE  
330 FSL 490 FWL of 1/4 SEC  
Latitude: 36.7619591 Longitude: -99.8071892  
Derrick Elevation: 2151 Ground Elevation: 2136

First Sales Date: 03/24/2008

Operator: LATIGO OIL AND GAS INC 10027  
PO BOX 1208  
5815 OKLAHOMA AVE  
WOODWARD, OK 73802-1208

Completion Type		Location Exception		Increased Density	
	Single Zone	Order No		Order No	
	Multiple Zone	There are no Location Exception records to display.		718518	
X	Commingled				

Casing and Cement							
Type	Size	Weight	Grade	Feet	PSI	SAX	Top of CMT
SURFACE	8 5/8	24 / 32	K-55	965	1000	530	SURFACE
PRODUCTION	4.5	11.6	N-80	7020		465	4084

Liner								
Type	Size	Weight	Grade	Length	PSI	SAX	Top Depth	Bottom Depth
There are no Liner records to display.								

**Total Depth: 7020**

Packer	
Depth	Brand & Type
There are no Packer records to display.	

Plug	
Depth	Plug Type
There are no Plug records to display.	

Initial Test Data
-------------------

Test Date	Formation	Oil BBL/Day	Oil-Gravity (API)	Gas MCF/Day	Gas-Oil Ratio Cu FT/BBL	Water BBL/Day	Pumpin or Flowing	Initial Shut-In Pressure	Choke Size	Flow Tubing Pressure
May 01, 2020	CHEROKEE	1		5	5000		PUMPING	160		
Feb 18, 2022	CHESTER			51		1	FLOWING	1575		45

#### Completion and Test Data by Producing Formation

Formation Name: CHESTER

Code: 354CSTR

Class: GAS

##### Spacing Orders

Order No	Unit Size
52944	640
92008	NPT

##### Perforated Intervals

From	To
6970	6982

##### Acid Volumes

1,500 GALLONS 15%

##### Fracture Treatments

There are no Fracture Treatments records to display.

Formation Name: CHEROKEE

Code: 404CHRK

Class: GAS

##### Spacing Orders

Order No	Unit Size
UNSPACES	

##### Perforated Intervals

From	To
6522	6529
6532	6534
6547	6552
6565	6571
6581	6583

##### Acid Volumes

There are no Acid Volume records to display.

##### Fracture Treatments

24,166 GALLONS 20% ACID WITH 50Q N2

Formation	Top
CHEROKEE	6522
CHESTER	6858

Were open hole logs run? Yes

Date last log run: June 03, 2008

Were unusual drilling circumstances encountered? No

Explanation:

#### Other Remarks

There are no Other Remarks.

#### FOR COMMISSION USE ONLY

1147709



API NO. 35-05922464  
OTC PROD. UNIT NO. 059-123298

Oil and Gas Conservation Division  
P.O. Box 52000  
Oklahoma City, OK 73152-2000  
405-521-2331  
OCCentralProcessing@OCC.OK.GOV



OKLAHOMA  
Corporation  
Commission

Form 1002A  
Rev. 2021

ORIGINAL  
AMENDED (Reason) RECOMPLETE AND COMMINGLE

Rule 165:10-3-25

COMPLETION REPORT

TYPE OF DRILLING OPERATION

☒ STRAIGHT HOLE ☐ DIRECTIONAL HOLE ☐ HORIZONTAL HOLE  
☐ SERVICE WELL

If directional or horizontal, see reverse for bottom hole location.

COUNTY HARPER SEC 5 TWP 26N RGE 24W

LEASE NAME BENTLEY

WELL NO. 2-5

SPUD DATE 2/27/2008

DRLG FINISHED DATE 3/8/2008

DATE OF WELL COMPLETION 3/21/2008

1st PROD DATE 3/19/2008

RECOMP DATE 1/31/2022

ELEVATION 2151 Ground 2136

Latitude

Longitude

OPERATOR NAME LATIGO OIL & GAS, INC

OTC / OCC OPERATOR NO. 10027

ADDRESS P.O. BOX 1208

CITY WOODWARD

STATE OK

ZIP 73802

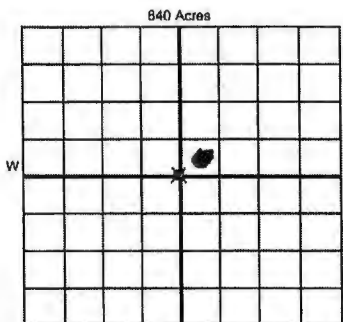

COMPLETION TYPE

☐ SINGLE ZONE  
☐ MULTIPLE ZONE  
☒ COMMINGLED Application Date 2/9/2022  
LOCATION EXCEPTION ORDER NO.  
MULTIUNIT ORDER NO.  
INCREASED DENSITY ORDER NO. 718518

CASING & CEMENT (Attach Form 1002C)

TYPE	SIZE	WEIGHT	GRADE	FEET	PSI	SAX	TOP OF CMT
CONDUCTOR							
SURFACE	8 5/8"	24/32	K55	965'	1000	530	SURFACE
INTERMEDIATE							
PRODUCTION	4.5"	11.6	N80	7020		465	4084'
LINER							

PACKER @ BRAND & TYPE PLUG @ TYPE PLUG @ TYPE PLUG @ TYPE  
PACKER @ BRAND & TYPE PLUG @ TYPE PLUG @ TYPE PLUG @ TYPE  
COMPLETION & TEST DATA BY PRODUCING FORMATION 354 CSTR 484 CHRK

FORMATION	CHESTER	CHEROKEE	Old Frac
SPACING & SPACING	(640) 92008	UNSPACED	
ORDER NUMBER 52944			
CLASS: Oil, Gas, Dry, Inj, (640)	Gas	Oil Gas	when commingled
Diap, Comm Diap, Svc			
PERFORATED INTERVALS	6970-6982'	6522-29', 6532-34'	
		6547-52', 6565-71'	
		6581-83'	
ACID/VOLUME	1,500 gal 15%		
FRACTURE TREATMENT (Fluids/Prop Amounts)	NA	24,166 GAL 20% ACID, W/ 50Q N2	

INITIAL TEST DATA ☒ Min Gas Allowable (165:10-17-7) OR Oil Allowable (165:10-13-3) Purchaser/Measurer First Sales Date DCP MIDSTREAM 3/24/2008

INITIAL TEST DATE	2/18/2022	5/1/2020			
OIL-BBL/DAY	0	1			
OIL-GRAVITY (API)					
GAS-MCF/DAY	51	5			
GAS-OIL RATIO CU FT/BBL	51	5000			
WATER-BBL/DAY	1	0			
PUMPING OR FLOWING	FLOWING	PUMPING			
INITIAL SHUT-IN PRESSURE	1575#	160#			
CHOKE SIZE					
FLOW TUBING PRESSURE	45#				

A record of the formations drilled through, and pertinent remarks are presented on the reverse. I declare that I have knowledge of the contents of this report and am authorized by my organization to make this report, which was prepared by me or under my supervision and direction, with the data and facts stated herein to be true, correct, and complete to the best of my knowledge and belief.

SIGNATURE RYAN BARBY 3/9/2022 580-256-1416  
P.O. BOX 1208 WOODWARD OK 73802 RYANB@LATIGOOIL.COM  
ADDRESS CITY STATE ZIP EMAIL ADDRESS

PLEASE TYPE OR USE BLACK INK ONLY  
FORMATION RECORD

Give formation names and tops, if available, or descriptions and thickness of formations drilled through. Show intervals cored or drillstem tested.

NAMES OF FORMATIONS	TOP
CHEROKEE	6522'
CHESTER	6858'

LEASE NAME BENTLEY WELL NO. 2-5

FOR COMMISSION USE ONLY	
ITD on file <input type="checkbox"/> YES <input type="checkbox"/> NO	
APPROVED _____	DISAPPROVED _____
2) Reject Codes	

Were open hole logs run?	<input checked="" type="radio"/> yes <input type="radio"/> no
Date Last log was run	6/3/2008
Was CO <sub>2</sub> encountered?	<input type="radio"/> yes <input checked="" type="radio"/> no at what depths? _____
Was H <sub>2</sub> S encountered?	<input type="radio"/> yes <input checked="" type="radio"/> no at what depths? _____
Were unusual drilling circumstances encountered?	<input type="radio"/> yes <input checked="" type="radio"/> no
If yes, briefly explain below	

Other remarks:

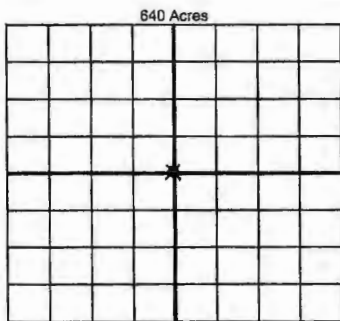
If more than three drainholes are proposed, attach a separate sheet indicating the necessary information.

Direction must be stated in degrees azimuth. Please note, the horizontal drainhole and its end point must be located within the boundaries of the lease or spacing unit.

Directional surveys are required for all drainholes and directional wells

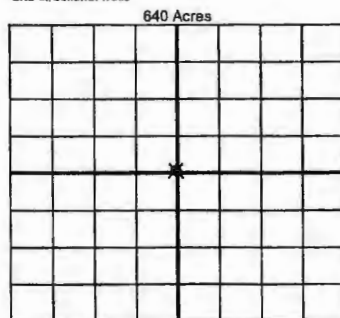

BOTTOM HOLE LOCATION FOR DIRECTIONAL HOLE

SEC	TWP	RGE	COUNTY
1/4	1/4	1/4	1/4
Measured Total Depth		True Vertical Depth	Feet From 1/4 Sec Lines BHL From Lease, Unit, or Property Line:

BOTTOM HOLE LOCATION FOR HORIZONTAL HOLE: (LATERALS)

LATERAL #1			
SEC	TWP	RGE	COUNTY
1/4	1/4	1/4	1/4
Depth of Deviation	Radius of Turn	Direction	Total Length
Measured Total Depth	True Vertical Depth	BHL From Lease, Unit, or Property Line:	

LATERAL #2			
SEC	TWP	RGE	COUNTY
1/4	1/4	1/4	1/4
Depth of Deviation	Radius of Turn	Direction	Total Length
Measured Total Depth	True Vertical Depth	BHL From Lease, Unit, or Property Line:	

LATERAL #3			
SEC	TWP	RGE	COUNTY
1/4	1/4	1/4	1/4
Depth of Deviation	Radius of Turn	Direction	Total Length
Measured Total Depth	True Vertical Depth	BHL From Lease, Unit, or Property Line:	