

Oklahoma Corporation Commission  
Oil & Gas Conservation Division  
Post Office Box 52000  
Oklahoma City, Oklahoma 73152-2000  
Rule 165: 10-3-25

Form 1002A

API No.: 35053012620002

**Completion Report**

Spud Date: July 10, 1963

OTC Prod. Unit No.:

Drilling Finished Date: July 23, 1963

**Amended**

1st Prod Date: August 06, 1964

Amend Reason: CONVERTED TO DISPOSAL

Completion Date: August 06, 1963

Recomplete Date: January 21, 2022

**Drill Type:** SERVICE WELL

Well Name: SW WAKITA UNIT 2-2

Purchaser/Measurer:

Location: GRANT 6 27N 7W  
C SE SE  
660 FSL 1980 FWL of 1/4 SEC  
Latitude: 36.84243 Longitude: -97.98701  
Derrick Elevation: 1122 Ground Elevation: 1118

First Sales Date:

Operator: CASILLAS PETROLEUM CORPORATION 17728  
PO BOX 3411  
410 S BOSTON AVE SUITE 2400  
TULSA, OK 74101-3411

Completion Type		Location Exception		Increased Density	
X	Single Zone	Order No		Order No	
	Multiple Zone	There are no Location Exception records to display.		There are no Increased Density records to display.	
	Commingled				

Casing and Cement							
Type	Size	Weight	Grade	Feet	PSI	SAX	Top of CMT
SURFACE	8 5/8	24	SMLS	263	1000	175	SURFACE
PRODUCTION	4 1/2	9.5	SMLS	5083	1000	75	4553

Liner								
Type	Size	Weight	Grade	Length	PSI	SAX	Top Depth	Bottom Depth
There are no Liner records to display.								

**Total Depth: 5084**

Packer		Plug	
Depth	Brand & Type	Depth	Plug Type
4332	MODEL R	4450	CIBP

Initial Test Data
-------------------

Test Date	Formation	Oil BBL/Day	Oil-Gravity (API)	Gas MCF/Day	Gas-Oil Ratio Cu FT/BBL	Water BBL/Day	Pumpin or Flowing	Initial Shut- In Pressure	Choke Size	Flow Tubing Pressure
-----------	-----------	----------------	----------------------	----------------	----------------------------	------------------	----------------------	---------------------------------	---------------	-------------------------

There are no Initial Data records to display.

Completion and Test Data by Producing Formation

Formation Name: LAYTON (COTT GRVE)      Code: 405LYTCG      Class: DISP

Spacing Orders		Perforated Intervals	
Order No	Unit Size	From	To
There are no Spacing Order records to display.		4372	4410
Acid Volumes		Fracture Treatments	
There are no Acid Volume records to display.		There are no Fracture Treatments records to display.	

Formation	Top
-----------	-----

Were open hole logs run? No  
Date last log run:  
  
Were unusual drilling circumstances encountered? No  
Explanation:

Other Remarks
CONVERTED WELL FROM A PRODUCING WELL TO A DISPOSAL WELL. OCC - UIC PERMIT NUMBER 220010120

FOR COMMISSION USE ONLY
<div>Status: Accepted</div> <div>1147704</div>

API NO. 35-053-01262  
OTC PROD.  
UNIT NO.

Oil and Gas Conservation Division  
P.O. Box 52000  
Oklahoma City, OK 73152-2000  
405-521-2331  
OCCCentralProcessing@OCC.OK.GOV



OKLAHOMA  
Corporation  
Commission

Form 1002A  
Rev. 2021

ORIGINAL  
AMENDED (Reason)

CONVERTED TO DISPOSAL WELL

Rule 165:10-3-25

COMPLETION REPORT

TYPE OF DRILLING OPERATION

☒ STRAIGHT HOLE ☐ DIRECTIONAL HOLE ☐ HORIZONTAL HOLE  
☒ SERVICE WELL

If directional or horizontal, see reverse for bottom hole location.

COUNTY	GRANT	SEC	06	TWP	27N	RGE	07W
LEASE NAME	S.W. WAKITA UNIT			WELL NO.	2-2		
1/4	C	1/4	SE	1/4	SE	1/4	FSL
ELEVATION		1122		Ground		1118	
Derrick FL		1122		Latitude		Longitude	
OPERATOR NAME				CASILLAS PETROLEUM CORP			
ADDRESS				PO BOX 3411			
CITY				TULSA		STATE	
OK				ZIP			
74101-3411							

SPUD DATE 07/10/1963  
DRLG FINISHED DATE 07/23/1963  
DATE OF WELL COMPLETION 08/06/1963  
1st PROD DATE 08/06/1963  
RECOMP DATE 01/21/2022

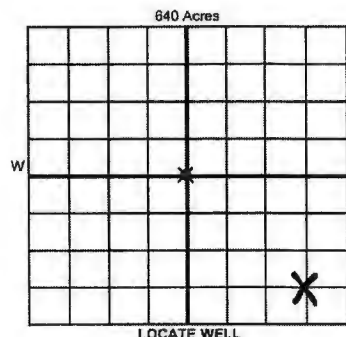

LOCATE WELL

COMPLETION TYPE

<input checked="" type="radio"/> SINGLE ZONE	
<input type="radio"/> MULTIPLE ZONE	
Application Date	
<input type="radio"/> COMMINGLED	
Application Date	
LOCATION EXCEPTION ORDER NO.	
MULTIUNIT ORDER NO.	
INCREASED DENSITY ORDER NO.	

CASING & CEMENT (Attach Form 1002C)

TYPE	SIZE	WEIGHT	GRADE	FEET	PSI	SAX	TOP OF CMT
CONDUCTOR							
SURFACE	8-5/8"	24	SMLS	263'	1000	175	SURFACE
INTERMEDIATE							
PRODUCTION	4-1/2"	9.5	SMLS	5083'	1000	75	4553
LINER							

PACKER @ 4332 BRAND & TYPE MODEL R PLUG @ 4450 TYPE CIBP PLUG @ TYPE TOTAL DEPTH 5084

COMPLETION & TEST DATA BY PRODUCING FORMATION

FORMATION	LAYTON, COTTAGE GROVE
SPACING & SPACING ORDER NUMBER	2200101201 see remarks
CLASS: Oil, Gas, Dry, Inj, Disp, Comm Disp, Svc	Disp
PERFORATED INTERVALS	4372-4410'
ACID/VOLUME	
FRACTURE TREATMENT (Fluids/Prop Amounts)	

Min Gas Allowable (165:10-7-7)

OR

Oil Allowable (165:10-13-3)

Purchaser/Measurer

First Sales Date

INITIAL TEST DATA

INITIAL TEST DATE	
OIL-BBL/DAY	
OIL-GRAVITY (API)	
GAS-MCF/DAY	
GAS-OIL RATIO CU FT/BBL	
WATER-BBL/DAY	
PUMPING OR FLOWING	
INITIAL SHUT-IN PRESSURE	
CHOKE SIZE	
FLOW TUBING PRESSURE	

RECEIVED

MAR 11 2022

OKLAHOMA CORPORATION  
COMMISSION

A record of the formations drilled through, and pertinent remarks are presented on the reverse. I declare that I have knowledge of the contents of this report and am authorized by my organization to make this report, which was prepared by me or under my supervision and direction, with the data and facts stated herein to be true, correct, and complete to the best of my knowledge and belief.

SIGNATURE ADDRESS 401 S BOSTON AVE STE 2400 TULSA OK 74103  
NAME (PRINT OR TYPE) GREG R. CASILLAS  
DATE 3/8/22 PHONE NUMBER 9185825310  
EMAIL ADDRESS GCASILLAS@CASILLASPETRO.COM

PLEASE TYPE OR USE BLACK INK ONLY  
FORMATION RECORD

Give formation names and tops, if available, or descriptions and thickness of formations drilled through. Show intervals cored or drillstem tested.

NAMES OF FORMATIONS	TOP
X	

LEASE NAME \_\_\_\_\_ WELL NO. \_\_\_\_\_

FOR COMMISSION USE ONLY	
ITD on file <input type="checkbox"/> YES <input type="checkbox"/> NO	
APPROVED _____	DISAPPROVED _____
2) Reject Codes	

Were open hole logs run?	<input type="radio"/> yes <input type="radio"/> no
Date Last log was run	_____
Was CO <sub>2</sub> encountered?	<input type="radio"/> yes <input type="radio"/> no at what depths? _____
Was H <sub>2</sub> S encountered?	<input type="radio"/> yes <input type="radio"/> no at what depths? _____
Were unusual drilling circumstances encountered?	<input type="radio"/> yes <input type="radio"/> no
If yes, briefly explain below	

Other remarks: **CONVERTED WELL FROM A PRODUCING WELL TO A DISPOSAL WELL**  
*occ - uic permit 2200101201*

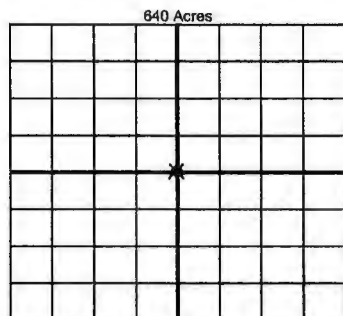

If more than three drainholes are proposed, attach a separate sheet indicating the necessary information.

Direction must be stated in degrees azimuth. Please note, the horizontal drainhole and its end point must be located within the boundaries of the lease or spacing unit.

Directional surveys are required for all drainholes and directional wells

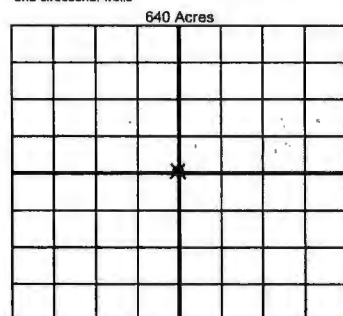

**BOTTOM HOLE LOCATION FOR DIRECTIONAL HOLE**

SEC	TWP	RGE	COUNTY
1/4	1/4	1/4	1/4
Measured Total Depth	True Vertical Depth	Feet From 1/4 Sec Lines	
		BHL From Lease, Unit, or Property Line:	

**BOTTOM HOLE LOCATION FOR HORIZONTAL HOLE: (LATERALS)**

LATERAL #1			
SEC	TWP	RGE	COUNTY
1/4	1/4	1/4	1/4
Depth of Deviation	Radius of Turn	Direction	Total Length
Measured Total Depth	True Vertical Depth	BHL From Lease, Unit, or Property Line:	

LATERAL #2			
SEC	TWP	RGE	COUNTY
1/4	1/4	1/4	1/4
Depth of Deviation	Radius of Turn	Direction	Total Length
Measured Total Depth	True Vertical Depth	BHL From Lease, Unit, or Property Line:	

LATERAL #3			
SEC	TWP	RGE	COUNTY
1/4	1/4	1/4	1/4
Depth of Deviation	Radius of Turn	Direction	Total Length
Measured Total Depth	True Vertical Depth	BHL From Lease, Unit, or Property Line:	