

Oklahoma Corporation Commission
Oil & Gas Conservation Division
Post Office Box 52000
Oklahoma City, Oklahoma 73152-2000
Rule 165: 10-3-25

Form 1002A

API No.: 35151226800002

Completion Report

Spud Date: March 09, 2006

OTC Prod. Unit No.:

Drilling Finished Date: April 19, 2006

Amended

1st Prod Date:

Amend Reason: ACID WORK / REPLACE INJECTION STRING

Completion Date: April 19, 2006

Recomplete Date: February 28, 2020

Drill Type: DIRECTIONAL HOLE

SERVICE WELL

Well Name: DACOMA SWD 1

Purchaser/Measurer:

Location: WOODS 35 26N 13W
SE SE SE SE
318 FSL 228 FEL of 1/4 SEC
Latitude: 36.681406 Longitude: -98.55775
Derrick Elevation: 0 Ground Elevation: 1384

First Sales Date:

Operator: AMPLIFY OKLAHOMA OPERATING LLC 23079

500 DALLAS ST STE 1700
HOUSTON, TX 77002-4800

Completion Type		Location Exception		Increased Density	
	Single Zone	Order No		Order No	
	Multiple Zone	There are no Location Exception records to display.		There are no Increased Density records to display.	
	Commingled				

Casing and Cement							
Type	Size	Weight	Grade	Feet	PSI	SAX	Top of CMT
SURFACE	13 3/8	48	J-55	505		430	SURFACE
PRODUCTION	9 5/8	40	N-80	7060		450	5970

Liner								
Type	Size	Weight	Grade	Length	PSI	SAX	Top Depth	Bottom Depth
There are no Liner records to display.								

Total Depth: 10276

Packer		Plug	
Depth	Brand & Type	Depth	Plug Type
6668	9-5/8" AS1-X	There are no Plug records to display.	

Initial Test Data

Test Date	Formation	Oil BBL/Day	Oil-Gravity (API)	Gas MCF/Day	Gas-Oil Ratio Cu FT/BBL	Water BBL/Day	Pumpin or Flowing	Initial Shut- In Pressure	Choke Size	Flow Tubing Pressure
-----------	-----------	----------------	----------------------	----------------	----------------------------	------------------	----------------------	---------------------------------	---------------	-------------------------

There are no Initial Data records to display.

Completion and Test Data by Producing Formation

Formation Name: 1ST WILCOX

Code: 202WLCX1

Class: DISP

Spacing Orders

Order No	Unit Size
There are no Spacing Order records to display.	

Perforated Intervals

From	To
There are no Perf. Intervals records to display.	

Acid Volumes

YEAR 2006: 6,800 GALLONS 15% HCL & YEAR 2020: 4,000 GALLONS 18% HCL
--

Fracture Treatments

NONE

Formation Name: 2ND WILCOX

Code: 202WLCX2

Class: DISP

Spacing Orders

Order No	Unit Size
There are no Spacing Order records to display.	

Perforated Intervals

From	To
There are no Perf. Intervals records to display.	

Acid Volumes

ACIDIZED WITH 1ST WILCOX AND ARBUCKLE

Fracture Treatments

NONE

Formation Name: ARBUCKLE

Code: 169ABCK

Class: DISP

Spacing Orders

Order No	Unit Size
There are no Spacing Order records to display.	

Perforated Intervals

From	To
There are no Perf. Intervals records to display.	

Acid Volumes

ACIDIZED WITH 1ST & 2ND WICOX

Fracture Treatments

NONE

Formation	Top
WILCOX	6750
ARBUCKLE	7000

Were open hole logs run? No

Date last log run:

Were unusual drilling circumstances encountered? No

Explanation:

Other Remarks

FEBRUARY 26, 2020: LAID DOWN 7" 26# L-80 INJECTION STRING.
FEBRUARY 27, 2020: RIH WITH 4.5" 11.6# L-80 LTC INJECTION STRING, SET AT 6,612', PUMPED PACKER FLUID.
FEBRUARY 28, 2020: PUMPED 4,000 GALLONS 18% HCL WITH NEFE, FLUSHED WITH 100 BARRELS OF PRODUCED WATER.
OCC - THIS WELL IS AN OPEN HOLE COMPLETION IN ALL 3 ZONES, 1ST WILCOX, 2ND WILCOX, AND ARBUCKLE, FROM BOTTOM OF 9 5/8" CASING AT 7,060' TO TOTAL DEPTH AT 10,276'. UIC ORDER NUMBER 523986

Bottom Holes
Sec: 35 TWP: 26N RGE: 13W County: WOODS
NW NW SW SE
1222 FSL 2550 FEL of 1/4 SEC
Depth of Deviation: 0 Radius of Turn: 0 Direction: 0 Total Length: 0
Measured Total Depth: 10276 True Vertical Depth: 8490 End Pt. Location From Release, Unit or Property Line: 0

FOR COMMISSION USE ONLY
Status: Accepted
1145003

(PLEASE TYPE OR USE BLACK INK ONLY)

OKLAHOMA CORPORATION COMMISSION
Oil & Gas Conservation Division
Post Office Box 52000
Oklahoma City, Oklahoma 73152-2000
Rule 165:10-3-25

Form 1002A
Rev. 2009

<input type="checkbox"/>	ORIGINAL	
<input checked="" type="checkbox"/>	AMENDED (Reason)	Acid Work/Replace Injection String

COMPLETION REPORT

TYPE OF DRILLING OPERATION

<input type="checkbox"/>	STRAIGHT HOLE	<input checked="" type="checkbox"/>	DIRECTIONAL HOLE	<input type="checkbox"/>	HORIZONTAL HOLE
<input checked="" type="checkbox"/>	SERVICE WELL				

SPUD DATE	3/9/2006
DRLG FINISHED DATE	4/19/2006
DATE OF WELL COMPLETION	4/19/2006
1st PROD DATE	N/A
RECOMP DATE	N/A 2-
Longitude (if known)	-98.55775
COCC OPERATOR NO.	23079
00	
TX	ZIP 77002

LOCATE WELL

COUNTY	Woods	SEC	35	TWP	26N	RGE	13W	
LEASE NAME	Dacoma SWD						WELL NO.	1
SE 1/4	SE 1/4	SE 1/4	SE 1/4	FSL OF 1/4 SEC	318	FEL OF 1/4 SEC	228	
ELEVATION	Derrick FL		Ground	1384	Latitude (if known)		36.68140	
OPERATOR NAME	Amplify Oklahoma Operating LLC						C	
ADDRESS	500 Dallas Street, Suite 1							
CITY	Houston						STATE	

COMPLETION TYPE		
X	SINGLE ZONE	
	MULTIPLE ZONE Application Date	
	COMMINGLED Application Date	
LOCATION EXCEPTION		
ORDER NO.		
INCREASED DENSITY		
ORDER NO.		

CASING & CEMENT (Attach Form 1002C)							
TYPE	SIZE	WEIGHT	GRADE	FEET	PSI	SAX	TOP OF CMT
CONDUCTOR							
SURFACE	13 3/8	48#	J-55	505		430	surface
INTERMEDIATE	9 5/8	40#	N-80	7,060		450	5,970
PRODUCTION							
LINER							
PLUG @	TYPE	PLUG @	TYPE	TOTAL DEPTH		10,276	

PACKER @	6,668	BRAND & TYPE	9-5/8" AS1-X	PLUG @	TYPE	PLUG @	TYPE	TOTAL DEPTH	10,276
PACKER @		BRAND & TYPE		PLUG @	TYPE	PLUG @	TYPE		

COMPLETION & TEST DATA BY PRODUCING FORMATION		202WLCX1		202WLCX2		169ABCK	
FORMATION	1st Wilcox, 2nd Wilcox, Arbuckle						No Frac
SPACING & SPACING ORDER NUMBER	None						
CLASS: Oil, Gas, Dry, Inj, Disp, Comm Disp, Svc	Disp all zones						
	N/A						
PERFORATED INTERVALS	Open Hole all zones						
	-7000' -10,278'						
ACID/VOLUME	<u>2006</u> :6800 gal 15 % HCL	<u>2020</u> :4000 gallons 18% HCL	all zones				
FRACTURE TREATMENT (Fluids/Prop Amounts)	none						

INITIAL TEST DATA	<input type="checkbox"/>	Min Gas Allowable	(165:10-17-7)	Gas Purchaser/Measurer	N/A
		OR		First Sales Date	
		OH Allowable	(165:10-13-3)		

INITIAL TEST DATE	N/A Disposal Well					
OIL-BBL/DAY						
OIL-GRAVITY (API)						
GAS-MCF/DAY						
GAS-OIL RATIO CU FT/BBL						
WATER-BBL/DAY						
PUMPING OR FLOWING						
INITIAL SHUT-IN PRESSURE						
CHOKE SIZE						
FLOW TUBING PRESSURE						

A record of the formations drilled through, and pertinent remarks are presented on the reverse. I declare that I have knowledge of the contents of this report and am authorized by my organization to make this report, which was prepared by me or under my supervision and direction, with the data and facts stated herein to be true, correct, and complete to the best of my knowledge and belief.

 SIGNATURE		Rachel Milne NAME (PRINT OR TYPE)		3/26/2020 DATE	303-309-1656 PHONE NUMBER
500 Dallas Street Suite 1700 ADDRESS		Houston CITY	TX 77002 STATE ZIP	rachel.milne@amplifyenery.com EMAIL ADDRESS	

PLEASE TYPE OR USE BLACK INK ONLY
FORMATION RECORD

Give formation names and tops, if available, or descriptions and thickness of formations drilled through. Show intervals cored or drillstem tested.

NAMES OF FORMATIONS	TOP
Wilcox	6,750
Arbuckle	7,000

LEASE NAME Dacoma SWD WELL NO. 1

FOR COMMISSION USE ONLY	
ITD on file <input type="checkbox"/> YES <input type="checkbox"/> NO	
APPROVED _____	DISAPPROVED _____
2) Reject Codes	

Were open hole logs run?	yes <input type="checkbox"/> no <input checked="" type="checkbox"/>
Date Last log was run	N/A
Was CO ₂ encountered?	yes <input type="checkbox"/> no <input checked="" type="checkbox"/> at what depths? _____
Was H ₂ S encountered?	yes <input type="checkbox"/> no <input checked="" type="checkbox"/> at what depths? _____
Were unusual drilling circumstances encountered?	yes <input type="checkbox"/> no <input checked="" type="checkbox"/>
If yes, briefly explain below	

Other remarks: 2/26/2020: Laid down 7" 26# L-80 injection string
2/27/2020 RIH with 4.5" 11.6# L-80 LTC injection string, set at 6612', pumped packer fluid
2/28/2020: Pumped 4000 gallons 18% HCL with NEFE, flushed with 100 bbls of produced water
OCC- This well is an open hole completion in 3 zones 1st Wilcox 2nd Wilcox and Arbuckle from bottom of 9 5/8" casing at 7060' to total depth at 10,276". UIC order # 523986

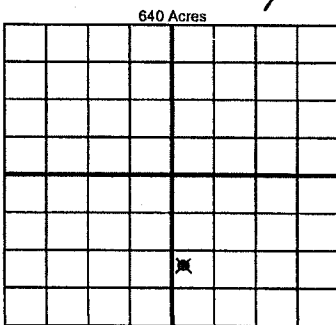

If more than three drainholes are proposed, attach a separate sheet indicating the necessary information.

Direction must be stated in degrees azimuth. Please note, the horizontal drainhole and its end point must be located within the boundaries of the lease or spacing unit.

Directional surveys are required for all drainholes and directional wells.

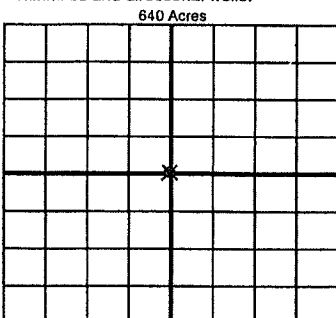

BOTTOM HOLE LOCATION FOR DIRECTIONAL HOLE

SEC 35	TWP 26N	RGE 13W	COUNTY Woods
Spot Location NW 1/4 NW 1/4 SW 1/4 SE 1/4		Feet From 1/4 Sec Lines	FSL 1222 FEL 2550
Measured Total Depth 10276		True Vertical Depth 8490	BHL From Lease, Unit, or Property Line: 1222

BOTTOM HOLE LOCATION FOR HORIZONTAL HOLE: (LATERALS)

LATERAL #1			
SEC	TWP	RGE	COUNTY
Spot Location 1/4 1/4 1/4 1/4		Feet From 1/4 Sec Lines	FSL FWL
Depth of Deviation		Radius of Turn	Direction Total Length
Measured Total Depth		True Vertical Depth	BHL From Lease, Unit, or Property Line:

LATERAL #2			
SEC	TWP	RGE	COUNTY
Spot Location 1/4 1/4 1/4 1/4		Feet From 1/4 Sec Lines	FSL FWL
Depth of Deviation		Radius of Turn	Direction Total Length
Measured Total Depth		True Vertical Depth	BHL From Lease, Unit, or Property Line:

LATERAL #3			
SEC	TWP	RGE	COUNTY
Spot Location 1/4 1/4 1/4 1/4		Feet From 1/4 Sec Lines	FSL FWL
Depth of Deviation		Radius of Turn	Direction Total Length
Measured Total Depth		True Vertical Depth	BHL From Lease, Unit, or Property Line: