

Oklahoma Corporation Commission
Oil & Gas Conservation Division
Post Office Box 52000
Oklahoma City, Oklahoma 73152-2000
Rule 165: 10-3-25

Form 1002A

API No.: 35109218220001

Completion Report

Spud Date: December 06, 1991

OTC Prod. Unit No.:

Drilling Finished Date: December 15, 1991

Amended

1st Prod Date:

Amend Reason: RE-CLASSIFY AS DISPOSAL WELL

Completion Date: January 15, 1992

Recomplete Date: September 20, 2018

Drill Type: STRAIGHT HOLE

SERVICE WELL

Well Name: WITCHER RED FORK UNIT 1-20

Purchaser/Measurer:

Location: OKLAHOMA 20 12N 2W
SW SE NE SW
1559 FSL 2073 FWL of 1/4 SEC
Derrick Elevation: 1223 Ground Elevation: 0

First Sales Date:

Operator: SHAMROCK WELL OPERATIONS LLC 24071

5661 N CLASSEN BLVD
OKLAHOMA CITY, OK 73118-4015

Completion Type		Location Exception		Increased Density	
	Single Zone	Order No		Order No	
	Multiple Zone	There are no Location Exception records to display.		There are no Increased Density records to display.	
	Commingled				

Casing and Cement							
Type	Size	Weight	Grade	Feet	PSI	SAX	Top of CMT
SURFACE	8.625	24	J-55	535		535	SURFACE
PRODUCTION	5.5	15.5	J-55	5438		560	3335

Liner								
Type	Size	Weight	Grade	Length	PSI	SAX	Top Depth	Bottom Depth
There are no Liner records to display.								

Total Depth: 5440

Packer		Plug	
Depth	Brand & Type	Depth	Plug Type
3660	TENSION	There are no Plug records to display.	

Initial Test Data

Test Date	Formation	Oil BBL/Day	Oil-Gravity (API)	Gas MCF/Day	Gas-Oil Ratio Cu FT/BBL	Water BBL/Day	Pumpin or Flowing	Initial Shut- In Pressure	Choke Size	Flow Tubing Pressure
-----------	-----------	----------------	----------------------	----------------	----------------------------	------------------	----------------------	---------------------------------	---------------	-------------------------

There are no Initial Data records to display.

Completion and Test Data by Producing Formation

Formation Name: VIRGILIAN

Code: 406VRGN

Class: DISP

Spacing Orders

Order No

Unit Size

There are no Spacing Order records to display.

Perforated Intervals

From

To

3710

3784

Acid Volumes

NONE

Fracture Treatments

NONE

Formation Name: COTTAGE GROVE

Code: 405CGGV

Class: DISP

Spacing Orders

Order No

Unit Size

There are no Spacing Order records to display.

Perforated Intervals

From

To

5170

5180

Acid Volumes

NONE

Fracture Treatments

NONE

Formation	Top
VIRGILIAN SAND ZONE	3554
COTTAGE GROVE SAND ZONE	5157

Were open hole logs run? Yes

Date last log run: December 16, 1991

Were unusual drilling circumstances encountered? No

Explanation:

Other Remarks

WITCHER RED FORK UNIT 1-20 WAS A WATER SUPPLY SERIVCE WELL FOR THE WITCHER RED FORK UNIT. IN SEPTEMBER, 2018 WE PERMITTED THE WELL FOR USE AS A SALTWATER DISPOSAL WELL. PERMIT NUMBER 1901060035

FOR COMMISSION USE ONLY

1145004

Status: Accepted

109-21822
OTC PROD. Service
UNIT NO.

(PLEASE TYPE OR USE BLACK INK ONLY)

OKLAHOMA CORPORATION COMMISSION
Oil & Gas Conservation Division
Post Office Box 52000
Oklahoma City, Oklahoma 73152-2000
Rule 165:10-3-25

Form 1002A
Rev. 2009

☐ ORIGINAL
☒ AMENDED (Reason) Re-Classify as Disposal Well

COMPLETION REPORT

TYPE OF DRILLING OPERATION
☒ STRAIGHT HOLE ☐ DIRECTIONAL HOLE ☐ HORIZONTAL HOLE
☒ SERVICE WELL
If directional or horizontal, see reverse for bottom hole location.

SPUD DATE 12/6/91
DRLG FINISHED DATE 12/15/91
DATE OF WELL COMPLETION 1/15/92
1st PROD DATE Service Well
RECOMP DATE 5/18-9-20-2018
WELL NO. 1-20
FSL OF 1/4 SEC 1559
FWL OF 1/4 SEC 2073
Longitude (if known)
Latitude (if known)
OTC / OCC OPERATOR NO. 24071

COUNTY Oklahoma SEC 20 TWP 12n RGE 2w
LEASE NAME Witcher Redfork Unit
SE 1/4 NE 1/4 SW 1/4
ELEVATION 1223 Ground
OPERATOR NAME Shamrock Well Operations LLC
ADDRESS 5661 N. Classen Blvd.
CITY Oklahoma City STATE OK ZIP 73118

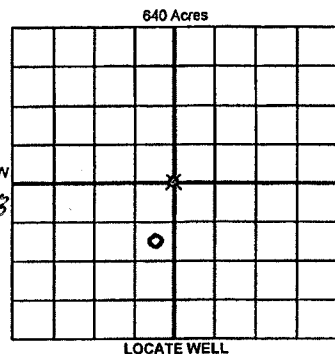

COMPLETION TYPE
☐ SINGLE ZONE
☐ MULTIPLE ZONE
Application Date
☐ COMMINGLED
Application Date
LOCATION EXCEPTION ORDER NO.
INCREASED DENSITY ORDER NO.

TYPE	SIZE	WEIGHT	GRADE	FEET	PSI	SAX	TOP OF CMT
CONDUCTOR							
SURFACE	8.625"	24#	J-55	535		535	Surface
INTERMEDIATE							
PRODUCTION	5.5"	15.5#	J-55	5438		560	3335
LINER							
TOTAL DEPTH							5,440

PACKER @ 3,660 BRAND & TYPE Tension PLUG @ 406 VRGN TYPE 405 CG6V PLUG @ TYPE
PACKER @ BRAND & TYPE PLUG @ TYPE PLUG @ TYPE

COMPLETION & TEST DATA BY PRODUCING FORMATION

FORMATION	Virgillian	Cottage Grove				No Frac
SPACING & SPACING						
ORDER NUMBER						
CLASS: Oil, Gas, Dry, Inj, Disp, Comm Disp, Svc	Disposal	Disposal				
	3710-84	5170-80				
PERFORATED INTERVALS						
ACID/VOLUME	none	none				
FRACTURE TREATMENT (Fluids/Prop Amounts)	none	none				

Min Gas Allowable (165:10-17-7) Gas Purchaser/Measurer
OR First Sales Date
Oil Allowable (165:10-13-3)

INITIAL TEST DATA

INITIAL TEST DATE	9/20/2018	9/20/2018				
OIL-BBL/DAY	Disposal	Disposal				
OIL-GRAVITY (API)						
GAS-MCF/DAY						
GAS-OIL RATIO CU FT/BBL						
WATER-BBL/DAY						
PUMPING OR FLOWING						
INITIAL SHUT-IN PRESSURE						
CHOKE SIZE						
FLOW TUBING PRESSURE						

A record of the formations drilled through, and pertinent remarks are presented on the reverse. I declare that I have knowledge of the contents of this report and am authorized by my organization to make this report, which was prepared by me or under my supervision and direction, with the data and facts stated herein to be true, correct, and complete to the best of my knowledge and belief.

SIGNATURE John Shields DATE 3/27/2020 PHONE NUMBER 405-664-6789
NAME (PRINT OR TYPE)

5661 N. Classen Blvd. Oklahoma City OK 73118 jshields@shieldsfs.com
ADDRESS CITY STATE ZIP EMAIL ADDRESS

PLEASE TYPE OR USE BLACK INK ONLY

FORMATION RECORD

Give formation names and tops, if available, or descriptions and thickness of formations drilled through. Show intervals cored or drillstem tested.

LEASE NAME _____

WELL NO. _____

NAMES OF FORMATIONS	TOP
Virgilian Sand Zone	3,554
Cottage Grove Sand Zone	5,157

FOR COMMISSION USE ONLY

ITD on file ☐ YES ☐ NO

APPROVED _____ DISAPPROVED _____

2) Reject Codes _____

Were open hole logs run? ☒ yes ☐ no

Date Last log was run 12/16/1991

Was CO₂ encountered? ☐ yes ☒ no at what depths? _____

Was H₂S encountered? ☐ yes ☒ no at what depths? _____

Were unusual drilling circumstances encountered? ☐ yes ☒ no

If yes, briefly explain below _____

Other remarks: WRFU #1-20 was a water supply service well for the Witcher Redfork Unit. In September, 2018 we permitted the well for use as saltwater disposal well. Permit # 1901060035

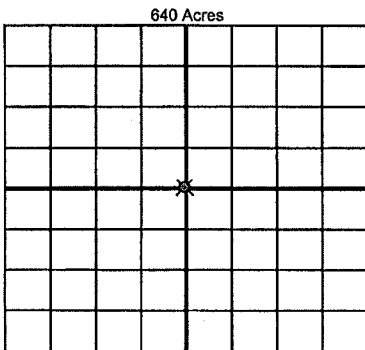

If more than three drainholes are proposed, attach a separate sheet indicating the necessary information.

Direction must be stated in degrees azimuth. Please note, the horizontal drainhole and its end point must be located within the boundaries of the lease or spacing unit.

Directional surveys are required for all drainholes and directional wells.

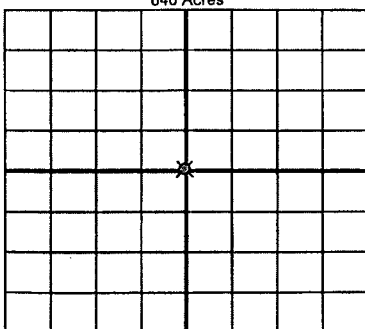

BOTTOM HOLE LOCATION FOR DIRECTIONAL HOLE

SEC	TWP	RGE	COUNTY
Spot Location			
1/4	1/4	1/4	1/4
Measured Total Depth		True Vertical Depth	BHL From Lease, Unit, or Property Line:

BOTTOM HOLE LOCATION FOR HORIZONTAL HOLE: (LATERALS)

LATERAL #1

SEC	TWP	RGE	COUNTY
Spot Location			
1/4	1/4	1/4	1/4
Depth of Deviation		Radius of Turn	Direction
Measured Total Depth		True Vertical Depth	BHL From Lease, Unit, or Property Line:

LATERAL #2

SEC	TWP	RGE	COUNTY
Spot Location			
1/4	1/4	1/4	1/4
Depth of Deviation		Radius of Turn	Direction
Measured Total Depth		True Vertical Depth	BHL From Lease, Unit, or Property Line:

LATERAL #3

SEC	TWP	RGE	COUNTY
Spot Location			
1/4	1/4	1/4	1/4
Depth of Deviation		Radius of Turn	Direction
Measured Total Depth		True Vertical Depth	BHL From Lease, Unit, or Property Line: