

Oklahoma Corporation Commission
Oil & Gas Conservation Division
Post Office Box 52000
Oklahoma City, Oklahoma 73152-2000
Rule 165: 10-3-25

Form 1002A

API No.: 35073267520000

Completion Report

Spud Date: May 29, 2021

OTC Prod. Unit No.:

Drilling Finished Date: June 06, 2021

1st Prod Date:

Completion Date: June 06, 2021

Drill Type: HORIZONTAL HOLE

Well Name: EAST HENNESSEY UNIT 265H

Purchaser/Measurer:

Location: KINGFISHER 8 19N 6W
NE NE NW NW
185 FNL 1266 FWL of 1/4 SEC
Latitude: 36.145096 Longitude: -97.86749
Derrick Elevation: 0 Ground Elevation: 1141

First Sales Date:

Operator: HINKLE OIL & GAS INC 21639

5600 N MAY AVE STE 295
OKLAHOMA CITY, OK 73112-4275

Completion Type		Location Exception		Increased Density	
	Single Zone	Order No		Order No	
	Multiple Zone	There are no Location Exception records to display.		There are no Increased Density records to display.	
	Commingled				

Casing and Cement							
Type	Size	Weight	Grade	Feet	PSI	SAX	Top of CMT
SURFACE	20			80			SURFACE
SURFACE	9 5/8	36	LTC	354		135	SURFACE
PRODUCTION	7	26	P-110	6595		230	4273

Liner								
Type	Size	Weight	Grade	Length	PSI	SAX	Top Depth	Bottom Depth
There are no Liner records to display.								

Total Depth: 7258

Packer	
Depth	Brand & Type
There are no Packer records to display.	

Plug	
Depth	Plug Type
There are no Plug records to display.	

Initial Test Data

Test Date	Formation	Oil BBL/Day	Oil-Gravity (API)	Gas MCF/Day	Gas-Oil Ratio Cu FT/BBL	Water BBL/Day	Pumpin or Flowing	Initial Shut-In Pressure	Choke Size	Flow Tubing Pressure
There are no Initial Data records to display.										
Completion and Test Data by Producing Formation										
<div> <div>Formation Name: NONE</div> <div>Code:</div> <div>Class: DRY</div> </div>										
<div> <div> <div>Formation</div> <div>Top</div> </div> <div> <div>Were open hole logs run? No</div> <div>Date last log run:</div> <div>Were unusual drilling circumstances encountered? Yes</div> <div>Explanation: WELL HAD DOWNHOLE PROBLEMS (STUCK PIPE). WILL BE PLUGGED AND ABANDONED.</div> </div> </div>										
Other Remarks										
There are no Other Remarks.										
Lateral Holes										
Sec: 8 TWP: 19N RGE: 6W County: KINGFISHER NW NW NW NW 34 FNL 297 FWL of 1/4 SEC Depth of Deviation: 6728 Radius of Turn: 530 Direction: 180 Total Length: 0 Measured Total Depth: 7258 True Vertical Depth: 7095 End Pt. Location From Release, Unit or Property Line: 34										
FOR COMMISSION USE ONLY										
<div>Status: Accepted</div> <div>1146781</div>										

API NO. 35-073-26752
OTC PROD.
UNIT NO.

Oil and Gas Conservation Division
P.O. Box 52000
Oklahoma City, OK 73152-2000
405-521-2331
OCCCentralProcessing@OCC.OK.GOV



OKLAHOMA
Corporation
Commission

Form 1002A
Rev. 2020

ORIGINAL
AMENDED (Reason)

Rule 165:10-3-25

COMPLETION REPORT

TYPE OF DRILLING OPERATION

☐ STRAIGHT HOLE ☐ DIRECTIONAL HOLE ☒ HORIZONTAL HOLE
☐ SERVICE WELL

If directional or horizontal, see reverse for bottom hole location.

COUNTY	Kingfisher	SEC	08	TWP	19N	RGE	06W	SPUD DATE	05/29/2021
LEASE NAME	East Hennessey Unit	WELL NO.	265H	DRLG FINISHED DATE	06/06/2021	DATE OF WELL COMPLETION			6/6/21
NE 1/4 NE 1/4 NW 1/4 NW 1/4	185'	1266'	RECOMP DATE						
ELEVATION	Ground	1141'	Latitude	36.145096	Longitude	-97.867490	1st PROD DATE		
OPERATOR NAME	Hinkle Oil & Gas, Inc.	OTC / OCC OPERATOR NO.	21639						
ADDRESS	5600 N. May Avenue, Suite 295								
CITY	Oklahoma City	STATE	OK	ZIP	73112				

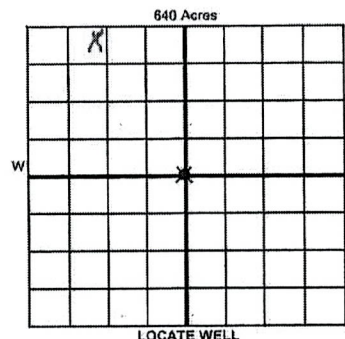

COMPLETION TYPE

<input type="radio"/> SINGLE ZONE	
<input type="radio"/> MULTIPLE ZONE	
<input type="radio"/> COMMINGLED	
LOCATION EXCEPTION ORDER NO.	
MULTIUNIT ORDER NO.	
INCREASED DENSITY ORDER NO.	

CASING & CEMENT (Attach Form 1002C)

TYPE	SIZE	WEIGHT	GRADE	FEET	PSI	SAX	TOP OF CMT
CONDUCTOR	20"			80'			Surface
SURFACE	9 5/8"	36#	LTC	354'		135	Surface
INTERMEDIATE							
PRODUCTION	7"	26#	P110	6595'		230	4273'
LINER							

PACKER @ BRAND & TYPE PLUG @ TYPE PLUG @ TYPE TOTAL DEPTH 7258'

COMPLETION & TEST DATA BY PRODUCING FORMATION

FORMATION	Mississippi Solid					
SPACING & SPACING ORDER NUMBER	61709					
CLASS: Oil, Gas, Dry, Inj, Disp, Comm Disp, Svc	Dry					
PERFORATED INTERVALS						
ACID/VOLUME						
FRACTURE TREATMENT (Fluids/Prop Amounts)						

RECEIVED

AUG 09 2021

OKLAHOMA CORPORATION
COMMISSION

Min Gas Allowable (165:10-17-7)

Purchaser/Measurer



OR

First Sales Date

Oil Allowable (165:10-13-3)

INITIAL TEST DATA

INITIAL TEST DATE						
OIL-BBL/DAY						
OIL-GRAVITY (API)						
GAS-MCF/DAY						
GAS-OIL RATIO CU FT/BBL						
WATER-BBL/DAY						
PUMPING OR FLOWING						
INITIAL SHUT-IN PRESSURE						
CHOKE SIZE						
FLOW TUBING PRESSURE						

A record of the formations drilled through, and pertinent remarks are presented on the reverse. I declare that I have knowledge of the contents of this report and am authorized by my organization to make this report, which was prepared by me or under my supervision and direction, with the data and facts stated herein to be true, correct, and complete to the best of my knowledge and belief.

B. Hinkle
SIGNATURE

Bruce A. Hinkle
NAME (PRINT OR TYPE)

08/06/2021 405-848-0924
DATE PHONE NUMBER

5600 N. May Avenue, Suite 295 Oklahoma City OK 73112
ADDRESS CITY STATE ZIP

Laurahinkle@hoagi.com
EMAIL ADDRESS

FORMATION RECORD

WELL NO. 265H

NAMES OF FORMATIONS	TOP

FOR COMMISSION USE ONLY	
ITD on file	<input type="checkbox"/> YES <input type="checkbox"/> NO
APPROVED	DISAPPROVED
2) Reject Codes	

Were open hole logs run? ☐ yes ☒ no

Date Last log was run _____

Was CO₂ encountered? ☐ yes ☒ no at what depths? _____

Was H₂S encountered? ☐ yes ☒ no at what depths? _____

Were unusual drilling circumstances encountered? ☒ yes ☐ no

If yes, briefly explain below _____

Other remarks: Well had downhole problems (Stuck Pipe). Will be P&A'd.

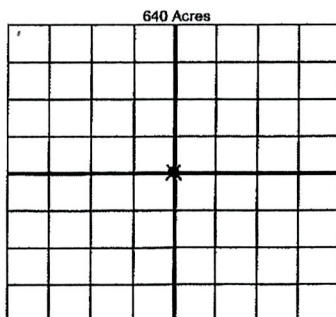

Directional surveys are required for all drainholes and directional wells

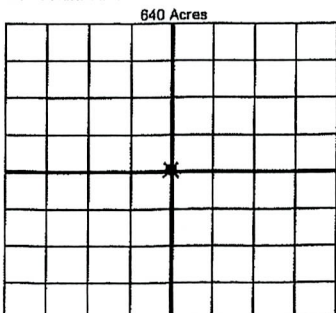

SEC	TWP	RGE	COUNTY			
1/4			1/4	1/4	1/4	Feet From 1/4 Sec Lines
Measured Total Depth		True Vertical Depth		BHL From Lease, Unit, or Property Line:		

LATERAL #1											
SEC	B		TWP	19N		RGE	6W		COUNTY	Kingfisher	
NW			1/4	NW		1/4	NW		1/4	Feet From 1/4 Sec Lines	
Depth of Deviation			6728		Radius of Turn			530		Direction	180
Measured Total Depth			7258		True Vertical Depth			7095		Total Length	0
										BHL From Lease, Unit, or Property Line:	34

SEC	TWP	RGE	COUNTY
1/4		1/4	1/4
Feet From 1/4 Sec Lines			
Depth of Deviation	Radius of Turn	Direction	Total Length
Measured Total Depth	True Vertical Depth	BHL From Lease, Unit, or Property Line:	

EXTERNAL #									
SEC		TWP		RGE		COUNTY			
1/4		1/4		1/4		1/4		Feet From 1/4 Sec Lines	
Depth of Deviation		Radius of Turn		Direction		Total Length			
Measured Total Depth		True Vertical Depth		BHL From Lease, Unit, or Property Line:					