

Oklahoma Corporation Commission
Oil & Gas Conservation Division
Post Office Box 52000
Oklahoma City, Oklahoma 73152-2000
Rule 165: 10-3-25

Form 1002A

API No.: 35133228510001

Completion Report

Spud Date: September 06, 1984

OTC Prod. Unit No.:

Drilling Finished Date: September 15, 1984

Amended

1st Prod Date:

Amend Reason: WELL REPAIRS - RAN NEW 5 1/2" CASING

Completion Date: October 01, 1984

Recomplete Date: August 29, 2019

Drill Type: STRAIGHT HOLE

SERVICE WELL

Well Name: MARSHALL 1-A

Purchaser/Measurer:

Location: SEMINOLE 36 8N 6E
NW SE NW NW
1815 FSL 825 FWL of 1/4 SEC
Latitude: 35.128052 Longitude: -96.632025
Derrick Elevation: 926 Ground Elevation: 916

First Sales Date:

Operator: LAPETCO INC 12358

2745 DALLAS PKWY STE 455
PLANO, TX 75093-8749

Completion Type		Location Exception		Increased Density	
X	Single Zone	Order No		Order No	
	Multiple Zone	There are no Location Exception records to display.		There are no Increased Density records to display.	
	Commingled				

Casing and Cement							
Type	Size	Weight	Grade	Feet	PSI	SAX	Top of CMT
SURFACE	10 3/4	40.5	J-55	122	1000	125	SURFACE
PRODUCTION	7	17	J-55	4357	3000	80	3500

Liner								
Type	Size	Weight	Grade	Length	PSI	SAX	Top Depth	Bottom Depth
LINER	5 1/2	17	J-55	0	0	220	SURFACE	4198

Total Depth: 4400

Packer		Plug	
Depth	Brand & Type	Depth	Plug Type
4180	ARROW TENSION	There are no Plug records to display.	

Initial Test Data

Test Date	Formation	Oil BBL/Day	Oil-Gravity (API)	Gas MCF/Day	Gas-Oil Ratio Cu FT/BBL	Water BBL/Day	Pumpin or Flowing	Initial Shut- In Pressure	Choke Size	Flow Tubing Pressure
-----------	-----------	----------------	----------------------	----------------	----------------------------	------------------	----------------------	---------------------------------	---------------	-------------------------

There are no Initial Data records to display.

Completion and Test Data by Producing Formation

Formation Name: 1ST WILCOX Code: 202WLCX1 Class: DISP

Spacing Orders		Perforated Intervals	
Order No	Unit Size	From	To
There are no Spacing Order records to display.		4224	4234
Acid Volumes		Fracture Treatments	
500 GALLONS		NONE	

Formation	Top
CROMWELL SAND	3230
VIOLA LIMESTONE	4090
SIMPSON	4176
1ST WILCOX	4210

Were open hole logs run? Yes
Date last log run: September 15, 1984

Were unusual drilling circumstances encountered? No
Explanation:

Other Remarks
WELL REPAIRS FOR MIT. RAN 101 JTS 5.5 CASING TO 4,198'. CEMENTED TO SURFACE. RAN 4,180' 2 3/8 TUBING AND SET PACKER. TESTED WELL WITH OCC. WELL PASSED MIT SEPTEMBER 3, 2019. ORDER NUMBER 375179. OCC - A D-V TOOL WAS SET IN THE 7" CASING AT 1009' AND 280 SACKS OF CEMENT WAS USED TO LIFT CEMENT TO SURFACE.

FOR COMMISSION USE ONLY

1143791

Status: Accepted

API NO. 13322851
OTC PROD. N/A
UNIT NO.

(PLEASE TYPE OR USE BLACK INK ONLY)

OKLAHOMA CORPORATION COMMISSION
Oil & Gas Conservation Division
Post Office Box 52000
Oklahoma City, Oklahoma 73152-2000
Rule 165:10-3-25

RECEIVED

Form 1002A
Rev. 2009

SEP 09 2019

OKLAHOMA CORPORATION COMMISSION

ORIGINAL
XX AMENDED (Reason) Well Repairs - Ran new 5 1/2 Csg.

COMPLETION REPORT

TYPE OF DRILLING OPERATION
XX STRAIGHT HOLE ☐ DIRECTIONAL HOLE ☐ HORIZONTAL HOLE
X SERVICE WELL

If directional or horizontal, see reverse for bottom hole location.

COUNTY	Seminole	SEC	36	TWP	8N	RGE	6E	SPUD DATE	9/6/1984
LEASE NAME	Marshall	WELL NO.	1A	DRLG FINISHED DATE	9/15/1984	DATE OF WELL COMPLETION	10/1/1984	1st PROD DATE	N/A
NW 1/4 SE 1/4 NW 1/4 NW 1/4	FSL OF 1/4 SEC	1815	FWL OF 1/4 SEC	825	RECOMP DATE	8-29-2019	Date w/ Liner Set		
ELEVATION Derrick FL	926	Ground	916	Latitude (if known)	35.128052	Longitude (if known)	-96.632025		
OPERATOR NAME	Lapetco, Inc.	OTC / OCC OPERATOR NO.	12358-0						
ADDRESS	2745 Dallas Parkway, Suite 455								
CITY	Plano	STATE	TX	ZIP	75093				

LOCATE WELL

COMPLETION TYPE

XX SINGLE ZONE	
MULTIPLE ZONE	
Application Date	
COMMINGLED	
Application Date	
LOCATION EXCEPTION ORDER NO.	
INCREASED DENSITY ORDER NO.	

CASING & CEMENT (Attach Form 1002C)

TYPE	SIZE	WEIGHT	GRADE	FEET	PSI	SAX	TOP OF CMT
CONDUCTOR	None						
SURFACE	10 3/4	40.5	J-55	122	1000	125	Surface
INTERMEDIATE		DV Tool	in 7"	1,009		280	Surface
PRODUCTION	7"	17#	J-55	4357	3000	80	3500'
LINER	5 1/2	17#	J-55	surface 4198		220	Surface
TOTAL DEPTH							4400'

PACKER @ 4,180 BRAND & TYPE Arrow Tension PLUG @ TYPE PLUG @ TYPE
PACKER @ BRAND & TYPE PLUG @ TYPE PLUG @ TYPE

COMPLETION & TEST DATA BY PRODUCING FORMATION

FORMATION	1st Wilcox Sand						No Frac
SPACING & SPACING ORDER NUMBER	375179 see remarks						
CLASS: Oil, Gas, Dry, Inj, Disp, Comm Disp, Svc	Noncommercial Disposal						
PERFORATED INTERVALS	4224' - 4234'						
ACID/VOLUME	500 gal						
FRACTURE TREATMENT (Fluids/Prop Amounts)	None						

Min Gas Allowable (165:10-17-7) Gas Purchaser/Measurer
OR
Oil Allowable (165:10-13-3) First Sales Date

INITIAL TEST DATA

INITIAL TEST DATE	10/1/1984					
OIL-BBL/DAY	N/A					
OIL-GRAVITY (API)	N/A					
GAS-MCF/DAY	N/A					
GAS-OIL RATIO CU FT/BBL	N/A					
WATER-BBL/DAY	N/A					
PUMPING OR FLOWING	N/A					
INITIAL SHUT-IN PRESSURE	N/A					
CHOKE SIZE	N/A					
FLOW TUBING PRESSURE	N/A					

AS SUBMITTED

A record of the formations drilled through, and pertinent remarks are presented on the reverse. I declare that I have knowledge of the contents of this report and am authorized by my organization to make this report, which was prepared by me or under my supervision and direction, with the data and facts stated herein to be true, correct, and complete to the best of my knowledge and belief.

SIGNATURE	Danny W. Looney	DATE	9/3/2019	PHONE NUMBER	214-526-6644
ADDRESS	2745 Dallas Parkway - Suite 455	CITY	Plano	STATE	TX
		ZIP	75093	EMAIL ADDRESS	dlooney@dannylooney.net

PLEASE TYPE OR USE BLACK INK ONLY
FORMATION RECORD

Give formation names and tops, if available, or descriptions and thickness of formations drilled through. Show intervals cored or drillstem tested.

NAMES OF FORMATIONS	TOP
Cromwell Sand	3,230
Viola Limestone	4,090
Simpson	4176
1st Wilcox	4,210

LEASE NAME _____ WELL NO. _____

FOR COMMISSION USE ONLY	
ITD on file	<input type="checkbox"/> YES <input type="checkbox"/> NO
APPROVED	DISAPPROVED
2) Reject Codes	

Were open hole logs run?	<input checked="" type="checkbox"/> yes <input type="checkbox"/> no
Date Last log was run	9/15/1984
Was CO ₂ encountered?	<input type="checkbox"/> yes <input checked="" type="checkbox"/> no at what depths? _____
Was H ₂ S encountered?	<input type="checkbox"/> yes <input checked="" type="checkbox"/> no at what depths? _____
Were unusual drilling circumstances encountered?	<input type="checkbox"/> yes <input checked="" type="checkbox"/> no
If yes, briefly explain below	

Other remarks: Well repairs for MIT. Ran 101 Jts 5.5 casing to 4198. Cemented to surface. Ran 4180' 2 3/8 tubing and set packer.

Tested well with OCC. Well Passed MIT 9/3/2019. **ORDER 375179**

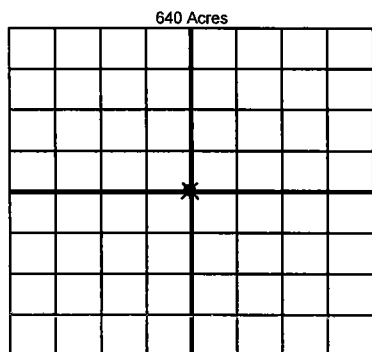

If more than three drainholes are proposed, attach a separate sheet indicating the necessary information.

Direction must be stated in degrees azimuth. Please note, the horizontal drainhole and its end point must be located within the boundaries of the lease or spacing unit.

Directional surveys are required for all drainholes and directional wells.

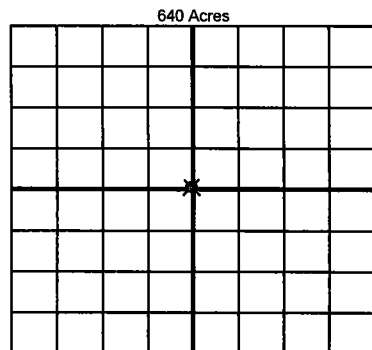

BOTTOM HOLE LOCATION FOR DIRECTIONAL HOLE

SEC	TWP	RGE	COUNTY
Spot Location		Feet From 1/4 Sec Lines	
1/4	1/4	1/4	1/4
Measured Total Depth		True Vertical Depth	
		BHL From Lease, Unit, or Property Line:	

BOTTOM HOLE LOCATION FOR HORIZONTAL HOLE: (LATERALS)

LATERAL #1			
SEC	TWP	RGE	COUNTY
Spot Location		Feet From 1/4 Sec Lines	
1/4	1/4	1/4	1/4
Depth of Deviation		Radius of Turn	Direction
Measured Total Depth		True Vertical Depth	Total Length
		BHL From Lease, Unit, or Property Line:	

LATERAL #2			
SEC	TWP	RGE	COUNTY
Spot Location		Feet From 1/4 Sec Lines	
1/4	1/4	1/4	1/4
Depth of Deviation		Radius of Turn	Direction
Measured Total Depth		True Vertical Depth	Total Length
		BHL From Lease, Unit, or Property Line:	

LATERAL #3			
SEC	TWP	RGE	COUNTY
Spot Location		Feet From 1/4 Sec Lines	
1/4	1/4	1/4	1/4
Depth of Deviation		Radius of Turn	Direction
Measured Total Depth		True Vertical Depth	Total Length
		BHL From Lease, Unit, or Property Line:	