

Oklahoma Corporation Commission
Oil & Gas Conservation Division
Post Office Box 52000
Oklahoma City, Oklahoma 73152-2000
Rule 165: 10-3-25

Form 1002A

API No.: 35019253410001

Completion Report

Spud Date: January 20, 2010

OTC Prod. Unit No.: 019-204190

Drilling Finished Date: February 16, 2010

Amended

1st Prod Date: June 25, 2010

Amend Reason: SET CIBP @ 6,800' AND PERFORATE TUSSY

Completion Date: June 25, 2010

Recomplete Date: February 28, 2018

Drill Type: STRAIGHT HOLE

Well Name: PINK RIPPLE 1-24

Purchaser/Measurer: TARGA PIPELINE

Location: CARTER 24 3S 3W
C N2 SE NE
990 FSL 1980 FWL of 1/4 SEC
Latitude: 34.284528 Longitude: -97.459556
Derrick Elevation: 993 Ground Elevation: 980

First Sales Date: 06/24/2010

Operator: CHARTER OAK PRODUCTION CO LLC 21672

13929 QUAIL POINTE DR
OKLAHOMA CITY, OK 73134-1037

Completion Type		Location Exception		Increased Density	
X	Single Zone	Order No		Order No	
	Multiple Zone	181221		There are no Increased Density records to display.	
	Commingled				

Casing and Cement							
Type	Size	Weight	Grade	Feet	PSI	SAX	Top of CMT
CONDUCTOR	16			50			SURFACE
SURFACE	9 5/8	36 & 40	J-55	1166		375	SURFACE
PRODUCTION	5 1/2	17	N-80	10498		1150	5830

Liner								
Type	Size	Weight	Grade	Length	PSI	SAX	Top Depth	Bottom Depth
There are no Liner records to display.								

Total Depth: 10500

Packer		Plug	
Depth	Brand & Type	Depth	Plug Type
There are no Packer records to display.		6800	CIBP

Initial Test Data

Test Date	Formation	Oil BBL/Day	Oil-Gravity (API)	Gas MCF/Day	Gas-Oil Ratio Cu FT/BBL	Water BBL/Day	Pumpin or Flowing	Initial Shut- In Pressure	Choke Size	Flow Tubing Pressure
Feb 28, 2018	TUSSY	12		13	1083	90	PUMPING	3290		

Completion and Test Data by Producing Formation

Formation Name: TUSSY

Code: 404TSSY

Class: OIL

Spacing Orders

Order No

Unit Size

There are no Spacing Order records to display.

Perforated Intervals

From

To

There are no Perf. Intervals records to display.

Acid Volumes

There are no Acid Volume records to display.

Fracture Treatments

2,457 BW, 98,200 POUNDS 20/40 SAND

Formation	Top
TUSSY	5901
SYCAMORE	7715
WOODFORD	8075
HUNTON	8608
SYLVAN	9216
VIOLA	9660

Were open hole logs run? Yes

Date last log run: February 17, 2010

Were unusual drilling circumstances encountered? No

Explanation:

Other Remarks

SEE ORIGINAL 1002A FOR INITIAL COMPLETION AND TEST DATA BY PRODUCING FORMATION.

FOR COMMISSION USE ONLY

Status: Accepted

1139058

RECEIVED

Form 1002A
Rev. 2009

MAR 16 2018

OKLAHOMA CORPORATION
COMMISSION

API NO. 35-019-25341
OTC PROD. UNIT NO. 019-204190

PLEASE TYPE OR USE BLACK INK ONLY
NOTE:

Attach copy of original 1002A
if recompletion or reentry.

OKLAHOMA CORPORATION COMMISSION
Oil & Gas Conservation Division
Post Office Box 52000
Oklahoma City, Oklahoma 73152-2000
Rule 165:10-3-25

☐ ORIGINAL
☒ AMENDED (Reason) Set CIBP @ 6800' & perforate Tussy

COMPLETION REPORT

TYPE OF DRILLING OPERATION

☒ STRAIGHT HOLE ☐ DIRECTIONAL HOLE ☐ HORIZONTAL HOLE
☐ SERVICE WELL

If directional or horizontal, see reverse for bottom hole location.

COUNTY	Carter	SEC 24	TWP 03S	RGE 03W	SPUD DATE	1/20/10
LEASE NAME	Pink Ripple			WELL NO.	1-24	DATE OF WELL COMPLETION
C 1/4 N2 1/4 SE 1/4 NE 1/4	FSL OF 1/4 SEC	990'	FWL OF 1/4 SEC	1980'	1st PROD DATE	6/25/10
ELEVATIO N Derrick	993'	Ground	980'	Latitude (if known)	34.284528	Longitude (if known)
OPERATOR NAME	Charter Oak Production Co., LLC			OTC/OCC OPERATOR NO.	21672	
ADDRESS	13929 Quail Pointe Dr.					
CITY	Oklahoma City	STATE	OK	ZIP	73134	

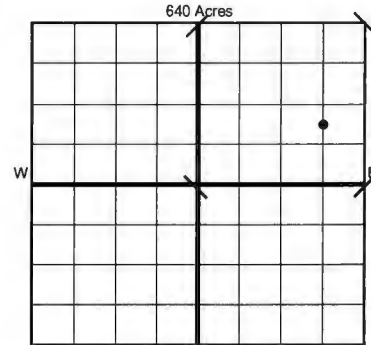

COMPLETION TYPE

☒ SINGLE ZONE
☐ MULTIPLE ZONE
Application Date
☐ COMMINGLED
Application Date
LOCATION
EXCEPTION ORDER
INCREASED DENSITY
ORDER NO.

CASING & CEMENT (Form 1002C must be attached)

TYPE	SIZE	WEIGHT	GRADE	FEET	PSI	SAX	TOP OF CMT
CONDUCTOR	16"			50'			Surface
SURFACE	9 5/8"	36# & 40#	J-55	1166'		375	Surface
INTERMEDIATE							
PRODUCTION	5 1/2"	17#	N-80	10498'		1150	5830'
LINER							
				TOTAL DEPTH	10500'		

PACKER @ _____ BRAND & TYPE _____ PLUG @ 6800' TYPE CBP PLUG @ _____ TYPE _____
PACKER @ _____ BRAND & TYPE _____ PLUG @ _____ TYPE _____ PLUG @ _____ TYPE _____

COMPLETION & TEST DATA BY PRODUCING FORMATION

FORMATION	Viola & Hunton	Tussy				
SPACING & SPACING ORDER NUMBER	160 Ac. - 181221	160 Ac. - 181221				
CLASS: Oil, Gas, Dry, Inj, Disp, Comm Disp, Svc	Oil	Oil				
PERFORATED INTERVALS	8629' - 10392' O.A.	6208' - 6218'				
	See original 1002A for individual formation test data.					
ACID/VOLUME	N/A	2000 Gal 15% acid				
FRACTURE TREATMENT (Fluids/Prop Amounts)	N/A	2457 BW				
		98,200# 20/40 sand				

Min Gas Allowable (165:10-17-7)

Gas Purchaser/Measurer

Targa Pipeline

OR

First Sales Date

6/24/10

INITIAL TEST DATA

INITIAL TEST DATE	6/25/10	2/28/18			
OIL-BBL/DAY	4	12			
OIL-GRAVITY (API)	39.0				
GAS-MCF/DAY	56	13			
GAS-OIL RATIO CU FT/BBL	14000	1083			
WATER-BBL/DAY	199	90			
PUMPING OR FLOWING	Pumping	Pumping			
INITIAL SHUT-IN PRESSURE	N/A	3290 psi			
CHOKE SIZE	N/A	N/A			
FLOW TUBING PRESSURE	N/A	N/A			

A record of the formations drilled through, and pertinent remarks are presented on the reverse. I declare that I have knowledge of the contents of this report and am authorized by my organization to make this report, which was prepared by me or under my supervision and direction, with the data and facts stated herein to be true, correct, and complete to the best of my knowledge and belief.

Joseph C. Brevetti
SIGNATURE
13929 Quail Pointe Dr.
ADDRESS
Oklahoma City
CITY
OK
STATE
73134
ZIP
3/14/18
DATE
(405) 286-0361
PHONE NUMBER
brevetti@charteroakproduction.com
EMAIL ADDRESS

API NO. 35-019-25341
OTC PROD. UNIT NO. 019-204190

PLEASE TYPE OR USE BLACK INK
NOTE:

Attach copy of original 1002
if recompletion or reentry.

AS SUBMITTED

RECEIVED

JAN 14 2011

Form 1002A
Rev. 2009

☒ ORIGINAL
☐ AMENDED (Reason)

COMPLETION REPORT

TYPE OF DRILLING OPERATION

☒ STRAIGHT HOLE ☐ DIRECTIONAL HOLE ☐ HORIZONTAL HOLE
☐ SERVICE WELL

If directional or horizontal, see reverse for bottom hole location.

COUNTY	Carter	SEC	24	TWP	03S	RGE	03W	SPUD DATE	01/20/2010
LEASE NAME	Pink Ripple	WELL NO.	1-24	DRLG FINISHED DATE	02/16/2010	DATE OF WELL COMPLETION	06/25/2010	1st PROD DATE	06/25/2010
C	1/4	N2	1/4	SE	1/4	NE	1/4	RECOMP DATE	
ELEVATION N Derrick	993'	Ground	980'	FSL OF 1/4 SEC	990	FWL OF 1/4 SEC	1980	Longitude (if known)	-97.459556
OPERATOR NAME	Charter Oak Production Co., LLC						OTC/OCC OPERATOR NO.	21672	
ADDRESS	13929 Quail Pointe Drive								
CITY	Oklahoma City	STATE	OK	ZIP	73134-1037				

OKLAHOMA CORPORATION COMMISSION

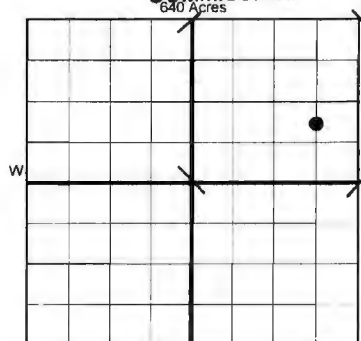

COMPLETION TYPE

<input type="checkbox"/> SINGLE ZONE
<input type="checkbox"/> MULTIPLE ZONE
Application Date
<input checked="" type="checkbox"/> COMMINGLED
Application Date
LOCATION
EXCEPTION ORDER
INCREASED DENSITY
ORDER NO.

CASING & CEMENT (Form 1002C must be attached)

TYPE	SIZE	WEIGHT	GRADE	FEET	PSI	SAX	TOP OF CMT
CONDUCTOR	16"			50'			Surface
SURFACE	9 5/8"	40# & 36#	J-55	1166'		375	Surface
INTERMEDIATE	N/A						
PRODUCTION	5 1/2"	17#	N-80	10498'		1150	5830'
LINER	N/A						
TOTAL DEPTH							10500'

PACKER @ BRAND & TYPE PLUG @ TYPE PLUG @ TYPE
PACKER @ BRAND & TYPE PLUG @ TYPE PLUG @ TYPE

COMPLETION & TEST DATA BY PRODUCING FORMATION **202V10L 269HNTN**

FORMATION	Viola	Hunton	Viola & Hunton
SPACING & SPACING ORDER NUMBER	181221 - 160 Ac.	181221 - 160 Ac.	181221 - 160 Ac.
CLASS Oil, Gas, Dry, Inj, Disp, Comm Disp, Svc	Oil	Oil	Oil
PERFORATED INTERVALS	9718' - 10392' O.A. (See attached wellbore schematic)	8629' - 9212' O.A. (See attached schematic)	8629' - 10392' O.A. (See attached schematic)
ACID/VOLUME	12,600 Gal 15% NeFe Acid	2,520 Gal 15% NeFe Acid	N/A
FRACTURE TREATMENT (Fluids/Prop Amounts)	20,408 BBL slick water 169,940# 20/40 sand	15,416 BBL slick water 106,000# 20/40 sand	N/A

Min Gas Allowable

(185-10-17-7)

☒ OR

Oil Allowable

(185-10-13-3)

Gas Purchaser/Measurer

First Sales Date

Atlas Pipeline Mid-Continent

06/24/2010 Gas, 07/06/2010 Oil

INITIAL TEST DATA

INITIAL TEST DATE	03/26/10	03/26/10	06/25/10
OIL-BBL/DAY	N/A	N/A	4
OIL-GRAVITY (API)	N/A	N/A	39
GAS-MCF/DAY	N/A	N/A	56
GAS-OIL RATIO CU FT/BBL	N/A	N/A	14000
WATER-BBL/DAY	N/A	N/A	199 (Load Water)
PUMPING OR FLOWING	N/A	N/A	Pumping
INITIAL SHUT-IN PRESSURE	2220 psi	1590 psi	N/A
CHOKE SIZE	N/A	N/A	N/A
FLOW TUBING PRESSURE	N/A	N/A	N/A

A record of the formations drilled through, and pertinent remarks are presented on the reverse. I declare that I have knowledge of the contents of this report and am authorized by my organization to make this report, which was prepared by me or under my supervision and direction, with the data and facts stated herein to be true, correct, and complete to the best of my knowledge and belief.

Alice E. Bengt

Alice E. Bengt, Project Manager

01/07/2011 (405) 286-0361

SIGNATURE

NAME (PRINT OR TYPE)

DATE

PHONE NUMBER

13929 Quail Pointe Drive

Oklahoma City OK 73134-1037

alice@charteroakproduction.com

ADDRESS

CITY

STATE

ZIP

EMAIL ADDRESS