

Oklahoma Corporation Commission  
Oil & Gas Conservation Division  
Post Office Box 52000  
Oklahoma City, Oklahoma 73152-2000  
Rule 165: 10-3-25

Form 1002A

API No.: 35015373000002

**Completion Report**

Spud Date: May 26, 1944

OTC Prod. Unit No.: 015-008353

Drilling Finished Date: August 05, 1944

**Amended**

1st Prod Date: August 15, 1944

Amend Reason: RECOMPLETION

Completion Date: August 15, 1944

Recomplete Date: February 13, 2019

**Drill Type: STRAIGHT HOLE**

Well Name: SCHOOL LAND 5

Purchaser/Measurer:

Location: CADD O 13 5N 9W  
C SW NW NE  
1650 FSL 330 FWL of 1/4 SEC  
Derrick Elevation: 0 Ground Elevation: 1325

First Sales Date:

Operator: HARMON C E OIL INC 10266

5555 E 71ST ST STE 9300  
TULSA, OK 74136-6559

Completion Type		Location Exception		Increased Density	
	Single Zone	Order No		Order No	
X	Multiple Zone	There are no Location Exception records to display.		There are no Increased Density records to display.	
	Commingled				

Casing and Cement							
Type	Size	Weight	Grade	Feet	PSI	SAX	Top of CMT
SURFACE	10 3/4			300		100	SURFACE
PRODUCTION	5 1/2			5579		1000	

Liner								
Type	Size	Weight	Grade	Length	PSI	SAX	Top Depth	Bottom Depth
There are no Liner records to display.								

**Total Depth: 5652**

Packer	
Depth	Brand & Type
There are no Packer records to display.	

Plug	
Depth	Plug Type
There are no Plug records to display.	

Initial Test Data
-------------------

Test Date	Formation	Oil BBL/Day	Oil-Gravity (API)	Gas MCF/Day	Gas-Oil Ratio Cu FT/BBL	Water BBL/Day	Pumpin or Flowing	Initial Shut-In Pressure	Choke Size	Flow Tubing Pressure
Jan 21, 2019	SCHOOL LAND	2	26			14	PUMPING			
Jan 31, 2019	NOBLE-OLSON	3	27.4				PUMPING	20		

Completion and Test Data by Producing Formation										
Formation Name: SCHOOL LAND				Code: 405SCLD				Class: OIL		
Spacing Orders				Perforated Intervals						
Order No		Unit Size		From			To			
UNSPACED				There are no Perf. Intervals records to display.						
Acid Volumes				Fracture Treatments						
NONE				NONE						
Formation Name: NOBLE-OLSON				Code: 451NBLO				Class: OIL		
Spacing Orders				Perforated Intervals						
Order No		Unit Size		From			To			
646832		40		3336			3342			
Acid Volumes				Fracture Treatments						
500 GALLONS 7 1/2 HCL				NONE						

Formation	Top
FORTUNA	2180
NOBLE-OLSON	3120
SCHOOL LAND	5567

Were open hole logs run? No  
 Date last log run:  
  
 Were unusual drilling circumstances encountered? No  
 Explanation:

Other Remarks
SQUEEZE DEPLETED NOBLE-OLSON PERFORATIONS FROM 3,290' - 3,298'. DRILL CIBP @ 3,620' AND SQUEEZE ROWE PERFORATIONS 3,724' - 3,738'. DRILL CIBP @ 3,819' AND SQUEEZE ROWE PERFORATIONS 3,870' - 3,886'. DRILL CIBP @ 4,020' AND SQUEEZE OSTRACODAL PERFORATIONS 4,226' - 4,240' AND SQUEEZE YULE PERFORATIONS FROM 4,514' - 4,520'. DRILL CIBP @ 4,646' AND TEST OPEN HOLE SCHOOL LAND FORMATION. SWAB 1 BO / 7 BW IN 6 HOURS = 4 BO / 28 BW IN 24 HOURS. PUMP RATE IS 2 BO / 14 BW. PLACE RBP OVER SCHOOL LAND FORMATION, PERFORATED NOBLE-OLSON FROM 3,336' - 3,342'. SWAB 1 BO IN 4 HOURS = 6 BO IN 24 HOURS OR 3 BO FOR PUMP RATE. PLACE RBP OVER NOBLE-OLSON AND PERFORATED FORTUNA FROM 2,304' - 2,314' AND 2,326' - 2,336'. GET WATER ONLY. SQUEEZE FORTUNA. REMOVE RBP'S AND PUT ON PUMP. OCC - SCHOOL LAND IS AN OPEN HOLE COMPLETION FROM BOTTOM OF 5 1/2" CASING AT 5,579' TO TOTAL DEPTH 5,652'.

FOR COMMISSION USE ONLY
<div> <div>Status: Accepted</div> <div>1142171</div> </div>

API NO. 01537300X  
OTC PROD. UNIT NO. 015008353

(PLEASE TYPE OR USE BLACK INK ONLY)

OKLAHOMA CORPORATION COMMISSION

Oil & Gas Conservation Division

Post Office Box 52000

Oklahoma City, Oklahoma 73152-2000

Rule 165:10-3-25

COMPLETION REPORT

RECEIVED

FEB 25 2019

Oklahoma Corporation  
Commission  
640 Acres

☒ ORIGINAL  
☐ AMENDED (Reason)

Recompletion

TYPE OF DRILLING OPERATION

☒ STRAIGHT HOLE ☐ DIRECTIONAL HOLE ☐ HORIZONTAL HOLE  
☐ SERVICE WELL

If directional or horizontal, see reverse for bottom hole location.

COUNTY	CADDO	SEC	13	TWP	5N	RGE	9W	SPUD DATE	5-26-12/21/18	
LEASE NAME	SCHOOL LAND				WELL NO.	5	DATE OF WELL COMPLETION	8-5-44		
C	1/4 SW	1/4 NW	1/4 NE	1/4	FSL OF 1/4 SEC	1650	FWL OF 1/4 SEC	330	1st PROD DATE	8-15-44
ELEVATION Derrick FL	Ground	1325	Latitude (if known)			Longitude (if known)				
OPERATOR NAME	C. E. HARMON OIL, INC.						OTC / OCC OPERATOR NO.	10266		
ADDRESS	5555 E. 71ST ST., STE 9300									
CITY	TULSA	STATE	OK	ZIP	74136					

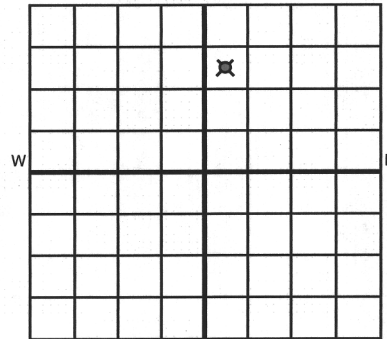

COMPLETION TYPE

<input type="checkbox"/> SINGLE ZONE	
<input checked="" type="checkbox"/> MULTIPLE ZONE	02/21/19
Application Date	
COMMINGLED	
Application Date	
LOCATION EXCEPTION ORDER NO.	
INCREASED DENSITY ORDER NO.	

CASING & CEMENT (Attach Form 1002C)

TYPE	SIZE	WEIGHT	GRADE	FEET	PSI	SAX	TOP OF CMT
CONDUCTOR							
SURFACE	10 3/4			300		100	SURFACE
INTERMEDIATE							
PRODUCTION	5 1/2			5579		1000	
LINER							
						TOTAL DEPTH	5,652

PACKER @ \_\_\_\_\_ BRAND & TYPE \_\_\_\_\_ PLUG @ \_\_\_\_\_ TYPE \_\_\_\_\_ PLUG @ \_\_\_\_\_ TYPE \_\_\_\_\_  
PACKER @ \_\_\_\_\_ BRAND & TYPE \_\_\_\_\_ PLUG @ \_\_\_\_\_ TYPE \_\_\_\_\_ PLUG @ \_\_\_\_\_ TYPE \_\_\_\_\_

COMPLETION & TEST DATA BY PRODUCING FORMATION 4055OLD 451NBLO

FORMATION	SCHOOL LAND	NOBLE-OLSON				No Frac
SPACING & SPACING ORDER NUMBER	UNSPACED	40/646832				
CLASS: Oil, Gas, Dry, Inj, Disp, Comm Disp, Svc	OIL	OIL				
PERFORATED INTERVALS	OPEN HOLE	3336-3342'				
ACID/VOLUME	NONE	7 1/2 HCL/500 gal				
FRACTURE TREATMENT (Fluids/Prop Amounts)	NONE	NONE				

Min Gas Allowable

(165:10-17-7)

Gas Purchaser/Measurer

OR

First Sales Date

Oil Allowable

(165:10-13-3)

INITIAL TEST DATA

INITIAL TEST DATE	1/21/2019	1/31/2019			
OIL-BBL/DAY	2	3			
OIL-GRAVITY ( API)	26	27.4			
GAS-MCF/DAY	0	0			
GAS-OIL RATIO CU FT/BBL	N/A	N/A			
WATER-BBL/DAY	14	0			
PUMPING OR FLOWING	PUMPING	PUMPING			
INITIAL SHUT-IN PRESSURE	0	20 PSI			
CHOKE SIZE	N/A	N/A			
FLOW TUBING PRESSURE	N/A	N/A			

A record of the formations drilled through, and pertinent remarks are presented on the reverse. I declare that I have knowledge of the contents of this report and am authorized by my organization to make this report, which was prepared by me or under my supervision and direction, with the data and facts stated herein to be true, correct, and complete to the best of my knowledge and belief.

Robert E. Harmon  
SIGNATURE

ROBERT E. HARMON

2/21/2019

(918) 663-8515

5555 E. 71ST ST., SUITE 9300

TULSA

OK

74136

DATE

PHONE NUMBER

rehoil@sbcglobal.net

AS SUBMITTED

PLEASE TYPE OR USE BLACK INK ONLY

FORMATION RECORD

Give formation names and tops, if available, or descriptions and thickness of formations drilled through. Show intervals cored or drillstem tested.

NAMES OF FORMATIONS	TOP
FORTUNA	2,180
NOBLE-OLSON	3,120
SCHOOL LAND	5,567

LEASE NAME SCHOOL LAND WELL NO. 5

FOR COMMISSION USE ONLY	
ITD on file <input type="checkbox"/> YES <input type="checkbox"/> NO	
APPROVED <input type="checkbox"/> DISAPPROVED <input type="checkbox"/>	2) Reject Codes

Were open hole logs run?	<input type="checkbox"/> yes <input checked="" type="checkbox"/> no
Date Last log was run	
Was CO <sub>2</sub> encountered?	<input type="checkbox"/> yes <input checked="" type="checkbox"/> no at what depths?
Was H <sub>2</sub> S encountered?	<input type="checkbox"/> yes <input checked="" type="checkbox"/> no at what depths?
Were unusual drilling circumstances encountered?	<input type="checkbox"/> yes <input checked="" type="checkbox"/> no
If yes, briefly explain below	

Other remarks: Squeeze depleted Noble-Olson perfs from 3290-3298'. Drill CIBP @ 3620' and squeeze Rowe perfs 3724-3738'.  
Drill CIBP @ 3819' and squeeze Rowe perfs 3870-3886'.  
Drill CIBP @ 4020' and squeeze Ostracodal perfs 4226-4240' and squeeze Yule perfs from 4514-4520'.  
Drill CIBP @ 4646 & test open hole School land formation. Swab 1 BO/7 BW in 6 hours = 4 BO/28 BW in 24 hrs. Pump rate is 2 BO/14 BW.  
Place RBP over School land formation, perf Noble-Olson from 3336-3342'. Swab 1 BO in 4 hours = 6 BO in 24 hrs or 3 BO for pump rate.  
Place RBP over Noble-Olson & perf Fortuna from 2304-2314' & 2326-2336'. Get water only. Squeeze Fortuna. Remove RBPs & put on pump

*occ - school land is an open hole completion from bottom of 5 1/2" casing at 5579' to total depth 5652'*

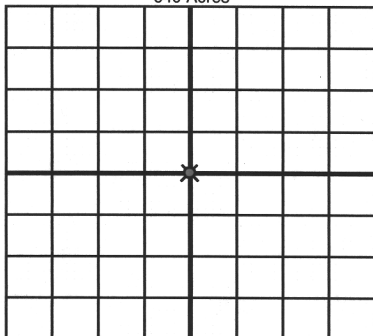

If more than three drainholes are proposed, attach a separate sheet indicating the necessary information.

Direction must be stated in degrees azimuth. Please note, the horizontal drainhole and its end point must be located within the boundaries of the lease or spacing unit.

Directional surveys are required for all drainholes and directional wells.

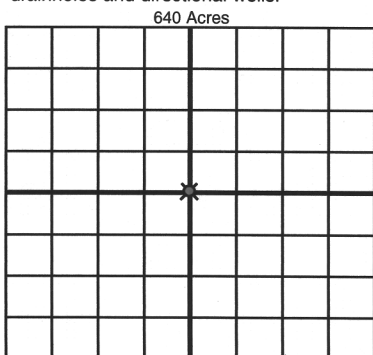

BOTTOM HOLE LOCATION FOR DIRECTIONAL HOLE

SEC	TWP	RGE	COUNTY
Spot Location			
1/4	1/4	1/4	1/4
Measured Total Depth		True Vertical Depth	BHL From Lease, Unit, or Property Line:

BOTTOM HOLE LOCATION FOR HORIZONTAL HOLE: (LATERALS)

LATERAL #1			
SEC	TWP	RGE	COUNTY
Spot Location			
1/4	1/4	1/4	1/4
Depth of Deviation		Radius of Turn	Direction
Measured Total Depth		True Vertical Depth	BHL From Lease, Unit, or Property Line:

LATERAL #2			
SEC	TWP	RGE	COUNTY
Spot Location			
1/4	1/4	1/4	1/4
Depth of Deviation		Radius of Turn	Direction
Measured Total Depth		True Vertical Depth	BHL From Lease, Unit, or Property Line:

LATERAL #3			
SEC	TWP	RGE	COUNTY
Spot Location			
1/4	1/4	1/4	1/4
Depth of Deviation		Radius of Turn	Direction
Measured Total Depth		True Vertical Depth	BHL From Lease, Unit, or Property Line: