

Oklahoma Corporation Commission  
Oil & Gas Conservation Division  
Post Office Box 52000  
Oklahoma City, Oklahoma 73152-2000  
Rule 165: 10-3-25

Form 1002A

API No.: 35015364270003

**Completion Report**

Spud Date: January 13, 1952

OTC Prod. Unit No.:

Drilling Finished Date: January 21, 1952

**Amended**

1st Prod Date: January 26, 1952

Amend Reason: INACTIVATE WELL

Completion Date: January 28, 1952

Recomplete Date: June 01, 2020

**Drill Type: STRAIGHT HOLE**

**SERVICE WELL**

Well Name: EAST CEMENT UNIT (PETREE 1A) 2-1A

Purchaser/Measurer:

Location: CADD 4 5N 9W  
C SE SE NE  
330 FSL 330 FEL of 1/4 SEC  
Latitude: 34.9355 Longitude: -98.14838888  
Derrick Elevation: 0 Ground Elevation: 1428

First Sales Date:

Operator: CITATION OIL & GAS CORPORATION 14156

14077 CUTTEN RD  
HOUSTON, TX 77069-2212

Completion Type		Location Exception		Increased Density	
X	Single Zone	Order No		Order No	
	Multiple Zone	There are no Location Exception records to display.		There are no Increased Density records to display.	
	Commingled				

Casing and Cement							
Type	Size	Weight	Grade	Feet	PSI	SAX	Top of CMT
SURFACE	10.75			300		250	SURFACE
PRODUCTION	7			2394		160	N/A

Liner								
Type	Size	Weight	Grade	Length	PSI	SAX	Top Depth	Bottom Depth
There are no Liner records to display.								

**Total Depth: 2452**

Packer	
Depth	Brand & Type
1837	TT
1972	ASIX

Plug	
Depth	Plug Type
2388	PLUGBACK CEMENT

Initial Test Data
-------------------

Test Date	Formation	Oil BBL/Day	Oil-Gravity (API)	Gas MCF/Day	Gas-Oil Ratio Cu FT/BBL	Water BBL/Day	Pumpin or Flowing	Initial Shut- In Pressure	Choke Size	Flow Tubing Pressure
-----------	-----------	----------------	----------------------	----------------	----------------------------	------------------	----------------------	---------------------------------	---------------	-------------------------

There are no Initial Data records to display.

Completion and Test Data by Producing Formation

Formation Name: PERMIAN                      Code: 459PRMN                      Class: INJ

Spacing Orders		Perforated Intervals	
Order No	Unit Size	From	To
85219	UNIT	2024	2349
Acid Volumes		Fracture Treatments	
N/A		N/A	

Formation	Top
FORTUNA	2024

Were open hole logs run? No  
Date last log run:  
  
Were unusual drilling circumstances encountered? No  
Explanation:

Other Remarks

THIS WELL HAS BEEN PLACED IN AN INACTIVE STATUS DUE TO LOW OIL PRICE ENVIRONMENT. A CASING PATCH WAS SET IN THIS WELL FROM 43.45 - 132.03 AND A PASSING MIT WAS OBTAINED FEBRUARY 12, 2020. 1003A HAS BEEN FILED.

FOR COMMISSION USE ONLY	
Status: Accepted	1145294

API NO. 35-015-36427  
OTC PROD.  
UNIT NO.

(PLEASE TYPE OR USE BLACK INK ONLY)

OKLAHOMA CORPORATION COMMISSION  
Oil & Gas Conservation Division  
Post Office Box 52000  
Oklahoma City, Oklahoma 73152-2000  
Rule 165:10-3-25

Form 1002A  
Rev. 2009

☐ ORIGINAL  
☒ AMENDED (Reason) Inactivate well

COMPLETION REPORT

TYPE OF DRILLING OPERATION

☒ STRAIGHT HOLE ☐ DIRECTIONAL HOLE ☐ HORIZONTAL HOLE  
☒ SERVICE WELL

If directional or horizontal, see reverse for bottom hole location.

COUNTY Caddo SEC 04 TWP 05N RGE 09W

LEASE NAME EAST CEMENT UNIT WELL NO. 2-1A

C 1/4 SE 1/4 SE 1/4 NE 1/4 FSL OF 1/4 SEC 330 ENE OF 1/4 SEC 330

ELEVATION Derrick FL Ground 1428 Latitude (if known) 34.9355

OPERATOR NAME Citation Oil & Gas Corp.

ADDRESS 14077 Cutten Rd

CITY Houston STATE Texas

SPUD DATE 1/13/1952

DRLG FINISHED DATE 1/21/1952

DATE OF WELL COMPLETION 1/28/1952

1st PROD DATE 1/26/1952

RECOMP DATE 6/1/2020

Longitude (if known) -98.1483888

OTC / OCC OPERATOR NO. 14156

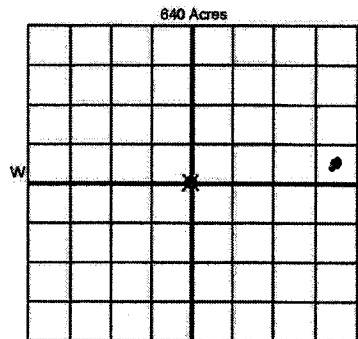

COMPLETION TYPE

☒ SINGLE ZONE  
☐ MULTIPLE ZONE  
Application Date  
☐ COMINGLED  
Application Date  
LOCATION EXCEPTION ORDER NO.  
INCREASED DENSITY ORDER NO.

CASING & CEMENT (Attach Form 1002C)

TYPE	SIZE	WEIGHT	GRADE	FEET	PSI	SAX	TOP OF CMT
CONDUCTOR							
SURFACE	10.75			300		250	surface
INTERMEDIATE							
PRODUCTION	7			2394		160	NA
LINER							

PACKER @ 1972 BRAND & TYPE ASIX PLUG @ 23BB TYPE Plugback cement  
PACKER @ 1937 BRAND & TYPE TT PLUG @ TYPE PLUG @ TYPE

TOTAL DEPTH 2452

COMPLETION & TEST DATA BY PRODUCING FORMATION

FORMATION	(Fortuna) Permian					No Fac
SPACING & SPACING ORDER NUMBER	85219 (unit)					
CLASS: Oil, Gas, Dry, Inj, Disp, Comm Disp, Svc	Injection					
PERFORATED INTERVALS	2024-2349					
ACID/VOLUME	NA					
FRACTURE TREATMENT (Fluids/Prop Amounts)	NA					

RECEIVED

JUN 11 2020

Oklahoma Corporation  
Commission

Min Gas Allowable (165:10-17-7)  
OR  
Oil Allowable (165:10-13-3)

Gas Purchaser/Measurer  
First Sales Date

INITIAL TEST DATA

INITIAL TEST DATE	NA					
OIL-BBL/DAY						
OIL-GRAVITY (API)						
GAS-MCF/DAY						
GAS-OIL RATIO CU FT/BBL						
WATER-BBL/DAY						
PUMPING OR FLOWING						
INITIAL SHUT-IN PRESSURE						
CHOKE SIZE						
FLOW TUBING PRESSURE						

A record of the formations drilled through, and pertinent remarks are presented on the reverse. I declare that I have knowledge of the contents of this report and am authorized by my organization to make this report, which was prepared by me or under my supervision and direction, with the data and facts stated herein to be true, correct, and complete to the best of my knowledge and belief.

SIGNATURE Sharon Ward  
14077 Cutten Rd  
ADDRESS  
Houston Texas 77069  
CITY STATE ZIP  
6/8/2020 281-891-1556  
DATE PHONE NUMBER  
sward@cogc.com  
EMAIL ADDRESS

PLEASE TYPE OR USE BLACK INK ONLY  
FORMATION RECORD

Give formation names and tops, if available, or descriptions and thickness of formations drilled through. Show intervals cored or drillstem tested.

LEASE NAME EAST CEMENT UNIT

WELL NO. 2-1A

NAMES OF FORMATIONS	TOP
FORTUNA	2024

FOR COMMISSION USE ONLY	
ITD on file <input type="checkbox"/> YES <input type="checkbox"/> NO	
APPROVED _____	DISAPPROVED _____
2) Reject Codes	

Were open hole logs run?	_____ yes _____ no
Date Last log was run	_____
Was CO <sub>2</sub> encountered?	_____ yes _____ no at what depths? _____
Was H <sub>2</sub> S encountered?	_____ yes _____ no at what depths? _____
Were unusual drilling circumstances encountered?	_____ yes _____ no
If yes, briefly explain below	

Other remarks: This well has been placed in an inactive status due to low oil price environment. A casing patch was set in this well from 43.45-132.03 and a passing MIT was obtained 2/12/20. 1003A has been filed. *OCC-UIC order# 85219*

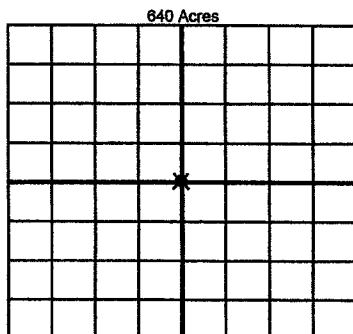

If more than three drainholes are proposed, attach a separate sheet indicating the necessary information.

Direction must be stated in degrees azimuth. Please note, the horizontal drainhole and its end point must be located within the boundaries of the lease or spacing unit.

Directional surveys are required for all drainholes and directional wells.

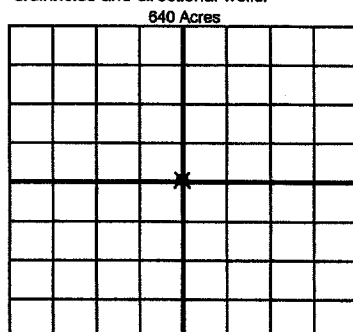

BOTTOM HOLE LOCATION FOR DIRECTIONAL HOLE

SEC	TWP	RGE	COUNTY
Spot Location			
1/4	1/4	1/4	1/4
Measured Total Depth		True Vertical Depth	BHL From Lease, Unit, or Property Line:

BOTTOM HOLE LOCATION FOR HORIZONTAL HOLE: (LATERALS)

LATERAL #1

SEC	TWP	RGE	COUNTY
Spot Location			
1/4	1/4	1/4	1/4
Depth of Deviation		Radius of Turn	Direction
Measured Total Depth		True Vertical Depth	BHL From Lease, Unit, or Property Line:

LATERAL #2

SEC	TWP	RGE	COUNTY
Spot Location			
1/4	1/4	1/4	1/4
Depth of Deviation		Radius of Turn	Direction
Measured Total Depth		True Vertical Depth	BHL From Lease, Unit, or Property Line:

LATERAL #3

SEC	TWP	RGE	COUNTY
Spot Location			
1/4	1/4	1/4	1/4
Depth of Deviation		Radius of Turn	Direction
Measured Total Depth		True Vertical Depth	BHL From Lease, Unit, or Property Line: