

Oklahoma Corporation Commission  
Oil & Gas Conservation Division  
Post Office Box 52000  
Oklahoma City, Oklahoma 73152-2000  
Rule 165: 10-3-25

Form 1002A

API No.: 35071236440001

**Completion Report**

Spud Date: October 22, 2019

OTC Prod. Unit No.:

Drilling Finished Date: October 23, 2019

1st Prod Date:

**Amended**

Completion Date: November 21, 2019

Amend Reason: RE-ENTER

**Drill Type: STRAIGHT HOLE**

Well Name: MARIAN B SCOTT 1

Purchaser/Measurer:

Location: KAY 32 29N 2E  
C SW NW SW  
1650 FSL 330 FWL of 1/4 SEC  
Derrick Elevation: 1176 Ground Elevation: 1166

First Sales Date:

Operator: O G P OPERATING INC 17901

8140 WALNUT HILL LN STE 610  
DALLAS, TX 75231-4336

Completion Type		Location Exception		Increased Density	
X	Single Zone	Order No		Order No	
	Multiple Zone	N/A		N/A	
	Commingled				

Casing and Cement								
Type		Size	Weight	Grade	Feet	PSI	SAX	Top of CMT
SURFACE		8 5/8	20	LTD	282	4000	180	SURFACE
PRODUCTION		5 1/2	17	K-55	1720	2000	320	SURFACE

Liner								
Type	Size	Weight	Grade	Length	PSI	SAX	Top Depth	Bottom Depth
There are no Liner records to display.								

**Total Depth: 1730**

Packer		Plug	
Depth	Brand & Type	Depth	Plug Type
1140	PACKER	1325	CIBP

Initial Test Data										
Test Date	Formation	Oil BBL/Day	Oil-Gravity (API)	Gas MCF/Day	Gas-Oil Ratio Cu FT/BBL	Water BBL/Day	Pumpin or Flowing	Initial Shut-In Pressure	Choke Size	Flow Tubing Pressure
Nov 11, 2019	NEWKIRK			650		200	FLOWING	325	N/A	180
Nov 21, 2019	VERTZ									

**Completion and Test Data by Producing Formation**

Formation Name: NEWKIRK

Code: 459NKRK

Class: DRY

**Spacing Orders**

Order No	Unit Size
N/A	

**Perforated Intervals**

From	To
1508	1514

**Acid Volumes**

500 GALLONS 7 1/2% HCL
------------------------

**Fracture Treatments**

NONE
------

Formation Name: VERTZ

Code: 406VRTZ

Class: DRY

**Spacing Orders**

Order No	Unit Size
N/A	

**Perforated Intervals**

From	To
1208	1249

**Acid Volumes**

500 GALLONS 7 1/2% HCL
------------------------

**Fracture Treatments**

NONE
------

Formation	Top
VERTZ	1180
NEWKIRK	1508

Were open hole logs run? No

Date last log run:

Were unusual drilling circumstances encountered? No

Explanation:

**Other Remarks**

SHUT IN. WAITING ON PIPELINE CONNECTION.

**FOR COMMISSION USE ONLY**

Status: Accepted

1145292

API NO. 071-23644 X  
OTC PROD. \_\_\_\_\_  
UNIT NO. \_\_\_\_\_

(PLEASE TYPE OR USE BLACK INK ONLY)

OKLAHOMA CORPORATION COMMISSION  
Oil & Gas Conservation Division  
Post Office Box 52000  
Oklahoma City, Oklahoma 73152-2000  
Rule 165:10-3-25

Form 1002A  
Rev. 2009

☒ ORIGINAL  
☒ AMENDED (Reason) Re-enter

COMPLETION REPORT

TYPE OF DRILLING OPERATION

☒ STRAIGHT HOLE ☐ DIRECTIONAL HOLE ☐ HORIZONTAL HOLE  
☐ SERVICE WELL

If directional or horizontal, see reverse for bottom hole location.

COUNTY KAY SEC 32 TWP 29N RGE 2E  
LEASE NAME MARION B SCOTT  
C 1/4 SW 1/4 NW 1/4 SW 1/4 FSL OF 1650' FWL OF 330'  
ELEVATION 1176' Ground 1166' Latitude (if known) Longitude (if known)  
OPERATOR OGP OPERATING, INC. OTC/OCC OPERATOR NO. 17901  
ADDRESS 8140 WALNUT HILL LANE SUITE 610  
CITY DALLAS STATE TX ZIP 75231

SPUD DATE 10/22/19  
DRIG FINISHED DATE 10/23/19  
DATE OF WELL COMPLETION 10/28/19

1st PROD DATE SI  
RECOMP DATE  
11-21-19 Date VertzW Tested

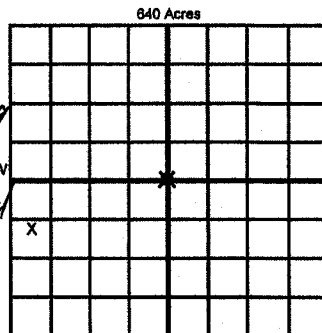

COMPLETION TYPE

☒ SINGLE ZONE  
☐ MULTIPLE ZONE  
Application Date  
COMINGLED  
Application Date  
LOCATION EXCEPTION ORDER NO. N/A  
INCREASED DENSITY ORDER NO. N/A

CASING & CEMENT (Attach Form 1002C)

TYPE	SIZE	WEIGHT	GRADE	FEET	PSI	SAX	TOP OF CMT
CONDUCTOR		20	42	102	4000	150	
SURFACE	8 5/8"	24	1-55	424	1500	225	SURFACE
INTERMEDIATE							
PRODUCTION	5 1/2"	17	K-55	1720'	2000	210	SURFACE
LINER						320	
						TOTAL DEPTH	1730'

PACKER @ 1140' BRAND & TYPE \_\_\_\_\_ PLUG @ 1325' TYPE CIBP PLUG @ \_\_\_\_\_ TYPE \_\_\_\_\_  
PACKER @ \_\_\_\_\_ BRAND & TYPE \_\_\_\_\_ PLUG @ \_\_\_\_\_ TYPE \_\_\_\_\_ PLUG @ \_\_\_\_\_ TYPE \_\_\_\_\_

COMPLETION & TEST DATA BY PRODUCING FORMATION

FORMATION NEWKIRK VERTZ  
SPACING & SPACING N/A N/A  
ORDER NUMBER  
CLASS: Oil, Gas, Dry, Inj, Disp, Comm Disp, Svc  
PERFORATED INTERVALS 1508'-1514' 1208'-1213' 1243'-1249'  
ACID/VOLUME 500 GALS 7 1/2% HCL 500 GAL 7 1/2% HCL  
FRACTURE TREATMENT (Fluids/Prop Amounts) none none  
RECEIVED JUN 08 2020 Oklahoma Corporation Commission

Min Gas Allowable (165:10-17-7) Gas Purchaser/Measurer  
OR First Sales Date  
Oil Allowable (165:10-13-3)

INITIAL TEST DATA

INITIAL TEST DATE 11/11/2019 11/21/2019  
OIL-BBL/DAY 0  
OIL-GRAVITY (API)  
GAS-MCF/DAY 650 DRY  
GAS-OIL RATIO CU FT/BBL  
TER-BBL/DAY 200  
OR FLOWING FLOWING  
PRESSURE 325 PSI 0  
N/A  
180 PSI

I declare that I have knowledge of the contents of this report and am authorized by my organization to sign for me or under my supervision and direction, with the data and facts stated herein to be true, correct, and complete to the best of my knowledge and belief.

DAVID G. BURNS 6/1/2020 214-696-2393  
NAME (PRINT OR TYPE) DATE PHONE NUMBER  
8140 WALNUT HILL LANE SUITE 610 DALLAS TX 75231  
ADDRESS CITY STATE ZIP  
DAVID.BURNS@OGPENERGY.COM  
EMAIL ADDRESS

PLEASE TYPE OR USE BLACK INK ONLY  
FORMATION RECORD

Give formation names and tops, if available, or descriptions and thickness of formations drilled through. Show intervals cored or drillstem tested.

NAMES OF FORMATIONS	TOP
NEWKIRK	1508'
VERTZ	1180'

LEASE NAME MARION B Scott WELL NO. 1

FOR COMMISSION USE ONLY	
ITD on file <input type="checkbox"/> YES <input type="checkbox"/> NO	
APPROVED _____	DISAPPROVED _____
2) Reject Codes	

Were open hole logs run?	yes	<input checked="" type="checkbox"/> no
Date Last log was run	_____	
Was CO <sub>2</sub> encountered?	yes	<input checked="" type="checkbox"/> no at what depths? _____
Was H <sub>2</sub> S encountered?	yes	<input checked="" type="checkbox"/> no at what depths? _____
Were unusual drilling circumstances encountered?	yes	<input checked="" type="checkbox"/> no
If yes, briefly explain below		

Other remarks: SI WOPL CONNECTION

---



---



---



---



---



---

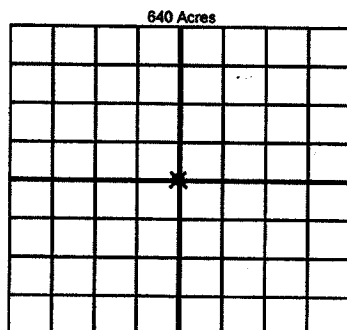

If more than three drainholes are proposed, attach a separate sheet indicating the necessary information.

Direction must be stated in degrees azimuth. Please note, the horizontal drainhole and its end point must be located within the boundaries of the lease or spacing unit.

Directional surveys are required for all drainholes and directional wells.

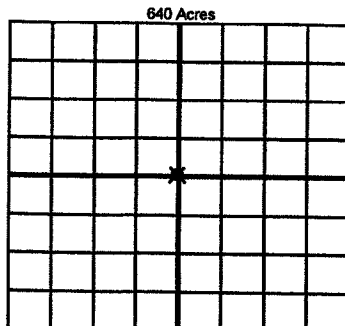

BOTTOM HOLE LOCATION FOR DIRECTIONAL HOLE

SEC	TWP	RGE	COUNTY
Spot Location			
1/4	1/4	1/4	1/4
Measured Total Depth		True Vertical Depth	Feet From 1/4 Sec Lines FSL FWL
BHL From Lease, Unit, or Property Line:			

BOTTOM HOLE LOCATION FOR HORIZONTAL HOLE: (LATERALS)

LATERAL #1			
SEC	TWP	RGE	COUNTY
Spot Location			
1/4	1/4	1/4	1/4
Depth of Deviation	Radius of Turn	Direction	Total Length
Measured Total Depth	True Vertical Depth	BHL From Lease, Unit, or Property Line:	

LATERAL #2			
SEC	TWP	RGE	COUNTY
Spot Location			
1/4	1/4	1/4	1/4
Depth of Deviation	Radius of Turn	Direction	Total Length
Measured Total Depth	True Vertical Depth	BHL From Lease, Unit, or Property Line:	

LATERAL #3			
SEC	TWP	RGE	COUNTY
Spot Location			
1/4	1/4	1/4	1/4
Depth of Deviation	Radius of Turn	Direction	Total Length
Measured Total Depth	True Vertical Depth	BHL From Lease, Unit, or Property Line:	