

Oklahoma Corporation Commission
Oil & Gas Conservation Division
Post Office Box 52000
Oklahoma City, Oklahoma 73152-2000
Rule 165: 10-3-25

Form 1002A

API No.: 35095206700000

Completion Report

Spud Date: January 29, 2019

OTC Prod. Unit No.:

Drilling Finished Date: February 27, 2019

1st Prod Date:

Completion Date: July 26, 2019

Drill Type: HORIZONTAL HOLE

Well Name: BELL 1-33H34X35

Purchaser/Measurer:

Location: MARSHALL 33 4S 5E
NE SE SE NW
2210 FNL 2505 FWL of 1/4 SEC
Derrick Elevation: 0 Ground Elevation: 0

First Sales Date:

Operator: XTO ENERGY INC 21003

22777 SPRINGWOODS VILLAGE PKWY
SPRING, TX 77389-1425

Completion Type		Location Exception		Increased Density	
X	Single Zone	Order No		Order No	
	Multiple Zone	688254		688792	
	Commingled			688793	
				688794	

Casing and Cement							
Type	Size	Weight	Grade	Feet	PSI	SAX	Top of CMT
CONDUCTOR	20	169	J-55	110			SURFACE
SURFACE	13 3/8	54.50	J-55	2013		855	SURFACE
PRODUCTION	5 1/2	20, 23	P-110	21719		2015	6200

Liner								
Type	Size	Weight	Grade	Length	PSI	SAX	Top Depth	Bottom Depth
There are no Liner records to display.								

Total Depth: 21719

Packer	
Depth	Brand & Type
There are no Packer records to display.	

Plug	
Depth	Plug Type
There are no Plug records to display.	

Initial Test Data

Test Date	Formation	Oil BBL/Day	Oil-Gravity (API)	Gas MCF/Day	Gas-Oil Ratio Cu FT/BBL	Water BBL/Day	Pumpin or Flowing	Initial Shut- In Pressure	Choke Size	Flow Tubing Pressure
-----------	-----------	----------------	----------------------	----------------	----------------------------	------------------	----------------------	---------------------------------	---------------	-------------------------

There are no Initial Data records to display.

Completion and Test Data by Producing Formation

Formation Name: WOODFORD

Code: 319WDFD

Class: TA

Spacing Orders

Order No	Unit Size
533420	640
583313	640
688251	MULTIUNIT

Perforated Intervals

From	To
8724	21589

Acid Volumes

N/A

Fracture Treatments

48 STAGES - 631,010 BARRELS TREATED WATER, 11,535,922 POUNDS 100 MESH, 3,983,810 POUNDS 40/70 SAND, 3,840,410 CRC SAND

Formation	Top
WOODFORD	8574

Were open hole logs run? No

Date last log run:

Were unusual drilling circumstances encountered? No

Explanation:

Other Remarks

IRREGULAR SECTION. WAITING ON OFFSET WELLS TO COMPLETE BEFORE PRODUCING.

Lateral Holes

Sec: 35 TWP: 4S RGE: 5E County: MARSHALL

SE NE NE NE

403 FNL 71 FEL of 1/4 SEC

Depth of Deviation: 7800 Radius of Turn: 674 Direction: 56 Total Length: 13430

Measured Total Depth: 21719 True Vertical Depth: 7003 End Pt. Location From Release, Unit or Property Line: 403

FOR COMMISSION USE ONLY

Status: Accepted

1144103

API NO. 095-20670
OTC PROD.
UNIT NO.

(PLEASE TYPE OR USE BLACK INK ONLY)

OKLAHOMA CORPORATION COMMISSION
Oil & Gas Conservation Division
Post Office Box 52000
Oklahoma City, Oklahoma 73152-2000
Rule 165:10-3-25

RECEIVED
OCT 28 2019
OKLAHOMA CORPORATION
COMMISSION

Form 1002A
Rev. 2009

☒ ORIGINAL
☐ AMENDED (Reason)

COMPLETION REPORT

TYPE OF DRILLING OPERATION

☐ STRAIGHT HOLE ☐ DIRECTIONAL HOLE ☒ HORIZONTAL HOLE
☐ SERVICE WELL

If directional or horizontal, see reverse for bottom hole location.

COUNTY **Marshall** SEC **33** TWP **4S** RGE **5E**
LEASE NAME **Bell 1-33H34X35** WELL NO. **→**
NE 1/4 SE 1/4 SE 1/4 NW 1/4 FNL OF 2210 FWL OF 2505
ELEVATION
Derrick FL Ground Latitude (if known) Longitude (if known)
OPERATOR NAME **XTO Energy Inc.** OTC / OCC OPERATOR NO. **21003**
ADDRESS **210 Park Avenue, Suite 2350**
CITY **Oklahoma City** STATE **Oklahoma** ZIP **73102**

SPUD DATE **1/29/2019**

DRLG FINISHED DATE **2/27/2019**

DATE OF WELL COMPLETION **7-26-19**

1st PROD DATE

RECOMP DATE

640 Acres
Date Frac Entered
W E
LOCATE WELL

COMPLETION TYPE

☒ SINGLE ZONE
☐ MULTIPLE ZONE
Application Date
☐ COMMINGLED
Application Date
LOCATION EXCEPTION ORDER NO. **688254, 688254**
INCREASED DENSITY ORDER NO. ***688792, 688793**

CASING & CEMENT (Attach Form 1002C)

TYPE	SIZE	WEIGHT	GRADE	FEET	PSI	SAX	TOP OF CMT
CONDUCTOR	20"	169	J-55	110			Surface
SURFACE	13 3/8"	54.50	J-55	2013		855	Surface
INTERMEDIATE							
PRODUCTION	5 1/2"	20,23	P-110	21,719		2015	6200
LINER							
				TOTAL DEPTH	21,719		

PACKER @ _____ BRAND & TYPE _____ PLUG @ _____ TYPE _____ PLUG @ _____ TYPE _____
PACKER @ _____ BRAND & TYPE _____ PLUG @ _____ TYPE _____ PLUG @ _____ TYPE _____

COMPLETION & TEST DATA BY PRODUCING FORMATION

FORMATION	Woodford						
SPACING & SPACING	640: 583313,	533420 (C40)	688251 (Multiunit)				
ORDER NUMBER							
CLASS: Oil, Gas, Dry, Inj, Disp, Comm Disp, Svc	TA						
PERFORATED INTERVALS	48 Stages						
	8724-21589'						
ACID/VOLUME	N/A						
FRACTURE TREATMENT (Fluids/Prop Amounts)	631,010 BTW Dbls Treated Water						
	11,535,922# 100 Mesh						
	3,983,810# 40/70 sand	3,840,410 CRC sand					

Min Gas Allowable (165:10-17-7) Gas Purchaser/Measurer
OR First Sales Date
Oil Allowable (165:10-13-3)

INITIAL TEST DATA

INITIAL TEST DATE	See Comments						
OIL-BBL/DAY							
OIL-GRAVITY (API)							
GAS-MCF/DAY							
GAS-OIL RATIO CU FT/BBL							
WATER-BBL/DAY							
PUMPING OR FLOWING							
INITIAL SHUT-IN PRESSURE							
CHOKE SIZE							
FLOW TUBING PRESSURE							

AS SUBMITTED

A record of the formations drilled through, and pertinent remarks are presented on the reverse. I declare that I have knowledge of the contents of this report and am authorized by my organization to make this report, which was prepared by me or under my supervision and direction, with the data and facts stated herein to be true, correct, and complete to the best of my knowledge and belief.

SIGNATURE **Debbie Waggoner** NAME (PRINT OR TYPE) **Debbie Waggoner** DATE **10/25/2019** PHONE NUMBER **405-319-3243**
ADDRESS **210 Park Avenue, Suite 2350** CITY **Oklahoma City** STATE **Ok** ZIP **73102** EMAIL ADDRESS **debbie_waggoner@xtoenergy.com**

Give formation names and tops, if available, or descriptions and thickness of formations drilled through. Show intervals cored or drillstem tested.

NAMES OF FORMATIONS	TOP
Woodford	8,574

FOR COMMISSION USE ONLY	
ITD on file	<input type="checkbox"/> YES <input type="checkbox"/> NO
APPROVED	DISAPPROVED
2) Reject Codes	

[illegible]

Other remarks:	Irregular Section
Waiting on offset wells to complete before producing.	
*Increased Density 688794	

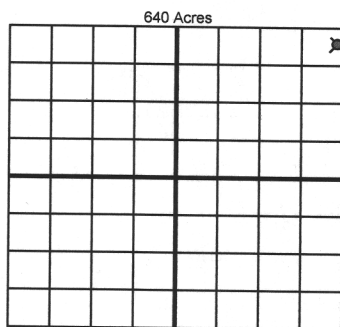

If more than three drainholes are proposed, attach a separate sheet indicating the necessary information.

Direction must be stated in degrees azimuth.
Please note, the horizontal drainhole and its end point must be located within the boundaries of the lease or spacing unit.

Directional surveys are required for all drainholes and directional wells.

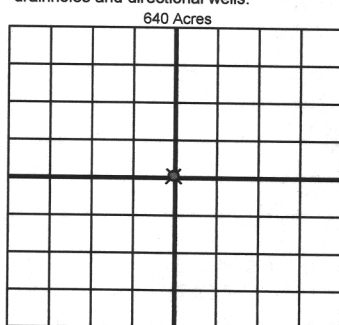

SEC	TWP	RGE	COUNTY
Spot Location			
1/4	1/4	1/4	1/4
Measured Total Depth		True Vertical Depth	BHL From Lease, Unit, or Property Line:

LATERAL #1									
SEC	35	TWP	4S	RGE	5E	COUNTY			
						Marshall			
Spot Location									
SE		NE		1/4		NE		1/4	
SE		NE		1/4		NE		1/4	
FEet From 1/4 Sec Lines		FNL		403				FEL 71	
Depth of Deviation		7,800		Radius of Turn		674.8		Direction 56	
Total Length		13,430							
Measured Total Depth				True Vertical Depth		BHL From Lease, Unit, or Property Line:			
21,719				7,003		403 FNL & 71 FEL			

SEC	TWP	RGE	COUNTY			
Spot Location			1/4	1/4	1/4	1/4
Feet From 1/4 Sec Lines			FSL			FWL
Depth of Deviation		Radius of Turn	Direction		Total Length	
Measured Total Depth		True Vertical Depth	BHL From Lease, Unit, or Property Line:			

SEC	TWP	RGE	COUNTY			
Spot Location			Feet From 1/4 Sec Lines		FSL	FWL
1/4	1/4	1/4	1/4			
Depth of Deviation		Radius of Turn	Direction	Total Length		
Measured Total Depth		True Vertical Depth	BHL From Lease, Unit, or Property Line:			