

OKLAHOMA CORPORATION COMMISSION
OIL & GAS CONSERVATION DIVISION
P.O. BOX 52000
OKLAHOMA CITY, OK 73152-2000
(Rule 165:10-3-1)

API NUMBER: 073 26494

Approval Date: 03/18/2019

Expiration Date: 09/18/2020

Horizontal Hole
Multi Unit

Oil & Gas

PERMIT TO DRILL

WELL LOCATION: Sec: 32 Twp: 16N Rge: 8W County: KINGFISHER

SPOT LOCATION: ☐ SE ☐ SW ☐ SE ☐ SW FEET FROM QUARTER: FROM SOUTH FROM WEST

SECTION LINES: 275 1700

Lease Name: MICHAEL FIU 1608 Well No: 6H-29X Well will be 275 feet from nearest unit or lease boundary.

Operator Name: NEWFIELD EXPLORATION MID-CON INC

Telephone: 2812105100; 9188781

OTC/OCC Number: 20944 0

NEWFIELD EXPLORATION MID-CON INC
4 WATERWAY SQUARE PL STE 100
THE WOODLANDS, TX 77380-2764

DAVID JOSEPH WITTROCK,
4424 248TH STREET NW
OKARCHE OK 73762

Formation(s) (Permit Valid for Listed Formations Only):

Name	Depth	Name	Depth
1 MISSISSIPPIAN	8836	6	
2 WOODFORD	9416	7	
3		8	
4		9	
5		10	

Spacing Orders: 635439
642183
690755

Location Exception Orders: 690756
690757

Increased Density Orders: 688852
688853

Pending CD Numbers:

Special Orders:

Total Depth: 19483

Ground Elevation: 1170

Surface Casing: 1500

Depth to base of Treatable Water-Bearing FM: 60

Under Federal Jurisdiction: No

Fresh Water Supply Well Drilled: No

Surface Water used to Drill: No

PIT 1 INFORMATION

Approved Method for disposal of Drilling Fluids:

Type of Pit System: CLOSED Closed System Means Steel Pits

Type of Mud System: WATER BASED

Chlorides Max: 5000 Average: 3000

Is depth to top of ground water greater than 10ft below base of pit? Y

Within 1 mile of municipal water well? N

Wellhead Protection Area? N

Pit is not located in a Hydrologically Sensitive Area.

Category of Pit: C

Liner not required for Category: C

Pit Location is NON HSA

Pit Location Formation: CHICKASHA

D. One time land application -- (REQUIRES PERMIT) PERMIT NO: 18-36055

E. Haul to Commercial pit facility: Sec. 31 Twn. 12N Rng. 8W Cnty. 17 Order No: 587498

H. SEE MEMO

This permit does not address the right of entry or settlement of surface damages.

The duration of this permit is SIX MONTHS, except as otherwise provided by Rule 165: 10-3-1.

Rule 165: 10-3-4 (c) (7) (e) - The Operator shall give 24 Hours notice by telephone to the appropriate District Office of the Conservation Division as to when Surface Casing will be run.

PIT 2 INFORMATION

Type of Pit System: CLOSED Closed System Means Steel Pits

Type of Mud System: OIL BASED

Chlorides Max: 300000 Average: 200000

Is depth to top of ground water greater than 10ft below base of pit? Y

Within 1 mile of municipal water well? N

Wellhead Protection Area? N

Pit is not located in a Hydrologically Sensitive Area.

Category of Pit: C

Liner not required for Category: C

Pit Location is NON HSA

Pit Location Formation: CHICKASHA

HORIZONTAL HOLE 1

Sec 29 Twp 16N Rge 8W County KINGFISHER

Spot Location of End Point: NE NE NW NW

Feet From: NORTH 1/4 Section Line: 85

Feet From: WEST 1/4 Section Line: 1017

Depth of Deviation: 8561

Radius of Turn: 391

Direction: 355

Total Length: 10307

Measured Total Depth: 19483

True Vertical Depth: 9416

End Point Location from Lease,
Unit, or Property Line: 85

Notes:

Category

Description

DEEP SURFACE CASING

12/31/2018 - G71 - APPROVED; NOTIFY OCC FIELD INSPECTOR IMMEDIATELY OF ANY LOSS OF CIRCULATION OR FAILURE TO CIRCULATE CEMENT TO SURFACE ON ANY CONDUCTOR OR SURFACE CASING

EXCEPTION TO RULE - 690757

2/5/2019 - G58 - (I.O.) 29 & 30-16N-8W
X165:10-3-28(C)(2)(B) MSSP, WDFD (MICHAEL FED 1608 6H-29X)
MAYBE CLOSER THAN 600' TO EXISTING AND/OR PROPOSED WELLS
2/1/2019

HYDRAULIC FRACTURING

12/31/2018 - G71 - OCC 165:10-3-10 REQUIRES:

1) PRIOR TO COMMENCEMENT OF HYDRAULIC FRACTURING OPERATIONS FOR HORIZONTAL WELLS, NOTICE GIVEN FIVE BUSINESS DAYS IN ADVANCE TO OFFSET OPERATORS WITH WELLS COMPLETED IN THE SAME COMMON SOURCE OF SUPPLY WITHIN 1/2 MILE;

2) WITH NOTICE ALSO GIVEN 48 HOURS IN ADVANCE OF HYDRAULIC FRACTURING ALL WELLS TO BOTH THE OCC CENTRAL OFFICE AND LOCAL DISTRICT OFFICES, USING THE "FRAC NOTICE FORM" FOUND AT THE FOLLOWING LINK:
OCCWEB.COM/OG/OGFORMS.HTML; AND,

3) THE CHEMICAL DISCLOSURE OF HYDRAULIC FRACTURING INGREDIENTS FOR ALL WELLS TO BE REPORTED TO FRACFOCUS WITHIN 60 DAYS AFTER THE CONCLUSION THE HYDRAULIC FRACTURING OPERATIONS, USING THE FOLLOWING LINK: FRACFOCUS.ORG

INCREASED DENSITY - 688852

2/5/2019 - G58 - 29-16N-8W
X635439 MSSP
5 WELLS
NEWFIELD EXPLORATION MID-CONTINENT INC.
12/26/2018

This permit does not address the right of entry or settlement of surface damages.

073 26494 MICHAEL FIU 1608 6H-29X

The duration of this permit is SIX MONTHS, except as otherwise provided by Rule 165: 10-3-1.

Rule 165: 10-3-4 (c) (7) (e) - The Operator shall give 24 Hours notice by telephone to the appropriate District Office of the Conservation Division as to when Surface Casing will be run.

Category	Description
INCREASED DENSITY - 688853	2/5/2019 - G58 - 32-16N-8W X635439 MSSP 5 WELLS NEWFIELD EXPLORATION MID-CONTINENT INC. 12/26/2018
INTERMEDIATE CASING	12/31/2018 - G71 - DUE TO THE KNOWN POTENTIAL RISK OF ENCOUNTERING AN OVER-PRESSURED ZONE IN THE MORROW SERIES IN THIS AREA, THE TECHNICAL MANAGER RECOMMENDS SETTING AN INTERMEDIATE STRING OF CASING IMMEDIATELY ABOVE THE MORROW SERIES
LOCATION EXCEPTION - 690756	2/5/2019 - G58 - (I.O.) 29 & 32-16N-8W X635439 MSSP, WDFD COMPL. INT. 32-16N-8W NCT 165' FSL, NCT 0' FNL, NCT 330' FWL COMPL. INT. 29-16N-8W NCT 0' FSL, NCT 165' FNL, NCT 330' FWL NEWFIELD EXPLORATION MID-CONTINENT INC. 2/1/2019
MEMO	12/31/2018 - G71 - PIT 1 & 2 - CLOSED SYSTEM = STEEL PITS PER OPERATOR REQUEST, WBM/CUTTINGS & OBM CUTTINGS CAPTURED IN STEEL HALF PITS, WBM CUTTINGS WILL BE SOIL FARMED, WBM & OBM CUTTINGS TRANSFERRED TO R360 587498 (31-12N-8W), CANADIAN CO, PIT 2 - OBM TO VENDOR
SPACING - 635439	2/5/2019 - G58 - (640)(HOR) 29 & 32-16N-8W VAC 41819 MCSTR VAC 83896 MNNG, MISS S2, E2 NW4, W2 NE4 29 & W2 W2, E2 SW4, E2 SE4 32 EXT 83896 MSSP, WDFD ** POE TO BHL NCT 660' FB (MSSP) POE TO BHL NCT 165 FNL OR FSL, NCT 330 FEL OR FWL (WDFD) (COEXIST SP. ORDER 83896 MNNG, MISS W2 NW4, E2 NE4 29 & 32 MINUS W2 W2 E2, E2 SE4) ** S/B EXT 614033 MSSP, WDFD; CORRECTED BY NPT 642183
SPACING - 642183	2/5/2019 - G58 - NPT TO SP. ORDER 635439 TO CORRECT ORDER BEING EXTENDED IS SP. ORDER NUMBER 614033
SPACING - 690755	2/5/2019 - G58 - (I.O.) 29 & 32-16N-8W EST MULTIUNIT HORIZONTAL WELL X635439 MSSP, WDFD (WDFD IS ADJACENT COMMON SOURCE OF SUPPLY TO MSSP) 50% 29 50% 32 NEWFIELD EXPLORATION MID-CONTINENT INC. 1/28/2019

This permit does not address the right of entry or settlement of surface damages.

The duration of this permit is SIX MONTHS, except as otherwise provided by Rule 165: 10-3-1.

Rule 165: 10-3-4 (c) (7) (e) - The Operator shall give 24 Hours notice by telephone to the appropriate District Office of the Conservation Division as to when Surface Casing will be run.

TOPOGRAPHIC LAND SURVEYORS OF OKLAHOMA

13800 WIRELESS WAY, OKLA. CITY, OKLA. 73134 * LOCAL (405) 843-4847 * OUT OF STATE (800) 654-3219
Certificate of Authorization No. 1293 LS

KINGFISHER

County, Oklahoma

275' FSL-1700' FWL Section 32 Township 16N Range 8W I.M.

PERMIT PLAT

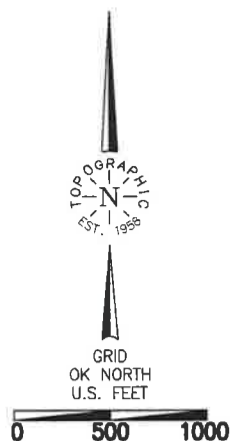

NOTES:

- NOTES:**
- The information shown herein is for construction purposes **ONLY**.
 - Section 32 is not within a flood zone.
 - All bearings shown are Grid, NAD-27, Oklahoma North.
 - Landing Point, Last Take Point, Bottom Hole, and Drill Path information provided by client listed, not surveyed.

SURFACE LOCATION

SERVICE NUMBER: _____
 DATUM: NAD-27
 LAT: 35°48'47.1"N
 LONG: 98°04'39.1"W
 LAT: 35.813081°N
 LONG: 98.077531°W
 STATE PLANE
 COORDINATES: (US Feet)
 ZONE: OK NORTH
 X: 1977012
 Y: 295977

DATUM: NAD-83
 LAT: 35°48'47.3"N
 LONG: 98°04'40.3"W
 LAT: 35.813127°N
 LONG: 98.077865°W
 STATE PLANE
 COORDINATES: (US Feet)
 ZONE: OK NORTH
 X: 1945413
 Y: 296001

This information was gathered with a GPS receiver with ± 1 foot Horiz./Vert. accuracy.

CERTIFICATE:

I, Thomas L. Howell an
Oklahoma Licensed Land Surveyor and
an authorized agent of Topographic
Land Surveyors of Oklahoma, do hereby
certify to the information shown herein.

Oklahoma Lic. No. 1438

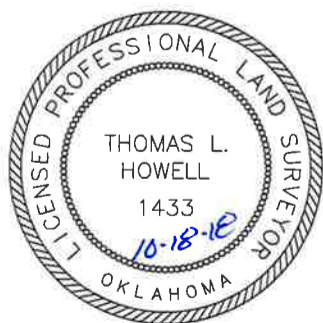

Operator: NEWFIELD EXPLORATION

Lease Name: MICHAEL FIU 1608

Topography & Vegetation Loc. fell in level to sloping wheat field.

Good Drill Site? Yes Alternate Location Stake Set None

Best Accessibility to Location From South off county road.

Distance & Direction

from Hwy Jct or Town From Kingfisher, OK, go ± 7.6 miles West on St. Hwy. 33, then ± 3 miles South, then ± 1 mile West
to the SE Corner of Section 32, T16N - R8W.

Invoice # 305349 Date of Drawing: Oct. 18, 2018 TR

Date Staked: Aug. 21, 2018

ELEVATION:

1170' Gr. at Stake (NGVD29)