

OKLAHOMA CORPORATION COMMISSION  
OIL & GAS CONSERVATION DIVISION  
P.O. BOX 52000  
OKLAHOMA CITY, OK 73152-2000  
(Rule 165:10-3-1)

API NUMBER: 073 26628

Approval Date: 10/04/2019

Expiration Date: 04/04/2021

Horizontal Hole  
Multi Unit

Oil & Gas

PERMIT TO DRILL

WELL LOCATION: Sec: 07 Twp: 15N Rge: 7W County: KINGFISHER

SPOT LOCATION: ☐ SE ☐ SE ☐ SW ☐ SW FEET FROM QUARTER: FROM SOUTH FROM WEST

SECTION LINES: 225 1125

Lease Name: PETTY FIU 1507 Well No: 3H-6XA Well will be 225 feet from nearest unit or lease boundary.

Operator Name: NEWFIELD EXPLORATION MID-CON INC

Telephone: 2812105100; 9188781

OTC/OCC Number: 20944 0

NEWFIELD EXPLORATION MID-CON INC  
4 WATERWAY AVE STE 100  
THE WOODLANDS, TX 77380-2764

VIRGINIA A. PETTY  
11798 E. 850 ROAD  
OKARCHE OK 73762

Formation(s) (Permit Valid for Listed Formations Only):

Name	Depth	Name	Depth
1 MISSISSIPPIAN	8362	6	
2 WOODFORD	8895	7	
3		8	
4		9	
5		10	

Spacing Orders: 643447  
690858

Location Exception Orders: 690865  
694887

Increased Density Orders: 689326  
689327

Pending CD Numbers:

Special Orders:

Total Depth: 19069

Ground Elevation: 1118

**Surface Casing: 1500**

Depth to base of Treatable Water-Bearing FM: 320

Deep surface casing has been approved

Under Federal Jurisdiction: No

Fresh Water Supply Well Drilled: No

Surface Water used to Drill: No

PIT 1 INFORMATION

Type of Pit System: CLOSED Closed System Means Steel Pits

Type of Mud System: WATER BASED

Chlorides Max: 5000 Average: 3000

Is depth to top of ground water greater than 10ft below base of pit? Y

Within 1 mile of municipal water well? N

Wellhead Protection Area? N

Pit is located in a Hydrologically Sensitive Area.

Category of Pit: C

Liner not required for Category: C

Pit Location is BED AQUIFER

Pit Location Formation: DUNCAN

Approved Method for disposal of Drilling Fluids:

D. One time land application -- (REQUIRES PERMIT)

PERMIT NO: 19-36236

E. Haul to Commercial pit facility: Sec. 31 Twn. 12N Rng. 8W Cnty. 17 Order No: 587498

H. SEE MEMO

This permit does not address the right of entry or settlement of surface damages.

The duration of this permit is 18 MONTHS, except as otherwise provided by Rule 165: 10-3-1.

Rule 165: 10-3-4 (c) (7) (e) - The Operator shall give 24 Hours notice by telephone to the appropriate District Office of the Conservation Division as to when Surface Casing will be run.

PIT 2 INFORMATION

Type of Pit System: CLOSED Closed System Means Steel Pits

Type of Mud System: OIL BASED

Chlorides Max: 300000 Average: 200000

Is depth to top of ground water greater than 10ft below base of pit? Y

Within 1 mile of municipal water well? N

Wellhead Protection Area? N

Pit is located in a Hydrologically Sensitive Area.

Category of Pit: C

Liner not required for Category: C

Pit Location is BED AQUIFER

Pit Location Formation: DUNCAN

HORIZONTAL HOLE 1

Sec 06 Twp 15N Rge 7W County KINGFISHER

Spot Location of End Point: NE NE NE NW

Feet From: NORTH 1/4 Section Line: 85

Feet From: WEST 1/4 Section Line: 2316

Depth of Deviation: 8080

Radius of Turn: 482

Direction: 10

Total Length: 10232

Measured Total Depth: 19069

True Vertical Depth: 8895

End Point Location from Lease,  
Unit, or Property Line: 85

Notes:

Category

Description

DEEP SURFACE CASING

9/19/2019 - G71 - APPROVED; NOTIFY OCC FIELD INSPECTOR IMMEDIATELY OF ANY LOSS OF CIRCULATION OR FAILURE TO CIRCULATE CEMENT TO SURFACE ON ANY CONDUCTOR OR SURFACE CASING

HYDRAULIC FRACTURING

9/19/2019 - G71 - OCC 165:10-3-10 REQUIRES:

1) PRIOR TO COMMENCEMENT OF HYDRAULIC FRACTURING OPERATIONS FOR HORIZONTAL WELLS, NOTICE GIVEN FIVE BUSINESS DAYS IN ADVANCE TO OFFSET OPERATORS WITH WELLS COMPLETED IN THE SAME COMMON SOURCE OF SUPPLY WITHIN 1/2 MILE;

2) WITH NOTICE ALSO GIVEN 48 HOURS IN ADVANCE OF HYDRAULIC FRACTURING ALL WELLS TO BOTH THE OCC CENTRAL OFFICE AND LOCAL DISTRICT OFFICES, USING THE "FRAC NOTICE FORM" FOUND AT THE FOLLOWING LINK: [OCCWEB.COM/OG/OGFORMS.HTML](http://OCCWEB.COM/OG/OGFORMS.HTML); AND,

3) THE CHEMICAL DISCLOSURE OF HYDRAULIC FRACTURING INGREDIENTS FOR ALL WELLS TO BE REPORTED TO FRACFOCUS WITHIN 60 DAYS AFTER THE CONCLUSION THE HYDRAULIC FRACTURING OPERATIONS, USING THE FOLLOWING LINK: [FRACFOCUS.ORG](http://FRACFOCUS.ORG)

INCREASED DENSITY – 689326

10/4/2019 - GB6 - 6-15N-7W  
X643447 MSSP  
6 WELLS  
NEWFIELD EXPLORATION MID-CONTINENT INC.  
01/07/2019

INCREASED DENSITY – 689327

10/4/2019 - GB6 - 7-15N-7W  
X643447 MSSP  
6 WELLS  
NEWFIELD EXPLORATION MID-CONTINENT INC.  
01/07/2019

This permit does not address the right of entry or settlement of surface damages.

The duration of this permit is 18 MONTHS, except as otherwise provided by Rule 165: 10-3-1.

Rule 165: 10-3-4 (c) (7) (e) - The Operator shall give 24 Hours notice by telephone to the appropriate District Office of the Conservation Division as to when Surface Casing will be run.

073 26628 PETTY FIU 1507 3H-6XA

LOCATION EXCEPTION - 694887	10/4/2019 - GB6 - (I.O.) 6 & 7 -15N-7W X643447 MSSP, WDFD COMPL. INT. (7-15N-7W) NCT 0' FNL, NCT 165' FSL, NCT 1980' FWL COMPL. INT. (6-15N-7W) NCT 0' FSL, NCT 165' FNL, NCT 1980' FWL NEWFIELD EXPLORATION MID-CONTINENT INC. 02/04/2019
LOCATION EXCEPTION – 690865	10/4/2019 - GB6 - (I.O.) 6 & 7 -15N-7W X165:10-3-28(C)(2)(B) MSSP (PETTY FIU 1507 3H-6X)** MAY BE CLOSER THAN 600' TO THE EXISTING PETTY 1H-6X AND/OR PROPOSED PETTY FIU 1507 2H-6X AND 4H-6X AND/OR PROPOSED PETTY FED 1507 5H-6X, 6H-6X, AND 7H-6X.*** NO OP. NAMED 12/09/2019  **S/B PETTY FIU 1507 3H-6XA. WILL BE CORRECTED AT FINAL HEARING PER OPERATOR. ***ALL WELL NUMBERS S/B ()-6XA. WILL BE CORRECTED AT FINAL HEARING PER OPERATOR.
MEMO	9/19/2019 - G71 - PIT 1 & 2 - CLOSED SYSTEM = STEEL PITS PER OPERATOR REQUEST, WBM/CUTTINGS & OBM CUTTINGS CAPTURED IN STEEL HALF PITS, WBM & WBM CUTTINGS WILL BE SOIL FARMED, OBM CUTTINGS TRANSFERRED TO R360 587498 (31-12N-8W), CANADIAN CO, PIT 2 - OBM TO VENDOR
SPACING - 690858	10/4/2019 - GB6 - (I.O.) 6 & 7 -15N-7W EST MULTIUNIT HORIZONTAL WELL X643447 MSSP,WDFD (WDFD ADJACENT COMMON SOURCE OF SUPPLY TO MSSP) 50% 6-15N-7W 50% 7-15N-7W NEWFIELD EXPLORATION MID-CONTINENT INC. 02/04/2019
SPACING – 643447	10/4/2019 - GB6 - (640)(HOR) 6 & 7 -15N-7W VAC 37910 FOR MCSTR VAC 248318 FOR MSSLM IN 6-15N-7W VAC 256082 FOR MSSLM IN 7-15N-7W EST MSSP, WDFD COMPL. INT. (MSSP) NCT 660 FB COMPL. INT. (WDFD) NCT 165' FSL, NCT 165' FNL, NCT 330' FEL, NCT 330' FWL

# TOPOGRAPHIC LAND SURVEYS OF OKLAHOMA

13800 WIRELESS WAY, OKLA. CITY, OKLA. 73134 \* LOCAL (405) 843-4847 \* OUT OF STATE (800) 654-3219  
Certificate of Authorization No. 1293 LS

35-073-26628

KINGFISHER

County, Oklahoma

225'FSL-1125'FWL Section 7 Township 15N Range 7W I.M.

NAD-27  
X 2006964.92  
Y 295870.97  
NAD-83  
X 1975366.44  
Y 295894.77



## NOTES:

- The information shown herein is for construction purposes ONLY.
- All bearings shown are Grid, NAD-27, Oklahoma North.
- Landing Point, Last Take Point, Bottom Hole, and Drill Path information provided by client listed, not surveyed.

## SURFACE LOCATION

DATUM: NAD-27  
LAT: 35°47'03.2"N  
LONG: 97°59'26.5"W  
LAT: 35.784210°N  
LONG: 97.990684°W  
STATE PLANE  
COORDINATES: (US Feet)  
ZONE: OK NORTH  
X: 2002764  
Y: 285459

DATUM: NAD-83  
LAT: 35°47'03.3"N  
LONG: 97°59'27.6"W  
LAT: 35.784257°N  
LONG: 97.991013°W  
STATE PLANE  
COORDINATES: (US Feet)  
ZONE: OK NORTH  
X: 1971166  
Y: 285483

(This information was gathered with a GPS receiver with ±1 foot Horiz./Vert. accuracy.)

## CERTIFICATE:

I, Thomas L. Howell an Oklahoma Licensed Land Surveyor and an authorized agent of Topographic Land Surveyors of Oklahoma, do hereby certify to the information shown herein.

*Thomas L. Howell*  
Oklahoma Lic. No. 1433

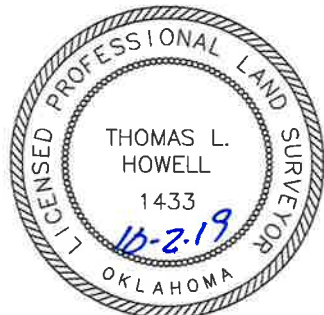

NAD-27 X 2001639.17 Y 285209.01  
NAD-83 X 1970040.83 Y 285232.77

Operator: NEWFIELD EXPLORATION MID-CON INC

Lease Name: PETTY FIU 1507

Topography & Vegetation Loc. fell in rolling pasture.

Good Drill Site? Yes

Reference Stakes or Alternate Location  
Stakes Set None

Best Accessibility to Location From South off county road.

Distance & Direction

from Hwy Jct or Town From Kingfisher, Okla., go ±5.5 miles South on US. Hwy. 81, then ±2.5 miles West on county road to the SW Cor. of Sec. 7-T15N-R7W

Revision ☒ B Date of Drawing: Oct. 02, 2019

Project # 129071B Date Staked: Sept. 03, 2019 LC

Well No.: 3H-6XA

## ELEVATION:

1118' Gr. at Stake (NGVD29)  
1119' Gr. at Stake (NAVD88)

