

OKLAHOMA CORPORATION COMMISSION
OIL & GAS CONSERVATION DIVISION
P.O. BOX 52000
OKLAHOMA CITY, OK 73152-2000
(Rule 165:10-3-1)

API NUMBER: 039 22583

Approval Date: 10/04/2019

Expiration Date: 04/04/2021

Horizontal Hole
Oil & Gas
Multi Unit

PERMIT TO DRILL

WELL LOCATION: Sec: 10 Twp: 15N Rge: 16W County: CUSTER

SPOT LOCATION: ☐ NW ☐ NW ☐ NE ☐ NE FEET FROM QUARTER: FROM NORTH FROM EAST

SECTION LINES: 255 1155

Lease Name: JONES Well No: 1-10H3X34 Well will be 255 feet from nearest unit or lease boundary.

Operator XTO ENERGY INC
Name:

Telephone: 4053193208; 8178852

OTC/OCC Number: 21003 0

XTO ENERGY INC
22777 SPRINGWOODS VILLAGE PKWY
SPRING, TX 77389-1425

RONALD E. JONES
23614 STATE HWY 47
THOMAS OK 73669

Formation(s) (Permit Valid for Listed Formations Only):

	Name	Depth	Name	Depth
1	MISSISSIPPIAN	13408	6	
2	WOODFORD	13853	7	
3			8	
4			9	
5			10	

Spacing Orders: 591694

Location Exception Orders:

Increased Density Orders:

Pending CD Numbers: 201904437
201904439
201904438

Special Orders:

Total Depth: 23900

Ground Elevation: 1789

Surface Casing: 1990

Depth to base of Treatable Water-Bearing FM: 370

Deep surface casing has been approved

Under Federal Jurisdiction: No

Fresh Water Supply Well Drilled: No

Surface Water used to Drill: Yes

PIT 1 INFORMATION

Approved Method for disposal of Drilling Fluids:

Type of Pit System: CLOSED Closed System Means Steel Pits

Type of Mud System: WATER BASED

Chlorides Max: 8000 Average: 5000

Is depth to top of ground water greater than 10ft below base of pit? Y

Within 1 mile of municipal water well? N

Wellhead Protection Area? N

Pit is located in a Hydrologically Sensitive Area.

Category of Pit: C

Liner not required for Category: C

Pit Location is BED AQUIFER

Pit Location Formation: RUSH SPRINGS

D. One time land application -- (REQUIRES PERMIT)

PERMIT NO: 19-36854

H. SEE MEMO

This permit does not address the right of entry or settlement of surface damages.

The duration of this permit is 18 MONTHS, except as otherwise provided by Rule 165: 10-3-1.

Rule 165: 10-3-4 (c) (7) (e) - The Operator shall give 24 Hours notice by telephone to the appropriate District Office of the Conservation Division as to when Surface Casing will be run.

PIT 2 INFORMATION

Type of Pit System: CLOSED Closed System Means Steel Pits

Type of Mud System: OIL BASED

Chlorides Max: 300000 Average: 200000

Is depth to top of ground water greater than 10ft below base of pit? Y

Within 1 mile of municipal water well? N

Wellhead Protection Area? N

Pit is located in a Hydrologically Sensitive Area.

Category of Pit: C

Liner not required for Category: C

Pit Location is BED AQUIFER

Pit Location Formation: RUSH SPRINGS

HORIZONTAL HOLE 1

Sec 34 Twp 16N Rge 16W County DEWEY

Spot Location of End Point: N2 N2 NE NE

Feet From: NORTH 1/4 Section Line: 50

Feet From: EAST 1/4 Section Line: 660

Depth of Deviation: 11947

Radius of Turn: 587

Direction: 1

Total Length: 11031

Measured Total Depth: 23900

True Vertical Depth: 13853

End Point Location from Lease,
Unit, or Property Line: 50

Notes:

Category

Description

DEEP SURFACE CASING

9/19/2019 - G71 - APPROVED; NOTIFY OCC FIELD INSPECTOR IMMEDIATELY OF ANY LOSS OF CIRCULATION OR FAILURE TO CIRCULATE CEMENT TO SURFACE ON ANY CONDUCTOR OR SURFACE CASING

HYDRAULIC FRACTURING

9/19/2019 - G71 - OCC 165:10-3-10 REQUIRES:

1) PRIOR TO COMMENCEMENT OF HYDRAULIC FRACTURING OPERATIONS FOR HORIZONTAL WELLS, NOTICE GIVEN FIVE BUSINESS DAYS IN ADVANCE TO OFFSET OPERATORS WITH WELLS COMPLETED IN THE SAME COMMON SOURCE OF SUPPLY WITHIN 1/2 MILE;

2) WITH NOTICE ALSO GIVEN 48 HOURS IN ADVANCE OF HYDRAULIC FRACTURING ALL WELLS TO BOTH THE OCC CENTRAL OFFICE AND LOCAL DISTRICT OFFICES, USING THE "FRAC NOTICE FORM" FOUND AT THE FOLLOWING LINK: OCCEWEB.COM/OG/OGFORMS.HTML; AND,

3) THE CHEMICAL DISCLOSURE OF HYDRAULIC FRACTURING INGREDIENTS FOR ALL WELLS TO BE REPORTED TO FRACFOCUS WITHIN 60 DAYS AFTER THE CONCLUSION THE HYDRAULIC FRACTURING OPERATIONS, USING THE FOLLOWING LINK: FRACFOCUS.ORG

MEMO

9/19/2019 - G71 - PITS 1 & 2 - CLOSED SYSTEM=STEEL PITS (REQUIRED - DEER CREEK), PIT 2 - OBM RETURNED TO VENDOR, CUTTINGS PERMITTED PER DISTRICT

PENDING CD - 201904437

10/4/2019 - GC2 - (640)(HOR) 34-16N-16W
VAC 688919 MSSP, WDFD
EXT 677011 MSSP, WDFD
EST OTHER
COMPL. INT. (MSSP) NCT 660' FB
COMPL. INT. (WDFD) NCT 165' FNL/FSL, NCT 330' FEL/FWL
REC. 9-23-2019 (JOHNSON)

This permit does not address the right of entry or settlement of surface damages.

The duration of this permit is 18 MONTHS, except as otherwise provided by Rule 165: 10-3-1.

Rule 165: 10-3-4 (c) (7) (e) - The Operator shall give 24 Hours notice by telephone to the appropriate District Office of the Conservation Division as to when Surface Casing will be run.

039 22583 JONES 1-10H3X34

PENDING CD - 201904438	10/4/2019 - GC2 - (I.O) 3-15N-16W & 34-16N-16W EST MULTIUNIT HORIZONTAL WELL X591694 MSSP, WDFD 3-15N-16W X201904437 MSSP, WDFD 34-16N-16W (WDFD ASSOCIATED COMMON SOURCE OF SUPPLY TO MSSP) 49% 3-15N-16W 51% 34-16N-16W NO OP. NAMED REC. 9-23-2019 (JOHNSON)
PENDING CD - 201904439	10/4/2019 - GC2 - (I.O.) 3-15N-16W & 34-16N-16W X591694 MSSP, WDFD 3-15N-16W X201904437 MSSP, WDFD 34-16N-16W COMPL. INT. (3-15N-16W) NCT 0' FNL, NCT 165' FSL, NCT 330' FEL COMPL. INT. (34-16N-16W) NCT 0' FSL, NCT 165' FNL, NCT 330' FEL NO OP. NAMED REC. 9-23-2019 (JOHNSON)
SPACING - 591694	10/4/2019 - GC2 - (640) 3-15N-16W EXT OTHERS EST MSSP, WDFD, OTHERS
SURFACE CASING	9/19/2019 - G71 - MIN. 500' PER ORDER 39839

JONES 1-10H3X34

SECTION 10
TOWNSHIP 15 NORTH, RANGE 16 WEST
CUSTER COUNTY, OKLAHOMA

API: 039-22583

OPERATOR:



LEGEND:

- EXISTING WELL HEAD/PRODUCTION WELL
- PROPOSED SURFACE HOLE (PSHL)
- SECTION CORNER
- PROPOSED LANDING POINT (LP)
- PROPOSED TARGET 1 (T1)
- PROPOSED BOTTOM HOLE (PBHL)
- BORE LINE SECTION LINE INTERSECT
- EXISTING WELL BORE
- PROPOSED WELL BORE
- SUBJECT WELL BORE
- DRILLING UNIT

Line Table		
Line #	Azimuth	Length
L1	050.672739	393.79
L2	050.672739	254.80
L3	000.684095	5154.93
L4	000.684095	5227.17

I, Chad Fox, a duly registered Professional Land Surveyor in the State of OKLAHOMA, do hereby certify that the drawing shown hereon was completed and represents a good and accurate survey made upon the ground by me or under my direct supervision.

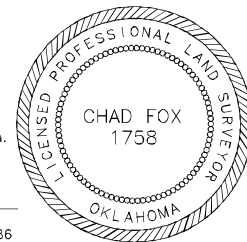

CHAD FOX P.L.S. NO. 1758
EX. DATE: 31JAN20 C.O.A. NO. 6186

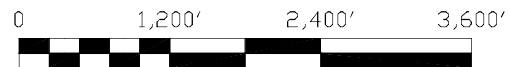

NOTES:

- This survey does not represent a boundary survey. It is for Geographical Information Systems (GIS) purposes only as instructed by the client and is not to be relied upon for the establishment of fences, buildings or other further improvement lines. Positions were taken with Survey Grade RTK GPS and NGS OPUS processed control using the NAD27 Oklahoma North State Plane Coordinate System.
- Bottom hole information provided by operator listed, not surveyed and corner coordinates are taken from points surveyed in field.

Operator: XTO Energy, Inc.

Best Accessibility to Location: From North

Distance & Direction from Hwy Jct or Town:
From the intersection of Hwy 47 and N 2310 Rd, then North on N 2310 Rd 3.0mi to E 0840 Rd, then West on E 0840 Rd to Access Rd. Well Location to the South.

Surface Hole Location: 255' From North Line Section 10
1155' From East Line Section 10

Latitude: N35.797194° (NAD 27)
Longitude: W98.883871° (NAD 27)
Latitude: N35.797241° (NAD 83)
Longitude: W98.884238° (NAD 83)

Ground Elev: 1788.78

Landing Point Location: 165' From South Line of Section 3
660' From East Line of Section 3

Bottom Hole Location: 50' From North Line Section 34
660' From East Line Section 34

Drilling Unit: Sec 3, T15N, R16W, Custer County &
Sec 34, T16N, R16W, Dewey County

CDF AND ASSOCIATES, LLC.

208 Dewey Ave. Poteau, OK 74953 (918) 649-3303
Certificate of Authorization No. 6186

JOB NO: XTO/WP19/JONES 1-10H3X34 DRAWN BY: LD

DATE: 22/JUL/19 REV: B SCALE: 1" = 1,200' Sht 1

