

OKLAHOMA CORPORATION COMMISSION
OIL & GAS CONSERVATION DIVISION
P.O. BOX 52000
OKLAHOMA CITY, OK 73152-2000
(Rule 165:10-3-1)

API NUMBER: 017 25584

Approval Date: 01/02/2020

Expiration Date: 07/02/2021

Horizontal Hole
Oil & Gas
Multi Unit

PERMIT TO DRILL

WELL LOCATION: Sec: 11 Twp: 14N Rge: 7W

County: CANADIAN

SPOT LOCATION: ☐ SE ☐ NE ☐ SW ☐ SE

FEET FROM QUARTER: FROM SOUTH FROM EAST

SECTION LINES: 678 1566

Lease Name: BRUEGGEN 1407

Well No: 7H-2X

Well will be 678 feet from nearest unit or lease boundary.

Operator
Name: NEWFIELD EXPLORATION MID-CON INC

Telephone: 2812105100; 9188781

OTC/OCC Number: 20944 0

NEWFIELD EXPLORATION MID-CON INC
4 WATERWAY AVE STE 100
THE WOODLANDS, TX 77380-2764

CYNTHIA K SCHROEDER
15438 W 149TH STREET
OLATHE KS 66062

Formation(s) (Permit Valid for Listed Formations Only):

Name	Depth	Name	Depth
1 MISSISSIPPIAN	8057	6	
2 WOODFORD	8541	7	
3		8	
4		9	
5		10	

Spacing Orders: 604466
705662

Location Exception Orders: 705664
705663

Increased Density Orders: 705330
705331
705332
705333

Pending CD Numbers:

Special Orders:

Total Depth: 19118

Ground Elevation: 1142

Surface Casing: 1500

Depth to base of Treatable Water-Bearing FM: 210

Deep surface casing has been approved

Under Federal Jurisdiction: No

Fresh Water Supply Well Drilled: No

Surface Water used to Drill: No

PIT 1 INFORMATION

Approved Method for disposal of Drilling Fluids:

Type of Pit System: CLOSED Closed System Means Steel Pits

Type of Mud System: WATER BASED

Chlorides Max: 5000 Average: 3000

Is depth to top of ground water greater than 10ft below base of pit? Y

Within 1 mile of municipal water well? N

Wellhead Protection Area? N

Pit is not located in a Hydrologically Sensitive Area.

Category of Pit: C

Liner not required for Category: C

Pit Location is NON HSA

Pit Location Formation: BISON

D. One time land application -- (REQUIRES PERMIT) PERMIT NO: 19-37171
E. Haul to Commercial pit facility: Sec. 31 Twn. 12N Rng. 8W Cnty. 17 Order No: 587498
H. SEE MEMO

This permit does not address the right of entry or settlement of surface damages.

The duration of this permit is 18 MONTHS, except as otherwise provided by Rule 165: 10-3-1.

Rule 165: 10-3-4 (c) (7) (e) - The Operator shall give 24 Hours notice by telephone to the appropriate District Office of the Conservation Division as to when Surface Casing will be run.

PIT 2 INFORMATION

Type of Pit System: CLOSED Closed System Means Steel Pits

Type of Mud System: OIL BASED

Chlorides Max: 300000 Average: 200000

Is depth to top of ground water greater than 10ft below base of pit? Y

Within 1 mile of municipal water well? N

Wellhead Protection Area? N

Pit is not located in a Hydrologically Sensitive Area.

Category of Pit: C

Liner not required for Category: C

Pit Location is NON HSA

Pit Location Formation: BISON

HORIZONTAL HOLE 1

Sec 02 Twp 14N Rge 7W County CANADIAN

Spot Location of End Point: NW NE NE NE

Feet From: NORTH 1/4 Section Line: 85

Feet From: EAST 1/4 Section Line: 600

Depth of Deviation: 8300

Radius of Turn: 521

Direction: 360

Total Length: 10000

Measured Total Depth: 19118

True Vertical Depth: 8541

End Point Location from Lease,
Unit, or Property Line: 85

Notes:

Category

Description

DEEP SURFACE CASING

12/30/2019 - G71 - APPROVED; NOTIFY OCC FIELD INSPECTOR IMMEDIATELY OF ANY LOSS OF CIRCULATION OR FAILURE TO CIRCULATE CEMENT TO SURFACE ON ANY CONDUCTOR OR SURFACE CASING

EXCEPTION TO THE RULE - 705664
(201904752)

1/2/2020 - GC2 - (I.O.) 2 & 11-14N-7W
X165:10-3-28(C)(2)(B) MSSP, WDFD (BRUEGGEN 1407 7H-2X)
MAY BE CLOSER THAN 600' TO BRUEGGEN 1407 2H-2X, BRUEGGEN 1407 3H-2X, BRUEGGEN 1407 4H-2X, BRUEGGEN 1407 5H-2X, BRUEGGEN 1407 6H-2X, BRUEGGEN 8H-2X, BRUEGGEN 1407 2X, VOSS 11-6
NO OP. NAMED
11-26-2019

HYDRAULIC FRACTURING

12/30/2019 - G71 - OCC 165:10-3-10 REQUIRES:

1) PRIOR TO COMMENCEMENT OF HYDRAULIC FRACTURING OPERATIONS FOR HORIZONTAL WELLS, NOTICE GIVEN FIVE BUSINESS DAYS IN ADVANCE TO OFFSET OPERATORS WITH WELLS COMPLETED IN THE SAME COMMON SOURCE OF SUPPLY WITHIN 1/2 MILE;

2) WITH NOTICE ALSO GIVEN 48 HOURS IN ADVANCE OF HYDRAULIC FRACTURING ALL WELLS TO BOTH THE OCC CENTRAL OFFICE AND LOCAL DISTRICT OFFICES, USING THE "FRAC NOTICE FORM" FOUND AT THE FOLLOWING LINK: OCCWEB.COM/OG/OGFORMS.HTML; AND,

3) THE CHEMICAL DISCLOSURE OF HYDRAULIC FRACTURING INGREDIENTS FOR ALL WELLS TO BE REPORTED TO FRACFOCUS WITHIN 60 DAYS AFTER THE CONCLUSION THE HYDRAULIC FRACTURING OPERATIONS, USING THE FOLLOWING LINK: FRACFOCUS.ORG

INCREASED DENSITY - 705330 (201904734)

1/2/2020 - GC2 - (I.O.) 2-14N-7W
X604466 MSSP
6 WELLS
NEWFIELD EXPLORATION MID-CONTINENT INC
11-19-2019

This permit does not address the right of entry or settlement of surface damages.

017 25584 BRUEGGEN 1407 7H-2X

The duration of this permit is 18 MONTHS, except as otherwise provided by Rule 165: 10-3-1.

Rule 165: 10-3-4 (c) (7) (e) - The Operator shall give 24 Hours notice by telephone to the appropriate District Office of the Conservation Division as to when Surface Casing will be run.

INCREASED DENSITY - 705331 (201904735)	1/2/2020 - GC2 - 2-14N-7W X604466 WDFD 7 WELLS NEWFIELD EXPLORATION MID-CONTINENT INC 11-19-2019
INCREASED DENSITY - 705332 (201904736)	1/2/2020 - GC2 - (I.O.) 11-14N-7W X604466 MSSP 6 WELLS NEWFIELD EXPLORATION MID-CONTINENT INC 11-19-2019
INCREASED DENSITY - 705333 (201904737)	1/2/2020 - GC2 - 11-14N-7W X604466 WDFD 7 WELLS NEWFIELD EXPLORATION MID-CONTINENT INC 11-19-2019
LOCATION EXCEPTION - 705663 (201904751)	1/2/2020 - GC2 - (I.O.) 2 & 11-14N-7W X604466 MSSP, WDFD, OTHER 2 & 11-14N-7W COMPL. INT. (11-14N-7W) NCT 165' FSL, NCT 0' FNL, NCT 330' FEL COMPL. INT. (2-14N-7W) NCT 0' FSL, NCT 165' FNL, NCT 330' FEL NEWFIELD EXPLORATION MID-CONTINENT INC 11-26-2019
MEMO	12/30/2019 - G71 - PIT 1 & 2 - CLOSED SYSTEM = STEEL PITS (REQUIRED - UNCLE JOHN CREEK), WBM/CUTTINGS & OBM CUTTINGS CAPTURED IN STEEL HALF PITS, WBM/CUTTINGS WILL BE SOIL FARMED, OBM CUTTINGS TRANSFERRED TO R360 587498 (31-12N-8W), CANADIAN CO, PIT 2 - OBM TO VENDOR
SPACING - 604466	1/2/2020 - GC2 - (640)(HOR) 2 & 11-14N-7W VAC OTHER VAC 127148 MSSLM VAC 286856 MCSMN EXT 599529 MSSP, WDFD, OTHER COMPL. INT. (MSSP) NCT 660' FB COMPL. INT. (WDFD) NCT 165' FNL/FSL, NCT 330' FEL/FWL
SPACING - 705662 (201904750)	1/2/2020 - GC2 - (I.O.) 2 & 11-14N-7W EST MULTIUNIT HORIZONTAL WELL X604466 MSSP, WDFD 2 & 11-14N-7W 50% 2-14N-7W 50% 11-14N-7W NEWFIELD EXPLORATION MID-CONTINENT INC 11-26-2019

This permit does not address the right of entry or settlement of surface damages.

The duration of this permit is 18 MONTHS, except as otherwise provided by Rule 165: 10-3-1.

Rule 165: 10-3-4 (c) (7) (e) - The Operator shall give 24 Hours notice by telephone to the appropriate District Office of the Conservation Division as to when Surface Casing will be run.

CANADIAN

COUNTY, OKLAHOMA

678' FSL - 1586' FEL SECTION 11 TOWNSHIP 14N RANGE 7W 1M

API: 017-25584

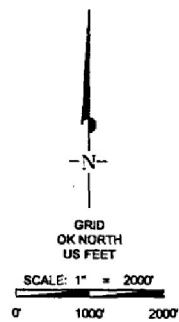

- NOTES:
- THE INFORMATION SHOWN HEREIN IS FOR CONSTRUCTION PURPOSES ONLY.
 - ALL BEARINGS SHOWN ARE GRID, NAD-83, OKLAHOMA NORTH.
 - LANDING POINT, LAST TAKE POINT, BOTTOM HOLE AND DRILL PATH INFORMATION PROVIDED BY CLIENT LISTED, NOT SURVEYED.

SURFACE LOCATION

DATUM: NAD-27
LAT: 35°41'54.9" N
LONG: 97°54'37.9" W
LAT: 35.698584° N
LONG: 97.910539° W
STATE PLANE
COORDINATES: (US Feet)
ZONE: OK NORTH
X: X 2026564
Y: Y 254302

DATUM: NAD-83
LAT: 35°41'55.1" N
LONG: 97°54'39.1" W
LAT: 35.698631° N
LONG: 97.910867° W
STATE PLANE
COORDINATES: (US Feet)
ZONE: OK NORTH
X: X 1994966
Y: Y 254326

(This information was gathered with a GPS receiver with ±1 foot Horiz/Vert accuracy)

CERTIFICATE:

I, Thomas L. Howell an Oklahoma Licensed Land Surveyor and an authorized agent of Topographic Land Surveyors of Oklahoma, do hereby certify to the information shown herein.

Thomas L. Howell
Oklahoma Reg. No. 1433

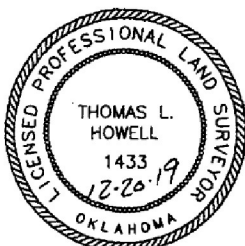

OPERATOR: NEWFIELD EXPLORATION MID-CON INC

LEASE NAME: WELL NO: BRUEGGEN 1407 WELL NO: 7H-2X

TOPOGRAPHY & VEGETATION LOCATION FELL IN SLOPED PASTURE

GOOD DRILL SITE? Yes REFERENCE STAKES OR ALTERNATE LOCATION STAKES SET: None

BEST ACCESSIBILITY TO LOCATION: From East off county road

DISTANCE & DIRECTION: From Okarche, OK, go South ±2 miles on US Hwy. 81/St Hwy 3, then East ±3.2 miles to the Southeast corner of Section 11-T14N-R7W

ELEVATION:

1142' Gr. at Stake (NGVD29)

1143' Gr. at Stake (NAVD88)

PROJECT # 131997

DATE OF DRAWING: DECEMBER 20, 2019

DATE STAKED: DECEMBER 20, 2019

DRAWN BY: EAH

REVISION: 0

FILE NAME: LO BRUEGGEN 1407 7H-2X

BOTTOM HOLE
85' FNL - 600' FEL
NAD-27
35°43'32.8" N
97°54'26.1" W
35.725779° N
97.907241° W
X 2027534
Y 264202
NAD-83
35°43'33.0" N
97°54'27.2" W
35.725826° N
97.907569° W
X 1995936
Y 264226

LAST TAKE POINT
165' FNL - 600' FEL
NAD-27
35°43'32.0" N
97°54'26.1" W
35.725559° N
97.907243° W
X 2027533
Y 264122
NAD-83
35°43'32.2" N
97°54'27.3" W
35.725606° N
97.907572° W
X 1995935
Y 264146

NAD-27
X 2022844.94
Y 264292.38
NAD-83
X 1991246.81
Y 264316.29

NAD-27
X 2025491.28
Y 264289.41
NAD-83
X 1993893.12
Y 264313.34

NAD-27
X 2028134.74
Y 264286.93
NAD-83
X 1996536.60
Y 264310.88

NAD-27
X 2022826.72
Y 261571.03
NAD-83
X 1991228.61
Y 261594.95

NAD-27
X 2022806.47
Y 258930.37
NAD-83
X 1991208.38
Y 258954.30

NAD-27
X 2022804.75
Y 256280.25
NAD-83
X 1991206.68
Y 256304.18

NAD-27
X 2022803.09
Y 253630.10
NAD-83
X 1991205.03
Y 253654.05

LANDING POINT
165' FSL - 600' FEL
NAD-27
35°41'49.9" N
97°54'26.2" W
35.697183° N
97.907272° W
X 2027535
Y 253793
NAD-83
35°41'50.0" N
97°54'27.4" W
35.697231° N
97.907800° W
X 1995936
Y 253817

NAD-27
X 2025486.12
Y 253619.45
NAD-83
X 1993868.06
Y 253643.42

SURFACE LOCATION
678' FSL - 1586' FEL
NAD-27
X 2028135.97
Y 253631.05
NAD-83
X 1996537.88
Y 253655.06