

OKLAHOMA CORPORATION COMMISSION
OIL & GAS CONSERVATION DIVISION
P.O. BOX 52000
OKLAHOMA CITY, OK 73152-2000
(Rule 165:10-3-1)

API NUMBER: 013 20172

Approval Date: 05/11/2021
Expiration Date: 11/11/2022

Directional Hole Oil & Gas

PERMIT TO DRILL

WELL LOCATION: Section: 27 Township: 6S Range: 7E County: BRYAN

SPOT LOCATION: ☐ SW ☐ NW ☐ NE ☐ NE FEET FROM QUARTER: FROM NORTH FROM EAST
SECTION LINES: 535 1045

Lease Name: ROBINSON Well No: 1-27 Well will be 275 feet from nearest unit or lease boundary.
Operator Name: GULF EXPLORATION LLC Telephone: 4058403371 OTC/OCC Number: 20983 0

GULF EXPLORATION LLC
9701 N BROADWAY EXT
OKLAHOMA CITY, OK 73114-6316

SHARON ROBINSON
1516 NORTH 12TH AVENUE
DURANT OK 74701

Formation(s) (Permit Valid for Listed Formations Only):

	Name	Code	Depth
1	VIOLA	202VIOL	4815
2	BROMIDE	202BRMD	5415
3	MCLISH	202MCLS	6230
4	OIL CREEK	202OLCK	6944

Spacing Orders: 716366

Location Exception Orders: No Exceptions

Increased Density Orders: No Density Orders

Pending CD Numbers: No Pending

Working interest owners' notified: ***

Special Orders: No Special Orders

Total Depth: 7200

Ground Elevation: 708

Surface Casing: 630

Depth to base of Treatable Water-Bearing FM: 580

Under Federal Jurisdiction: No
Fresh Water Supply Well Drilled: No
Surface Water used to Drill: Yes

Approved Method for disposal of Drilling Fluids:

D. One time land application -- (REQUIRES PERMIT)

PERMIT NO: 21-37599

H. (Other)

CLOSED SYSTEM=STEEL PITS (REQUIRED - LAKE TEXOMA)

PIT 1 INFORMATION

Type of Pit System: CLOSED Closed System Means Steel Pits

Type of Mud System: WATER BASED

Chlorides Max: 8000 Average: 5000

Is depth to top of ground water greater than 10ft below base of pit? Y

Within 1 mile of municipal water well? N

Wellhead Protection Area? N

Pit **is not** located in a Hydrologically Sensitive Area.

Category of Pit: C

Liner not required for Category: C

Pit Location is: NON HSA

Pit Location Formation: GRAYSON MARL

DIRECTIONAL HOLE 1

Section: 27 Township: 6S Range: 7E Meridian: IM
County: BRYAN

Measured Total Depth: 7200

Spot Location of End Point: SE NW NE NE

True Vertical Depth: 7199

Feet From: NORTH 1/4 Section Line: 536

End Point Location from

Feet From: EAST 1/4 Section Line: 960

Lease, Unit, or Property Line: 360

NOTES:

This permit does not address the right of entry or settlement of surface damages. The duration of this permit is 18 MONTHS, except as otherwise provided by Rule 165: 10-3-1. Rule 165: 10-3-4 (c) (7) (e) - The Operator shall give 24 Hours notice by telephone to the appropriate District Office of the Conservation Division as to when Surface Casing will be run.

Category	Description
HYDRAULIC FRACTURING	<p>[4/29/2021 - GC2] - OCC 165:10-3-10 REQUIRES:</p> <p>1) NOTICE SHALL BE GIVEN AT LEAST 5 BUSINESS DAYS PRIOR TO COMMENCEMENT OF HYDRAULIC FRACTURING OPERATIONS ON A HORIZONTAL WELL TO OPERATORS PRODUCING WELLS WITHIN 1 MILE OF THE COMPLETION INTERVAL OF THE SUBJECT WELL. THE NOTICE TO SUCH OPERATORS SHALL CONTAIN THE INFORMATION IN FORM 6000NOO. IF THE HYDRAULIC FRACTURING OPERATIONS SCHEDULE CHANGES AFTER NOTICE HAS BEEN PROVIDED, RESULTING IN A DELAY OF OPERATIONS OF MORE THAN 5 DAYS FROM THE INITIAL NOTICE, NEW NOTICE IS REQUIRED TO BE GIVEN;</p> <p>2) NOTICE WILL BE GIVEN TO THE OCC CENTRAL OFFICE AND LOCAL DISTRICT OFFICES AT LEAST 48 HOURS PRIOR TO COMMENCEMENT OF HYDRAULIC FRACTURING OPERATIONS. FORM 6000NHF SHALL BE USED AND IS FOUND AT THIS LINK: OCCEWEB.COM/OG/OGFORMS.HTML; AND,</p> <p>3) THE CHEMICAL DISCLOSURE OF HYDRAULIC FRACTURING INGREDIENTS FOR ALL WELLS IS TO BE REPORTED TO FRACFOCUS WITHIN 60 DAYS AFTER THE CONCLUSION OF HYDRAULIC FRACTURING OPERATIONS, FOUND AT FRACFOCUS.ORG</p>
SPACING - 716366	<p>[5/11/2021 - GC2] - (80) N2 NE4 27 & N2 NW4 26-6S-7E LD VAC 46555 BRMD2, BRMD3 N2 NE4 27-6S-7E VAC 46555 MCLBA, OLCKU, AND OLCKB NE4 NE4 27-6S-7E VAC 120920 OLCKB N2 NE4 27-6S-7E EST VIOL, BRMD, MCLS, OLCK</p>

Well Location Plat

M & M Land Surveying, Inc.
520 "E" Street NW. Ardmore, OK. 73401
Office 580-226-0446 Mobile 580-221-4999

Company Name: Gulf Exploration, LLC Lease Name: Robinson #1-27
 Section 27 Township 6 South Range 7 East County Bryan Oklahoma
 Surface Location 535' FNL - 1045' FEL Elevation 708' Good Location? Yes

Topography

Location fell in
pasture ± 50' West of
Fnc. and ±125' N of
Fnc.

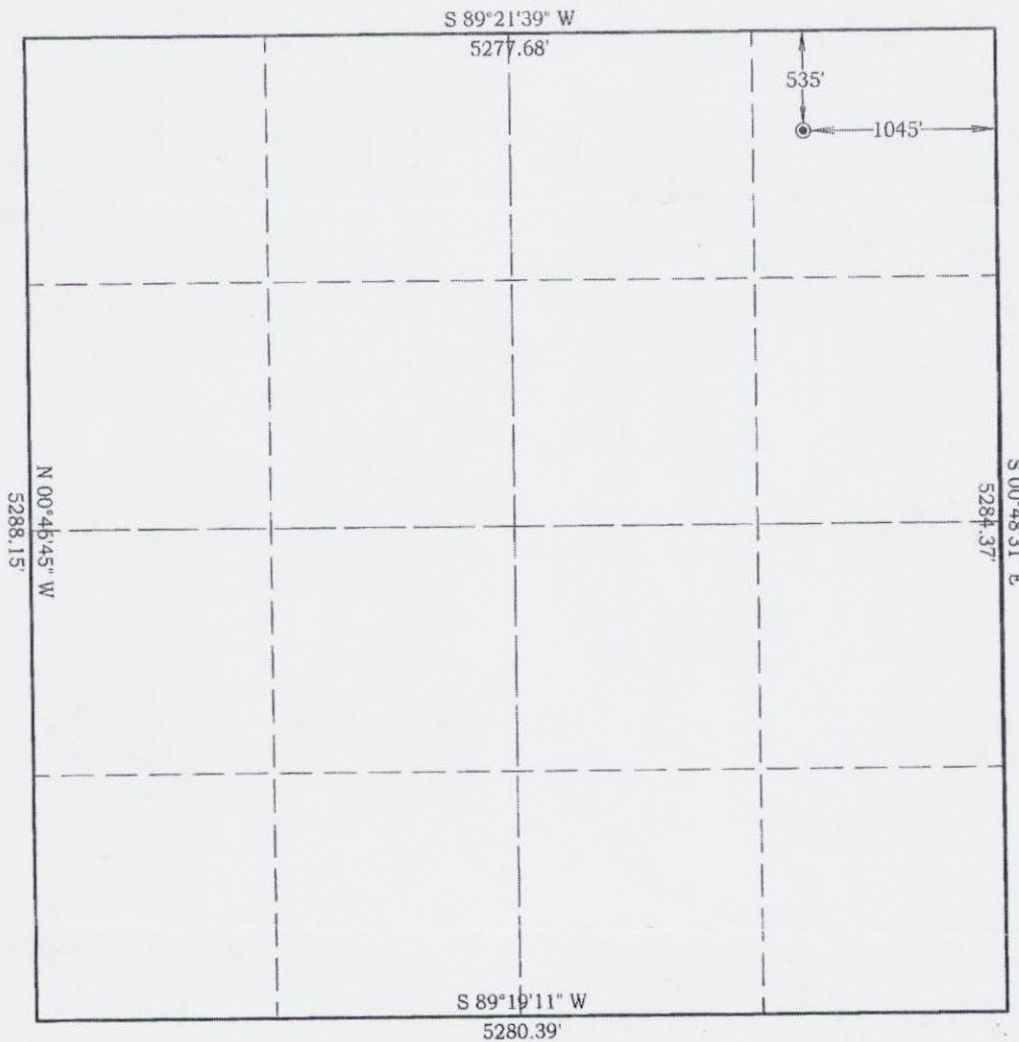

SCALE 1" = 1000'
 0' 1000'

Job # 21022
 Date 3/10/2021

NAD 83 OK South

Surface Location
 Latitude: 34.011220°
 Longitude: 96.556175°
 N= 249,828'
 E=2,406,043'

NAD 27 OK South

Surface Location
 Latitude: 34.011123°
 Longitude: 96.555901°
 N= 249,786'
 E=2,437,637'

Best Accessibility to Location
From the North

Distance & Direction From From the Jct US #70 and County Road #3630, go 1 mile North on County Road 3630 to the Northeast Corner of Section 27.
 Highway or Town _____

CERTIFICATE:

I, D. Harry McClintick, a Registered Land Surveyor in the state of Oklahoma, do hereby certify that the above described Well Location was surveyed and staked on the ground as shown.

[Signature] 3/10/2021
 D. Harry McClintick, R.P.L.S. # 1367, CA # 3093

This location has been staked according to the best official survey records available to us, but its accuracy is not guaranteed. Please review this plat and notify us immediately of any discrepancy.

