

OKLAHOMA CORPORATION COMMISSION
OIL & GAS CONSERVATION DIVISION
P.O. BOX 52000
OKLAHOMA CITY, OK 73152-2000
(Rule 165:10-3-1)

API NUMBER: 073 26557

Approval Date: 04/26/2019

Expiration Date: 10/26/2020

Horizontal Hole Oil & Gas

PERMIT TO DRILL

WELL LOCATION: Sec: 29 Twp: 19N Rge: 5W

County: KINGFISHER

SPOT LOCATION:

FEET FROM QUARTER: FROM SOUTH FROM WEST

SECTION LINES: 238 237

Lease Name: DONALD

Well No: 32-M1SH

Well will be 237 feet from nearest unit or lease boundary.

Operator Name: SK NEMAHA LLC

Telephone: 7133955141

OTC/OCC Number: 24221 0

SK NEMAHA LLC
11700 KATY FWY STE 900
HOUSTON, TX 77079--1222

TIMOTHY AND JANETTE MAGEE
7528 NW 192ND
EDMOND OK 73012

Formation(s) (Permit Valid for Listed Formations Only):

Name	Depth	Name	Depth
1 MISSISSIPPIAN	6716	6	
2		7	
3		8	
4		9	
5		10	

Spacing Orders: 654350
672186

Location Exception Orders:

Increased Density Orders:

Pending CD Numbers: 201902041
201902042

Special Orders:

Total Depth: 11666

Ground Elevation: 1068

Surface Casing: 380

Depth to base of Treatable Water-Bearing FM: 160

Under Federal Jurisdiction: No

Fresh Water Supply Well Drilled: No

Surface Water used to Drill: No

PIT 1 INFORMATION

Approved Method for disposal of Drilling Fluids:

Type of Pit System: CLOSED Closed System Means Steel Pits

Type of Mud System: WATER BASED

Chlorides Max: 5000 Average: 3000

Is depth to top of ground water greater than 10ft below base of pit? Y

Within 1 mile of municipal water well? N

Wellhead Protection Area? N

Pit is located in a Hydrologically Sensitive Area.

Category of Pit: C

Liner not required for Category: C

Pit Location is BED AQUIFER

Pit Location Formation: KINGMAN

D. One time land application -- (REQUIRES PERMIT) PERMIT NO: 19-36519
H. CLOSED SYSTEM=STEEL PITS PER OPERATOR REQUEST

This permit does not address the right of entry or settlement of surface damages.

The duration of this permit is SIX MONTHS, except as otherwise provided by Rule 165: 10-3-1.

Rule 165: 10-3-4 (c) (7) (e) - The Operator shall give 24 Hours notice by telephone to the appropriate District Office of the Conservation Division as to when Surface Casing will be run.

HORIZONTAL HOLE 1

Sec 32 Twp 19N Rge 5W County KINGFISHER

Spot Location of End Point: SE SW SW SW

Feet From: SOUTH 1/4 Section Line: 165

Feet From: WEST 1/4 Section Line: 400

Depth of Deviation: 6003

Radius of Turn: 460

Direction: 179

Total Length: 4940

Measured Total Depth: 11666

True Vertical Depth: 6716

End Point Location from Lease,

Unit, or Property Line: 165

Notes:

Category

Description

HYDRAULIC FRACTURING

4/23/2019 - G71 - OCC 165:10-3-10 REQUIRES:

1) PRIOR TO COMMENCEMENT OF HYDRAULIC FRACTURING OPERATIONS FOR HORIZONTAL WELLS, NOTICE GIVEN FIVE BUSINESS DAYS IN ADVANCE TO OFFSET OPERATORS WITH WELLS COMPLETED IN THE SAME COMMON SOURCE OF SUPPLY WITHIN 1/2 MILE;

2) WITH NOTICE ALSO GIVEN 48 HOURS IN ADVANCE OF HYDRAULIC FRACTURING ALL WELLS TO BOTH THE OCC CENTRAL OFFICE AND LOCAL DISTRICT OFFICES, USING THE "FRAC NOTICE FORM" FOUND AT THE FOLLOWING LINK: OCCEWEB.COM/OG/OGFORMS.HTML; AND,

3) THE CHEMICAL DISCLOSURE OF HYDRAULIC FRACTURING INGREDIENTS FOR ALL WELLS TO BE REPORTED TO FRACFOCUS WITHIN 60 DAYS AFTER THE CONCLUSION THE HYDRAULIC FRACTURING OPERATIONS, USING THE FOLLOWING LINK: FRACFOCUS.ORG

PENDING CD - 201902041

4/26/2019 - GB1 - (I.O.) 32-19N-5W
X654350/672186 MSSP
3 WELLS
NO OP. NAMED
REC. 4/22/2019 (THOMAS)

PENDING CD - 201902042

4/26/2019 - GB1 - (I.O.) 32-19N-5W
X654350/672186 MSSP
COMPL. INT. (MSSP) NCT 165' FNL, NCT 165' FSL, NCT 330' FWL
NO OP. NAMED
REC. 4/22/2019 (THOMAS)

SPACING - 654350

4/26/2019 - GB1 - (640)(HOR) 32-19N-5W
VAC 43828/62761 MSSLM NE4, SE4, SW4 **
EXT 648238 MSSP, OTHER
POE TO BHL NCT 660' FB
(COEXIST SP. ORDER # 44960/62761 MSSLM NW4)

** S/B VAC 44960/62761 MSSLM NE4, SE4, SW4

SPACING - 672186

4/26/2019 - GB1 - NPT PARAGRAPH 5.1(A) OF # 654350 TO CORRECT SCRIVENER'S ERROR
STATING # 43828 TO ORDER # 44960

This permit does not address the right of entry or settlement of surface damages.

073 26557 DONALD 32-M1SH

The duration of this permit is SIX MONTHS, except as otherwise provided by Rule 165: 10-3-1.

Rule 165: 10-3-4 (c) (7) (e) - The Operator shall give 24 Hours notice by telephone to the appropriate District Office of the Conservation Division as to when Surface Casing will be run.



Well Location Plat

S.H.L. Sec. 29-19N-5W I.M.
B.H.L. Sec. 32-19N-5W I.M.

Operator: SK NEMHA
Lease Name and No.: DONALD 32-M1SH
Footage: 238' FSL - 237' FWL Gr. Elevation: 1068'
Section: 29 Township: 19N Range: 5W I.M.
County: Kingfisher State of Oklahoma
Terrain at Loc.: Location fell in an open field.

API 073-26557



All bearings shown
are grid bearings.



1" = 1320'

GPS DATUM

NAD 83

NAD 27

OK NORTH ZONE

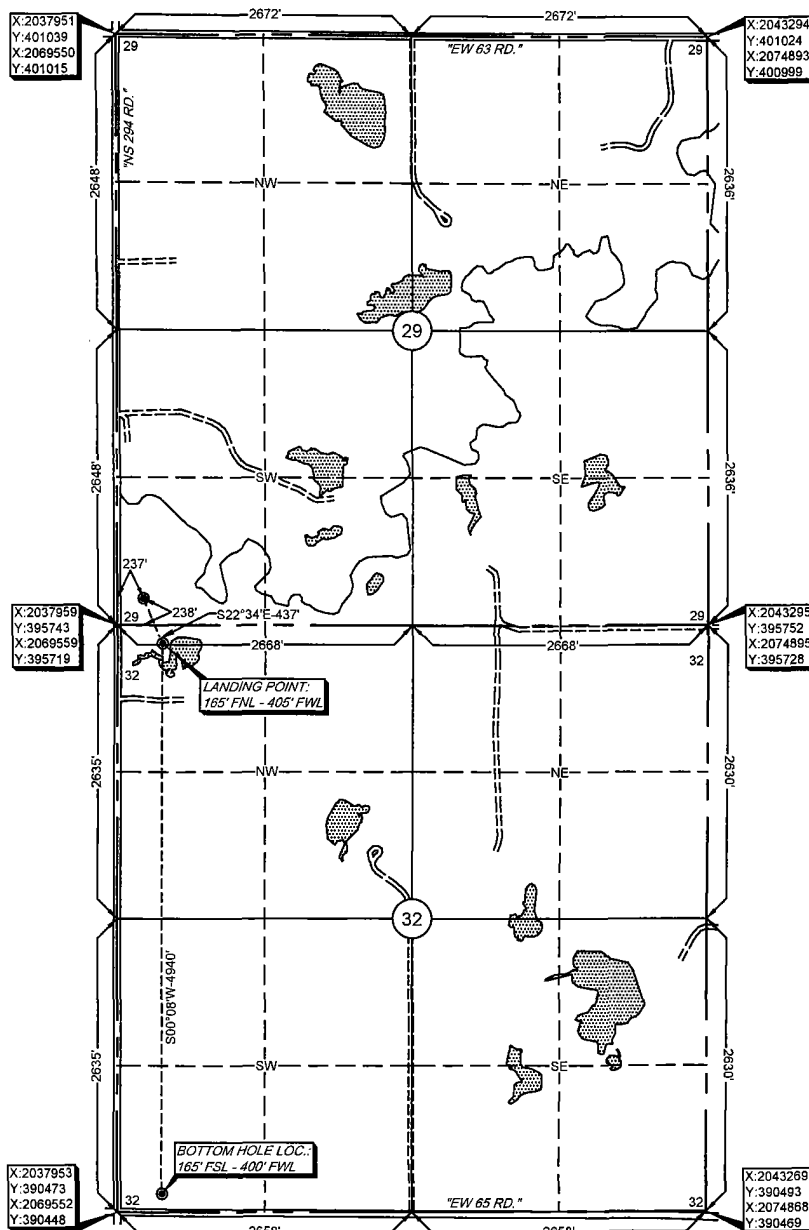

Surface Hole Loc.:
Lat: 36°05'15.28"N
Lon: 97°45'50.81"W
Lat: 36.08757863
Lon: -97.76411524
X: 2038197
Y: 395982

Surface Hole Loc.:
Lat: 36°05'15.14"N
Lon: 97°45'49.63"W
Lat: 36.08753973
Lon: -97.76378503
X: 2069796
Y: 395958

Landing Point:
Lat: 36°05'11.29"N
Lon: 97°45'48.78"W
Lat: 36.08646980
Lon: -97.76355125
X: 2038364
Y: 395579

Landing Point:
Lat: 36°05'11.15"N
Lon: 97°45'47.60"W
Lat: 36.08643088
Lon: -97.76322106
X: 2069963
Y: 395555

Bottom Hole Loc.:
Lat: 36°04'22.44"N
Lon: 97°45'49.06"W
Lat: 36.07290024
Lon: -97.76362852
X: 2038353
Y: 390639

Bottom Hole Loc.:
Lat: 36°04'22.30"N
Lon: 97°45'47.87"W
Lat: 36.07286104
Lon: -97.76329844
X: 2069953
Y: 390615

-Please note that this location was staked on the ground under the supervision of a Licensed Professional Land Surveyor, but the accuracy of this survey is not guaranteed. Please contact Arkoma Surveying and Mapping promptly if any discrepancy is determined. GPS data is obtained from RTK - which is a real-time kinematic method of surveying that provides centimeter-level accuracy. The accuracy of the survey is dependent on the quality of the equipment and the skill of the surveyor. Quarter Section distances may be assumed from a Government Survey Plat or assumed at a proportionate distance from opposing section corners, or occupation as shown on the plat. The survey is not a true boundary survey, and does not represent a true boundary survey.

Survey and plat by:
Arkoma Surveying and Mapping, PLLC
P.O. Box 238 Wilburton, OK 74578
Ph. 918-465-5711 Fax 918-465-5030
Certificate of Authorization No. 5348
Expires June 30, 2020

Invoice #8530
Date Staked: 03/04/19 By: D.K.
Date Drawn: 03/05/19 By: J.H.

Certification:

This is to certify that this Well Location Plat represents the results of a survey made on the ground performed under the supervision of the undersigned.

LANCE G. MATHIS

03/11/19

OK LPLS 1664

