

API NUMBER: 133 25371

OKLAHOMA CORPORATION COMMISSION
OIL & GAS CONSERVATION DIVISION
P.O. BOX 52000
OKLAHOMA CITY, OK 73152-2000
(Rule 165:10-3-1)

Approval Date: 09/24/2021
Expiration Date: 03/24/2023

Straight Hole Oil & Gas

PERMIT TO DRILL

WELL LOCATION: Section: 31 Township: 8N Range: 6E County: SEMINOLE

SPOT LOCATION: FEET FROM QUARTER: FROM NORTH FROM EAST
SECTION LINES: 2160 330

Lease Name: SANDY Well No: 1-31 Well will be 330 feet from nearest unit or lease boundary.
Operator Name: REACH OIL AND GAS COMPANY INC Telephone: 4052545779 OTC/OCC Number: 24558 0

REACH OIL AND GAS COMPANY INC
6301 WATERFORD BLVD STE 120
OKLAHOMA CITY, OK 73118-1100

SANDRA KAY BUCHANAN
35405 EW 1310 RD
MAUD OK 74854

Formation(s) (Permit Valid for Listed Formations Only):

	Name	Code	Depth
1	SENORA	404SNOR	3190
2	EARLSBORO	404ERLB	3370
3	BARTLESVILLE	404BRVL	3520
4	GILCREASE	403GLCR	3590
5	CROMWELL	402CMWL	3630

	Name	Code	Depth
6	HUNTON	269HNTN	4400
7	VIOLA	202VIOL	4500
8	SIMPSON DOLOMITE	202SMPSD	4570
9	1ST WILCOX	202WLCX1	4580
10	2ND WILCOX	202WLCX2	4620

Spacing Orders: 718199

Location Exception Orders: No Exceptions

Increased Density Orders: No Density

Pending CD Numbers: No Pending

Working interest owners' notified: ***

Special Orders: No Special

Total Depth: 4650 Ground Elevation: 900

Surface Casing: 760

Depth to base of Treatable Water-Bearing FM: 710

Under Federal Jurisdiction: No
Fresh Water Supply Well Drilled: No
Surface Water used to Drill: Yes

Approved Method for disposal of Drilling Fluids:

E. Haul to Commercial pit facility	Sec. 19 Twn. 8N Rng. 5E Cnty. 125 Order No: 274874
H. (Other)	CLOSED SYSTEM=STEEL PITS PER OPERATOR REQUEST

PIT 1 INFORMATION

Type of Pit System: CLOSED Closed System Means Steel Pits

Type of Mud System: WATER BASED

Chlorides Max: 8000 Average: 5000

Is depth to top of ground water greater than 10ft below base of pit? Y

Within 1 mile of municipal water well? N

Wellhead Protection Area? N

Pit is located in a Hydrologically Sensitive Area.

Category of Pit: C

Liner not required for Category: C

Pit Location is: AP/TE DEPOSIT

Pit Location Formation: TERRACE

NOTES:

This permit does not address the right of entry or settlement of surface damages. The duration of this permit is 18 MONTHS, except as otherwise provided by Rule 165: 10-3-1. Rule 165: 10-3-4 (c) (7) (e) - The Operator shall give 24 Hours notice by telephone to the appropriate District Office of the Conservation Division as to when Surface Casing will be run.

Category	Description
HYDRAULIC FRACTURING	<p>[9/23/2021 - GC2] - OCC 165:10-3-10 REQUIRES:</p> <p>1) NOTICE SHALL BE GIVEN AT LEAST 5 BUSINESS DAYS PRIOR TO COMMENCEMENT OF HYDRAULIC FRACTURING OPERATIONS ON A HORIZONTAL WELL TO OPERATORS PRODUCING WELLS WITHIN 1 MILE OF THE COMPLETION INTERVAL OF THE SUBJECT WELL. THE NOTICE TO SUCH OPERATORS SHALL CONTAIN THE INFORMATION IN FORM 6000NOO. IF THE HYDRAULIC FRACTURING OPERATIONS SCHEDULE CHANGES AFTER NOTICE HAS BEEN PROVIDED, RESULTING IN A DELAY OF OPERATIONS OF MORE THAN 5 DAYS FROM THE INITIAL NOTICE, NEW NOTICE IS REQUIRED TO BE GIVEN;</p> <p>2) NOTICE WILL BE GIVEN TO THE OCC CENTRAL OFFICE AND LOCAL DISTRICT OFFICES AT LEAST 48 HOURS PRIOR TO COMMENCEMENT OF HYDRAULIC FRACTURING OPERATIONS. FORM 6000NHF SHALL BE USED AND IS FOUND AT THIS LINK: OCCEWEB.COM/OG/OGFORMS.HTML; AND,</p> <p>3) THE CHEMICAL DISCLOSURE OF HYDRAULIC FRACTURING INGREDIENTS FOR ALL WELLS IS TO BE REPORTED TO FRACFOCUS WITHIN 60 DAYS AFTER THE CONCLUSION OF HYDRAULIC FRACTURING OPERATIONS, FOUND AT FRACFOCUS.ORG</p>
SPACING - 718199	<p>[9/24/2021 - G56] - (80) SE4 NE4, NE4 SE4 31-8N-6E SU SE4 NE NCT 330' FB VAC OTHER VAC 170575 SNOR, ERLB, BRVL, CMWL, HNTN, WLCX EST SNOR, ERLB, BRVL, GLCR, CMWL, HNTN, VIOL, SMPSD, WLCX1, WLCX2</p>



Well Location Plat

Sec. 31-8N-6E I.M.

Operator: REACH OIL AND GAS COMPANY, INC.

Lease Name and No.: SANDY #1-31

Surface Hole Location: 2160' FNL - 330' FEL Gr. Elevation: 900'

NE/4-SE/4-SE/4-NE/4 Section: 31 Township: 8N Range: 6E I.M.

County: Seminole State of Oklahoma

Terrain at Loc.: Location fell in heavy timber.



All bearings shown
are grid bearings.



1" = 1000'

GPS DATUM
NAD 27
OK SOUTH ZONE

Surface Hole Loc.:
Lat: 35°07'27.60"N
Lon: 96°42'22.23"W
Lat: 35.12433279
Lon: -96.70617494
X: 2386906
Y: 654259

-Please note that this location was staked on the ground under the supervision of a Licensed Professional Land Surveyor, but the accuracy of this survey is not guaranteed. Please contact Arkoma Surveying and Mapping promptly if any inconsistency is determined. GPS data is observed from RTK - GPS. NOTE: X and Y data shown herein for Section Corners may NOT have been surveyed on-the-ground, and further, does NOT represent a true boundary survey. Quarter Section distances may be assumed from a Government Survey Plat or a proposed plat. All distances from opposing section corners, or location thereof, and if it have been measured on-the-ground, and further, does not represent a true boundary survey.



Survey and plat by:

Arkoma Surveying and Mapping, PLLC

P.O. Box 238 Wilburton, OK 74578

Ph. 918-465-5711 Fax 918-465-5030

Certificate of Authorization No. 5348

Expires June 30, 2022

Invoice #9516-A

Date Staked: 08/27/2021 By: D.W.

Date Drawn: 08/30/2021 By: J.L.

Certification:

This is to certify that this Well Location Plat represents the results of a survey made on the ground performed under the supervision of the undersigned.

Lance G. Mathis
LANCE G. MATHIS

09/01/2021

OK LPLS 1664

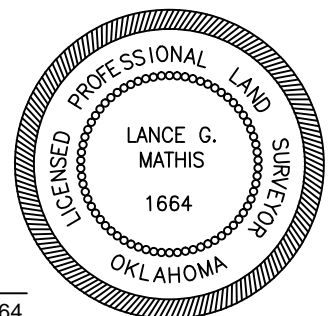





Topographic Vicinity Map

Operator: REACH OIL AND GAS COMPANY, INC.

Lease Name and No.: SANDY #1-31

Surface Hole Location: 2160' FNL - 330' FEL

Sec. 31 Twp. 8N Rng. 6E I.M.

County: Seminole State of Oklahoma



Ground Elevation at Surface Hole Location: 900'

Scale 1" = 2000'
Contour Interval: 10'

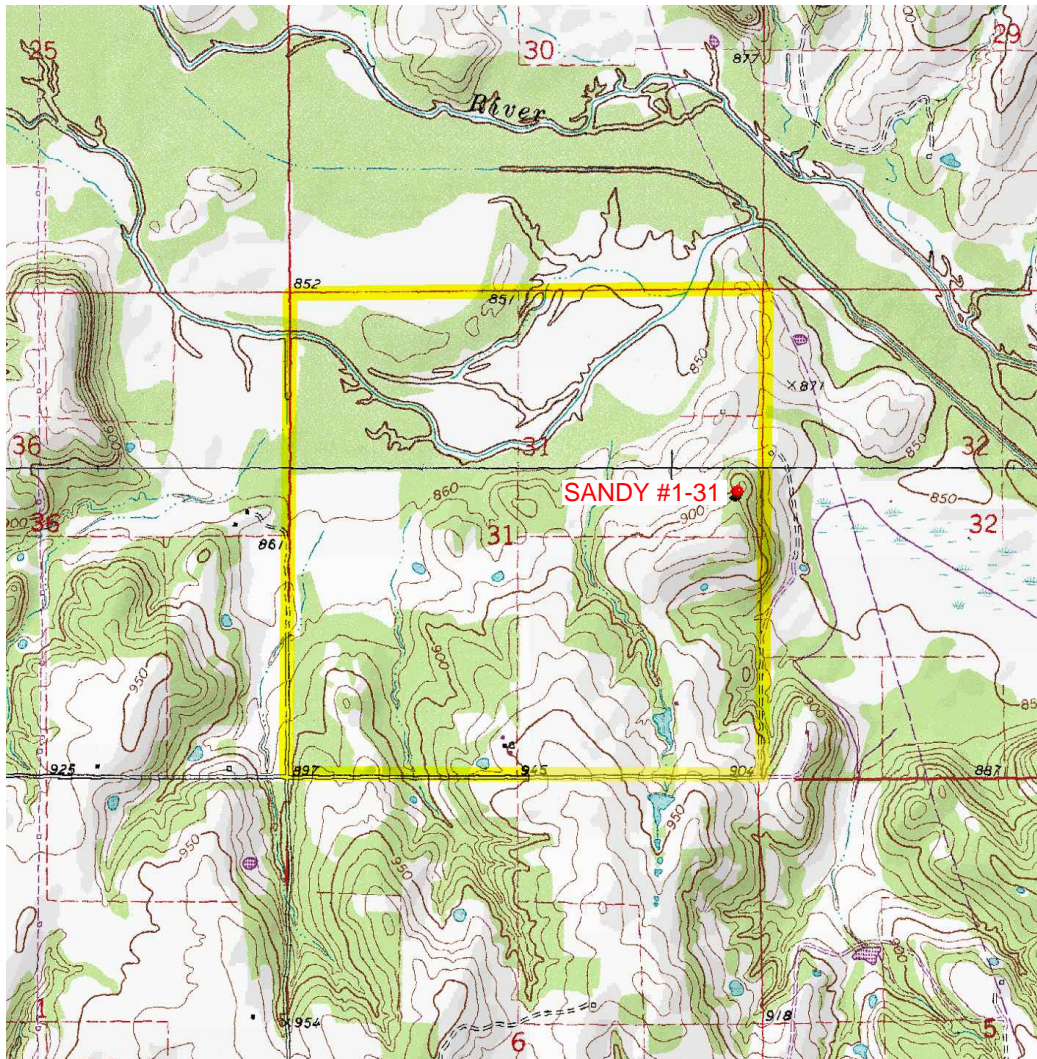

Provided by:

Arkoma Surveying and Mapping, PLLC

P.O. Box 238 Wilburton, OK 74578

Ph. 918-465-5711 Fax 918-465-5030

Certificate of Authorization No. 5348

Expires June 30, 2022

Date Staked: 08/27/2021

The purpose of this map is to verify the location and elevation as staked on the ground and to show the surrounding Topographic features. The footage shown hereon is only as SCALED onto a U.S.G.S. Topographic Map.

Please note that this location was staked carefully on the ground under the supervision of a Licensed Professional Land Surveyor, but the accuracy of this survey is not guaranteed.

Please contact Arkoma Surveying and Mapping promptly if any inconsistency is determined.

County Highway Vicinity Map

Job #: 9516-A

Operator: REACH OIL AND GAS COMPANY, INC.

Lease Name and No.: SANDY #1-31

Accessibility: From the West.

Directions: From Maud, OK, go 1.0 mile East on State Highway 59, 1.0 mile South on State Highway 9A, 3.0 miles East on "EW 1310 Rd.", then 0.6 mile North on "NS 3540 Rd." to the location on your left.

1 inch = 0.5 mile

provided by,
Arkoma Surveying and Mapping, PLLC
P.O. Box 238 Wilburton, OK 74578
Ph. 918-465-5711 Fax 918-465-5030
Certificate of Authorization No. 5348
Expires June 30, 2022

