

OKLAHOMA CORPORATION COMMISSION
OIL & GAS CONSERVATION DIVISION
P.O. BOX 52000
OKLAHOMA CITY, OK 73152-2000
(Rule 165:10-3-1)

API NUMBER: 087 22144 A

Approval Date: 06/11/2018

Expiration Date: 12/11/2018

Horizontal Hole Oil & Gas
Multi Unit

Amend reason: SHL

AMEND PERMIT TO DRILL

WELL LOCATION: Sec: 07 Twp: 9N Rge: 4W County: MCCLAIN

SPOT LOCATION: ☐ NW ☐ SE ☐ NE ☐ NW FEET FROM QUARTER: FROM NORTH FROM WEST

SECTION LINES: 890 2235

Lease Name: NIGHTHAWK Well No: 0718 1H Well will be 890 feet from nearest unit or lease boundary.

Operator EOG RESOURCES INC
Name:

Telephone: 4052463224

OTC/OCC Number: 16231 0

EOG RESOURCES INC
3817 NW EXPRESSWAY STE 500
OKLAHOMA CITY, OK 73112-1483

MCMURTRY MANAGEMENT & INVESTMENTS LLC
PO BOX 850467
THOMAS E MCMURTRY, MANAGING MEMBER
YUKON OK 73085-

Formation(s) (Permit Valid for Listed Formations Only):

	Name	Depth	Name	Depth
1	MISSISSIPPIAN	8985	6	
2	WOODFORD	9040	7	
3	HUNTON	9190	8	
4			9	
5			10	

Spacing Orders: 632844
682713
686043

Location Exception Orders: 686044

Increased Density Orders:

Pending CD Numbers:

Special Orders:

Total Depth: 19629

Ground Elevation: 1354

Surface Casing: 1500

Depth to base of Treatable Water-Bearing FM: 1100

Under Federal Jurisdiction: No

Fresh Water Supply Well Drilled: No

Surface Water used to Drill: Yes

PIT 1 INFORMATION

Approved Method for disposal of Drilling Fluids:

Type of Pit System: CLOSED Closed System Means Steel Pits

Type of Mud System: WATER BASED

Chlorides Max: 5000 Average: 3000

Is depth to top of ground water greater than 10ft below base of pit? Y

Within 1 mile of municipal water well? N

Wellhead Protection Area? N

Pit is located in a Hydrologically Sensitive Area.

Category of Pit: C

Liner not required for Category: C

Pit Location is BED AQUIFER

Pit Location Formation: DUNCAN

D. One time land application -- (REQUIRES PERMIT) PERMIT NO: 18-34705

E. Haul to Commercial pit facility: Sec. 31 Twn. 12N Rng. 8W Cnty. 17 Order No: 587498

H. SEE MEMO

This permit does not address the right of entry or settlement of surface damages.

The duration of this permit is SIX MONTHS, except as otherwise provided by Rule 165: 10-3-1.

Rule 165: 10-3-4 (c) (7) (e) - The Operator shall give 24 Hours notice by telephone to the appropriate District Office of the Conservation Division as to when Surface Casing will be run.

PIT 2 INFORMATION

Type of Pit System: CLOSED Closed System Means Steel Pits

Type of Mud System: OIL BASED

Chlorides Max: 300000 Average: 200000

Is depth to top of ground water greater than 10ft below base of pit? Y

Within 1 mile of municipal water well? N

Wellhead Protection Area? N

Pit is located in a Hydrologically Sensitive Area.

Category of Pit: C

Liner not required for Category: C

Pit Location is BED AQUIFER

Pit Location Formation: DUNCAN

HORIZONTAL HOLE 1

Sec 18 Twp 9N Rge 4W County MCCLAIN

Spot Location of End Point: S2 SW SW SW

Feet From: SOUTH 1/4 Section Line: 165

Feet From: WEST 1/4 Section Line: 330

Depth of Deviation: 8541

Radius of Turn: 530

Direction: 190

Total Length: 10256

Measured Total Depth: 19629

True Vertical Depth: 9409

End Point Location from Lease,
Unit, or Property Line: 165

Notes:

Category

Description

DEEP SURFACE CASING

6/1/2018 - G71 - APPROVED; NOTIFY OCC FIELD INSPECTOR IMMEDIATELY OF ANY LOSS OF CIRCULATION OR FAILURE TO CIRCULATE CEMENT TO SURFACE ON ANY CONDUCTOR OR SURFACE CASING

HYDRAULIC FRACTURING

6/1/2018 - G71 - OCC 165:10-3-10 REQUIRES:

1) PRIOR TO COMMENCEMENT OF HYDRAULIC FRACTURING OPERATIONS FOR HORIZONTAL WELLS, NOTICE GIVEN FIVE BUSINESS DAYS IN ADVANCE TO OFFSET OPERATORS WITH WELLS COMPLETED IN THE SAME COMMON SOURCE OF SUPPLY WITHIN 1/2 MILE;

2) WITH NOTICE ALSO GIVEN 48 HOURS IN ADVANCE OF HYDRAULIC FRACTURING ALL WELLS TO BOTH THE OCC CENTRAL OFFICE AND LOCAL DISTRICT OFFICES, USING THE "FRAC NOTICE FORM" FOUND AT THE FOLLOWING LINK: OCCEWEB.COM/OG/OGFORMS.HTML; AND,

3) THE CHEMICAL DISCLOSURE OF HYDRAULIC FRACTURING INGREDIENTS FOR ALL WELLS TO BE REPORTED TO FRACFOCUS WITHIN 60 DAYS AFTER THE CONCLUSION THE HYDRAULIC FRACTURING OPERATIONS, USING THE FOLLOWING LINK: FRACFOCUS.ORG

LOCATION EXCEPTION - 686044

3/27/2019 - G58 - (I.O.) 7 & 18-9N-4W
X632844 MSSP, WDFD, HNTN (7-9N-4W)
X682713 MSSP, WDFD, HNTN (18-9N-4W)
COMPL. INT. (7-9N-4W) NCT 165' FNL, NCT 0' FSL, NCT 330' FWL
COMPL. INT. (18-9N-4W) NCT 165' FSL, NCT 0' FNL, NCT 330' FWL
EOG RESOURCES, INC.
11/5/2018

MEMO

6/1/2018 - G71 - PIT 1 & 2 - CLOSED SYSTEM=STEEL PITS PER OPERATOR REQUEST; PIT 1 - WBM & CUTTINGS TO BE SOIL FARMED; PIT 2 - OBM CUTTINGS TO R360 (ORDER # 587498) OR DEQ APPROVED FACILITY (SOUTHERN PLAINS LANDFILL, 3-5N-6W, GRADY CO., # 3526013); PIT 2 - OBM TO VENDOR

This permit does not address the right of entry or settlement of surface damages.

The duration of this permit is SIX MONTHS, except as otherwise provided by Rule 165: 10-3-1.

Rule 165: 10-3-4 (c) (7) (e) - The Operator shall give 24 Hours notice by telephone to the appropriate District Office of the Conservation Division as to when Surface Casing will be run.

087 22144 NIGHTHAWK 0718 1H

Category	Description
SPACING - 632844	6/11/2018 - G58 - (640) 7-9N-4W VAC 140574 HNTN EXT 61142 MSSP, WDFD, HNTN, OTHERS
SPACING - 682713	3/27/2019 - G58 - (640)(HOR) 18-9N-4W EXT 664083 MSSP, WDFD, HNTN COMPL. INT. (MSSP, HNTN) NCT 660' FB COMPL. INT. (WDFD) NCT 165' FNL & FSL, NCT 330' FEL & FWL (EXIST CONCURRENTLY WITH NON-HORIZONTAL DRILLING AND SPACING UNITS)
SPACING - 686043	3/27/2019 - G58 - (I.O.) 7 & 18-9N-4W EST MULTIUNIT HORIZONTAL WELL X632844 MSSP, WDFD, HNTN (7-9N-4W) X682713 MSSP, WDFD, HNTN (18-9N-4W) 50% 7-9N-4W 50% 18-9N-4W EOG RESOURCES, INC. 11/5/2018

This permit does not address the right of entry or settlement of surface damages.
The duration of this permit is SIX MONTHS, except as otherwise provided by Rule 165: 10-3-1.
Rule 165: 10-3-4 (c) (7) (e) - The Operator shall give 24 Hours notice by telephone to the appropriate District
Office of the Conservation Division as to when Surface Casing will be run.

13800 WIRELESS WAY, OKLA. CITY, OKLA. 73134 • LOCAL (405) 843-4847 • OUT OF STATE (800) 654-3219
Certificate of Authorization No. 1293 LS
McCLAIN County, Oklahoma

McCLAIN County, Oklahoma
890'FNL - 2235'FWL Section 7 Township 9N Range 4W I.M.

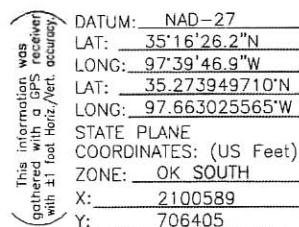

Invoice # 304725 Date of Drawing: Oct. 11, 2018
Date Staked: Oct. 10, 2018 RKM/TR

I, Thomas L. Howell an Oklahoma Licensed Land Surveyor and an authorized agent of Topographic Land Surveyors of Oklahoma, do hereby certify to the information shown herein

Thomas L. Hawco
Oklahoma Lic. No. 1433

