

OKLAHOMA CORPORATION COMMISSION
OIL & GAS CONSERVATION DIVISION
P.O. BOX 52000
OKLAHOMA CITY, OK 73152-2000
(Rule 165:10-3-1)

API NUMBER: 037 29434

Approval Date: 09/05/2019

Expiration Date: 03/05/2021

Straight Hole

Oil & Gas

PERMIT TO DRILL

WELL LOCATION: Sec: 32 Twp: 19N Rge: 7E

County: CREEK

SPOT LOCATION: ☐ SW ☐ NW ☐ NW ☐ SE

FEET FROM QUARTER: FROM NORTH FROM WEST

SECTION LINES: 371 215

Lease Name: TERRAIN

Well No: 2-32

Well will be 215 feet from nearest unit or lease boundary.

Operator Name: TERRAIN ENERGY LLC

Telephone: 2149064413

OTC/OCC Number: 24319 0

TERRAIN ENERGY LLC
PO BOX 600013
DALLAS, TX 75360-0013

TERRAIN ENERGY LLC
PO BOX 600013
DALLAS TX 74360

Formation(s) (Permit Valid for Listed Formations Only):

	Name	Depth		Name	Depth
1	CLEVELAND	1940	6	SKINNER LOW	2550
2	BIG LIME-OSWEGO	2335	7	RED FORK	2650
3	PRUE	2420	8	BARTLESVILLE	2725
4	BURGESS	2445	9	1ST WILCOX	2982
5	SKINNER UP	2490	10	2ND WILCOX	3000

Spacing Orders: 182989

Location Exception Orders:

Increased Density Orders:

Pending CD Numbers: 201904215

Special Orders:

Total Depth: 3500

Ground Elevation: 849

Surface Casing: 630

Depth to base of Treatable Water-Bearing FM: 580

Under Federal Jurisdiction: No

Fresh Water Supply Well Drilled: No

Surface Water used to Drill: No

PIT 1 INFORMATION

Approved Method for disposal of Drilling Fluids:

Type of Pit System: CLOSED Closed System Means Steel Pits

Type of Mud System: WATER BASED

Chlorides Max: 2500 Average: 1500

Is depth to top of ground water greater than 10ft below base of pit? Y

Within 1 mile of municipal water well? Y

Wellhead Protection Area? Y

Pit is located in a Hydrologically Sensitive Area.

Category of Pit: C

Liner not required for Category: C

Pit Location is AP/TE DEPOSIT

Pit Location Formation: TERRACE

D. One time land application -- (REQUIRES PERMIT)

PERMIT NO: 19-36934

H. CLOSED SYSTEM=STEEL PITS PER OPERATOR REQUEST

Notes:

This permit does not address the right of entry or settlement of surface damages.

037 29434 TERRAIN 2-32

The duration of this permit is SIX MONTHS, except as otherwise provided by Rule 165: 10-3-1.

Rule 165: 10-3-4 (c) (7) (e) - The Operator shall give 24 Hours notice by telephone to the appropriate District Office of the Conservation Division as to when Surface Casing will be run.

Category	Description
HYDRAULIC FRACTURING	<p>8/28/2019 - G71 - OCC 165:10-3-10 REQUIRES:</p> <p>1) PRIOR TO COMMENCEMENT OF HYDRAULIC FRACTURING OPERATIONS FOR HORIZONTAL WELLS, NOTICE GIVEN FIVE BUSINESS DAYS IN ADVANCE TO OFFSET OPERATORS WITH WELLS COMPLETED IN THE SAME COMMON SOURCE OF SUPPLY WITHIN 1/2 MILE;</p> <p>2) WITH NOTICE ALSO GIVEN 48 HOURS IN ADVANCE OF HYDRAULIC FRACTURING ALL WELLS TO BOTH THE OCC CENTRAL OFFICE AND LOCAL DISTRICT OFFICES, USING THE "FRAC NOTICE FORM" FOUND AT THE FOLLOWING LINK: OCCEWEB.COM/OG/OGFORMS.HTML; AND,</p> <p>3) THE CHEMICAL DISCLOSURE OF HYDRAULIC FRACTURING INGREDIENTS FOR ALL WELLS TO BE REPORTED TO FRACFOCUS WITHIN 60 DAYS AFTER THE CONCLUSION THE HYDRAULIC FRACTURING OPERATIONS, USING THE FOLLOWING LINK: FRACFOCUS.ORG</p>
PENDING CD - 201904215	<p>9/5/2019 - G56 - (E.O.) NW4 SE4 32-19N-7E X182989 CLVD, BGLO, PRUE, SKNRU, SKNRL, RDFK, BRVL, WLCX1, WLCX2, BRGS, OTHERS COMPL INT 371' FNL, 215' FWL TERRAIN ENERGY, LLC REC 8/26/2019 (MOORE)</p>
PUBLIC WATER SUPPLY WELL	<p>8/28/2019 - G71 - OILTON - 1 PWS/WPA, SE/4 32-19N-7E</p>
SPACING - 182989	<p>9/5/2019 - G56 - (40) N2 S2 32-19N-7E MOD OTHERS EXT OTHERS VAC 28933 SKNR, RDFK EXT 54067/176079 SKNRL, RDFK EXT 179220 CLVD, BGLO, PRUE, BRVL, WLCX1, WLCX2, SKNRU, BRGS, OTHERS</p>

WELL LOCATION FOR: Terrain Energy, LLC

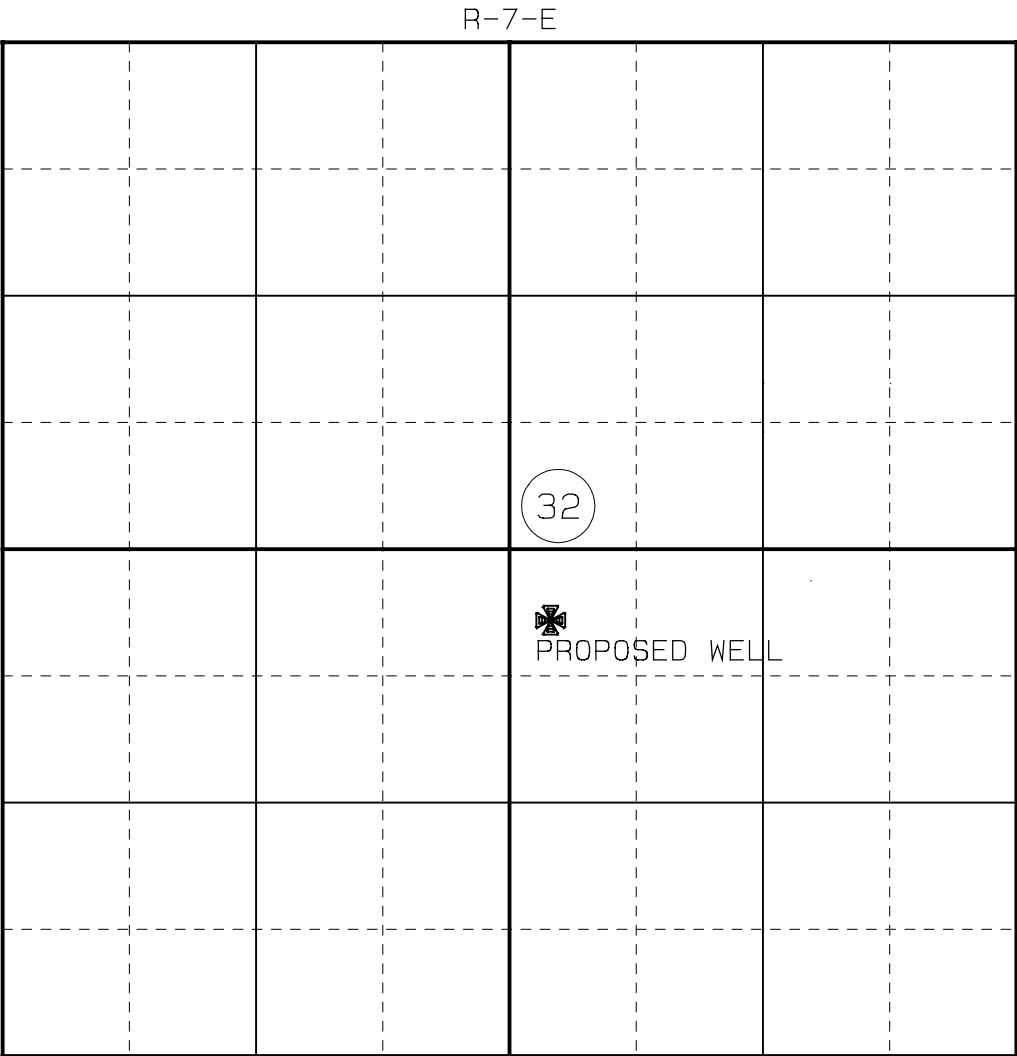

037-29434

PROPOSED WELL
371' F.N.L. &
215' F.W.L SE/4
ELEV 849'

ALL WELLS IN
SEC 32-T19N-R7E

DUE CARE AND DILIGENCE HAVE BEEN EXERCISED IN THE
STAKING OF THIS WELL LOCATION ON THE GROUND
ACCORDING TO THE BEST OFFICIAL RECORDS AND MAPS
AVAILABLE TO US.
PLEASE REVIEW THIS PLAT AND NOTIFY US IMMEDIATELY
OF ANY DISCREPANCY

PENNCO LAND SURVEYING
P.O. BOX 52, SAPULPA, OK, 74067
(918) -367-2942; penncosurveying@yahoo.com
CA# 2074; PenncoLandSurveying.com

DATE OF LAST SITE VISIT: 7-24-19
DATE OF REVISIONS: