

API NUMBER: 049 25332

OKLAHOMA CORPORATION COMMISSION  
OIL & GAS CONSERVATION DIVISION  
P.O. BOX 52000  
OKLAHOMA CITY, OK 73152-2000  
(Rule 165:10-3-1)

Approval Date: 11/05/2020  
Expiration Date: 05/05/2022

Straight Hole Disposal

## PERMIT TO DRILL

WELL LOCATION: Section: 14 Township: 1N Range: 3W County: GARVIN

SPOT LOCATION: ☐ NE ☐ NE ☐ NW ☐ NE FEET FROM QUARTER: FROM NORTH FROM EAST  
SECTION LINES: 145 1420

Lease Name: DOUGLAS Well No: 8 Well will be 145 feet from nearest unit or lease boundary.  
Operator Name: DUNN'S OIL AND GAS LEASE MANAGEMENT Telephone: 5803194377 OTC/OCC Number: 24452 0

DUNN'S OIL AND GAS LEASE MANAGEMENT LLC  
224 N ROCKFORD RD STE B  
ARDMORE, OK 73401-2550

DUNN'S OIL AND GAS LEASE MANAGEMENT LLC  
224 NORTH ROCKFORD RD STE B  
ARDMORE OK 73401-2550

Formation(s) (Permit Valid for Listed Formations Only):

Name	Code	Depth
1 HOXBAR	405HXBR	2000

Spacing Orders: No Spacing

Location Exception Orders: No Exceptions

Increased Density Orders: No Density Orders

Pending CD Numbers: No Pending

Working interest owners' notified: \*\*\*

Special Orders: No Special Orders

Total Depth: 2500 Ground Elevation: 976

Surface Casing: 860

Depth to base of Treatable Water-Bearing FM: 760

Under Federal Jurisdiction: No  
Fresh Water Supply Well Drilled: No  
Surface Water used to Drill: No

### Approved Method for disposal of Drilling Fluids:

F. Haul to Commercial soil farming facility	Sec. 28 Twn. 2N Rng. 4W Cnty. 137 Order No: 665063
H. (Other)	CLOSED SYSTEM=STEEL PITS (REQUIRED - SALT CREEK)

### PIT 1 INFORMATION

Type of Pit System: CLOSED Closed System Means Steel Pits  
Type of Mud System: WATER BASED  
Chlorides Max: 5000 Average: 3000

Is depth to top of ground water greater than 10ft below base of pit? Y

Within 1 mile of municipal water well? N

Wellhead Protection Area? N

Pit is located in a Hydrologically Sensitive Area.

Category of Pit: C

Liner not required for Category: C

Pit Location is: BED AQUIFER

Pit Location Formation: GARBER

### NOTES:

This permit does not address the right of entry or settlement of surface damages. The duration of this permit is 18 MONTHS, except as otherwise provided by Rule 165: 10-3-1. Rule 165: 10-3-4 (c) (7) (e) - The Operator shall give 24 Hours notice by telephone to the appropriate District Office of the Conservation Division as to when Surface Casing will be run.

Category	Description
HYDRAULIC FRACTURING	<p>[11/2/2020 - GC2] - OCC 165:10-3-10 REQUIRES:</p> <p>1) NOTICE SHALL BE GIVEN AT LEAST 5 BUSINESS DAYS PRIOR TO COMMENCEMENT OF HYDRAULIC FRACTURING OPERATIONS ON A HORIZONTAL WELL TO OPERATORS PRODUCING WELLS WITHIN 1 MILE OF THE COMPLETION INTERVAL OF THE SUBJECT WELL. THE NOTICE TO SUCH OPERATORS SHALL CONTAIN THE INFORMATION IN FORM 6000NOO. IF THE HYDRAULIC FRACTURING OPERATIONS SCHEDULE CHANGES AFTER NOTICE HAS BEEN PROVIDED, RESULTING IN A DELAY OF OPERATIONS OF MORE THAN 5 DAYS FROM THE INITIAL NOTICE, NEW NOTICE IS REQUIRED TO BE GIVEN;</p> <p>2) NOTICE WILL BE GIVEN TO THE OCC CENTRAL OFFICE AND LOCAL DISTRICT OFFICES AT LEAST 48 HOURS PRIOR TO COMMENCEMENT OF HYDRAULIC FRACTURING OPERATIONS. FORM 6000NHF SHALL BE USED AND IS FOUND AT THIS LINK: <a href="http://OCCEWEB.COM/OG/OGFORMS.HTML">OCCEWEB.COM/OG/OGFORMS.HTML</a>; AND,</p> <p>3) THE CHEMICAL DISCLOSURE OF HYDRAULIC FRACTURING INGREDIENTS FOR ALL WELLS IS TO BE REPORTED TO FRACFOCUS WITHIN 60 DAYS AFTER THE CONCLUSION OF HYDRAULIC FRACTURING OPERATIONS, FOUND AT <a href="http://FRACFOCUS.ORG">FRACFOCUS.ORG</a></p>
SPACING	[11/2/2020 - GC2] - N/A DISPOSAL WELL

**WELL LOCATION PLAT**

Company Name **DUNN'S OIL & GAS LEASE MANAGEMENT, LLC**  
 Lease Name: Douglas No 8 SWDW

Section 14 Township 1 N Range 3 W I.B.M. County of Garvin. State of Oklahoma

Elevation Good Location?  
 Original Location: 145' FNL - 1420' FEL NE/4 975' GROUND YES

Topography: PASTURE, 108' EAST AND 50' NORTH OF PUMPJACK (GRADY DOUGLAS No 3), 35' EAST OF N/S PIPELINE, 50' SOUTH OF E/W OVER HEAD POWER LINE.

Best Accessibility to Location From the South

Distance & Direction From Highway or Town: From jct of SH 29 & SH 76 South, go 4.0 miles South on SH. 76 South; Then go East 1 mile on E1690 Road to the NW Corner of Section 14, T1N. R3W.

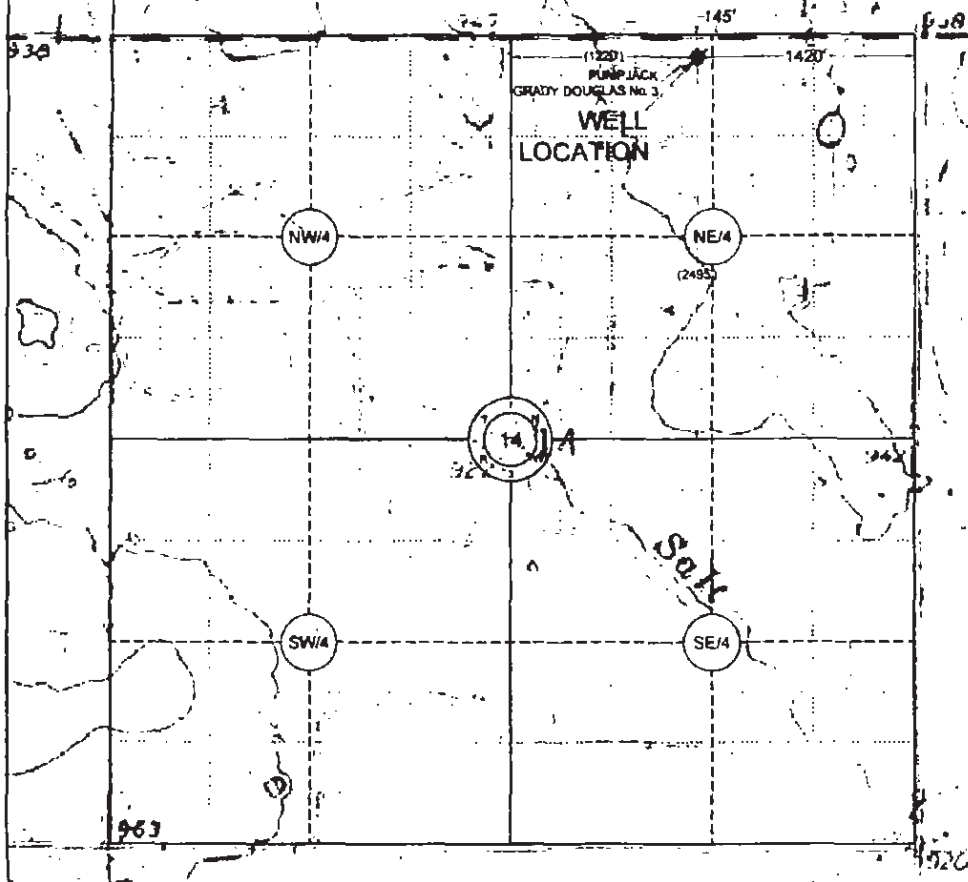

SCALE 1" = 1000'

Were Pipelines Located?

Yes ☐ No ☐

See Attached?

Yes ☐ No ☐

This location has been staked according to the best official survey records available to us, but its accuracy is not guaranteed. Please review this plat and notify us immediately of any discrepancy.

The distances shown in parentheses ( ) are Calculated distances based on the Quarter Section being 2640' and have not been measured.

FROM G.P.S.

Latitude: 34°33'52.54" Longitude 97°28'48.28"

State Plane Coordinates:

Zone \_\_\_\_\_  
 X \_\_\_\_\_  
 Y \_\_\_\_\_

GARVIN COUNTY, OKLAHOMA

**CERTIFICATE:**

I Aaron L. Morris a Registered Land Surveyor in the State Of Oklahoma, do hereby certify that the above described Well Location was surveyed and staked on the ground as shown R.P.L.S. # 1477

*Aaron L. Morris* 10/19/2020

Aaron L. Morris R.P.L.S. No.1477  
 Phone (580) 226-5108  
 Fax (888) 662-7778  
 510 E Street N.W.  
 Ardmore, OK 73401

© COPYRIGHT 2016 Bennett, Morris And Associates Land Surveying, P.C. - C.A. No. 5975 (LS)

SCALE: 1in = 1000ft	SITE VISIT (Number Date and Explanation) 1 10/19/2020 FIELD SURVEY
DATE 10/19/2020	
DRAWING AND PROJECT NUMBER	REVISIONS (Number Date and Explanation)

**DUNN'S OIL & GAS LEASE  
 MANAGEMENT, LLC**  
 ARDMORE, OK 73401

SURVEYING AND MAPPING BY

