

OKLAHOMA CORPORATION COMMISSION  
OIL & GAS CONSERVATION DIVISION  
P.O. BOX 52000  
OKLAHOMA CITY, OK 73152-2000  
(Rule 165:10-3-1)

API NUMBER: 073 26457

Approval Date: 02/21/2019

Expiration Date: 08/21/2020

Horizontal Hole  
Multi Unit

Oil & Gas

PERMIT TO DRILL

WELL LOCATION: Sec: 07 Twp: 15N Rge: 7W County: KINGFISHER

SPOT LOCATION: ☐ SE ☐ SE ☐ SW ☐ SW FEET FROM QUARTER: FROM SOUTH FROM WEST

SECTION LINES: 225 1150

Lease Name: PETTY FIU 1507 Well No: 3H-6X Well will be 225 feet from nearest unit or lease boundary.

Operator Name: NEWFIELD EXPLORATION MID-CON INC

Telephone: 2812105100; 9188781

OTC/OCC Number: 20944 0

NEWFIELD EXPLORATION MID-CON INC  
24 WATERWAY AVE ST 900  
THE WOODLANDS, TX 77380-2764

VIRGINIA A. PETTY  
11798 E. 850 ROAD  
OKARCHE OK 73762

Formation(s) (Permit Valid for Listed Formations Only):

	Name	Depth	Name	Depth
1	MISSISSIPPIAN	8402	6	
2	WOODFORD	8935	7	
3			8	
4			9	
5			10	

Spacing Orders: 643447  
690856

Location Exception Orders: 690857  
690865

Increased Density Orders: 689326  
689327

Pending CD Numbers:

Special Orders:

Total Depth: 18892

Ground Elevation: 1117

**Surface Casing: 1500**

Depth to base of Treatable Water-Bearing FM: 320

Under Federal Jurisdiction: No

Fresh Water Supply Well Drilled: No

Surface Water used to Drill: No

PIT 1 INFORMATION

Approved Method for disposal of Drilling Fluids:

Type of Pit System: CLOSED Closed System Means Steel Pits

Type of Mud System: WATER BASED

Chlorides Max: 5000 Average: 3000

Is depth to top of ground water greater than 10ft below base of pit? Y

Within 1 mile of municipal water well? N

Wellhead Protection Area? N

Pit is located in a Hydrologically Sensitive Area.

Category of Pit: C

Liner not required for Category: C

Pit Location is BED AQUIFER

Pit Location Formation: DUNCAN

D. One time land application -- (REQUIRES PERMIT) PERMIT NO: 19-36236

E. Haul to Commercial pit facility: Sec. 31 Twn. 12N Rng. 8W Cnty. 17 Order No: 587498

H. SEE MEMO

This permit does not address the right of entry or settlement of surface damages.

The duration of this permit is SIX MONTHS, except as otherwise provided by Rule 165: 10-3-1.

Rule 165: 10-3-4 (c) (7) (e) - The Operator shall give 24 Hours notice by telephone to the appropriate District Office of the Conservation Division as to when Surface Casing will be run.

PIT 2 INFORMATION

Type of Pit System: CLOSED Closed System Means Steel Pits

Type of Mud System: OIL BASED

Chlorides Max: 300000 Average: 200000

Is depth to top of ground water greater than 10ft below base of pit? Y

Within 1 mile of municipal water well? N

Wellhead Protection Area? N

Pit is located in a Hydrologically Sensitive Area.

Category of Pit: C

Liner not required for Category: C

Pit Location is BED AQUIFER

Pit Location Formation: DUNCAN

HORIZONTAL HOLE 1

Sec 06 Twp 15N Rge 7W County KINGFISHER

Spot Location of End Point: NE NW NE NW

Feet From: NORTH 1/4 Section Line: 85

Feet From: WEST 1/4 Section Line: 1927

Depth of Deviation: 8000

Radius of Turn: 368

Direction: 5

Total Length: 10314

Measured Total Depth: 18892

True Vertical Depth: 8935

End Point Location from Lease,  
Unit, or Property Line: 85

Notes:

Category

Description

DEEP SURFACE CASING

2/8/2019 - G71 - APPROVED; NOTIFY OCC FIELD INSPECTOR IMMEDIATELY OF ANY LOSS OF CIRCULATION OR FAILURE TO CIRCULATE CEMENT TO SURFACE ON ANY CONDUCTOR OR SURFACE CASING

HYDRAULIC FRACTURING

2/8/2019 - G71 - OCC 165:10-3-10 REQUIRES:

1) PRIOR TO COMMENCEMENT OF HYDRAULIC FRACTURING OPERATIONS FOR HORIZONTAL WELLS, NOTICE GIVEN FIVE BUSINESS DAYS IN ADVANCE TO OFFSET OPERATORS WITH WELLS COMPLETED IN THE SAME COMMON SOURCE OF SUPPLY WITHIN 1/2 MILE;

2) WITH NOTICE ALSO GIVEN 48 HOURS IN ADVANCE OF HYDRAULIC FRACTURING ALL WELLS TO BOTH THE OCC CENTRAL OFFICE AND LOCAL DISTRICT OFFICES, USING THE "FRAC NOTICE FORM" FOUND AT THE FOLLOWING LINK: [OCCEWEB.COM/OG/OGFORMS.HTML](http://OCCEWEB.COM/OG/OGFORMS.HTML); AND,

3) THE CHEMICAL DISCLOSURE OF HYDRAULIC FRACTURING INGREDIENTS FOR ALL WELLS TO BE REPORTED TO FRACFOCUS WITHIN 60 DAYS AFTER THE CONCLUSION THE HYDRAULIC FRACTURING OPERATIONS, USING THE FOLLOWING LINK: [FRACFOCUS.ORG](http://FRACFOCUS.ORG)

INCREASED DENSITY - 689326

2/20/2019 - G58 - 6-15N-7W  
X643447 MSSP  
6 WELLS  
NEWFIELD EXPLORATION MID-CONTINENT INC.  
1/7/2019

INCREASED DENSITY - 689327

2/20/2019 - G58 - 7-15N-7W  
X643447 MSSP  
6 WELLS  
NEWFIELD EXPLORATION MID-CONTINENT INC.  
1/7/2019

This permit does not address the right of entry or settlement of surface damages.

The duration of this permit is SIX MONTHS, except as otherwise provided by Rule 165: 10-3-1.

Rule 165: 10-3-4 (c) (7) (e) - The Operator shall give 24 Hours notice by telephone to the appropriate District Office of the Conservation Division as to when Surface Casing will be run.

073 26457 PETTY FIU 1507 3H-6X

Category	Description
LOCATION EXCEPTION - 690857	2/20/2019 - G58 - (I.O.) 6 & 7-15N-7W X643447 MSSP, WDFD COMPL. INT. 7-15N-7W NCT 0' FNL, NCT 165' FSL, NCT 1320' FWL COMPL. INT. 6-15N-7W NCT 0' FSL, NCT 165' FNL, NCT 1320' FWL NEWFIELD EXPLORATION MID-CONTINENT INC. 2/4/2019
LOCATION EXCEPTION - 690865	2/20/2019 - G58 - (I.O.) 6 & 7-15N-7W X165:10-3-28(C)(2)(B) MSSP, WDFD (PETTY FIU 1507 3H-6X) MAY BE CLOSER THAN 600' TO THE PETTY 1H-6X WELL MAY BE CLOSER THAN 600' TO PROPOSED WELL 2/4/2019
MEMO	2/8/2019 - G71 - PIT 1 & 2 - CLOSED SYSTEM = STEEL PITS PER OPERATOR REQUEST, WBM/CUTTINGS & OBM CUTTINGS CAPTURED IN STEEL HALF PITS, WBM CUTTINGS WILL BE SOIL FARMED, WBM & OBM CUTTINGS TRANSFERRED TO R360 587498 (31-12N-8W), CANADIAN CO, PIT 2 - OBM TO VENDOR
SPACING - 643447	2/20/2019 - G58 - (640)(HOR) 6 & 7-15N-7W VAC 37910 MCSTR 6 & 7-15N-7W VAC 248318 MSSLM 6-15N-7W VAC 256082 MSSLM 7-15N-7W EST MSSP, WDFD COMPL. INT. (MSSP) NLT 660' FB COMPL. INT. (WDFD) NLT 165' FNL & FSL, NLT 330' FEL & FWL
SPACING - 690856	2/20/2019 - G58 - (I.O.) 6 & 7-15N-7W EST MULTIUNIT HORIZONTAL WELL X643447 MSSP, WDFD (WDFD IS ADJACENT CSS TO MSSP) 50% 6-15N-7W 50% 7-15N-7W NEWFIELD EXPLORATION MID-CONTINENT INC. 2/4/2019

KINGFISHER

County, Oklahoma

225° FSL-1150° FWL Section 7 Township 15N Range 7W I.M.

PERMIT PLAT



0' 500' 1000'

NOTES:

- The information shown herein is for construction purposes ONLY.
- Section 7 is not within a flood zone.
- All bearings shown are Grid, NAD-27, Oklahoma North.
- Landing Point, Last Take Point, Bottom Hole, and Drill Path information provided by client listed, not surveyed.

SURFACE LOCATION

DATUM: NAD-27  
LAT: 35°47'03.2"N  
LONG: 97°59'26.2"W  
LAT: 35.784212°N  
LONG: 97.990599°W  
STATE PLANE  
COORDINATES: (US Feet)  
ZONE: OK NORTH  
X: 2002789  
Y: 285460

DATUM: NAD-83  
LAT: 35°47'03.3"N  
LONG: 97°59'27.3"W  
LAT: 35.784259°N  
LONG: 97.990929°W  
STATE PLANE  
COORDINATES: (US Feet)  
ZONE: OK NORTH  
X: 1971191  
Y: 285484

(This information was gathered with a GPS receiver with ±1 foot Horiz./Vert. accuracy.)

CERTIFICATE:

I, Thomas L. Howell an Oklahoma Licensed Land Surveyor and an authorized agent of Topographic Land Surveyors of Oklahoma, do hereby certify to the information shown herein

Oklahoma Lic. No. 1433

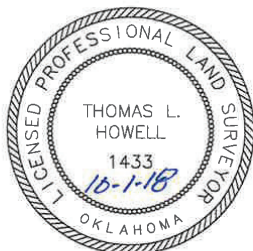

NAD-27  
X 2001639.17  
Y 285209.01  
NAD-83  
X 1970040.83  
Y 285232.77

Operator: NEWFIELD EXPLORATION

Lease Name: PETTY FIU 1507

Topography & Vegetation Loc. fell in sloping pasture.

Good Drill Site? Yes

Best Accessibility to Location From South off county road.

Distance & Direction

from Hwy Jct or Town From Okarche, OK, go ±4 miles North on US Hwy. 81,

then ±2.5 miles West to the SW Cor. of Sec. 7-T15-R7W.

Invoice # 300860A Well No.: 3H-6X

Date of Drawing: Sept. 27, 2018

Date Staked: Sept. 20, 2018

TR

ELEVATION:

1117' Gr. at Stake (NGVD29)

NAD-27  
X 2001628.34  
Y 295780.89  
NAD-83  
X 1970029.86  
Y 295804.66

NAD-27  
X 2004311.30  
Y 295830.33  
NAD-83  
X 1972712.82  
Y 295854.12

NAD-27  
X 2006964.92  
Y 295870.97  
NAD-83  
X 1975366.44  
Y 295894.77

NAD-27  
X 2001631.60  
Y 293147.86  
NAD-83  
X 1970033.16  
Y 293171.63

BOTTOM HOLE  
85° FNL-1927° FWL  
NAD-27 (US Feet)  
35°48'44.7"N  
97°59'16.8"W  
35.812430°N  
97.988011°W  
X= 2003555  
Y= 295731  
NAD-83 (US Feet)  
35°48'44.9"N  
97°59'18.0"W  
35.812476°N  
97.988341°W  
X= 1971957  
Y= 295755

NAD-27  
X 2006957.49  
Y 293240.20  
NAD-83  
X 1975359.05  
Y 293264.00

LAST TAKE POINT  
165° FNL-1927° FWL  
NAD-27 (US Feet)  
35°48'44.0"N  
97°59'16.8"W  
35.812210°N  
97.988011°W  
X= 2003556  
Y= 295651  
NAD-83 (US Feet)  
35°48'44.1"N  
97°59'18.0"W  
35.812256°N  
97.988341°W  
X= 1971957  
Y= 295675

NAD-27  
X 2001634.35  
Y 290517.40  
NAD-83  
X 1970035.95  
Y 290541.17

NAD-27  
X 2004306.19  
Y 290563.65  
NAD-83  
X 1972707.78  
Y 290587.43

NAD-27  
X 2006949.60  
Y 290609.45  
NAD-83  
X 1975351.19  
Y 290633.25

NAD-27  
X 2001636.80  
Y 287863.34  
NAD-83  
X 1970038.43  
Y 287887.10

NAD-27  
X 2006950.25  
Y 287967.22  
NAD-83  
X 1975351.87  
Y 287991.02

LANDING POINT  
165° FSL-1927° FWL  
NAD-27 (US Feet)  
35°47'02.7"N  
97°59'16.7"W  
35.784095°N  
97.987980°W  
X= 2003566  
Y= 285417  
NAD-83 (US Feet)  
35°47'02.9"N  
97°59'17.9"W  
35.784141°N  
97.988309°W  
X= 1971968  
Y= 285441

NAD-27  
X 2006951.15  
Y 285327.04  
NAD-83  
X 1975352.81  
Y 285350.83

NAD-27  
X 2004306.27  
Y 285269.02  
NAD-83  
X 1972707.93  
Y 285292.79