

OKLAHOMA CORPORATION COMMISSION  
OIL & GAS CONSERVATION DIVISION  
P.O. BOX 52000  
OKLAHOMA CITY, OK 73152-2000  
(Rule 165:10-3-1)

API NUMBER: 073 26558

Approval Date: 04/29/2019

Expiration Date: 10/29/2020

Horizontal Hole Oil & Gas

PERMIT TO DRILL

WELL LOCATION: Sec: 29 Twp: 19N Rge: 5W

County: KINGFISHER

SPOT LOCATION: ☐ NW ☐ SW ☐ SW ☐ SW

FEET FROM QUARTER: FROM SOUTH FROM WEST

SECTION LINES: 373 237

Lease Name: DONALD

Well No: 32-M2SH

Well will be 237 feet from nearest unit or lease boundary.

Operator Name: SK NEMAHA LLC

Telephone: 7133955141

OTC/OCC Number: 24221 0

SK NEMAHA LLC  
11700 KATY FWY STE 900  
HOUSTON, TX 77079--1222

TIMOTHY AND JANETTE MAGEE  
7525 NW 192ND  
EDMOND OK 73012

Formation(s) (Permit Valid for Listed Formations Only):

Name	Depth	Name	Depth
1 MISSISSIPPIAN	6716	6	
2		7	
3		8	
4		9	
5		10	

Spacing Orders: 654350  
672186

Location Exception Orders:

Increased Density Orders:

Pending CD Numbers: 201902354  
201902041

Special Orders:

Total Depth: 11666

Ground Elevation: 1066

**Surface Casing: 380**

Depth to base of Treatable Water-Bearing FM: 160

Under Federal Jurisdiction: No

Fresh Water Supply Well Drilled: No

Surface Water used to Drill: No

**PIT 1 INFORMATION**

Approved Method for disposal of Drilling Fluids:

Type of Pit System: CLOSED Closed System Means Steel Pits

Type of Mud System: WATER BASED

Chlorides Max: 5000 Average: 3000

Is depth to top of ground water greater than 10ft below base of pit? Y

Within 1 mile of municipal water well? N

Wellhead Protection Area? N

Pit is located in a Hydrologically Sensitive Area.

Category of Pit: C

Liner not required for Category: C

Pit Location is BED AQUIFER

Pit Location Formation: KINGMAN

D. One time land application -- (REQUIRES PERMIT) PERMIT NO: 19-36519  
H. CLOSED SYSTEM=STEEL PITS PER OPERATOR REQUEST

This permit does not address the right of entry or settlement of surface damages.

The duration of this permit is SIX MONTHS, except as otherwise provided by Rule 165: 10-3-1.

Rule 165: 10-3-4 (c) (7) (e) - The Operator shall give 24 Hours notice by telephone to the appropriate District Office of the Conservation Division as to when Surface Casing will be run.

HORIZONTAL HOLE 1

Sec 32 Twp 19N Rge 5W County KINGFISHER

Spot Location of End Point: SW SW SE SW

Feet From: SOUTH 1/4 Section Line: 165

Feet From: WEST 1/4 Section Line: 1370

Depth of Deviation: 5966

Radius of Turn: 477

Direction: 173

Total Length: 4950

Measured Total Depth: 11666

True Vertical Depth: 6716

End Point Location from Lease,  
Unit, or Property Line: 165

Notes:

Category

Description

HYDRAULIC FRACTURING

4/29/2019 - G71 - OCC 165:10-3-10 REQUIRES:

1) PRIOR TO COMMENCEMENT OF HYDRAULIC FRACTURING OPERATIONS FOR HORIZONTAL WELLS, NOTICE GIVEN FIVE BUSINESS DAYS IN ADVANCE TO OFFSET OPERATORS WITH WELLS COMPLETED IN THE SAME COMMON SOURCE OF SUPPLY WITHIN 1/2 MILE;

2) WITH NOTICE ALSO GIVEN 48 HOURS IN ADVANCE OF HYDRAULIC FRACTURING ALL WELLS TO BOTH THE OCC CENTRAL OFFICE AND LOCAL DISTRICT OFFICES, USING THE "FRAC NOTICE FORM" FOUND AT THE FOLLOWING LINK: [OCCEWEB.COM/OG/OGFORMS.HTML](http://OCCEWEB.COM/OG/OGFORMS.HTML); AND,

3) THE CHEMICAL DISCLOSURE OF HYDRAULIC FRACTURING INGREDIENTS FOR ALL WELLS TO BE REPORTED TO FRACFOCUS WITHIN 60 DAYS AFTER THE CONCLUSION THE HYDRAULIC FRACTURING OPERATIONS, USING THE FOLLOWING LINK: [FRACFOCUS.ORG](http://FRACFOCUS.ORG)

PENDING CD - 201902041

4/29/2019 - G56 - 32-19N-5W  
X654350/672186 MSSP  
3 WELLS  
NO OP NAMED  
REC 4/22/2019 (THOMAS)

PENDING CD - 201902354

4/29/2019 - G56 - (E.O.) 32-19N-5W  
X654350/672186 MSSP  
COMPL INT NCT 165' FSL, NCT 165' FNL, NCT 330' FWL  
NO OP NAMED  
REC 4/26/2019 (P. PORTER)

SPACING - 654350

4/29/2019 - G56 - (640)(HOR) 32-19N-5W  
VAC 43828/62761 MSSLM NE4, SE4, SW4  
EXT 648238 MSSP, OTHER  
POE TO BHL NCT 660' FB  
(COEXIST WITH NW4 SP # 44960/62761 MSSLM)

SPACING - 672186

4/29/2019 - G56 - NUNC PRO TUNC SP # 654350 TO CORRECT PARAGRAPH 5.1(A) STATING SP # 43828 WAS TO BE PARTIALLY VACATED, WHEN IN FACT SP # 44960 WAS THE ORDER TO BE PARTIALLY VACATED



# Well Location Plat

S.H.L. Sec. 29-19N-5W I.M.  
B.H.L. Sec. 32-19N-5W I.M.

Operator: SK NEMAHA  
Lease Name and No.: DONALD 32-M2SH  
Footage: 373' FSL - 237' FWL Gr. Elevation: 1066'  
Section: 29 Township: 19N Range: 5W I.M.  
County: Kingfisher State of Oklahoma  
Terrain at Loc.: Location fell in an open field.



All bearings shown  
are grid bearings.



1" = 1320'

GPS DATUM  
NAD 83  
NAD 27  
OK NORTH ZONE

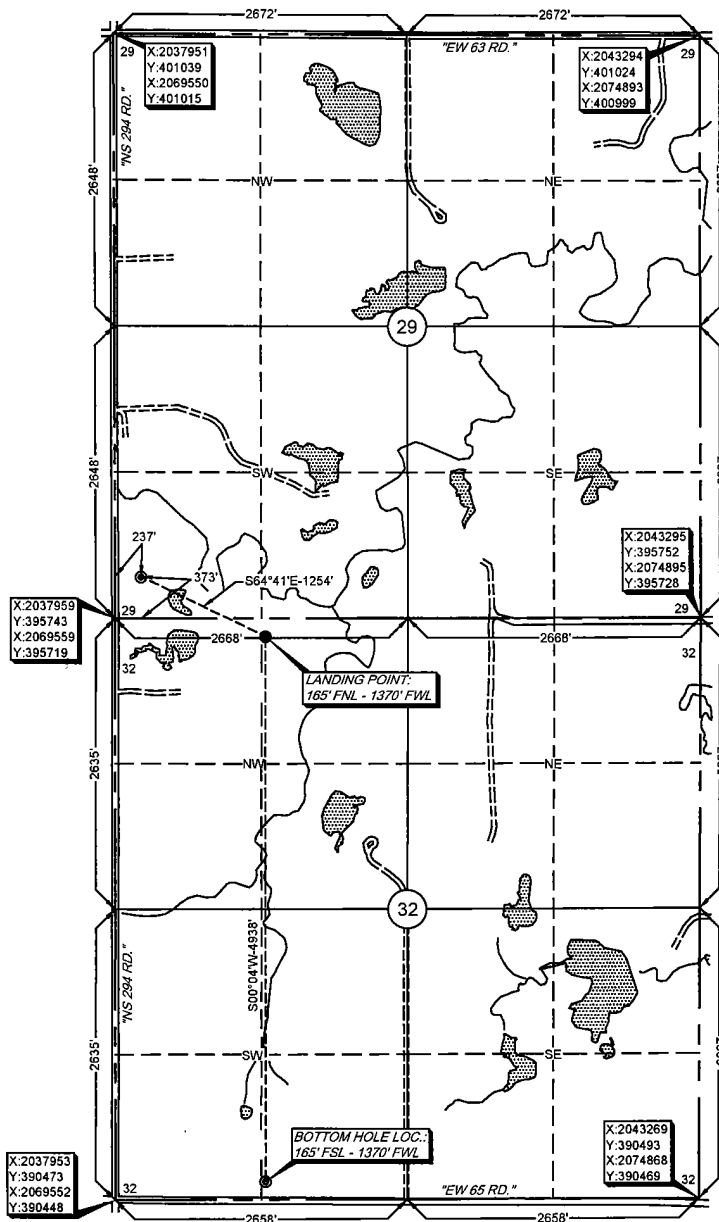

Surface Hole Loc.:  
Lat: 36°05'16.61"N  
Lon: 97°45'50.82"W  
Lat: 36.08794791  
Lon: -97.76411689  
X: 2038196  
Y: 396117

Surface Hole Loc.:  
Lat: 36°05'16.47"N  
Lon: 97°45'49.63"W  
Lat: 36.08790902  
Lon: -97.76378666  
X: 2069795  
Y: 396092

Landing Point:  
Lat: 36°05'11.28"N  
Lon: 97°45'37.03"W  
Lat: 36.08646789  
Lon: -97.76028528  
X: 2039329  
Y: 395581

Landing Point:  
Lat: 36°05'11.14"N  
Lon: 97°45'35.84"W  
Lat: 36.08642895  
Lon: -97.75995518  
X: 2070928  
Y: 395556

Bottom Hole Loc.:  
Lat: 36°04'22.45"N  
Lon: 97°45'37.25"W  
Lat: 36.07290405  
Lon: -97.76034618  
X: 2039323  
Y: 390643

Bottom Hole Loc.:  
Lat: 36°04'22.31"N  
Lon: 97°45'36.06"W  
Lat: 36.07286485  
Lon: -97.76001617  
X: 2070923  
Y: 390619

-Please note that this location was staked on the ground under the supervision of a Licensed Professional Land Surveyor, but the accuracy of this survey is not guaranteed. The location is based on GPS data as recorded from the GPS. -NOTE: X and Y data shown herein to Station Corners may NOT have been surveyed on-the-ground, and further, does NOT represent a true Boundary Survey. -Quarter section distances may be assumed from a Government Survey that Station Corners were surveyed on-the-ground, and further, does not represent a true boundary survey.

Survey and plat by:  
Arkoma Surveying and Mapping, PLLC  
P.O. Box 238 Wilburton, OK 74578  
Ph. 918-465-5711 Fax 918-465-5030  
Certificate of Authorization No. 5348  
Expires June 30, 2020

Invoice #8530-B  
Date Staked: 04/24/19 By: B.A.  
Date Drawn: 04/26/19 By: R.S.

## Certification:

This is to certify that this Well Location Plat represents the results of a survey made on the ground performed under the supervision of the undersigned.

LANCE G. MATHIS

04/26/19

OK LPLS 1664

