

OKLAHOMA CORPORATION COMMISSION  
OIL & GAS CONSERVATION DIVISION  
P.O. BOX 52000  
OKLAHOMA CITY, OK 73152-2000  
(Rule 165:10-3-1)

API NUMBER: 073 26517 A

Approval Date: 03/26/2019  
Expiration Date: 09/26/2020

Horizontal Hole Oil & Gas  
Multi Unit

Amend reason: CHANGE SHL AND BHL. UPDATE OCC ORDERS.

AMEND PERMIT TO DRILL

WELL LOCATION: Sec: 07 Twp: 16N Rge: 8W County: KINGFISHER  
SPOT LOCATION: ☐ SW ☐ SE ☐ SE ☐ SW FEET FROM QUARTER: FROM SOUTH FROM WEST  
SECTION LINES: 250 2003

Lease Name: YOST Well No: 1608 2H-18X Well will be 250 feet from nearest unit or lease boundary.  
Operator Name: NEWFIELD EXPLORATION MID-CON INC Telephone: 2812105100; 9188781 OTC/OCC Number: 20944 0

NEWFIELD EXPLORATION MID-CON INC  
4 WATERWAY AVE STE 100  
THE WOODLANDS, TX 77380-2764

SHERRY AND CHARLES WROBBEL  
905 PARK LANE  
KINGFISHER OK 73750

Formation(s) (Permit Valid for Listed Formations Only):

	Name	Depth	Name	Depth
1	WOODFORD	9355	6	
2	MISSISSIPPIAN	9620	7	
3			8	
4			9	
5			10	

Spacing Orders: 687616 Location Exception Orders: 687617 Increased Density Orders:  
614033 686483  
704635 705013  
705023

Pending CD Numbers: 201905770 Special Orders:  
201905771

Total Depth: 19555 Ground Elevation: 1178 Surface Casing: 1500 Depth to base of Treatable Water-Bearing FM: 360

Under Federal Jurisdiction: No Fresh Water Supply Well Drilled: No Surface Water used to Drill: No

PIT 1 INFORMATION

Approved Method for disposal of Drilling Fluids:

Type of Pit System: CLOSED Closed System Means Steel Pits

Type of Mud System: WATER BASED

Chlorides Max: 5000 Average: 3000

Is depth to top of ground water greater than 10ft below base of pit? Y

Within 1 mile of municipal water well? N

Wellhead Protection Area? N

Pit is located in a Hydrologically Sensitive Area.

Category of Pit: C

Liner not required for Category: C

Pit Location is AP/TE DEPOSIT

Pit Location Formation: TERRACE

D. One time land application -- (REQUIRES PERMIT) PERMIT NO: 19-37100  
E. Haul to Commercial pit facility: Sec. 31 Twn. 12N Rng. 8W Cnty. 17 Order No: 587498  
H. SEE MEMO

This permit does not address the right of entry or settlement of surface damages.  
The duration of this permit is 18 MONTHS, except as otherwise provided by Rule 165: 10-3-1.  
Rule 165: 10-3-4 (c) (7) (e) - The Operator shall give 24 Hours notice by telephone to the appropriate District  
Office of the Conservation Division as to when Surface Casing will be run.

## PIT 2 INFORMATION

Type of Pit System: CLOSED Closed System Means Steel Pits

Type of Mud System: OIL BASED

Chlorides Max: 300000 Average: 200000

Is depth to top of ground water greater than 10ft below base of pit? Y

Within 1 mile of municipal water well? N

Wellhead Protection Area? N

Pit is located in a Hydrologically Sensitive Area.

Category of Pit: C

Liner not required for Category: C

Pit Location is AP/TE DEPOSIT

Pit Location Formation: TERRACE

## HORIZONTAL HOLE 1

Sec 19 Twp 16N Rge 8W County KINGFISHER

Spot Location of End Point: SE SE SW SW

Feet From: SOUTH 1/4 Section Line: 85

Feet From: WEST 1/4 Section Line: 1241

Depth of Deviation: 8218

Radius of Turn: 715

Direction: 190

Total Length: 10214

Measured Total Depth: 19555

True Vertical Depth: 9620

End Point Location from Lease,  
Unit, or Property Line: 85

Additional Surface Owner	Address	City, State, Zip
DOROTHY DIANE MUSICK	7689 E 790 ROAD P.O BOX 777	KINGFISHER, OK 73750

### Notes:

#### Category

#### Description

#### DEEP SURFACE CASING

11/25/2019 - G71 - APPROVED; NOTIFY OCC FIELD INSPECTOR IMMEDIATELY OF ANY LOSS OF CIRCULATION OR FAILURE TO CIRCULATE CEMENT TO SURFACE ON ANY CONDUCTOR OR SURFACE CASING

#### EXCEPTION TO RULE - 686483 (201807734)

12/09/2019 - GB6 - (I.O.) 18 & 19-16N-8W  
X165:10-3-28(C)(2)(B) MSSP (YOST 1608 2H-18X)  
MAY BE CLOSER THAN 600' TO THE YOST 1608 1H-18X  
MAY BE CLOSER THAN 600' TO PROPOSED WELLS  
11/9/2018

#### EXCEPTION TO RULE - 705023 (201807734)

12/9/2019 - GB6 - EXTENSION OF ORDER # 686483 UNTIL 11/09/2020

#### HYDRAULIC FRACTURING

11/25/2019 - G71 - OCC 165:10-3-10 REQUIRES:

1) PRIOR TO COMMENCEMENT OF HYDRAULIC FRACTURING OPERATIONS FOR HORIZONTAL WELLS, NOTICE GIVEN FIVE BUSINESS DAYS IN ADVANCE TO OFFSET OPERATORS WITH WELLS COMPLETED IN THE SAME COMMON SOURCE OF SUPPLY WITHIN 1/2 MILE;

2) WITH NOTICE ALSO GIVEN 48 HOURS IN ADVANCE OF HYDRAULIC FRACTURING ALL WELLS TO BOTH THE OCC CENTRAL OFFICE AND LOCAL DISTRICT OFFICES, USING THE "FRAC NOTICE FORM" FOUND AT THE FOLLOWING LINK:  
[OCCWEB.COM/OG/OGFORMS.HTML](http://OCCWEB.COM/OG/OGFORMS.HTML); AND,

3) THE CHEMICAL DISCLOSURE OF HYDRAULIC FRACTURING INGREDIENTS FOR ALL WELLS TO BE REPORTED TO FRACFOCUS WITHIN 60 DAYS AFTER THE CONCLUSION THE HYDRAULIC FRACTURING OPERATIONS, USING THE FOLLOWING LINK: [FRACFOCUS.ORG](http://FRACFOCUS.ORG)

This permit does not address the right of entry or settlement of surface damages.

073 26517 YOST 1608 2H-18X

The duration of this permit is 18 MONTHS, except as otherwise provided by Rule 165: 10-3-1.

Rule 165: 10-3-4 (c) (7) (e) - The Operator shall give 24 Hours notice by telephone to the appropriate District Office of the Conservation Division as to when Surface Casing will be run.

INTERMEDIATE CASING	3/1/2019 - G71 - DUE TO THE KNOWN POTENTIAL RISK OF ENCOUNTERING AN OVER-PRESSURED ZONE IN THE MORROW SERIES IN THIS AREA, THE TECHNICAL MANAGER RECOMMENDS SETTING AN INTERMEDIATE STRING OF CASING IMMEDIATELY ABOVE THE MORROW SERIES
INTERMEDIATE CASING	11/25/2019 - G71 - DUE TO THE KNOWN POTENTIAL RISK OF ENCOUNTERING AN OVER-PRESSURED ZONE IN THE MORROW SERIES IN THIS AREA, THE TECHNICAL MANAGER RECOMMENDS SETTING AN INTERMEDIATE STRING OF CASING IMMEDIATELY ABOVE THE MORROW SERIES
LOCATION EXCEPTION - 687617 (201807721)	12/09/2019 - GB6 - (I.O.) 18 & 19-16N-8W X614033 MSSP, WDFD COMPL. INT. 19-16N-8W NCT 0' FNL, NCT 165' FSL, NCT 660' FWL COMPL. INT. 18-16N-8W NCT 0' FSL, NCT 165' FNL, NCT 660' FWL NEWFIELD EXPLORATION MID-CONTINENT IC. 12/4/2018
LOCATION EXCEPTION - 705013 (201807721)	12/9/2019 - GB6 - EXTENSION OF ORDER # 687617 UNTIL 12/04/2020
MEMO	11/25/2019 - G71 - PIT 1 & 2 - CLOSED SYSTEM = STEEL PITS PER OPERATOR REQUEST, WBM/CUTTINGS & OBM CUTTINGS CAPTURED IN STEEL HALF PITS, WBM/CUTTINGS WILL BE SOIL FARMED, OBM CUTTINGS TRANSFERRED TO R360 587498 (31-12N-8W), CANADIAN CO, PIT 2 - OBM TO VENDOR
PENDING CD - 201905770	12/12/2019 - GB6 - 18-16N-8W X614033 MSSP 7 WELLS NO OP. NAMED FILED 12/11/2019
PENDING CD - 201905771	12/12/2019 - GB6 - 19-16N-8W X614033 MSSP 7 WELLS NO OP. NAMED FILED 12/11/2019
SPACING - 614033	3/25/2019 - G58 - (640)(HOR) 18 & 19-16N-8W VAC 42491 MCSTR VAC 83896 MISS, MNNG VAC 131715 MSSNC, MNNG (SEC 18) VAC 195139 MSSNC, MNNG, WDFD (SEC 18) EST MSSP, WDFD POE TO BHL (MSSP) NCT 660' FB POE TO BHL (WDFD) NCT 165 FNL/FSL, NCT 330' FEL/FWL (COEXIST WITH PRODUCING NON-HORIZONTAL SPACING UNITS; SUPERSEDE NON-DEVELOPED NON-HORIZONTAL SPACING UNITS)
SPACING - 687616 (201807720)	12/09/2019 - GB6 - (I.O.) 18 & 19-16N-8W EST MULTIUNIT HORIZONTAL WELL X614033 MSSP, WDFD (WDFD IS ADJACENT CSS TO MSSP) 50% 18-16N-8W 50% 19-16N-8W NEWFIELD EXPLORATION MID-CONTINENT INC. 12/4/2018
SPACING - 704635 (201807720)	12/9/2019 - GB6 - EXTENSION OF ORDER # 687616 UNTIL 12/04/2020

This permit does not address the right of entry or settlement of surface damages.

The duration of this permit is 18 MONTHS, except as otherwise provided by Rule 165: 10-3-1.

Rule 165: 10-3-4 (c) (7) (e) - The Operator shall give 24 Hours notice by telephone to the appropriate District Office of the Conservation Division as to when Surface Casing will be run.

# TOPOGRAPHIC LAND SURVEYORS OF OKLAHOMA

13800 Wireless Way, Okla. City, OK 73134 \* LOCAL (405) 843-4847 \* OUT OF STATE (800) 654-3219  
Certificate of Authorization No. 1293 LS

073-26517 A

KINGFISHER

COUNTY, OKLAHOMA

250' FSL - 2003' FWL SECTION 7 TOWNSHIP 16N RANGE 8W I.M.

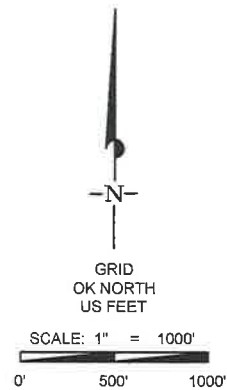

## NOTES:

- THE INFORMATION SHOWN HEREIN IS FOR CONSTRUCTION PURPOSES ONLY.
- ALL BEARINGS SHOWN ARE GRID, NAD-27, OKLAHOMA NORTH.
- LANDING POINT, LAST TAKE POINT, BOTTOM HOLE AND DRILL PATH INFORMATION PROVIDED BY CLIENT LISTED, NOT SURVEYED.

## SURFACE LOCATION

DATUM: NAD-27  
LAT: 35°52'15.2" N  
LONG: 98°05'36.5" W  
LAT: 35.870893° N  
LONG: 98.093477° W  
STATE PLANE  
COORDINATES: (US Feet)  
ZONE: OK NORTH  
X: X 1972304  
Y: Y 317025

DATUM: NAD-83  
LAT: 35°52'15.4" N  
LONG: 98°05'37.7" W  
LAT: 35.870937° N  
LONG: 98.093812° W  
STATE PLANE  
COORDINATES: (US Feet)  
ZONE: OK NORTH  
X: X 1940705  
Y: Y 317049

(This information was gathered with a GPS receiver with ±1 foot Horiz./Vert. accuracy.)

## CERTIFICATE:

I, Thomas L. Howell an Oklahoma Licensed Land Surveyor and an authorized agent of Topographic Land Surveyors of Oklahoma, do hereby certify to the information shown herein.

*Thomas L. Howell*  
Oklahoma Reg. No. 1433



NAD-27  
X 1970305.84  
Y 306216.91  
NAD-83  
X 1938706.64  
Y 306240.63

N 00°07'03" W 2636.32'

N 00°07'00" W 2636.10'

T16N-R8W

N 00°03'02" E 2636.72'

SECTION 7 SW/4

250' FSL - 2003' FWL

2003'

NAD-27  
X 1970301.15  
Y 316762.27  
NAD-83  
X 1938701.85  
Y 316785.98

LOT 1

LOT 2

LOT 3

LOT 4

LOT 1

LOT 2

LOT 3

LOT 4

LOT 1

LOT 2

LOT 3

LOT 4

LOT 1

LOT 2

LOT 3

LOT 4

LOT 1

LOT 2

LOT 3

LOT 4

LOT 1

LOT 2

LOT 3

LOT 4

LOT 1

LOT 2

LOT 3

LOT 4

LOT 1

LOT 2

LOT 3

LOT 4

LOT 1

LOT 2

LOT 3

LOT 4

LOT 1

LOT 2

LOT 3

LOT 4

LOT 1

LOT 2

LOT 3

LOT 4

LOT 1

LOT 2

LOT 3

LOT 4

LOT 1

LOT 2

LOT 3

LOT 4

LOT 1

LOT 2

LOT 3

LOT 4

LOT 1

LOT 2

LOT 3

LOT 4

LOT 1

LOT 2

LOT 3

LOT 4

LOT 1

LOT 2

LOT 3

LOT 4

LOT 1

LOT 2

LOT 3

LOT 4

LOT 1

LOT 2

LOT 3

LOT 4

LOT 1

LOT 2

LOT 3

LOT 4

LOT 1

LOT 2

LOT 3

LOT 4

LOT 1

LOT 2

LOT 3

LOT 4

LOT 1

LOT 2

LOT 3

LOT 4

LOT 1

LOT 2

LOT 3

LOT 4

LOT 1

LOT 2

LOT 3

LOT 4

LOT 1

LOT 2

LOT 3

LOT 4

LOT 1

LOT 2

LOT 3

LOT 4

LOT 1

LOT 2

LOT 3

LOT 4

LOT 1

LOT 2

LOT 3

LOT 4

LOT 1

LOT 2

LOT 3

LOT 4

LOT 1

LOT 2

LOT 3

LOT 4

LOT 1

LOT 2

LOT 3

LOT 4

LOT 1

LOT 2

LOT 3

LOT 4

LOT 1

LOT 2

LOT 3

LOT 4

LOT 1

LOT 2

LOT 3

LOT 4

LOT 1

LOT 2

LOT 3

LOT 4

LOT 1

LOT 2

LOT 3

LOT 4

LOT 1

LOT 2

LOT 3

LOT 4

LOT 1

LOT 2

LOT 3

LOT 4

LOT 1

LOT 2

LOT 3

LOT 4

LOT 1

LOT 2

LOT 3

LOT 4

LOT 1

LOT 2

LOT 3

LOT 4

LOT 1

LOT 2

LOT 3

LOT 4

LOT 1

LOT 2

LOT 3

LOT 4

LOT 1

LOT 2

LOT 3

LOT 4

LOT 1

LOT 2

LOT 3

LOT 4

LOT 1

LOT 2

LOT 3

LOT 4

LOT 1

LOT 2

LOT 3

LOT 4

LOT 1

LOT 2

LOT 3

LOT 4

LOT 1

LOT 2

LOT 3

LOT 4

LOT 1

LOT 2

LOT 3

LOT 4

LOT 1

LOT 2

LOT 3

LOT 4

LOT 1

LOT 2

LOT 3

LOT 4

LOT 1

LOT 2

LOT 3

LOT 4

LOT 1

LOT 2

LOT 3

LOT 4

LOT 1

LOT 2

LOT 3

LOT 4

LOT 1

LOT 2

LOT 3

LOT 4

LOT 1

LOT 2

LOT 3

LOT 4

LOT 1

LOT 2

LOT 3

LOT 4

LOT 1

LOT 2

LOT 3

LOT 4

LOT 1

LOT 2

LOT 3

LOT 4

LOT 1

LOT 2

LOT 3

LOT 4

LOT 1

LOT 2

LOT 3

LOT 4