

OKLAHOMA CORPORATION COMMISSION
OIL & GAS CONSERVATION DIVISION
P.O. BOX 52000
OKLAHOMA CITY, OK 73152-2000
(Rule 165:10-3-1)

API NUMBER: 073 26651

Approval Date: 12/12/2019

Expiration Date: 06/12/2021

Horizontal Hole
Oil & Gas
Multi Unit

PERMIT TO DRILL

WELL LOCATION: Sec: 29 Twp: 16N Rge: 8W County: KINGFISHER

SPOT LOCATION: ☐ NW ☐ NW ☐ NW ☐ NW FEET FROM QUARTER: FROM NORTH FROM WEST

SECTION LINES: 255 243

Lease Name: DAN FED 1608 Well No: 8H-17X Well will be 243 feet from nearest unit or lease boundary.

Operator Name: NEWFIELD EXPLORATION MID-CON INC

Telephone: 2812105100; 9188781

OTC/OCC Number: 20944 0

NEWFIELD EXPLORATION MID-CON INC
4 WATERWAY AVE STE 100
THE WOODLANDS, TX 77380-2764

KANE L. YOST
7442 E. 810 ROAD
KINGFISHER OK 73750

Formation(s) (Permit Valid for Listed Formations Only):

Name	Depth	Name	Depth
1 MISSISSIPPIAN	8702	6	
2		7	
3		8	
4		9	
5		10	

Spacing Orders: 635442
690964

Location Exception Orders: 691102
695482

Increased Density Orders: 689313
689870

Pending CD Numbers:

Special Orders:

Total Depth: 19234

Ground Elevation: 1107

Surface Casing: 1500

Depth to base of Treatable Water-Bearing FM: 140

Deep surface casing has been approved

Under Federal Jurisdiction: Yes

Fresh Water Supply Well Drilled: No

Surface Water used to Drill: No

PIT 1 INFORMATION

Approved Method for disposal of Drilling Fluids:

Type of Pit System: CLOSED Closed System Means Steel Pits

Type of Mud System: WATER BASED

Chlorides Max: 5000 Average: 3000

Is depth to top of ground water greater than 10ft below base of pit? Y

Within 1 mile of municipal water well? N

Wellhead Protection Area? N

Pit is located in a Hydrologically Sensitive Area.

Category of Pit: C

Liner not required for Category: C

Pit Location is BED AQUIFER

Pit Location Formation: CEDAR HILLS

D. One time land application -- (REQUIRES PERMIT) PERMIT NO: 19-37103

E. Haul to Commercial pit facility: Sec. 31 Twn. 12N Rng. 8W Cnty. 17 Order No: 587498

H. SEE MEMO

This permit does not address the right of entry or settlement of surface damages.

The duration of this permit is 18 MONTHS, except as otherwise provided by Rule 165: 10-3-1.

Rule 165: 10-3-4 (c) (7) (e) - The Operator shall give 24 Hours notice by telephone to the appropriate District Office of the Conservation Division as to when Surface Casing will be run.

PIT 2 INFORMATION

Type of Pit System: CLOSED Closed System Means Steel Pits

Type of Mud System: OIL BASED

Chlorides Max: 300000 Average: 200000

Is depth to top of ground water greater than 10ft below base of pit? Y

Within 1 mile of municipal water well? N

Wellhead Protection Area? N

Pit is located in a Hydrologically Sensitive Area.

Category of Pit: C

Liner not required for Category: C

Pit Location is BED AQUIFER

Pit Location Formation: CEDAR HILLS

HORIZONTAL HOLE 1

Sec 17 Twp 16N Rge 8W County KINGFISHER

Spot Location of End Point: NE NW NW NW

Feet From: NORTH 1/4 Section Line: 85

Feet From: WEST 1/4 Section Line: 380

Depth of Deviation: 8275

Radius of Turn: 475

Direction: 360

Total Length: 10212

Measured Total Depth: 19234

True Vertical Depth: 8702

End Point Location from Lease,
Unit, or Property Line: 85

Notes:

Category

Description

DEEP SURFACE CASING

12/4/2019 - G71 - APPROVED; NOTIFY OCC FIELD INSPECTOR IMMEDIATELY OF ANY LOSS OF CIRCULATION OR FAILURE TO CIRCULATE CEMENT TO SURFACE ON ANY CONDUCTOR OR SURFACE CASING

EXCEPTION TO RULE - 695482 (201808814)

12/12/2019 - GC2 - (I.O.) 17 & 20-16N-8W
X165:10-3-28(C)(2)(B) MSSP (DAN FED 1608 8H-17X)
MAY BE CLOSER THAN 600' TO DAN FED 1608 2H-17X, DAN FED 1608 3H-17X, DAN FED 1608 4H-17X, DAN FIU 1608 5H-17X, DAN FIU 1608 6H-17X, DAN FED 1608 7H-17X, GRACE 1-17, GRACE 2-17, ZETA 20-1, MAX YOST 1, DAN 1H-17X
NO OP. NAMED
5-2-2019

HYDRAULIC FRACTURING

12/4/2019 - G71 - OCC 165:10-3-10 REQUIRES:

1) PRIOR TO COMMENCEMENT OF HYDRAULIC FRACTURING OPERATIONS FOR HORIZONTAL WELLS, NOTICE GIVEN FIVE BUSINESS DAYS IN ADVANCE TO OFFSET OPERATORS WITH WELLS COMPLETED IN THE SAME COMMON SOURCE OF SUPPLY WITHIN 1/2 MILE;

2) WITH NOTICE ALSO GIVEN 48 HOURS IN ADVANCE OF HYDRAULIC FRACTURING ALL WELLS TO BOTH THE OCC CENTRAL OFFICE AND LOCAL DISTRICT OFFICES, USING THE "FRAC NOTICE FORM" FOUND AT THE FOLLOWING LINK: OCCWEB.COM/OG/OGFORMS.HTML; AND,

3) THE CHEMICAL DISCLOSURE OF HYDRAULIC FRACTURING INGREDIENTS FOR ALL WELLS TO BE REPORTED TO FRACFOCUS WITHIN 60 DAYS AFTER THE CONCLUSION THE HYDRAULIC FRACTURING OPERATIONS, USING THE FOLLOWING LINK: FRACFOCUS.ORG

INCREASED DENSITY - 689313 (201808795)

12/12/2019 - GC2 - 17-16N-8W
X635442 MSSP
7 WELLS
NEWFIELD EXPLORATION MID-CONTINENT INC
1-17-2019

This permit does not address the right of entry or settlement of surface damages.

073 26651 DAN FED 1608 8H-17X

The duration of this permit is 18 MONTHS, except as otherwise provided by Rule 165: 10-3-1.

Rule 165: 10-3-4 (c) (7) (e) - The Operator shall give 24 Hours notice by telephone to the appropriate District Office of the Conservation Division as to when Surface Casing will be run.

INCREASED DENSITY - 689870 (201808796)	12/12/2019 - GC2 - 20-16N-8W X635442 MSSP 7 WELLS NEWFIELD EXPLORATION MID-CONTINENT INC 1-16-2019
INTERMEDIATE CASING	12/4/2019 - G71 - DUE TO THE KNOWN POTENTIAL RISK OF ENCOUNTERING AN OVER-PRESSURED ZONE IN THE MORROW SERIES IN THIS AREA, THE TECHNICAL MANAGER RECOMMENDS SETTING AN INTERMEDIATE STRING OF CASING IMMEDIATELY ABOVE THE MORROW SERIES
LOCATION EXCEPTION - 691102 (201808813)	12/12/2019 - GC2 - (I.O.) 17 & 20-16N-8W X635442 MSSP 17 & 20-16N-8W COMPL. INT. (20-16N-8W) NCT 165' FSL, NCT 0' FNL, NCT 330' FWL COMPL. INT. (17-16N-8W) NCT 0' FSL, NCT 165' FNL, NCT 330' FWL NEWFIELD EXPLORATION MID-CONTINENT INC 2-7-2019
MEMO	12/4/2019 - G71 - PIT 1 & 2 - CLOSED SYSTEM = STEEL PITS (REQUIRED - KINGFISHER CREEK), WBM/CUTTINGS & OBM CUTTINGS CAPTURED IN STEEL HALF PITS, WBM/CUTTINGS WILL BE SOIL FARMED, OBM CUTTINGS TRANSFERRED TO R360 587498 (31-12N-8W), CANADIAN CO, PIT 2 - OBM TO VENDOR
SPACING - 635442	12/12/2019 - GC2 - (640)(HOR) 17 & 20-16N-8W VAC 83896 MISS, MNNG W2 & SE4 17-16N-8W & N2, W2 SW4, & W2 SE4 20-16N-8W VAC 187915 CSTR NW4 20-16N-8W VAC 225407 CSTCU SW4 20-16N-8W VAC OTHERS VAC 210501 CSTR S2 & NW4 17-16N-8W EXT 614033 MSSP, OTHER COMPL. INT. (MSSP) NCT 660' FB (COEXIST PRODUCING NON-HORIZONTAL SPACING UNITS)
SPACING - 690964 (201808812)	12/12/2019 - GC2 - (I.O.) 17 & 20-16N-8W EST MULTIUNIT HORIZONTAL WELL X635442 MSSP 17 & 20-16N-8W 50% 17-16N-8W 50% 20-16N-8W NEWFIELD EXPLORATION MID-CONTINENT INC 2-5-2019

TOPOGRAPHIC LAND SURVEYORS OF OKLAHOMA

13800 WIRELESS WAY, OKLA. CITY, OKLA. 73134 • LOCAL (405) 843-4847 • OUT OF STATE (800) 654-3219

Certificate of Authorization No. 1293 LS

KINGFISHER

County, Oklahoma

255'FNL-243'FWL

Section 29

Township 16N

Range 8W

I.M.

NAD-27
X 1980476.37
Y 316829.78
NAD-83
X 1948877.25
Y 316853.51



NOTES:

- The information shown herein is for construction purposes ONLY.
- All bearings shown are Grid, NAD-27, Oklahoma North.
- Landing Point, Last Take Point, Bottom Hole, and Drill Path information provided by client listed, not surveyed.

SURFACE LOCATION

DATUM: NAD-27

LAT: 35°50'26.2"N

LONG: 98°04'57.3"W

LAT: 35.840612°N

LONG: 98.082597°W

STATE PLANE

COORDINATES: (US Feet)

ZONE: OK NORTH

X: 1975519

Y: 306000

DATUM: NAD-83

LAT: 35°50'26.4"N

LONG: 98°04'58.6"W

LAT: 35.840657°N

LONG: 98.082931°W

STATE PLANE

COORDINATES: (US Feet)

ZONE: OK NORTH

X: 1943920

Y: 306024

(This information was gathered with a GPS receiver with ±1 foot Horiz./Vert. accuracy.)

CERTIFICATE:

I, Thomas L. Howell an Oklahoma Licensed Land Surveyor and an authorized agent of Topographic Land Surveyors of Oklahoma, do hereby certify to the information shown herein.

Thomas L. Howell
Oklahoma Lic. No. 1433

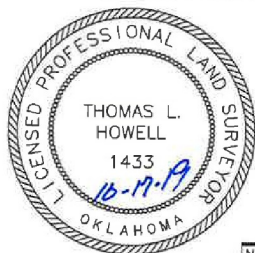

NAD-27
X 1975245.37
Y 316794.77
NAD-83
X 1943646.16
Y 316818.49

BOTTOM HOLE
N 00°14'13" W
80.00'
LAST TAKE POINT

NAD-27
X 1977860.87
Y 316812.35
NAD-83
X 1946261.71
Y 316836.08

BOTTOM HOLE
85'FNL-380'FWL
NAD-27 (US FEET)
35°52'12.1" N
98°04'56.2" W
35.870041° N
98.082266° W
X 1975626
Y 316712
NAD-83
35°52'12.3" N
98°04'57.4" W
35.870085° N
98.082601° W
X 1944027
Y 316736

LAST TAKE POINT
165'FNL-380'FWL
NAD-27 (US FEET)
35°52'11.4" N
98°04'56.2" W
35.869821° N
98.082265° W
X 1975626
Y 316632
NAD-83
35°52'11.5" N
98°04'57.4" W
35.869865° N
98.082600° W
X 1944027
Y 316656

NAD-27
X 1977890.70
Y 311536.70
NAD-83
X 1946291.61
Y 311560.43

NAD-27
X 1980490.57
Y 314191.56
NAD-83
X 1948891.49
Y 314215.29

NAD-27
X 1980504.94
Y 311553.31
NAD-83
X 1948905.89
Y 311577.05

NAD-27
X 1975277.78
Y 311520.14
NAD-83
X 1943678.64
Y 311543.86

LANDING POINT
165'FSL-380'FWL
NAD-27 (US FEET)
35°50'30.4" N
98°04'55.7" W
35.841767° N
98.082136° W
X 1975656
Y 306420
NAD-83
35°50'30.5" N
98°04'56.9" W
35.841811° N
98.082470° W
X 1944057
Y 306444

NAD-27
X 1980521.21
Y 308911.99
NAD-83
X 1948922.20
Y 308935.72

NAD-27
X 1975275.70
Y 308886.58
NAD-83
X 1943676.60
Y 308910.30

NAD-27
X 1977906.60
Y 306262.49
NAD-83
X 1946307.58
Y 306286.22

NAD-27
X 1980537.39
Y 306270.65
NAD-83
X 1948938.43
Y 306294.38

NAD-27
X 1975275.76
Y 306254.06
NAD-83
X 1943676.69
Y 306277.78

LANDING POINT
N 18°02'48" E
442.04'

PROPOSED PAD
255'FNL-243'FWL

Operator: NEWFIELD EXPLORATION MID-CON INC

Project # 128212

Date of Drawing: Sep. 30, 2019

Date Staked: Sep. 17, 2019 LC

Lease Name: DAN FED 1608

Well No.: 8H-17X

Topography & Vegetation Location fell in grass pasture.

Good Drill Site? Yes

Reference Stakes or Alternate Location
Stakes Set None

Best Accessibility to Location From South off county road.

Distance & Direction

from Hwy Jct or Town From Kingfisher, Oklahoma go ±8.5 miles West, then ±1.0 mile South to

the Northwest corner of Section 29, T16N-R8W.

ELEVATION:

1107' Gr. at Stake (NGVD29)

1107' Gr. at Stake (NAVD88)