

OKLAHOMA CORPORATION COMMISSION  
OIL & GAS CONSERVATION DIVISION  
P.O. BOX 52000  
OKLAHOMA CITY, OK 73152-2000  
(Rule 165:10-3-1)

API NUMBER: 049 25324

Approval Date: 01/22/2020

Expiration Date: 07/22/2021

Horizontal Hole  
Multi Unit

Oil & Gas

PERMIT TO DRILL

WELL LOCATION: Sec: 21 Twp: 3N Rge: 4W County: GARVIN

SPOT LOCATION: ☐ NW ☐ NE ☐ NE ☐ NW FEET FROM QUARTER: FROM NORTH FROM WEST

SECTION LINES: 325 2280

Lease Name: SANDRA Well No: 0304 2H-9X Well will be 325 feet from nearest unit or lease boundary.

Operator Name: NEWFIELD EXPLORATION MID-CON INC

Telephone: 2812105100; 9188781

OTC/OCC Number: 20944 0

NEWFIELD EXPLORATION MID-CON INC  
4 WATERWAY AVE STE 100  
THE WOODLANDS, TX 77380-2764

BOB D. DICKSON AND ILENE R. DICKSON  
12202 E. PVT 1580 DRIVE  
LINDSAY OK 73052

Formation(s) (Permit Valid for Listed Formations Only):

Name	Depth	Name	Depth
1 SPRINGER	11225	6	
2		7	
3		8	
4		9	
5		10	

Spacing Orders: 638181  
658538  
659832  
663306

Location Exception Orders:

Increased Density Orders:

Pending CD Numbers: 201903437  
201903438  
201903442  
201903443

Special Orders:

Total Depth: 23428

Ground Elevation: 1183

Surface Casing: 1500

Depth to base of Treatable Water-Bearing FM: 330

Deep surface casing has been approved

Under Federal Jurisdiction: No

Fresh Water Supply Well Drilled: No

Surface Water used to Drill: No

PIT 1 INFORMATION

Approved Method for disposal of Drilling Fluids:

Type of Pit System: CLOSED Closed System Means Steel Pits

Type of Mud System: WATER BASED

Chlorides Max: 5000 Average: 3000

Is depth to top of ground water greater than 10ft below base of pit? Y

Within 1 mile of municipal water well? N

Wellhead Protection Area? N

Pit is located in a Hydrologically Sensitive Area.

Category of Pit: C

Liner not required for Category: C

Pit Location is BED AQUIFER

Pit Location Formation: DUNCAN

D. One time land application -- (REQUIRES PERMIT) PERMIT NO: 20-37208

E. Haul to Commercial pit facility: Sec. 31 Twn. 12N Rng. 8W Cnty. 17 Order No: 587498

H. SEE MEMO

This permit does not address the right of entry or settlement of surface damages.

The duration of this permit is 18 MONTHS, except as otherwise provided by Rule 165: 10-3-1.

Rule 165: 10-3-4 (c) (7) (e) - The Operator shall give 24 Hours notice by telephone to the appropriate District Office of the Conservation Division as to when Surface Casing will be run.

## PIT 2 INFORMATION

Type of Pit System: CLOSED Closed System Means Steel Pits

Type of Mud System: OIL BASED

Chlorides Max: 300000 Average: 200000

Is depth to top of ground water greater than 10ft below base of pit? Y

Within 1 mile of municipal water well? N

Wellhead Protection Area? N

Pit is located in a Hydrologically Sensitive Area.

Category of Pit: C

Liner not required for Category: C

Pit Location is BED AQUIFER

Pit Location Formation: DUNCAN

## HORIZONTAL HOLE 1

Sec 09 Twp 3N Rge 4W County GARVIN

Spot Location of End Point: NW NW NW NE

Feet From: NORTH 1/4 Section Line: 85

Feet From: EAST 1/4 Section Line: 2400

Depth of Deviation: 12319

Radius of Turn: 564

Direction: 360

Total Length: 10223

Measured Total Depth: 23428

True Vertical Depth: 12723

End Point Location from Lease,  
Unit, or Property Line: 85

### Notes:

#### Category

#### Description

DEEP SURFACE CASING

1/21/2020 - G71 - APPROVED; NOTIFY OCC FIELD INSPECTOR IMMEDIATELY OF ANY LOSS OF CIRCULATION OR FAILURE TO CIRCULATE CEMENT TO SURFACE ON ANY CONDUCTOR OR SURFACE CASING

HYDRAULIC FRACTURING

1/21/2020 - G71 - OCC 165:10-3-10 REQUIRES:

1) PRIOR TO COMMENCEMENT OF HYDRAULIC FRACTURING OPERATIONS FOR HORIZONTAL WELLS, NOTICE GIVEN FIVE BUSINESS DAYS IN ADVANCE TO OFFSET OPERATORS WITH WELLS COMPLETED IN THE SAME COMMON SOURCE OF SUPPLY WITHIN 1/2 MILE;

2) WITH NOTICE ALSO GIVEN 48 HOURS IN ADVANCE OF HYDRAULIC FRACTURING ALL WELLS TO BOTH THE OCC CENTRAL OFFICE AND LOCAL DISTRICT OFFICES, USING THE "FRAC NOTICE FORM" FOUND AT THE FOLLOWING LINK: [OCCEWEB.COM/OG/OGFORMS.HTML](http://OCCEWEB.COM/OG/OGFORMS.HTML); AND,

3) THE CHEMICAL DISCLOSURE OF HYDRAULIC FRACTURING INGREDIENTS FOR ALL WELLS TO BE REPORTED TO FRACFOCUS WITHIN 60 DAYS AFTER THE CONCLUSION THE HYDRAULIC FRACTURING OPERATIONS, USING THE FOLLOWING LINK: [FRACFOCUS.ORG](http://FRACFOCUS.ORG)

MEMO

1/21/2020 - G71 - PIT 1 & 2 - CLOSED SYSTEM = STEEL PITS PER OPERATOR REQUEST, WBM/CUTTINGS & OBM CUTTINGS CAPTURED IN STEEL HALF PITS, WBM/CUTTINGS WILL BE SOIL FARMED, OBM CUTTINGS TRANSFERRED TO R360 587498 (31-12N-8W), CANADIAN CO, PIT 2 - OBM TO VENDOR

PENDING CD - 201903437

1/22/2020 - GC2 - 9-3N-4W  
X658538/659832/663306 SPRG  
2 WELLS  
NO OP. NAMED  
REC. 1-7-2020 (NORRIS)

This permit does not address the right of entry or settlement of surface damages.

The duration of this permit is 18 MONTHS, except as otherwise provided by Rule 165: 10-3-1.

Rule 165: 10-3-4 (c) (7) (e) - The Operator shall give 24 Hours notice by telephone to the appropriate District Office of the Conservation Division as to when Surface Casing will be run.

049 25324 SANDRA 0304 2H-9X

PENDING CD - 201903438	1/22/2020 - GC2 - 16-3N-4W X638181 SPRG 2 WELLS NO OP. NAMED REC. 1-7-2020 (NORRIS)
PENDING CD - 201903442	1/22/2020 - GC2 - (I.O.) 9 & 16-3N-4W EST MULTIUNIT HORIZONTAL WELL X658538/659832/663306 SPRG 9-3N-4W X638181 SPRG 16-3N-4W 50% 9-3N-4W 50% 16-3N-4W NO OP. NAMED REC. 1-7-2020 (NORRIS)
PENDING CD - 201903443	1/22/2020 - GC2 - (I.O.) 9 & 16-3N-4W X658538/659832/663306 SPRG 9-3N-4W X638181 SPRG 16-3N-4W COMPL. INT. (9-3N-4W) NCT 165', NCT 0' FSL, NCT 1,980' FEL COMPL. INT. (16-3N-4W) NCT 0' FSL, NCT 165', FSL, NCT 1,980' FEL NO OP. NAMED REC. 1-7-2020 (NORRIS)
SPACING - 638181	1/22/2020 - GC2 - (640)(HOR) 16-3N-4W VAC 27834 16-3N-4W EST SPRG COMPL. INT. NCT 660' FB
SPACING - 658538	1/22/2020 - GC2 - (640)(HOR) 9-3N-4W VAC 27834 9-3N-4W EXT 638181 SPRG COMPL. INT. NCT 660' FB
SPACING - 659832	1/22/2020 - GC2 - NPT PARAGRAPH 5.2 AND 8.1 OF 658538 TO CHANGE THE COMMON SOURCE OF SUPPLY FROM SPRINGER SAND TO SPRINGER
SPACING - 663306	1/22/2020 - GC2 - (640)(HOR) 9-3N-4W EXT 658538/659832 SPRG, OTHERS COMPL. INT. (SPRG, OTHERS) NCT 660' FB

## TOPOGRAPHIC LAND SURVEYORS

13800 Wireless Way, Okla. City, OK 73134 • LOCAL (405) 843-4847 • OUT OF STATE (800) 654-3219  
Certificate of Authorization No. 1292 LS

API: 049-25324

GARVIN

COUNTY, OKLAHOMA

325' FNL - 2280' FWL

SECTION 21  
S 89°43'12" E 2646.19'

TOWNSHIP 3N

RANGE 4W I.M.

S 89°42'51" E 2645.96'

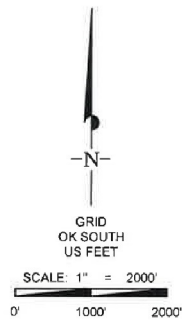

## NOTES:

- THE INFORMATION SHOWN HEREIN IS FOR CONSTRUCTION PURPOSES ONLY.
- ALL BEARINGS SHOWN ARE GRID, NAD-83, OKLAHOMA SOUTH.
- LANDING POINT, LAST TAKE POINT, BOTTOM HOLE AND DRILL PATH INFORMATION PROVIDED BY CLIENT LISTED, NOT SURVEYED.

## SURFACE LOCATION

DATUM: NAD-27

LAT: 34°43'26.2" N

LONG: 97°37'31.5" W

LAT: 34°42'39.39" N

LONG: 97°32'54.22" W

STATE PLANE

COORDINATES: (US Feet)

ZONE: OK SOUTH

X: X 2112557

Y: Y 506267

DATUM: NAD-83

LAT: 34°43'26.5" N

LONG: 97°37'32.6" W

LAT: 34°42'40.17" N

LONG: 97°32'57.32" W

STATE PLANE

COORDINATES: (US Feet)

ZONE: OK SOUTH

X: X 2080962

Y: Y 506309

(This information was gathered with a GPS receiver with ±1 foot Horiz./Vert. accuracy)

## CERTIFICATE:

I, Thomas L. Howell an Oklahoma Licensed Land Surveyor and an authorized agent of Topographic Land Surveyors, do hereby certify to the information shown herein.

Oklahoma Reg. No.

1433

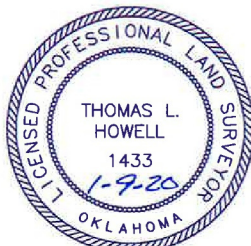

OPERATOR: NEWFIELD EXPLORATION MID-CON INC

LEASE NAME: WELL NO: SANDRA 0304

WELL NO: 2H-9X

TOPOGRAPHY &amp; VEGETATION

LOCATION FELL IN PASTURE

REFERENCE STAKES OR ALTERNATE LOCATION  
STAKES SET: NONE

GOOD DRILL SITE? Yes

BEST ACCESSIBILITY TO LOCATION: From South off county road.

DISTANCE & DIRECTION: From Lindsay, OK go ±9 miles South on St. Hwy. 76, then ±2 miles West on E1590 Road, then ±1 mile North on N3010 Road to the Northeast Corner of Section 21-T3N-R4W.

## ELEVATION:

1183' Gr. at Stake (NGVD29)

1183' Gr. at Stake (NAVD88)

PROJECT # 127844

DATE OF DRAWING: JANUARY 08, 2020

DATE STAKED: AUGUST 7, 2019

DRAWN BY: EAH

REVISION: 0

FILE NAME: LO SANDRA 0304 2H-9X

