

API NUMBER: 019 26467

OKLAHOMA CORPORATION COMMISSION
OIL & GAS CONSERVATION DIVISION
P.O. BOX 52000
OKLAHOMA CITY, OK 73152-2000
(Rule 165:10-3-1)

Approval Date: 11/18/2021
Expiration Date: 05/18/2023

Straight Hole Oil & Gas

PERMIT TO DRILL

WELL LOCATION: Section: 22 Township: 4S Range: 2W County: CARTER

SPOT LOCATION: ☐ NW ☐ SW ☐ SE ☐ NW FEET FROM QUARTER: FROM NORTH FROM WEST
SECTION LINES: 2048 1588

Lease Name: HEWITT UNIT Well No: 22-2704 Well will be 1588 feet from nearest unit or lease boundary.
Operator Name: XTO ENERGY INC Telephone: 4053193200; 8178852283 OTC/OCC Number: 21003 0

XTO ENERGY INC
22777 SPRINGWOODS VILLAGE PARKWAY
SPRING, TX 77389-1425

XTO ENERGY INC
810 HOUSTON STREET
FORT WORTH TX 76102

Formation(s) (Permit Valid for Listed Formations Only):

	Name	Code	Depth
1	HOXBAR	405HXBR	1280
2	DEESE	404DEESS	2245

Spacing Orders: 67990

Location Exception Orders: No Exceptions

Increased Density Orders: No Density

Pending CD Numbers: No Pending

Working interest owners' notified: ***

Special Orders: No Special

Total Depth: 4000 Ground Elevation: 855

Surface Casing: 440

Depth to base of Treatable Water-Bearing FM: 390

Under Federal Jurisdiction: No
Fresh Water Supply Well Drilled: No
Surface Water used to Drill: Yes

Approved Method for disposal of Drilling Fluids:

D. One time land application -- (REQUIRES PERMIT) PERMIT NO: 21-37962
H. (Other) CLOSED SYSTEM=STEEL PITS (REQUIRED - WALNUT CREEK)

PIT 1 INFORMATION

Type of Pit System: CLOSED Closed System Means Steel Pits

Type of Mud System: WATER BASED

Chlorides Max: 5000 Average: 3000

Is depth to top of ground water greater than 10ft below base of pit? Y

Within 1 mile of municipal water well? N

Wellhead Protection Area? N

Pit is located in a Hydrologically Sensitive Area.

Category of Pit: C

Liner not required for Category: C

Pit Location is: ALLUVIAL

Pit Location Formation: ALLUVIUM

NOTES:

This permit does not address the right of entry or settlement of surface damages. The duration of this permit is 18 MONTHS, except as otherwise provided by Rule 165: 10-3-1. Rule 165: 10-3-4 (c) (7) (e) - The Operator shall give 24 Hours notice by telephone to the appropriate District Office of the Conservation Division as to when Surface Casing will be run.

Category	Description
HYDRAULIC FRACTURING	<p>[11/17/2021 - GC2] - OCC 165:10-3-10 REQUIRES:</p> <p>1) NOTICE SHALL BE GIVEN AT LEAST 5 BUSINESS DAYS PRIOR TO COMMENCEMENT OF HYDRAULIC FRACTURING OPERATIONS ON A HORIZONTAL WELL TO OPERATORS PRODUCING WELLS WITHIN 1 MILE OF THE COMPLETION INTERVAL OF THE SUBJECT WELL. THE NOTICE TO SUCH OPERATORS SHALL CONTAIN THE INFORMATION IN FORM 6000NOO. IF THE HYDRAULIC FRACTURING OPERATIONS SCHEDULE CHANGES AFTER NOTICE HAS BEEN PROVIDED, RESULTING IN A DELAY OF OPERATIONS OF MORE THAN 5 DAYS FROM THE INITIAL NOTICE, NEW NOTICE IS REQUIRED TO BE GIVEN;</p> <p>2) NOTICE WILL BE GIVEN TO THE OCC CENTRAL OFFICE AND LOCAL DISTRICT OFFICES AT LEAST 48 HOURS PRIOR TO COMMENCEMENT OF HYDRAULIC FRACTURING OPERATIONS. FORM 6000NHF SHALL BE USED AND IS FOUND AT THIS LINK: OCCEWEB.COM/OG/OGFORMS.HTML; AND,</p> <p>3) THE CHEMICAL DISCLOSURE OF HYDRAULIC FRACTURING INGREDIENTS FOR ALL WELLS IS TO BE REPORTED TO FRACFOCUS WITHIN 60 DAYS AFTER THE CONCLUSION OF HYDRAULIC FRACTURING OPERATIONS, FOUND AT FRACFOCUS.ORG</p>
SPACING - 67990	<p>[11/18/2021 - G56] - (UNIT) 22-4S-2W</p> <p>EST HEWITT UNIT FOR BASE OF DEESS TO SURFACE</p>

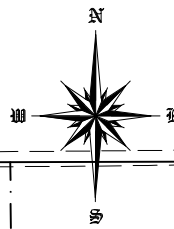

N: 316564.33
E: 2180101.88

N: 316571.71
E: 2182745.25

NW

N: 314586.97
E: 2181437.12

N: 314590.31
E: 2182098.86

SURFACE LOCATION
68'FNL-264'FWUL
2048'FNL-1588'FWL
NAD - 27
Lat: N034°11'46.06"
Lon: W097°23'56.84"
Lat: N034.196128
Lon: W097.399122
N: 314520.70
E: 2181701.55

N: 313918.94
E: 2180117.53

N: 313926.62
E: 2181441.64

N: 313930.45
E: 2182103.68

NOTES:

1. This survey does not represent a boundary survey. It is for Geographical Information Systems (GIS) purposes only as instructed by the client and is not to be relied upon for the establishment of fences, buildings or other further improvement lines. Positions were taken with Survey Grade RTK GPS and NGS OPUS processed control using the NAD27 Oklahoma South State Plane Coordinate System.

0 400' 800' 1,200'



Surface Hole Location: 68' From North Line of Unit 27
264' From West Line of Unit 27

2048' From North Line of Sec 22
1588' From West Line Sec 22

Latitude: N34.196128° (NAD 27)
Longitude: W97.399122° (NAD 27)
Latitude: N34.196171° (NAD 83)
Longitude: W97.399421° (NAD 83)

Ground Elev: 854.95

Drilling Unit: Unit 27 (SW/4 SE/4 NW/4),
Section 22, T4S, R2W

- LEGEND:**
- EXISTING WELL HEAD/PRODUCTION WELL
 - PROPOSED SURFACE HOLE (PSHL)
 - SECTION CORNER
 - UNIT LINE
 - DRILLING UNIT

I, Chad Fox, a duly registered Professional Land Surveyor in the State of OKLAHOMA, do hereby certify that the drawing shown hereon was completed and represents a good and accurate survey made upon the ground by me or under my direct supervision.

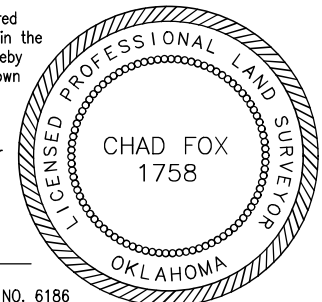

Operator: XTO Energy, Inc.
Best Accessibility to Location: From West

Distance & Direction from Hwy Jct or Town:
From the Intersection of Interstate 70 and Dillard Rd, go North 1.6mi on Dillard Rd well location to the East.

CHAD FOX P.L.S. NO. 1758
EX. DATE: 31JAN22 C.O.A. NO. 6186

CDF AND ASSOCIATES, LLC.

208 Dewey Ave. Poteau, OK 74953 (918) 649-3303
Certificate of Authorization No. 6186

JOB NO:	XTO/WP21/HU 22-2704	DRAWN BY:	LD
DATE: 17/NOV/21	REV: C	SCALE: 1" = 400'	SHT NO. 1