

API NUMBER: 037 29479

OKLAHOMA CORPORATION COMMISSION
OIL & GAS CONSERVATION DIVISION
P.O. BOX 52000
OKLAHOMA CITY, OK 73152-2000
(Rule 165:10-3-1)

Approval Date: 08/27/2021
Expiration Date: 02/27/2023

Straight Hole Oil & Gas

PERMIT TO DRILL

WELL LOCATION: Section: 17 Township: 16N Range: 10E County: CREEK

SPOT LOCATION: ☐ SW ☐ NW ☐ NE ☐ NE FEET FROM QUARTER: FROM NORTH FROM EAST
SECTION LINES: 494 1250

Lease Name: WEYBURN Well No: 2 Well will be 494 feet from nearest unit or lease boundary.
Operator Name: WEINS HORTON L Telephone: 9186940016 OTC/OCC Number: 21286 0

WEINS HORTON L
PO BOX 571117
TULSA, OK 74157-1117

BRYAN KELLY AND MICHELLE KELLY
25341 WEST 203RD SOUTH
KELLYVILLE OK 74039

Formation(s) (Permit Valid for Listed Formations Only):

Name	Code	Depth
1 BURGESS	404BRGS	2940

Spacing Orders: No Spacing

Location Exception Orders: No Exceptions

Increased Density Orders: No Density

Pending CD Numbers: No Pending

Working interest owners' notified: ***

Special Orders: No Special

Total Depth: 3150 Ground Elevation: 920

Surface Casing: 550

Depth to base of Treatable Water-Bearing FM: 480

Under Federal Jurisdiction: No
Fresh Water Supply Well Drilled: No
Surface Water used to Drill: No

Approved Method for disposal of Drilling Fluids:

A. Evaporation/dewater and backfilling of reserve pit.

PIT 1 INFORMATION

Type of Pit System: ON SITE
Type of Mud System: WATER BASED
Chlorides Max: 5000 Average: 3000
Is depth to top of ground water greater than 10ft below base of pit? Y
Within 1 mile of municipal water well? N
Wellhead Protection Area? N
Pit **is not** located in a Hydrologically Sensitive Area.

Category of Pit: 2
Liner not required for Category: 2
Pit Location is: NON HSA
Pit Location Formation: DEWEY

NOTES:

This permit does not address the right of entry or settlement of surface damages. The duration of this permit is 18 MONTHS, except as otherwise provided by Rule 165: 10-3-1. Rule 165: 10-3-4 (c) (7) (e) - The Operator shall give 24 Hours notice by telephone to the appropriate District Office of the Conservation Division as to when Surface Casing will be run.

Category	Description
HYDRAULIC FRACTURING	<p>[8/26/2021 - GC2] - OCC 165:10-3-10 REQUIRES:</p> <p>1) NOTICE SHALL BE GIVEN AT LEAST 5 BUSINESS DAYS PRIOR TO COMMENCEMENT OF HYDRAULIC FRACTURING OPERATIONS ON A HORIZONTAL WELL TO OPERATORS PRODUCING WELLS WITHIN 1 MILE OF THE COMPLETION INTERVAL OF THE SUBJECT WELL. THE NOTICE TO SUCH OPERATORS SHALL CONTAIN THE INFORMATION IN FORM 6000NOO. IF THE HYDRAULIC FRACTURING OPERATIONS SCHEDULE CHANGES AFTER NOTICE HAS BEEN PROVIDED, RESULTING IN A DELAY OF OPERATIONS OF MORE THAN 5 DAYS FROM THE INITIAL NOTICE, NEW NOTICE IS REQUIRED TO BE GIVEN;</p> <p>2) NOTICE WILL BE GIVEN TO THE OCC CENTRAL OFFICE AND LOCAL DISTRICT OFFICES AT LEAST 48 HOURS PRIOR TO COMMENCEMENT OF HYDRAULIC FRACTURING OPERATIONS. FORM 6000NHF SHALL BE USED AND IS FOUND AT THIS LINK: OCCEWEB.COM/OG/OGFORMS.HTML; AND,</p> <p>3) THE CHEMICAL DISCLOSURE OF HYDRAULIC FRACTURING INGREDIENTS FOR ALL WELLS IS TO BE REPORTED TO FRACFOCUS WITHIN 60 DAYS AFTER THE CONCLUSION OF HYDRAULIC FRACTURING OPERATIONS, FOUND AT FRACFOCUS.ORG</p>
SPACING	[8/27/2021 - G56] - BRGS UNSPACED; 80-ACRE LEASE (N2 NE4)

WELL LOCATION FOR: HORTON L. WEINS

R-10-E

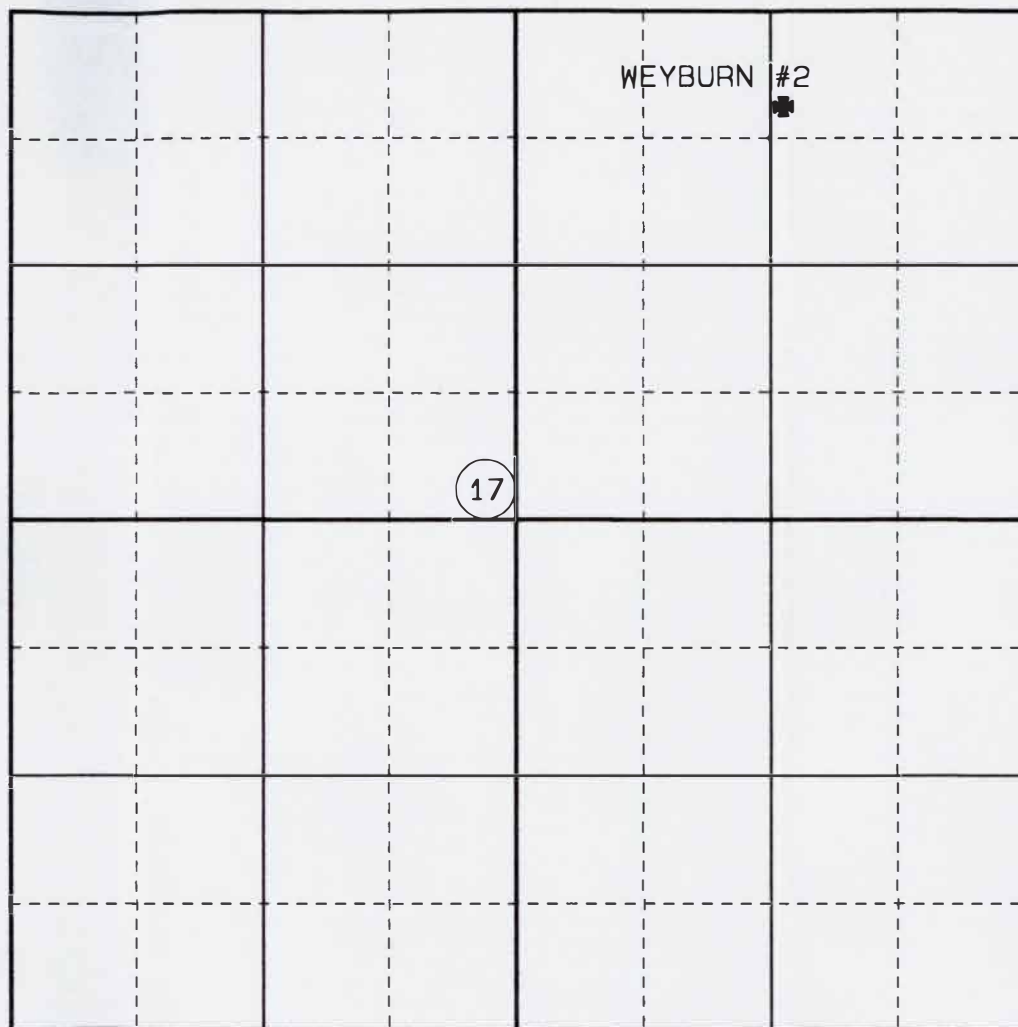

WEYBURN #2
494' F.N.L. & 1250' F.E.L.
NE/4 SEC 17-T16N-R10E
ELEV 920'
LAT 35°52'12.60"N
LONG 96°16'04.07"W
CREEK COUNTY

DUE CARE AND DILIGENCE HAVE BEEN EXERCISED IN THE
STAKING OF THIS WELL LOCATION ON THE GROUND
ACCORDING TO THE BEST OFFICIAL RECORDS AND MAPS
AVAILABLE TO US.
PLEASE REVIEW THIS PLAT AND NOTIFY US IMMEDIATELY
OF ANY DISCREPANCY

PENNCO LAND SURVEYING
P.O. BOX 52, SAPULPA, OK, 74067
(918)-367-2942; penncosurveying@yahoo.com
CA# 2074

DATE OF LAST SITE VISIT: 8-16-21
DATE OF REVISIONS: